

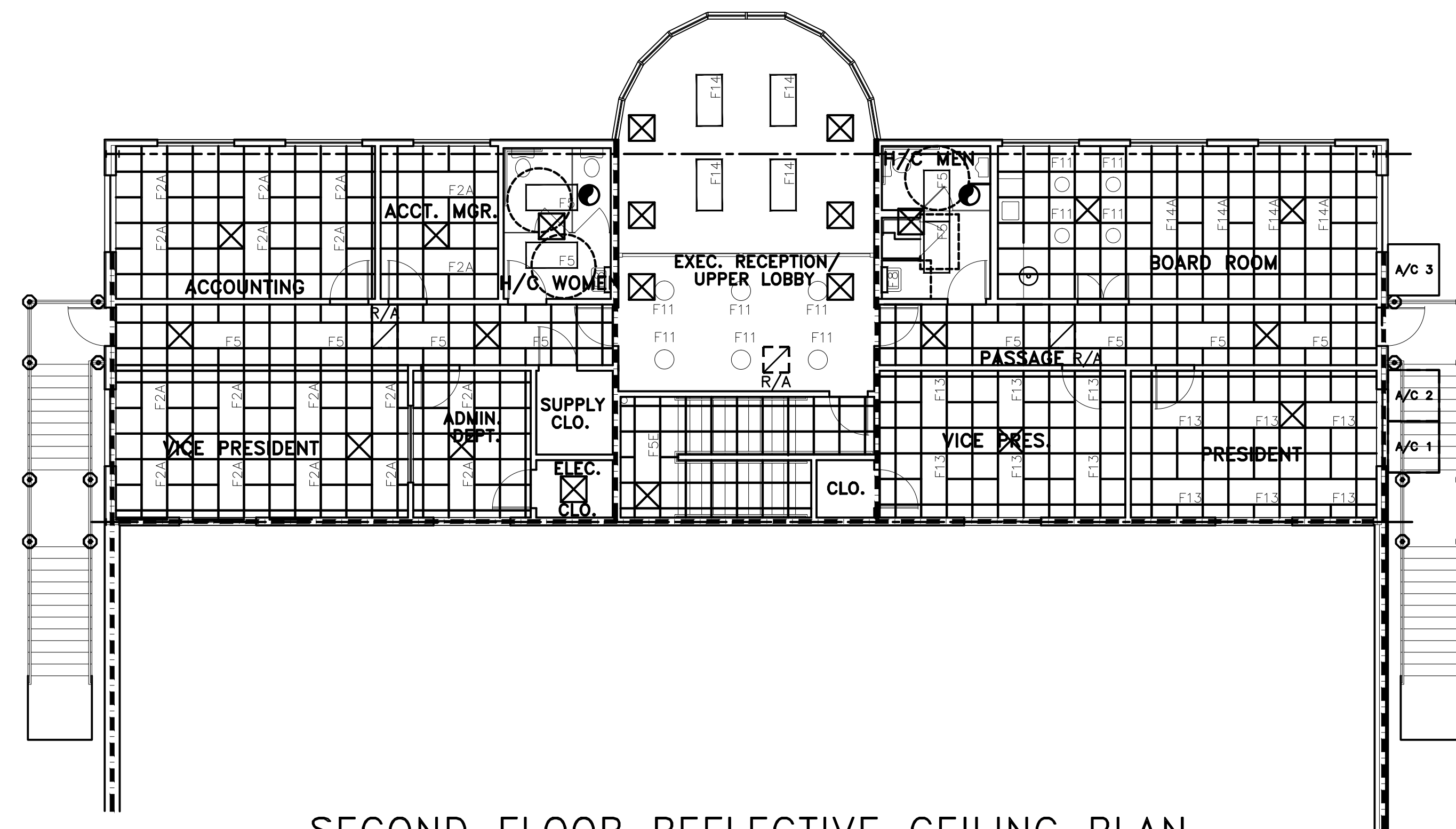



**FIRST FLOOR REFLECTIVE CEILING PLAN**  
SCALE: 1/8"=1'-0"

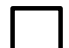

**SECOND FLOOR REFLECTIVE CEILING PLAN**  
SCALE: 1/8"=1'-0"

**NOTE:**  
CONTRACTOR/OWNER TO VERIFY EQUIPMENT,  
UTILITY TIE-INS AND ELECTRICAL LOCATIONS  
PRIOR TO START OF CONSTRUCTION

**LEGEND**

-  - 2 X 2 REFLECTIVE CEILING GRID
-  - 2 X 4 FLUORESCENT LIGHT FIXTURE
-  - 2 X 2 SUPPLY AIR DUCT
-  - 2 X 2 RETURN AIR DUCT

REFLECTIVE CEILING PLAN  
PLATFORM CRANE SERVICE  
DOSS DRIVE  
SLIDELL, LOUISIANA

OFFICE/WAREHOUSE  
**DAMMON ENGINEERING, INC.**  
1095 FLORIDA AVENUE 985-649-5832 SLIDELL, LA. 70458  
DAMMONENGINEERING.COM

SCALE: AS NOTED

FILE:

JOB NO. 1655

DATE: 04-13-05

SHEET

A-4

OF

REVISED: 04-04-06