

OFFICE / WAREHOUSE : PLATFORM CRANE

POWELL DRIVE AND
DOSS DRIVE
ST. TAMMANY PARISH, LA



PLATFORM CRANE
DOSS DRIVE
SLIDELL, LOUISIANA

DATE: 03-23-05
JOB NO. 1655

INTERNATIONAL BUILDING CODE

OCCUPANCY: B-NONSEPARATED USE
CONSTRUCTION TYPE V B

(TABLE 503) ALLOWABLE 9,000 SQ. FT. TWO STORIES

(TABLE 601) FIRE RESISTANCE RATING:
STRUCTURAL FRAME-0 HRS.
BEARING WALLS (INTERIOR & EXTERIOR)-0 HRS.
FLOOR CONSTRUCTION-0 HRS.
ROOF CONSTRUCTION-0 HRS.

(TABLE 602) FIRE RESISTANCE RATING FOR EXTERIOR WALLS-
0 HRS.-ALL EXTERIOR WALLS

(TABLE 704.8) MAX AREA OF WALL OPENINGS
UNLIMITED UNPROTECTED OPENINGS
ALLOWED THROUGHOUT.

(IBC 1603.1.4) THIS BUILDING SHALL BE DESIGNED IN ACCORDANCE
WITH IBC SECTION 1609 AS A PARTIALLY ENCLOSED
BUILDING USING THE FOLLOWING INFORMATION:

(IBC FIG. 1609) - BASIC WIND SPEED (3 SECOND GUSTS)-130 MPH

(TABLE 1604.5) - CATEGORY I BUILDING, IW=1

(IBC 1609.4) - EXPOSURE B

- DETERMINATION OF WIND LOADS SHALL BE IN
ACCORDANCE WITH IBC 1609.6

SQUARE FOOTAGE:

OFFICE	
FIRST FLOOR -	3169 SQ.FT.
SECOND FLOOR -	3169 SQ.FT.
TOTAL OFFICE	6338 SQ.FT.
WAREHOUSE	
TOTAL	8662 SQ.FT.
TOTAL	15000 SQ.FT.

DRAWING INDEX

C-1	COPY OF SURVEY	E-1	ELECTRICAL PLAN
C-2	SITE PLAN	E-2	PANEL SCHEDULES
C-3	DRAINAGE PLAN	M-1	MECHANICAL PLAN
C-4	PAVING NOTES & DETAILS	P-1	PLUMBING PLAN
S-1	FOUNDATION PLAN	H-1	HANDICAP DETAILS
A-1	FIRST & SECOND FLOOR PLAN	H-2	HANDICAP DETAILS
A-2	SCHEDULES & DETAILS		
A-3	ELEVATIONS		
A-4	REFLECTIVE CEILING PLAN		

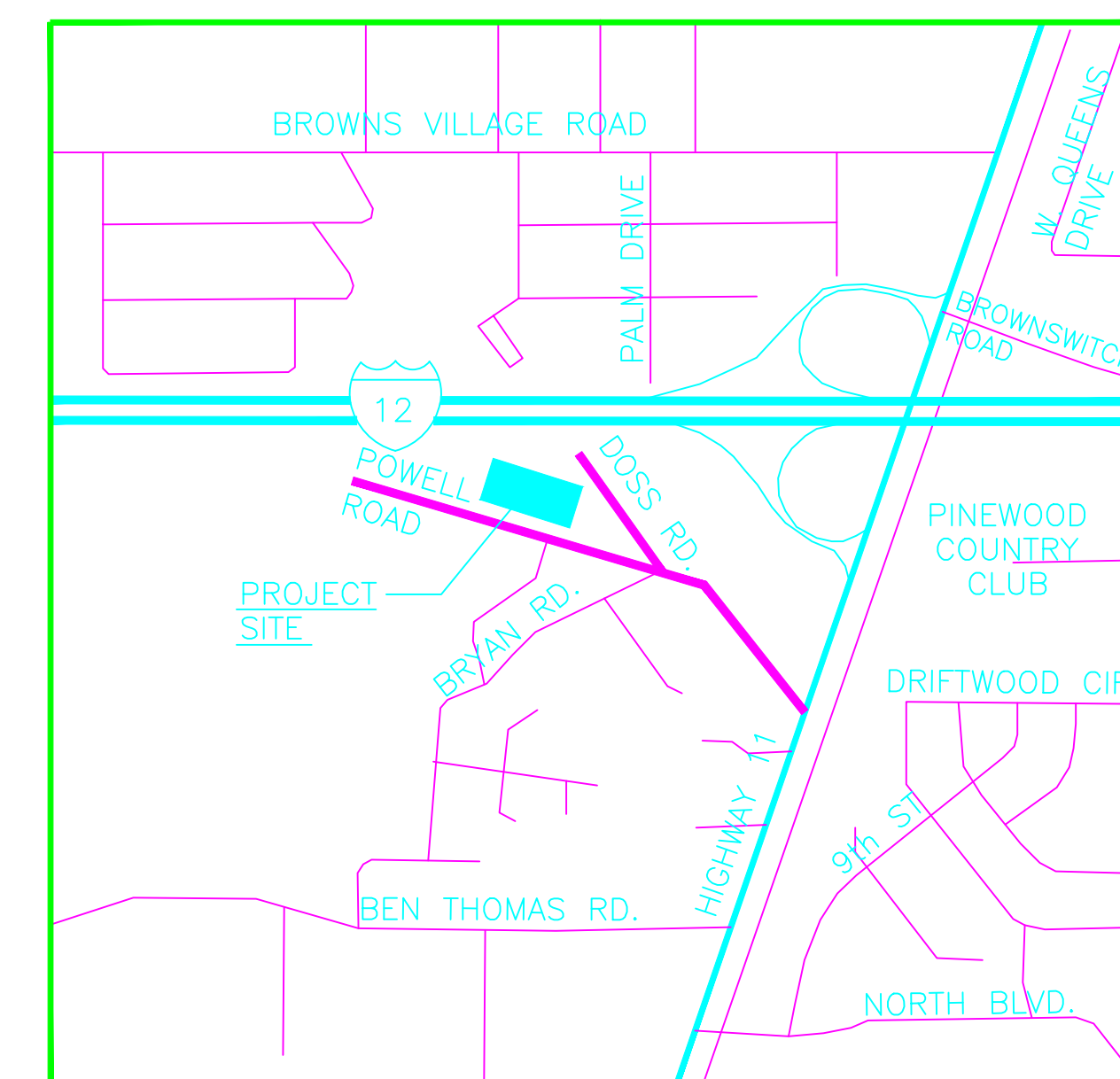

VICINITY MAP

N.T.S.

DAMMON ENGINEERING, INC.
1095 FLORIDA AVENUE 985-649-5832 SLIDELL, LA. 70458
DAMMONENGINEERING.COM