

VICINITY MAP
N.T.S.

SITE LIGHTING
EXTERIOR LIGHTING SHALL BE SHADED OR INWARDLY DIRECTED IN SUCH A MANNER SO THAT NO DIRECT LIGHTING OR GLARE BE CAST BEYOND THE PROPERTY LINE. THE INTENSITY OF SUCH LIGHTING SHALL NOT EXCEED ONE FOOT CANDLE AS MEASURED AT THE ABUTTING PROPERTY LINE. (N/A)

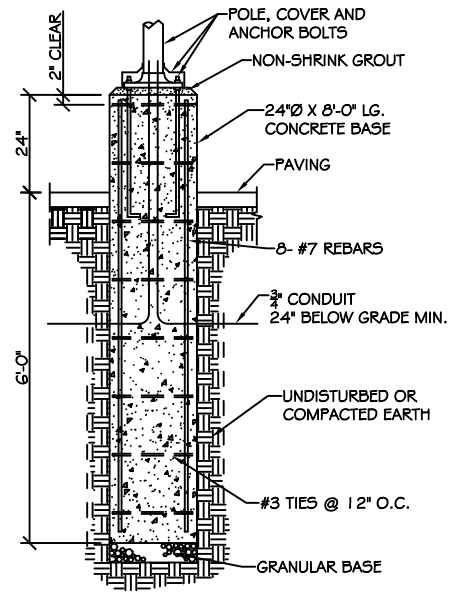

LIGHT POLE DETAIL
N. T. S.

- LEGEND:**
- - - - - PROPERTY LINE
 - SETBACK
 - NEW BUILDING OUTLINE
 - 6' CHAIN LINK FENCE
 - EXISTING WATER LINE
 - E—E—E— EXISTING POWER LINE
 - S—S—S— NEW SEWER LINE
 - W—W—W— NEW WATER LINE
 - SITE LIGHTING LINE
 - ▲—▲—▲— STANDPIPE 6" MIN. ABOVE GROUND, DRAIN INTO DITCH

PHOTOMETRIC PLAN
SCALE: 1" = 20'-0"

ZONING M-2
INTERMEDIATE INDUSTRIAL
FLOOD ZONE C

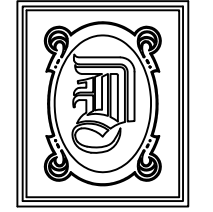

DAMMON ENGINEERING, INC.

CHIEF ENGINEER
EMMETT DAMMON, P.E.

CHIEF ARCHITECT
ROBERT WILTSE

1095 FLORIDA AVENUE
SLUDELL, LA. 70458
OFFICE: 985-649-5832
FAX: 985-641-5950

WEBSITE:
WWW.DAMMONENGINEERING.COM

EMAIL:
DAMMONENG@BELLSOUTH.NET

- ARCHITECTURE
- ENGINEERING
- STUDIES
- PLANNING
- INVESTIGATION
- EXPERT WITNESS

NEW FACILITY

STANDARD MATERIALS
1601 NORTH LANE
MANDEVILLE, LA

PHOTOMETRIC PLAN

REV:

SCALE: AS NOTED

JOB#: 1906

DATE: 01-09-09

SHEET

C-5

OF