

- SITE PLAN NOTES**
1. ROOFING MATERIAL: METAL ROOFING PANEL
  2. SIDING MATERIAL: SPUNT FACE BLOCK
  3. UTILITIES: ALL UTILITIES SHALL BE PLACED UNDERGROUND
- NOTE:**  
 1. ALL PAVEMENT SHALL BE 6" THICK CONCRETE.
- SITE LIGHTING:**  
 EXTERIOR LIGHTING SHALL BE SHADOWED OR INWARDLY DIRECTED IN SUCH A MANNER SO THAT NO DIRECT LIGHTING OR GLARE BE CAST BEYOND THE PROPERTY LINE. THE INTENSITY OF SUCH LIGHTING SHALL NOT EXCEED ONE FOOT CANDLE AS MEASURED AT THE ADJUTING PROPERTY LINE.

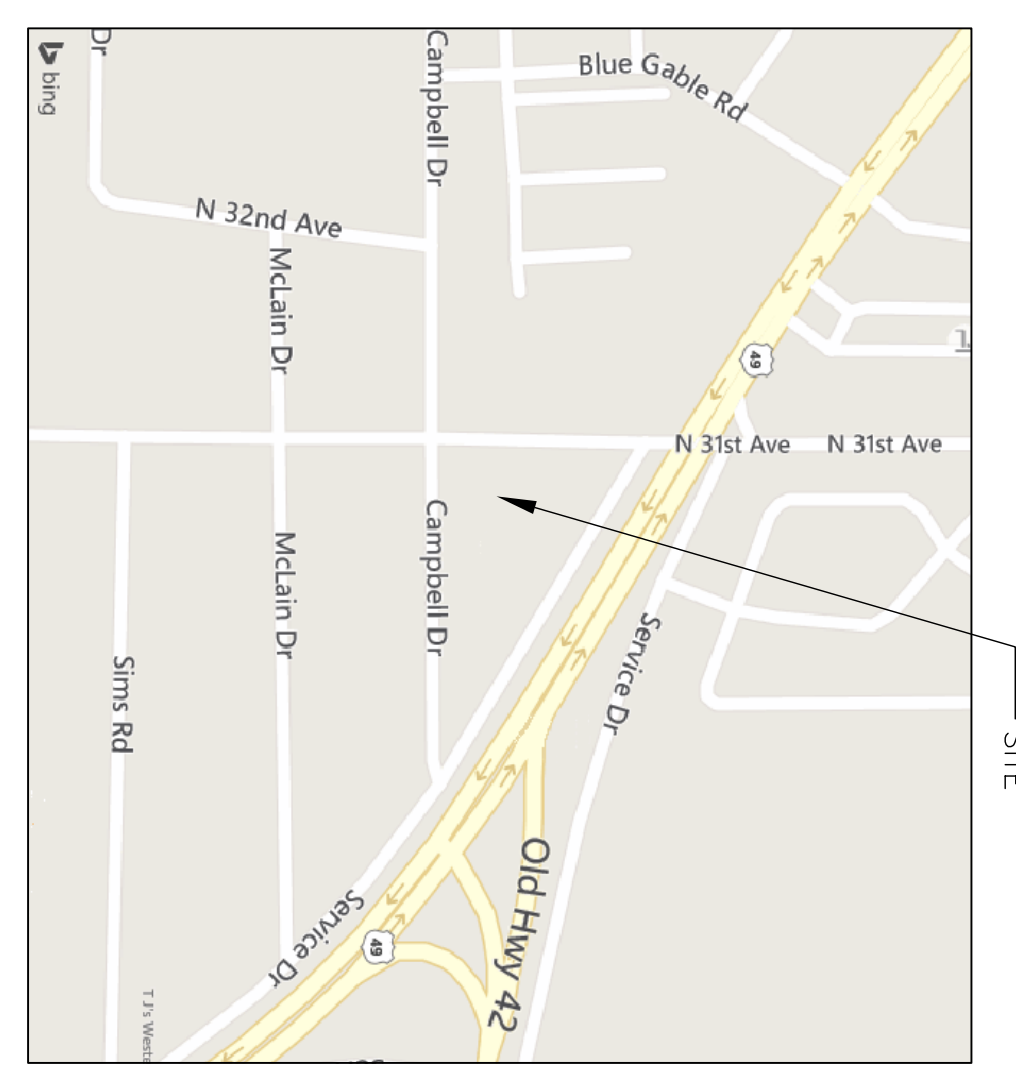
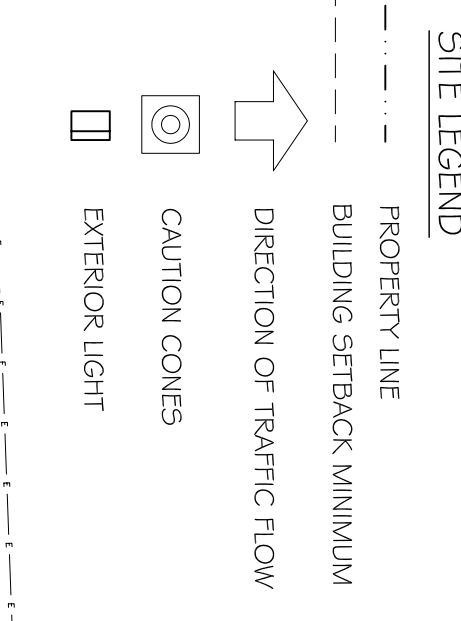

SHEET No: 00 OF 00

**C1**

**SITE PLAN**

REVISIONS		DATE
#	DESCRIPTION	

**RAINFOREST CARWASH #2**  
 6485 U.S. HWY. 49

HATTIESBURG, MISSISSIPPI

JOB No: 2212      DATE: 09-08-2014

DRAWN BY: CKD      CHECKED BY: CKD

**DAMMON ENGINEERING, INC.**  
*Architects & Engineers*

CHIEF ENGINEER: BRIAN MISTICH, P.E.  
 554 OLD SPANISH TRAIL  
 SLIDELL, LA 70458

dammonengineering.com  
 dammoneng@slidell.rr.com  
 PHONE: 985-649-5832  
 FAX: 985-641-5950