

TITLE STREAM NEW OPTIONAL STANDBY GENERATOR

GENERAL NOTES:

- CONTRACTOR SHALL INSTALL A COMPLETE SYSTEM TO PROVIDE CONTINUOUS POWER TO MATCH THE EXISTING ELECTRICAL SERVICE. CONTRACTOR SHALL PROVIDE A 120/240V 1Ø - 32 KW GENERATOR THAT OPERATES ON NATURAL GAS WITH AN AUTOMATIC POWER TRANSFER SWITCH (ATS) RATED AT 240V 200A, THE ATS SHALL BE SERVICE ENTRANCE RATED. THE ATS SHALL HAVE A NEMA 3R ENCLOSURE.
- CONTRACTOR IS TO SUPPLY AND INSTALL A STEEL PLATFORM CAPABLE OF SUPPORTING THE GENERATOR SUPPLIED.
- CONTRACTOR TO SECURELY ATTACH GENERATOR TO PLATFORM PER THE MANUFACTURER'S GUIDELINES TO WITHSTAND 144 MPH WINDS AND THEFT.
- CONTRACTOR TO VERIFY ALL SITE CONDITIONS AND ELEVATIONS PRIOR TO CONSTRUCTION.
- MATERIALS SHALL BE NEW AND U.L. LISTED.
- NO WORK SHALL BE CONCEALED UNTIL APPROVED BY LOCAL INSPECTORS.
- CONSTRUCTION SHALL COMPLY WITH ALL CITY, STATE AND LOCAL CODES.
- CONTRACTOR TO GUARANTEE WORK FOR ONE YEAR.
- CONTRACTOR IS TO PROTECT ALL EXPOSED EXTERIOR STRUCTURAL STEEL, PLATFORM, WITH A HIGH PERFORMANCE EPOXY SYSTEM EQUAL TO SHERWIN WILLIAMS (APPLY PER MANUFACTURER'S INSTRUCTIONS).

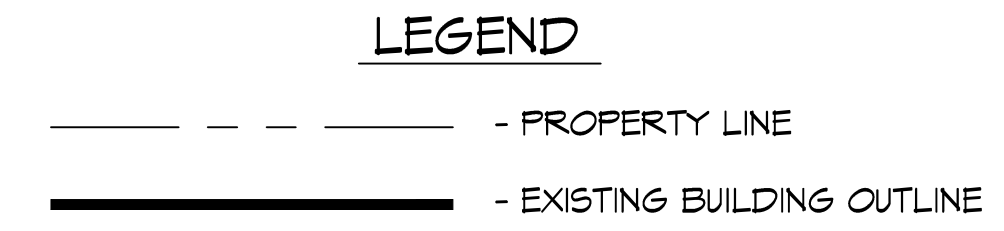
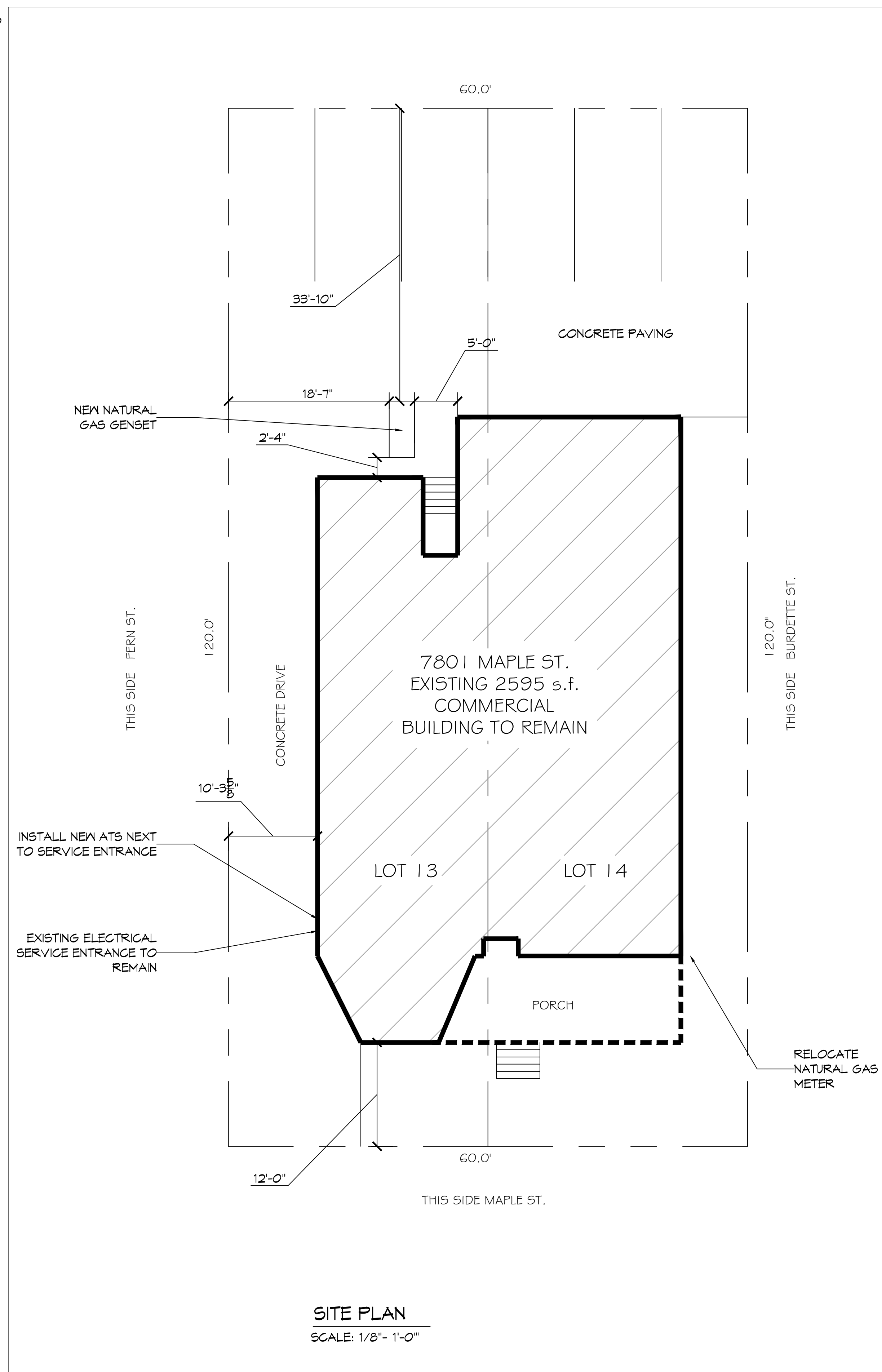
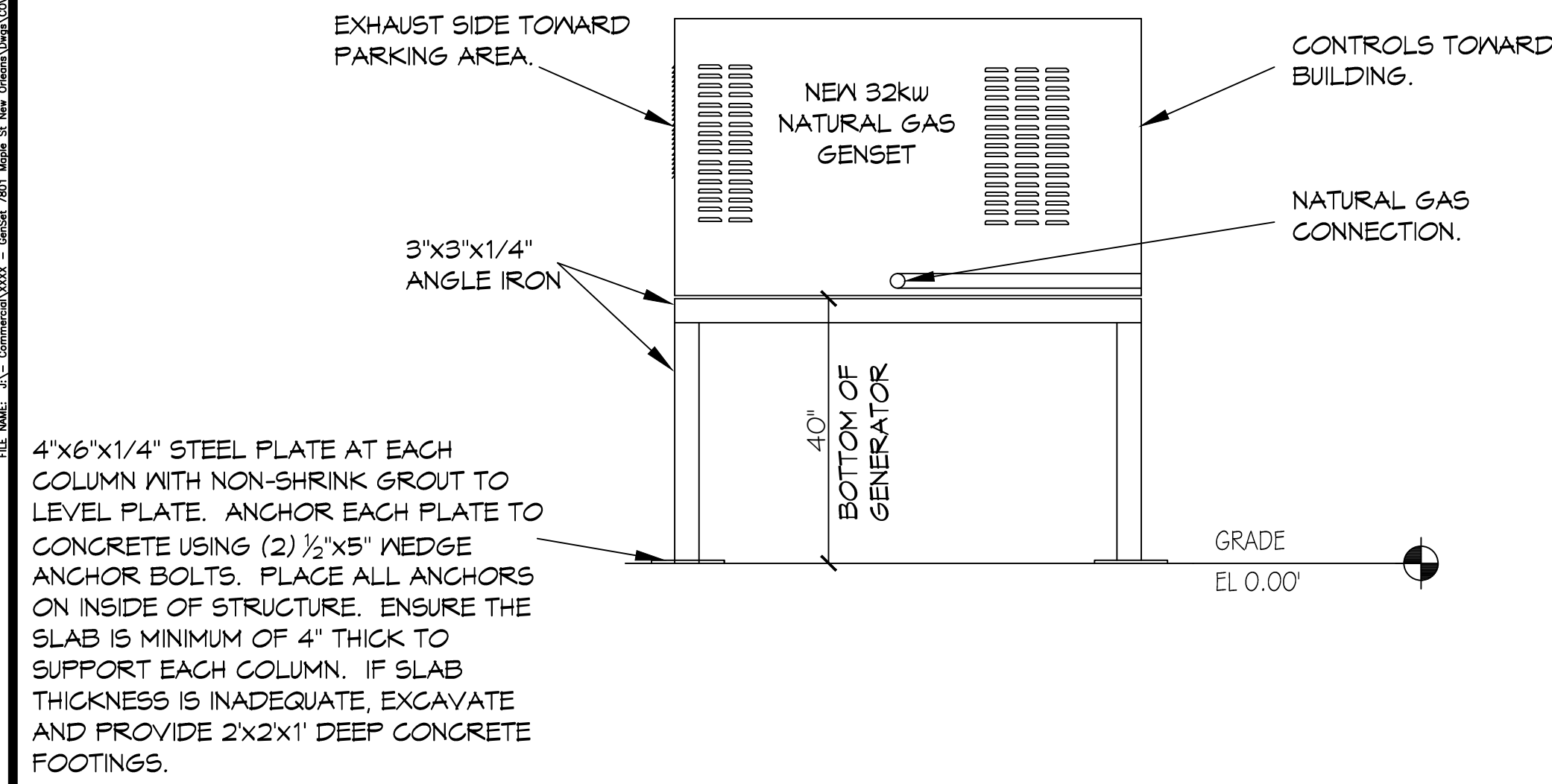

**PRELIMINARY DWGS
NOT FOR
CONSTRUCTION.**

PROJECT LOCATION:
7801 MAPLE ST., NEW ORLEANS, LA 70118

PROPERTY DESCRIPTION: SQ. 96 LOTS 13 & 14
14 MAPLE & BURDETTE 60' X 120',
SURVEY BY SAM SCANDALATO, LAND SURVEYOR, DATED DECEMBER 27, 1990.

APPLICABLE CODES:

NFPA 70 NATIONAL ELECTRICAL CODE, 2014
NFPA 101 LIFE SAFETY CODE, 2015
NFPA, 110 STANDARD FOR EMERGENCY AND STANDBY POWER SYSTEMS, 2016
INTERNATIONAL FUEL GAS CODE, 2015

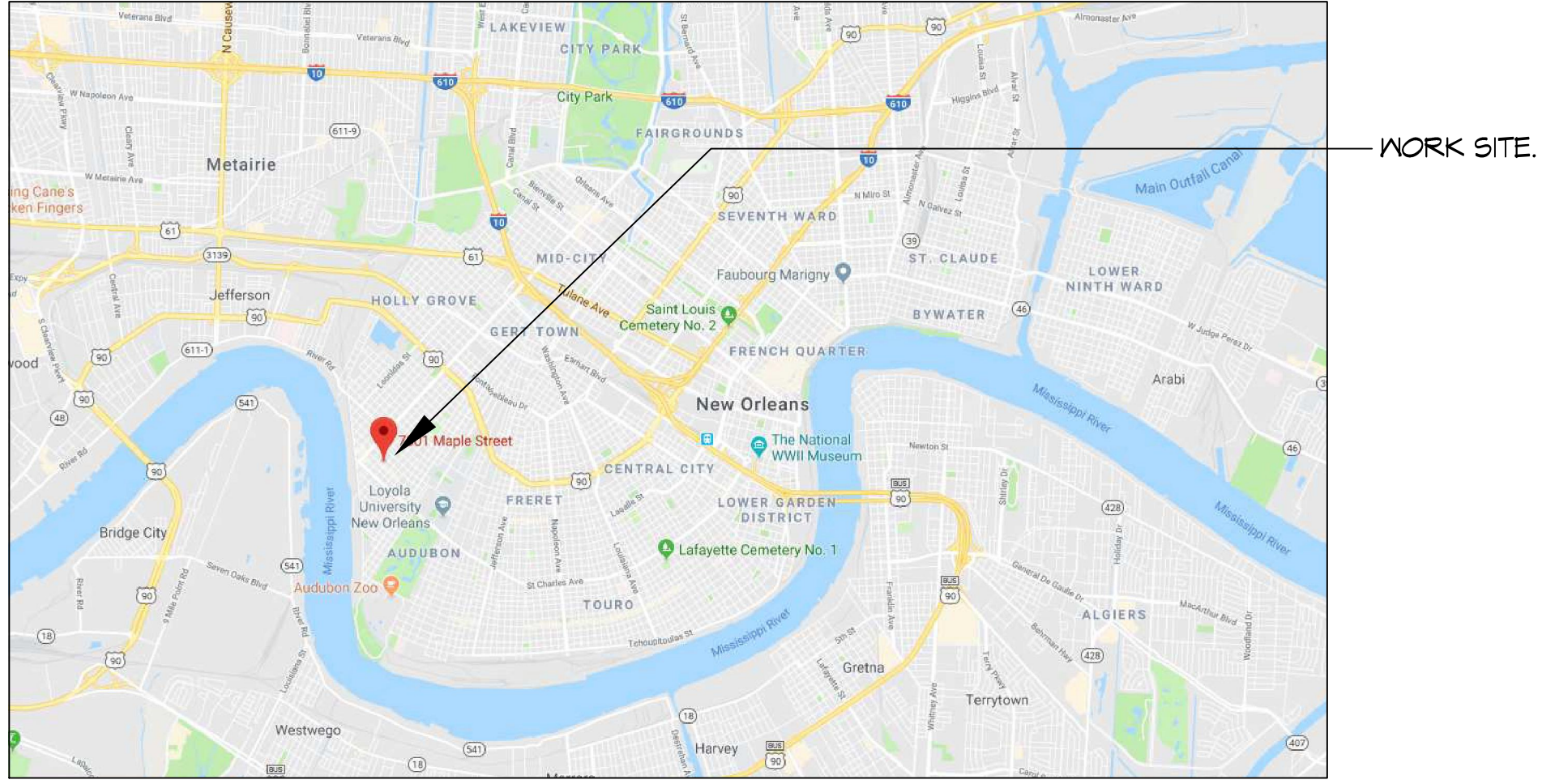

VICINITY MAP
SCALE: N.T.S.

SITE PLAN
SCALE: 1/8" = 1'-0"

#	DESCRIPTION	DATE

NEW OPTIONAL STANDBY GENERATOR

TITLE STREAM

7801 MAPLE ST.,
NEW ORLEANS, LA 70118
JOB No: 2355 DATE: 11/1/2019

SHEET TITLE:
COVER SHEET

DRAWING NUMBER:

TS-1