

FILE NAME: J:\CHECKED\New\Mechanical\General\A101 - Floor Plan.dwg PLOT DATE: 11/17/2021 10:48 AM

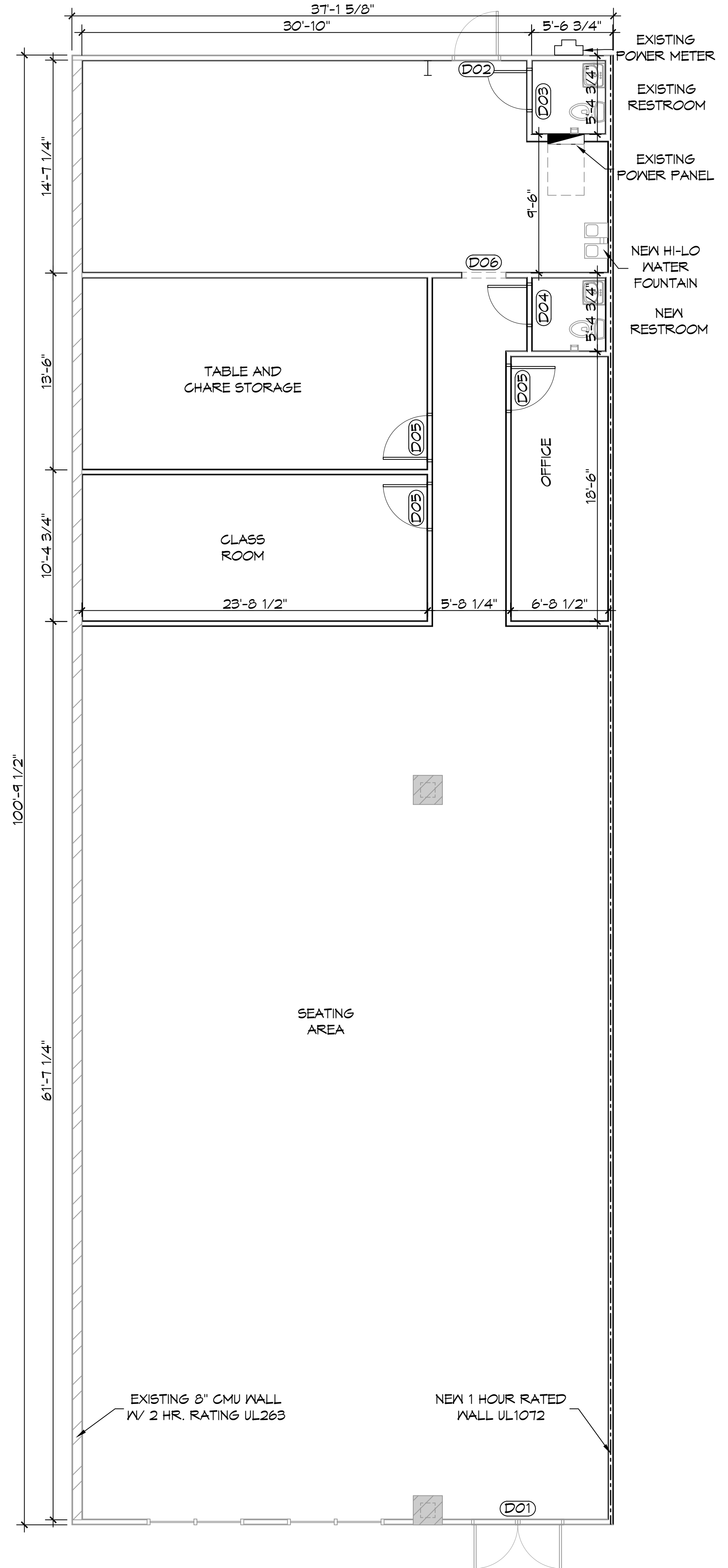

**3 FLOOR PLAN**  
SCALE: 3/16"=1'-0"

**DOOR SCHEDULE**

MK	WIDTH	HEIGHT	THK	DOOR MAT	FRAME MAT	FR	REMARKS
D01	(2)3'-0"	7'-0"	1-3/4"	GLASS	STEEL	NR	EXISTING DOUBLE DOOR WITH CLOSER
D02	3'-0"	6'-8"	1-3/4"	STEEL	STEEL	NR	EXISTING BACK DOOR
D03	2'-8"	6'-8"	1-3/4"	WOOD	STEEL	NR	EXISTING RESTROOM DOOR WITH CLOSER
D04	2'-8"	6'-8"	1-3/4"	WOOD	STEEL	NR	NEW RESTROOM DOOR WITH CLOSER
D05	3'-0"	6'-8"	1-3/4"	WOOD	STEEL	NR	NEW INTERIOR DOORS
D06	3'-0"	6'-8"	-	-	STEEL	NR	EXISTING CASSED OPENING

NOTE:  
DOORS IN A REQUIRED MEANS OF EGRESS SERVING ANY ASSEMBLY AREA HAVING AN OCCUPANT LOAD OF 50 OR MORE PERSONS SHALL NOT BE EQUIPPED WITH A LATCH OR LOCK OTHER THAN PANIC HARDWARE OR FIRE EXIT HARDWARE.

**GENERAL PLAN NOTES**

- INSULATION AND INSULATION ASSEMBLIES SHALL MEET THE REQUIREMENTS OF IBC 2015 SECTION 120.
- A. CONCEALED INSULATION SHALL HAVE A FLAME SPREAD OF 0-25 AND SMOKE DEVELOPED INDEX OF 0-450, EXCEPT THAT IN COMBUSTIBLE (WOOD FRAME) CONSTRUCTION.
- B. FACING SHALL COMPLY WITH IBC 2015.
- ALL MATERIALS SHALL BE NEW AND UL LISTED.
- NO WORK SHALL BE CONCEALED UNTIL APPROVED BY LOCAL INSPECTORS.
- CONSTRUCTION SHALL COMPLY WITH ALL PARISH, STATE, AND LOCAL CODES.
- CONTRACTOR TO GUARANTEE WORK FOR ONE YEAR FROM DATE OF SUBSTANTIAL COMPLETION.
- CONTRACTOR SHALL FURNISH WATER AND POWER FROM EXISTING SOURCES.
- EXTERIOR CAULKING SHALL BE THICKAL CAULK.
- PAINT SHALL BE SHERWIN WILLIAMS OR EQUIVALENT AND APPROPRIATE FOR THE SUBSTRATE TO WHICH IT IS APPLIED AS RECOMMENDED BY PAINT MANUFACTURER. ALL WORK TO RECEIVE THREE COATS (ONE PRIMER COAT, TWO FINISH COATS) UNLESS OTHERWISE RECOMMENDED BY PAINT MANUFACTURER. COLORS TO BE SELECTED BY OWNER.
- PROVIDE CLEANUP ON A REGULAR BASIS. NO TRASH SHALL BE STORED INSIDE BUILDING PREMISES.
- ALL BATT INSULATION SHALL HAVE A CLASS "A" (0-25) FLAME SPREAD IN COMPLIANCE WITH IBC 2015.
- USE 2x6 WOOD STUDS, OR TWO 2x4 WOOD STAGGERED STUDS WITH 2x6 SILL PLATE AT ALL WALLS WHERE 4" PIPE IS INDICATED. SEE PLUMBING RISER DIAGRAM FOR PIPE SIZE.
- PROVIDE GALVANIZED METAL PAN WITH DRAIN AT ALL WATER HEATERS.
- ALL FLOORING SHALL MEET OR EXCEED ADA GUIDELINES REQUIREMENTS FOR SLIP RESISTANCE.
- INTERIOR LOCKS ON DOORS IN MEANS OF EGRESS SHALL NOT REQUIRE THE USE OF A KEY, SPECIAL KNOWLEDGE, OR SPECIAL DEVICE TO OPEN IN THE DIRECTION OF EGRESS. ALL DOORS SHALL HAVE LEVER TYPE HANDLES.
- INTERIOR WALLS AND CEILING SHALL HAVE A FLAME SPREAD OF 0-200 AND A SMOKE DEVELOPMENT RATING OF 0-450.
- ALL NEW WORK SHALL COMPLY WITH THE LATEST EDITION OF ALL LOCAL, STATE, AND NATIONAL CODES COVERING THE TYPE OF WORK BEING PERFORMED.
- PROVIDE PORTABLE FIRE EXTINGUISHERS IN ACCORDANCE WITH NFPA 101, SEE APPENDIX 'E' OF NFPA 101 FOR DISTRIBUTION OF EXTINGUISHERS.
- ALL FIRE WALLS SHALL EXTEND TIGHT TO ROOF DECK AND BE SEALED WITH AN APPROVED FIRE CAULK.
- ALL ELECTRICAL, MECHANICAL, AND PLUMBING MATERIALS PENETRATING FIRE WALLS SHALL BE FIRE CAULKED. (PENETRATIONS THROUGH RATED CONSTRUCTION SHALL BE SEALED WITH A MATERIAL CAPABLE OF PREVENTING THE PASSAGE OF FLAMES AND HOT GASES WHEN TESTED IN ACCORDANCE WITH ASTM-E814.)
- SERVICE COUNTERS SHALL HAVE AN ACCESSIBLE WRITING SURFACE IN COMPLIANCE WITH ADAAG ACCESSIBILITY GUIDELINES 2010, SECTION 902.3.

BXUV.U906  
Fire Resistance Ratings - ANSI/UL 263  
Design No. U906  
March 17, 2004

BEARING WALL RATING -- 2 HR.  
NONBEARING WALL RATING -- 2 HR.  
Load Restricted for Canadian Applications --  
See Guide BXUV7

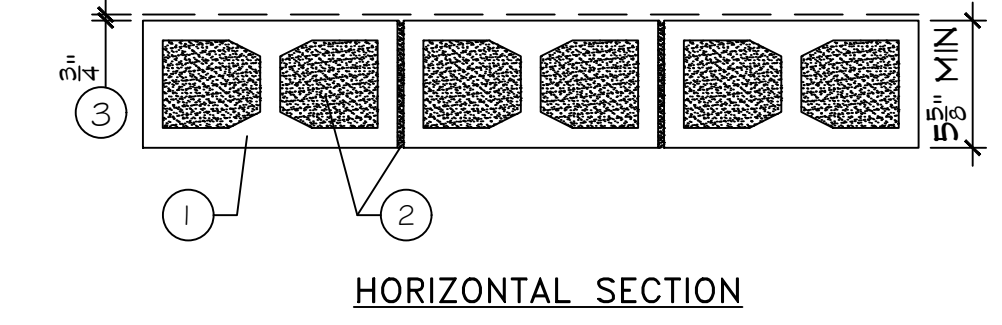

- Concrete Blocks\*** -- Nominal 6 by 8 by 16 in, hollow or solid. Classification D-2 (2 hr).  
ANCHOR CONCRETE PRODUCTS INC  
GAGNE & SON CONCRETE BLOCK INC  
  
Allowable compressive stress of 57% of max allowable compressive stress in accordance with the empirical design method.  
  
OLDCASTLE APG NE DBA ARTHUR WHITCOMB  
WESTBROOK CONCRETE BLOCK CO INC  
  
Allowable compressive stress of 75.6% of max allowable compressive stress in accordance with the empirical design method.
- Mortar** -- Blocks laid in full bed of mortar, nom. 3/8 in. thick, of not less than 2-1/4 and not more than 3-1/2 parts of clean sharp sand to 1 part Portland cement (proportioned by volume) and not more than 50 percent hydrated lime (by cement volume). Vertical joints staggered.
- Portland Cement Stucco or Gypsum Plaster** -- Add 1/2 hr to Classification if used. Attached to concrete blocks (Item 1).
- Foamed Plastic\*** -- (Optional-Not Shown) -- 1-1/2 in. thick max, 4 ft wide sheathing attached to concrete blocks (Item 1).  
THE DOW CHEMICAL CO -- Type Thermax

\*Bearing the UL Classification Mark

Last Updated on 2004-03-17  
GA FILE NO. WP 1072 GENERIC

ONE LAYER 5/8" TYPE X GYPSUM WALLBOARD OR GYPSUM VENEER BASE APPLIED PARALLEL OR AT RIGHT ANGLES TO EACH SIDE OF 3-5/8" STEEL STUDS 24" O.C. WITH 1" TYPE 5 DRYWALL SCREWS 8" O.C. AT VERTICAL JOINTS AND 12" O.C. AT FLOOR AND CEILING RUNNERS AND INTERMEDIATE STUDS.

JOINTS STAGGERED 24" ON EACH SIDE AND ON OPPOSITE SIDES. SOUND TESTED WITH 3-1/2" GLASS FIBER FRICTION FIT IN STUD SPACE. (NON-LOAD BEARING)

1 HOUR FIRE	45 TO 49 STC SOUND	THICKNESS: APPROX. WEIGHT: FIRE TEST:	4-7/8" 6 PSF SEE WP 1200 (FM WP-45, 6-19-68); OSU T-1770, 8-6-11; ULC 791484, 791500, 791497, 8-12-81, ULC DESIGN W415) SOUND TEST: NRCC 816-NV, 2-3-81
-------------	--------------------	---	---

**DAMMON ENGINEERING, INC.**  
LOUISIANA & MISSISSIPPI  
www.dammonengineering.com  
info@dammonengineering.com  
554 Old Spanish Trail  
Slidell, LA 70458  
Chief Engineer: Brian Mistich, PE  
554 Old Spanish Trail  
Slidell, LA 70458  
PH: 985.641.5832 F: 985.641.5950

REVISIONS	DATE	DESCRIPTION

REID MOCHERMAN  
**LESIA CRISTIANO**  
**SLINJEDECRISTO**  
**INC.**  
1000 CANEBO BLDG  
BUILDING UNITS 165 - XX  
SLIDELL, LA 70461  
JOB NO: 11/17/2021  
DATE: 11/17/2021  
CHECKED BY: JAS  
DRAWN BY:

SHEET TITLE:  
**FLOOR PLAN**  
DRAWING NUMBER:  
**A101**  
SHEET No: 3 of XX