

LIFE-SAFETY INFORMATION

APPLICABLE CODES	
NFPA 101 LIFE-SAFETY CODE 2015	
OCCUPANCY TYPE(S) AND CHAPTER(S)	
ASSEMBLY (CHAPTER 12)	
OCCUPANT LOAD FACTOR	(REFERENCE TABLE 7.3.1.2)
ASSEMBLY (Concentrated use, without fixed seating)	7 NET / PERSON 2074 S.F. / 7 S.F. / PERSON = 241 OCCUPANTS
CLASSIFICATION OF HAZARD OF CONTENTS	
(REFERENCE: OCCUPANCY CHAPTER AND 6.2.2: SPECIFY LOW, ORDINARY, OR HIGH)	
CONST. TYPE = B(200) (REFERENCE: CHAPTERS, TABLE A.8.2.1.2 AND COMMENTARY TABLE 8.1 IN HANDBOOK)	
MINIMUM EXIT SEPARATION DISTANCE FOR REMOTELY LOCATED EXITS	
(REFERENCE: SECTION 7.5; SPECIFY 1/2 OR 1/3 DIAGONAL DISTANCE OF AREA SERVED)	
1/3 DIAGONAL =	107 FT / 3 = 35.6 FT
MAXIMUM DEAD-END CORRIDORS (REFERENCE: OCCUPANCY CHAPTER AND TABLE A.7.6)	
20 FEET	
MAXIMUM COMMON PATH OF TRAVEL DISTANCE (REFERENCE: OCCUPANCY CHAPTER AND TABLE A.7.6)	
20 FEET	
MAXIMUM TRAVEL DISTANCE TO EXITS (REFERENCE: OCCUPANCY CHAPTER AND TABLE A.7.6)	
250 FEET	
*MAIN ENTRANCE MUST BE SIGNED TO ACCOMMODATE 1/2 OCCUPANT LOAD OF BUILDING	
EXTINGUISHMENT REQUIREMENTS THIS BUILDING IS FULLY SPRINKLERED	
DETECTION, ALARM, AND COMMUNICATION SYSTEMS MONITORED FIRE ALARM SYSTEM	
ALLOWABLE HEIGHT AND BUILDING AREA PER IBC EQUIVALENT CONSTRUCTION TYPE	

BUILDING CODE INFORMATION

APPLICABLE CODES	
IBC 2015	
ASSEMBLY GROUP A2 & A5	(IBC 2015 CHAPTER 10)
OCCUPANT LOAD CALCULATIONS	(TABLE 1004.1.2)
ASSEMBLY A-3 (CONSECRATED NON-FIXED SEATING) =	7 S.F. / PERSON = 241 OCCUPANTS
TOTAL OCCUPANTS	241 OCCUPANTS
CONSTRUCTION TYPE(S)	3 B (SECTION 602)
ALLOWABLE HEIGHT AND BUILDING AREA LIMITED BY TYPE OF CONSTRUCTION	
MAXIMUM HEIGHT IN STORIES (SECTION 503 & 504, TABLE 504.4)	2
MAXIMUM AREA IN SQUARE FEET (SECTION 503, 506 & 507, TABLE 506.2)	39,000 SF
ACTUAL BUILDING FIRE AREA IN SQUARE FEET	18,000 SF

WIND SPEED DESIGN REQUIREMENTS

IMPROVEMENTS TO THIS BUILDING SHALL BE DESIGNED WITH IBC SEC 1609 AS A FULLY ENCLOSED BLDG USING THE FOLLOWING INFORMATION:

WIND DESIGN DATA: DETERMINATION OF WIND LOADS SHALL BE IN ACCORDANCE WITH IBC SEC 1609.3 (A), (B), OR (C) DEPENDING ON THE RISK CATEGORY			
ULTIMATE WIND SPEED =	142 MPH (IBC FIG 1609C)	NOMINAL WIND SPEED =	V _{ref} = 110 MPH
RISK FACTOR:	CATEGORY II	SURFACE ROUGHNESS =	B
TOPOGRAPHIC FACTOR =	1	EXPOSURE =	B
INTERNAL PRESSURE COEFFICIENT (ASCE 7-10 TABLE 26.11-1): ± 0.18			
LIVE LOADS (IBC SEC 1607)			
ASSEMBLY MOVEABLE SEATING (IBC TABLE 1607.1):	100 PSF		
PLATFORMS (ASSEMBLY) (IBC TABLE 1607.1):	100 PSF		
LOBBIES (IBC TABLE 1607.1):	100 PSF		
CLASSROOMS (IBC TABLE 1607.1):	40 PSF UNIFORM, 1,000 LB CONCENTRATED		
ROOF LIVE LOADS (IBC TABLE 1607.1):	20 PSF UNIFORM, 300 LB CONCENTRATED		
SNOW LOADS (IBC TABLE 1608):			
GROUND SNOW LOAD (IBC FIG 1608.2):	5 PSF		

FLOOD ZONE INFORMATION

BASED ON THE LSU FLOOD MAP PROPERTY IS IN ZONE AE, EL. 19 BASE FLOOD.

FLOOD ZONE:	AE	BASE FLOOD ELEVATION	19.0'
FIRM, COMMUNITY NUMBER 2201C0695F	DATE: 04/30/2008		

LIFE-SAFETY LEGEND

SYMBOL	DESCRIPTION
	EXITS
	DOOR FIRE RATING (MINUTES)
	DOOR WIDTH/EGRESS CAPACITY
	EXIT LIGHT
	FIRE EXTINGUISHER VV WALL MTD BRACKET
	COMMON PATH OF TRAVEL
	TRAVEL DISTANCE
	DECISION POINT

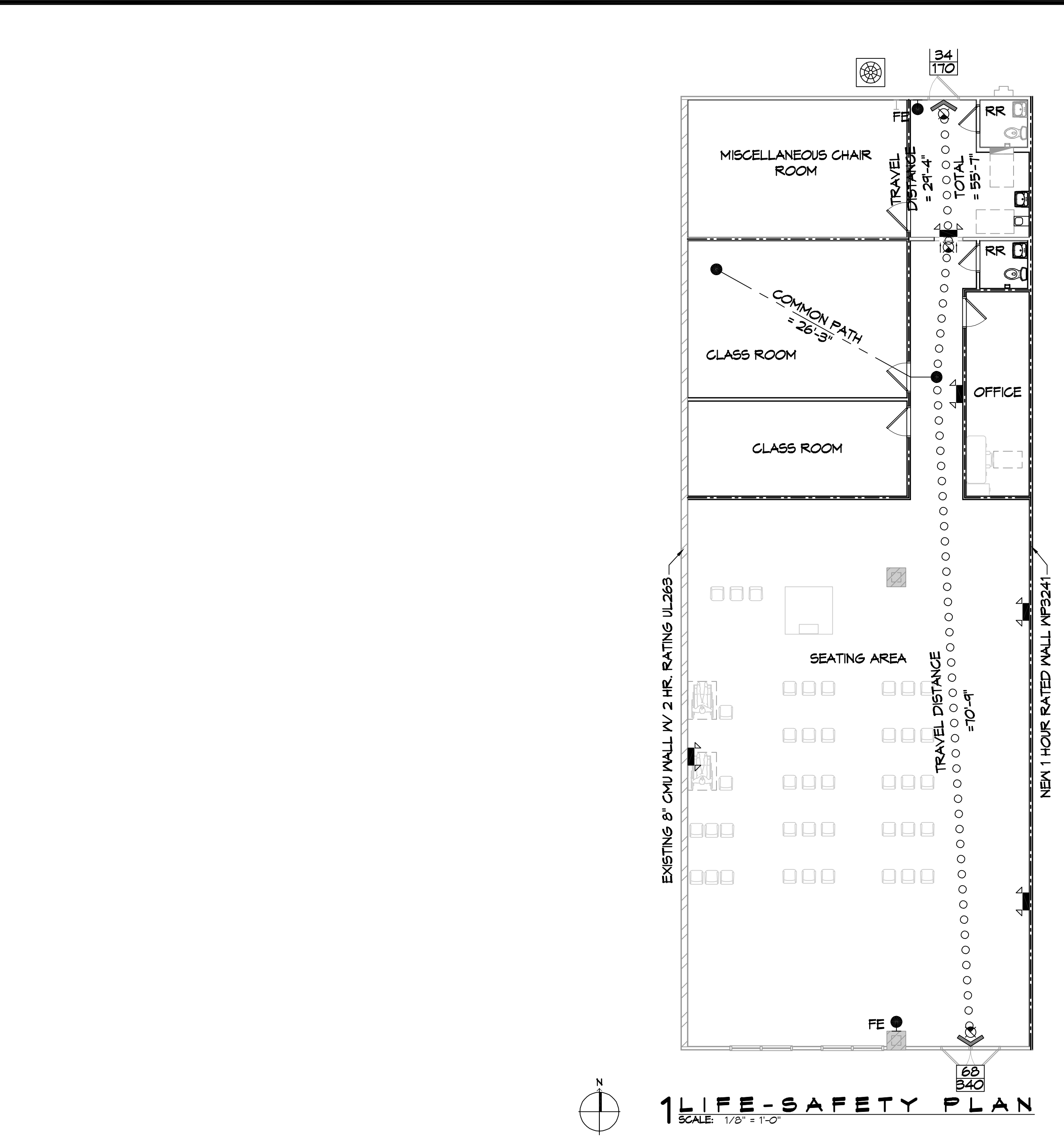

BUILDING INFORMATION:
TOTAL S.F. = 87,583 S.F.
SPRINKLED = YES
ALARMED = YES

FIRE AREA INFORMATION:
2 HR CMU FIREWALL AREA = 18,000 S.F.

SUITE INFORMATION:
TOTAL SUITE = 3,800 S.F.
WORSHIP AREA = 2,079 S.F.
NEITHER CLASSROOMS NOR MISCELLANEOUS ROOM WILL BE OCCUPIED WHILE WORSHIP SERVICE IS BEING HELD.

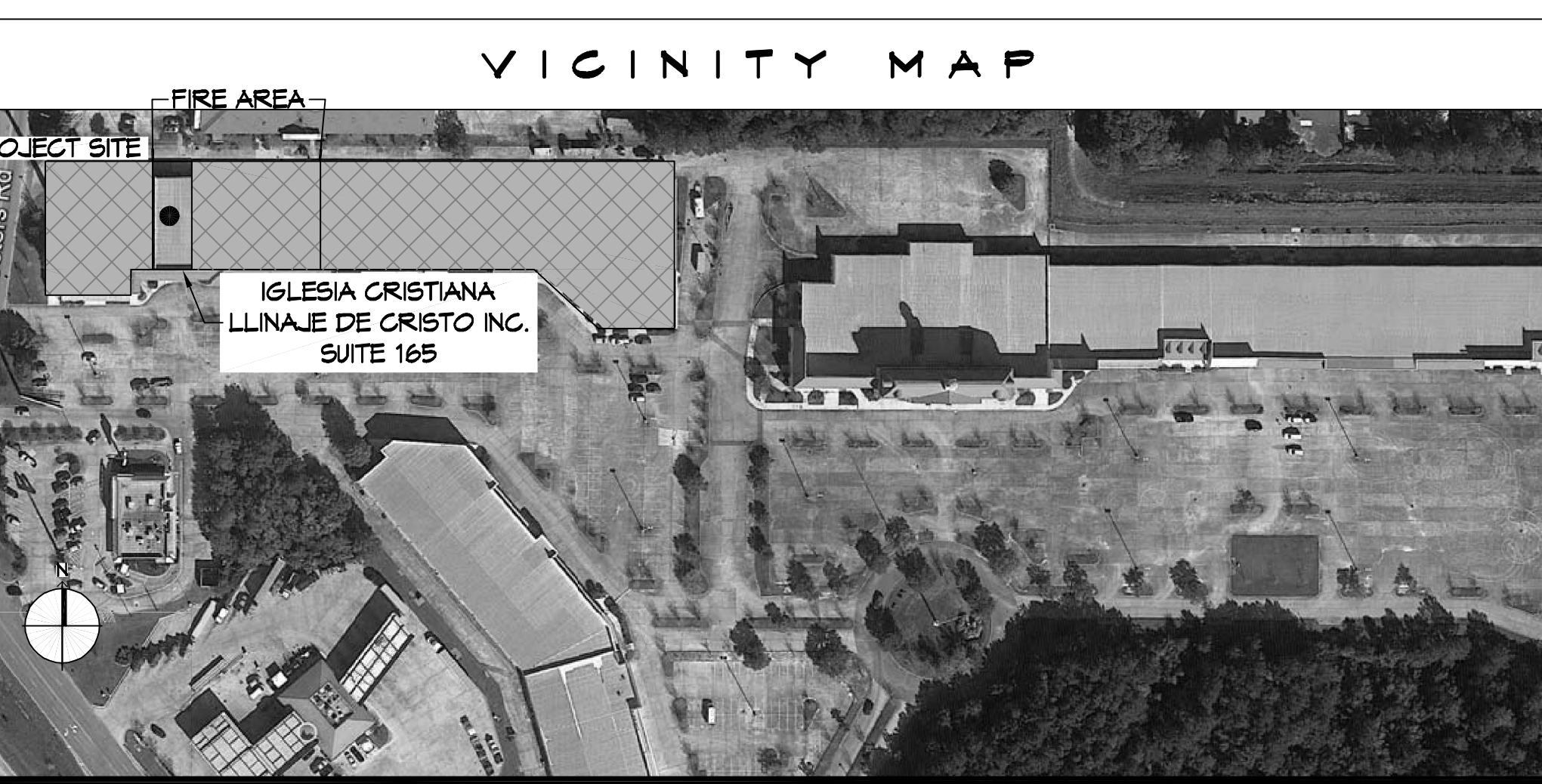

SHEET INDEX

SHEET #	SHEET TITLE
G101	GENERAL INFORMATION SHEET
C101	SITE PLAN
A101	FLOOR AND REFLECTED CEILING PLAN
PM101	PLUMBING AND MECHANICAL PLAN
E101	POWER AND LIGHTING PLAN

- ### GENERAL NOTES
- ALL MATERIALS AND WORK, INCIDENTAL TO THE CONSTRUCTION OF THIS PROJECT, SHALL CONFORM TO ALL GOVERNING CODES, AND REGULATIONS OF AGENCIES IN AUTHORITY.
 - CONTRACTOR SHALL PROVIDE ALL PUBLIC PROTECTIONS NECESSARY AS REQUIRED BY LAW.
 - THE DRAWINGS, SPECIFICATIONS AND ANY SUBSEQUENTLY ISSUED ADDENDA, AMENDMENTS OR SUCH CHANGE ORDERS APPROVED BY THE OWNER AND THE CONTRACTOR ARE PART OF THESE CONTRACT DOCUMENTS.
 - DO NOT SCALE DRAWINGS. CONSULT WITH THE ARCHITECT REGARDING ANY ITEMS IN THE CONTRACT DOCUMENTS THAT REQUIRE CLARIFICATION.
 - TRASH SHALL BE REMOVED FROM THE SITE NOT LESS THAN TWICE MONTHLY.
 - THE GENERAL CONTRACTOR SHALL VERIFY EXISTING CONDITIONS PRIOR TO COMMENCING WORK AND REPORT ANY AND ALL DISCREPANCIES TO THE ARCHITECT.
 - CONTRACTOR VEHICLES AND EQUIPMENT NECESSARY FOR CONSTRUCTION MAY BE PARKED ON THE SITE. OTHER VEHICLES PARKED ON THE SITE REQUIRE THE OWNER'S PERMISSION.
 - NAMING A CERTAIN BRAND, MAKE OR MANUFACTURER IS TO DESIGNATE THE GENERAL STYLE, TYPE, CHARACTER AND QUALITY STANDARD OF THE PRODUCT DESIRED. SUBSTITUTION REQUESTS MUST BE SUBMITTED PRIOR TO BIDDING.
 - ALL MATERIALS/EQUIPMENT SHALL BE INSTALLED PER MANUFACTURER'S RECOMMENDATIONS. WORK NOT CONSISTENT WITH MANUFACTURER'S RECOMMENDATIONS WILL BE REJECTED BY OWNER/ARCHITECT.

DAMMON ENGINEERING, INC.

LOUISIANA & MISSISSIPPI

www.dammonengineering.com
info@dammonengineering.com
PH: 985.649.5832 F: 985.641.5950

Chief Engineer: Brian Misch, PE
554 Old Spanish Trail
Slidell, LA 70458

#	DESCRIPTION	DATE

LESIA CRISTIANO DE CRISTO INC.

1000 CARISO BLVD.
BUILDING 1 UNIT 165
SLIDELL, LA 70461

JOB No: 2454 DATE: 12/07/2021
RJD CHECKED BY: JMS
DRAWN BY: JMS

SHEET TITLE:
GENERAL PROJECT,
LIFE-SAFETY, AND
BUILDING CODE
INFORMATION

DRAWING NUMBER:
GOO1

SHEET No: 1 of 5