

SIMILAR TO REVISED LAYOUT BELOW.

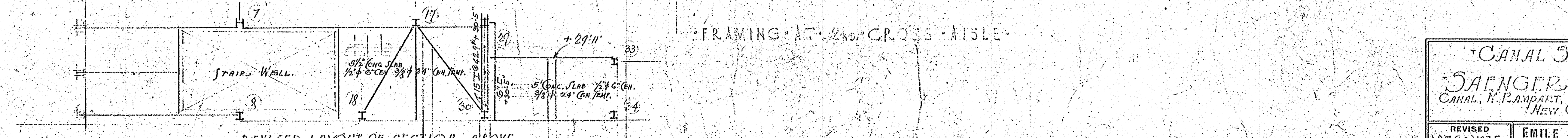
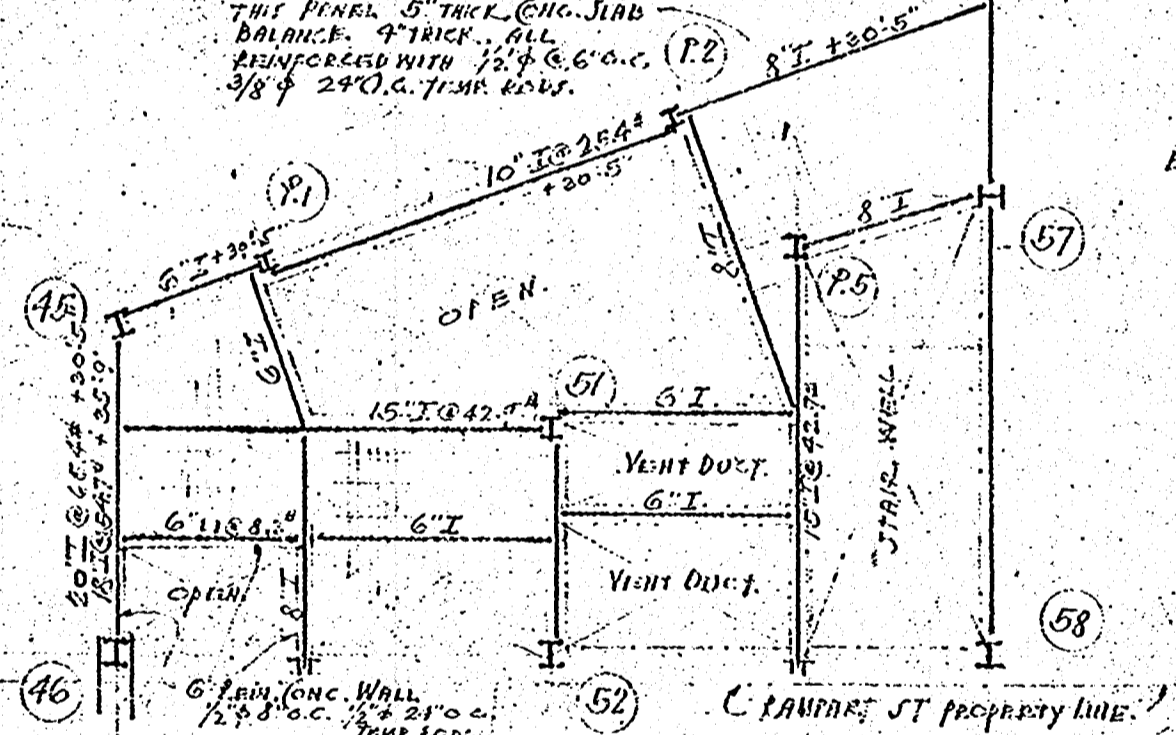
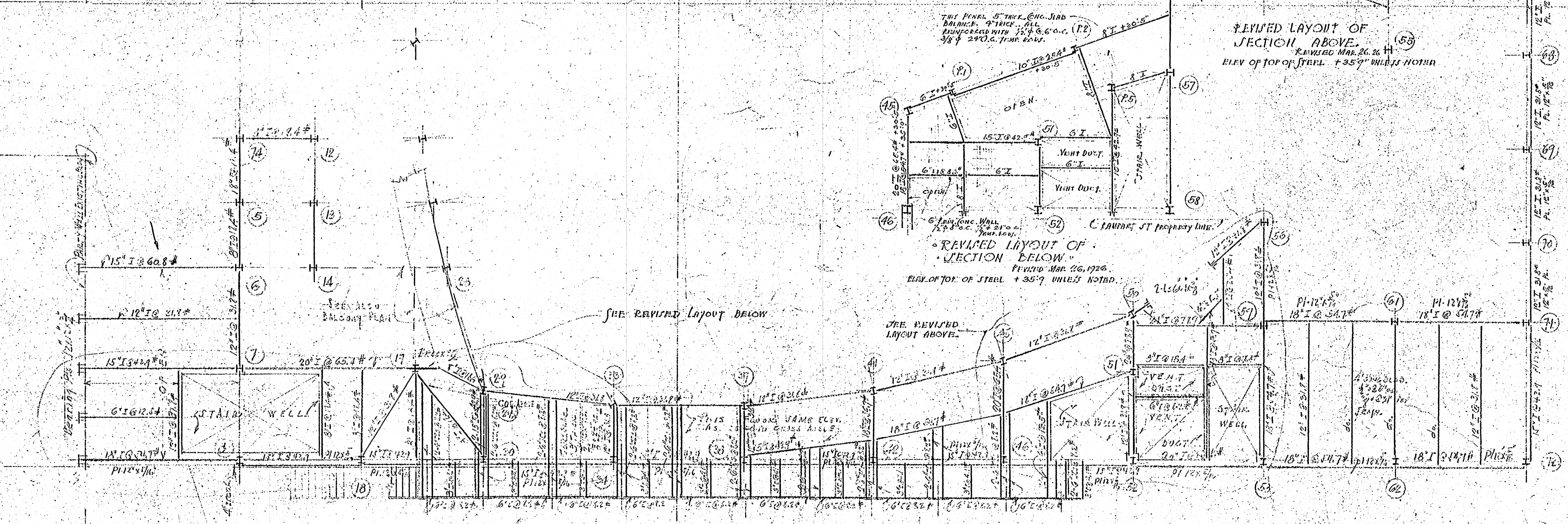
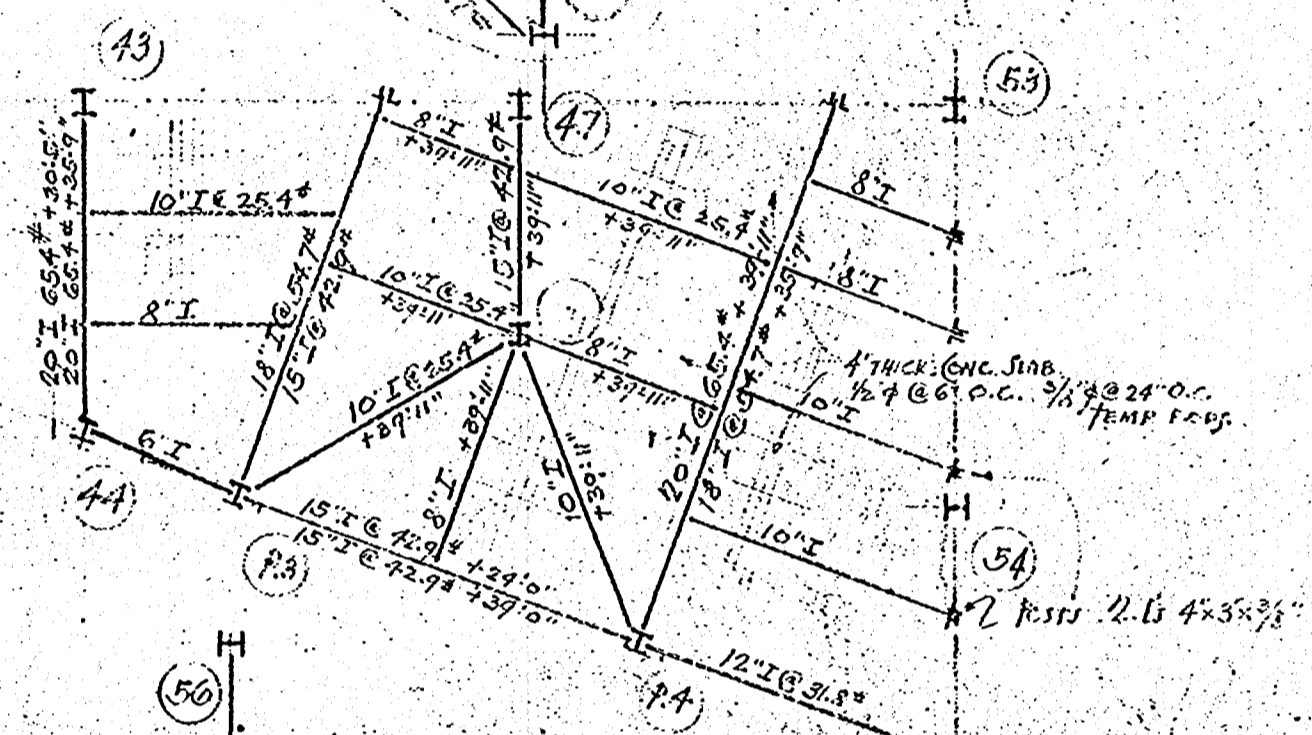
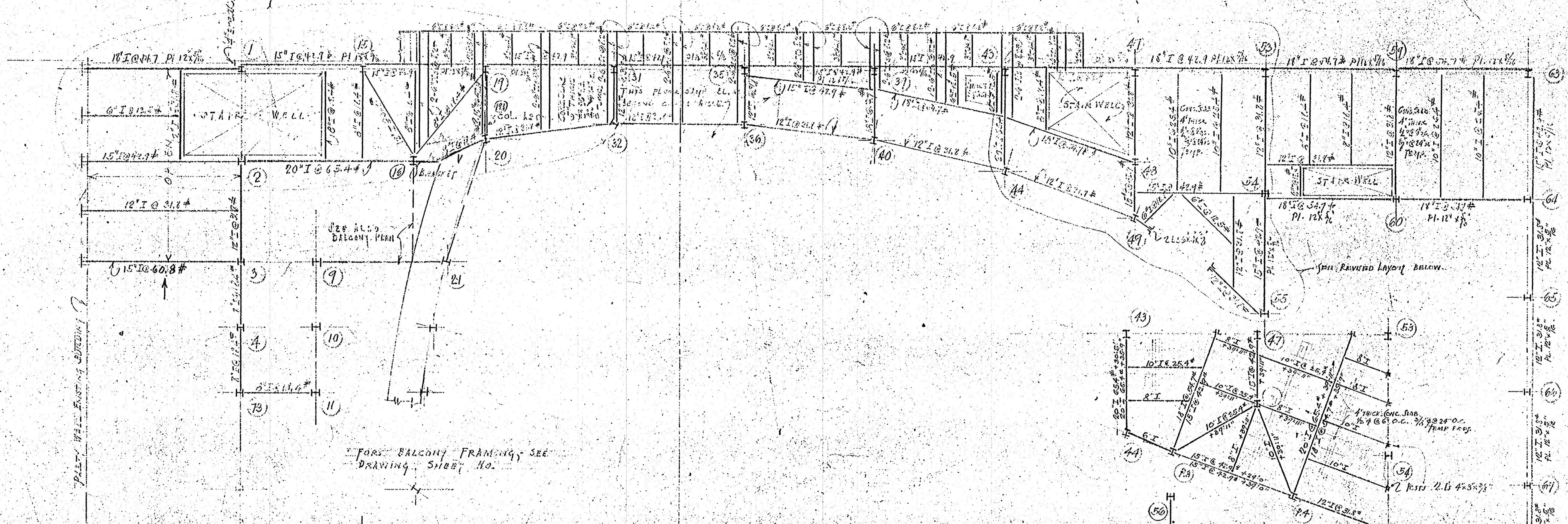

"CANAL STREET THEATRE"
 FOR
SAENGER THEATRES, INC.
 CANAL ST. RAMPART, IBERVILLE ST. N. SHERBOURNE ST.
 NEW ORLEANS, LA.

REVISED
 DEC. 3, 1925
 MAR. 26, 1926

EMILE WEILL ARCHITECTS
 WHITNEY CENTRAL BUILDING
 NEW ORLEANS, LA.

PLAN
 894
 SHEET
 9
 DATE NOV. 28, 1925