

DETAIL OF BALCONY RAIL
SCALE 3/4" = 1"

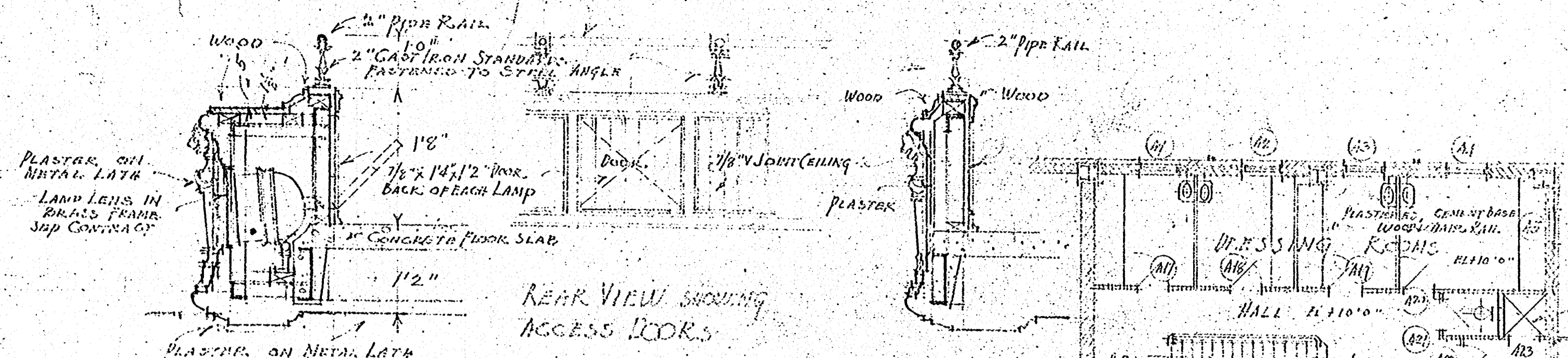

BALCONY RAIL AT CENTER

BALCONY RAIL AT END BOXES

PLAN IN SECOND FLOOR OF DRESSING ROOM

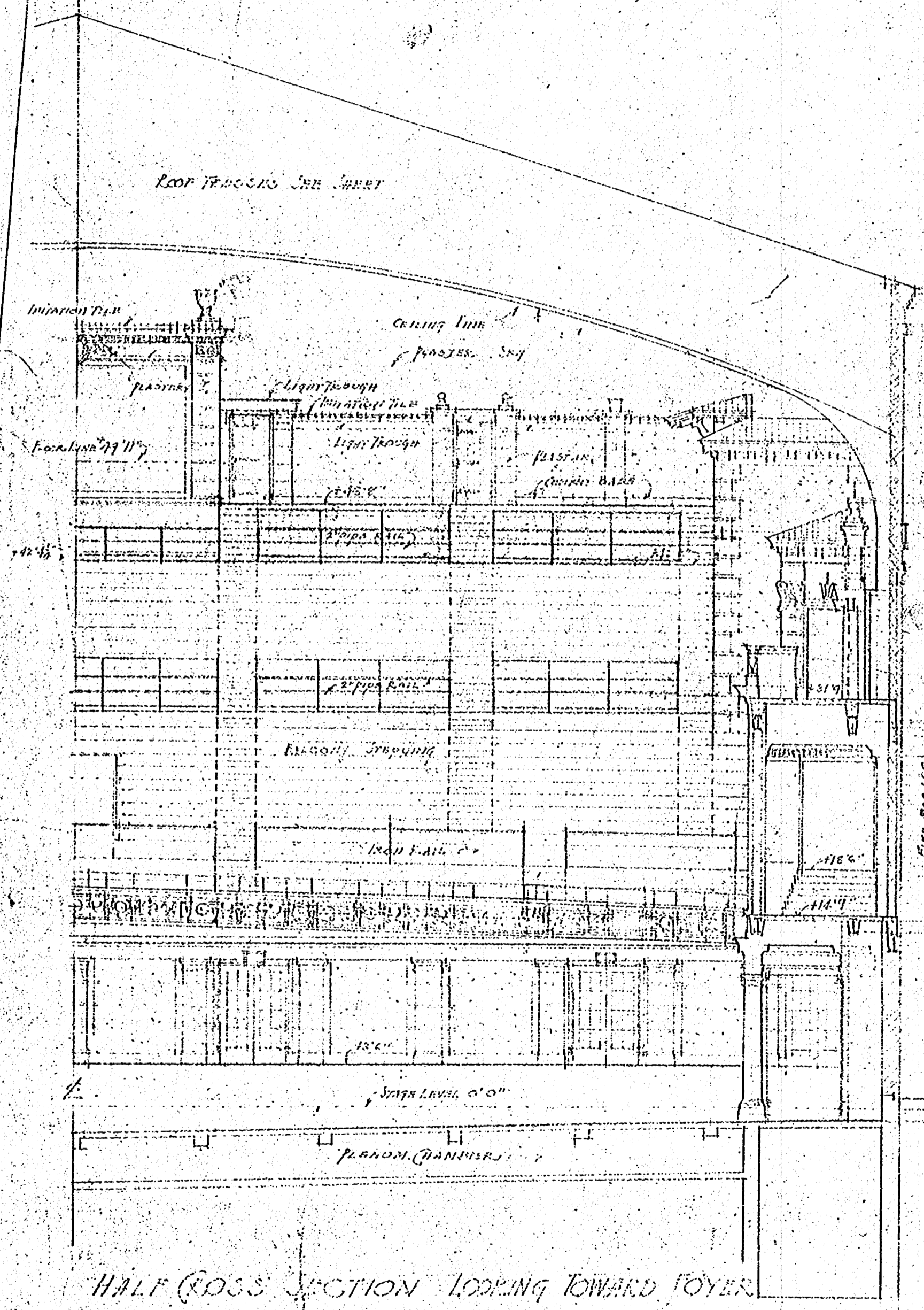

HALF CROSS SECTION LOOKING TOWARD FOYER

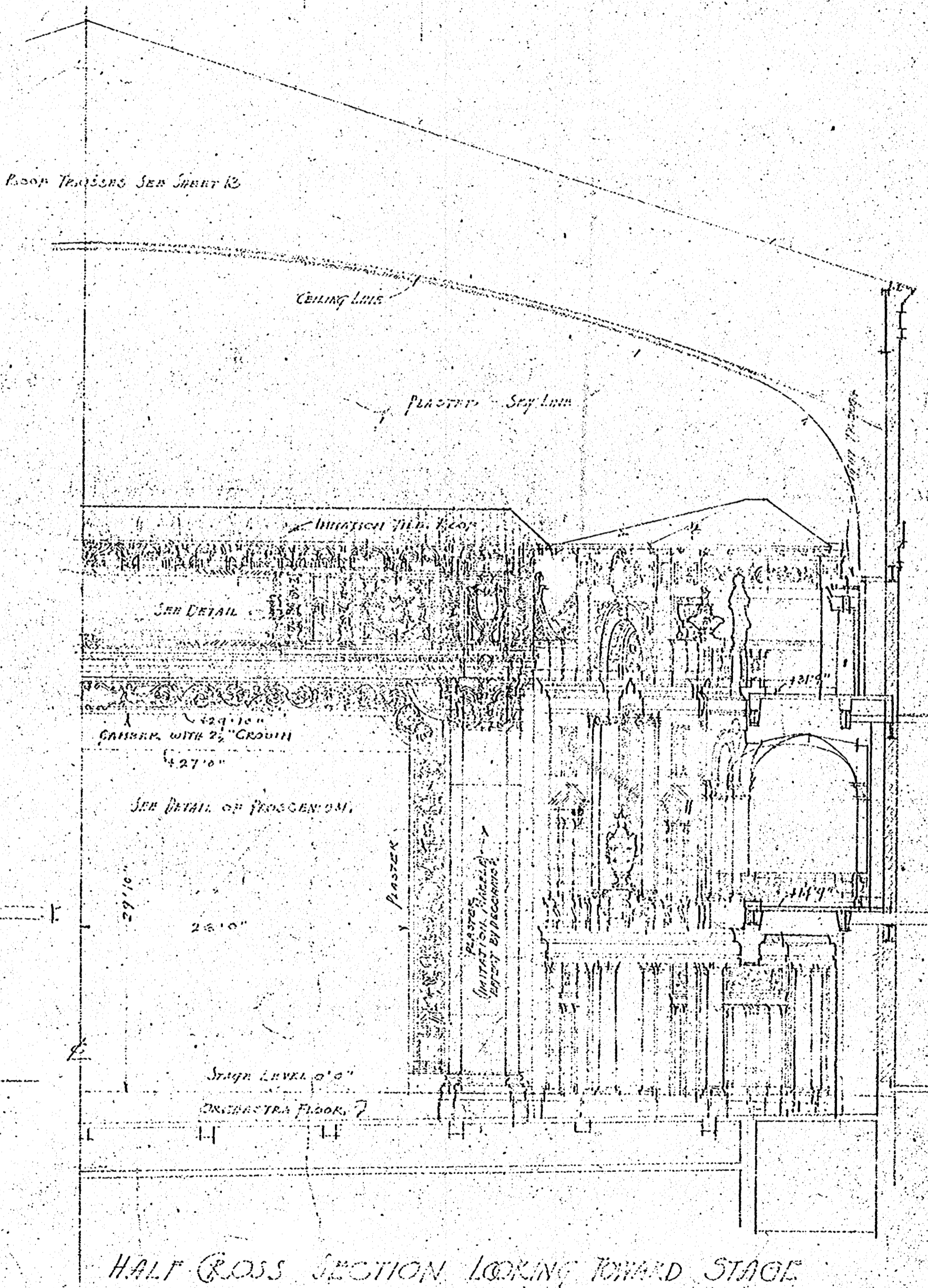

HALF CROSS SECTION LOOKING TOWARD STAGE

UPPER PART OF STAGE

UPPER PART OF STAGE

OPENING SCHEDULE.

A12, A13	2'8\"/>
A14	Opening 2'6\"/>
A15	Two Glass A' fire doors, folding, iron gate, 12\"/>
A16, A17, A18	2'8\"/>
A19, A20	1'8\"/>
A21, A22	3'0\"/>
A23	3'0\"/>

INTERIOR

CANAL STREET THEATRE
SAENGER THEATRES INC.
CANAL, MONROE, N. ROBERT & BARRON STS.
NEW ORLEANS, LA.

REVISED

EMILE WEILL ARCHITECT
WHITNEY CENTRAL BUILDING
NEW ORLEANS, LA.

PLAN SHEET
894 D.
DATE APR. 1917