

FILE NAME: C:\Users\Brett Cabirac\Desktop\Projects\18_SitePlan\18_SitePlan.dwg DATE: 08/01/2025 10:45:32 AM

DESIGN CRITERIA

THE CONSTRUCTION FOR SAID RESIDENCE, WHERE BASIC WIND SPEED IS 130 MILES PER HOUR, WIND EXPOSURE ZONE C, IS DESIGNED IN ACCORDANCE WITH: AMERICAN FOREST AND PAPER ASSOCIATION (AF&PA) WOOD FRAME CONSTRUCTION MANUAL FOR ONE AND TWO FAMILY DWELLINGS (WFCM) 2001 EDITION AS WELL AS THE INTERNATIONAL RESIDENTIAL CODE (IRC) 2021 EDITION

PLANNING

ZONED C3 DISTRICT

FLOOD ZONE

ZONE "AE"

BUILDING ELEVATION

BASE FLOOD ELEVATION "AE" = 11.0'
FINISHED FLOOR ELEVATION = 13.0'

SETBACK LIMITS

FRONT - 20 FT.
SIDES - 20% LOT WIDTH WITH 5FT. MINIMUM
REAR - 20% LOT DEPTH WITH 25FT. MINIMUM AND 50FT. MAX

LEGEND

- PROPERTY LINE
- - - SETBACK LINE
- STORM DRAIN LINE
- POWER LINE
- FENCE LINE

SHEET INDEX

SHEET #	SHEET TITLE
C101	SITE PLAN
A101	FLOOR PLAN
A102	GROUND FLOOR PLAN
A103	ELEVATION PLAN
A104	INTERIOR ELEVATION PLAN
S101	FOUNDATION PLAN
S102	FRAMING PLAN
S103	TYPICAL CONNECTION DETAILS

DAMMON
ENGINEERING, INC.
LOUISIANA & MISSISSIPPI

www.dammonengineering.com
info@dammonengineering.com
Chief Engineer: Brian Wistich, PE
554 Old Spanish Trail
Slidell, LA 70468
PH: 985.649.9332

ROBERT STREET

NEW RESIDENCE

SECOND STREET

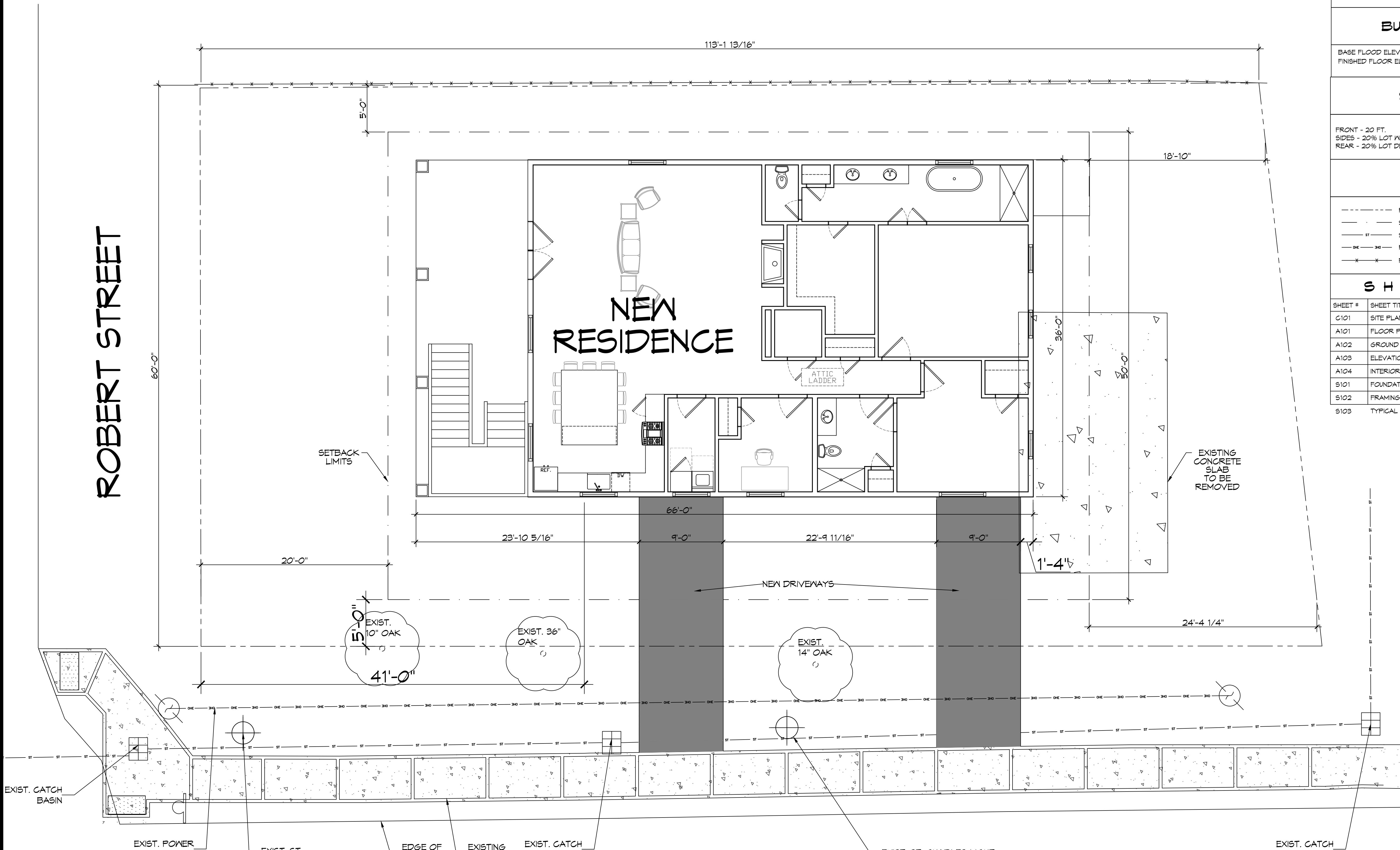

1 SITE PLAN
SCALE: 3/16" = 1'-0"

OVERALL SITE PLAN

#	DESCRIPTION	DATE

SEAL:

BRETT CABIRAC
LOT 5 SQUARE 24
ROBERT STREET
SLIDELL, LA 70468
JOB No: 25-01-2025
DATE: 08-01-2025
DRAWN BY: BAW
CHECKED BY: CKD

SHEET TITLE:
SITE PLAN

DRAWING NUMBER:
C101

SHEET No: 1 of 2