

**DAMMON**  
ENGINEERING, INC.

CHIEF ENGINEER  
EMMETT  
DAMMON, P.E.  
CHIEF ARCHITECT  
ROBERT  
WILTSE

1095 FLORIDA AVENUE  
SUDBELL, LA, 70450  
OFFICE: 985-649-5632  
FAX: 985-641-5950

WEBSITE:  
WWW.DAMMONENGINEERING.COM  
EMAIL:  
DAMMONENG@BELL.SOUTH.NET

ARCHITECTURE  
ENGINEERING  
STUDIES  
PLANNING  
INVESTIGATION  
EXPERT WITNESS

STRAIN RESIDENCE  
LOT 31  
NEW ARBOR LAKES  
POPLARVILLE, MS

FLOOR  
LEVEL  
FOUNDATION  
PLAN

REV.: 10-02-08

SCALE: AS NOTED

JOB#: 1990

DATE: 09-22-08

SHEET

S-1

OF

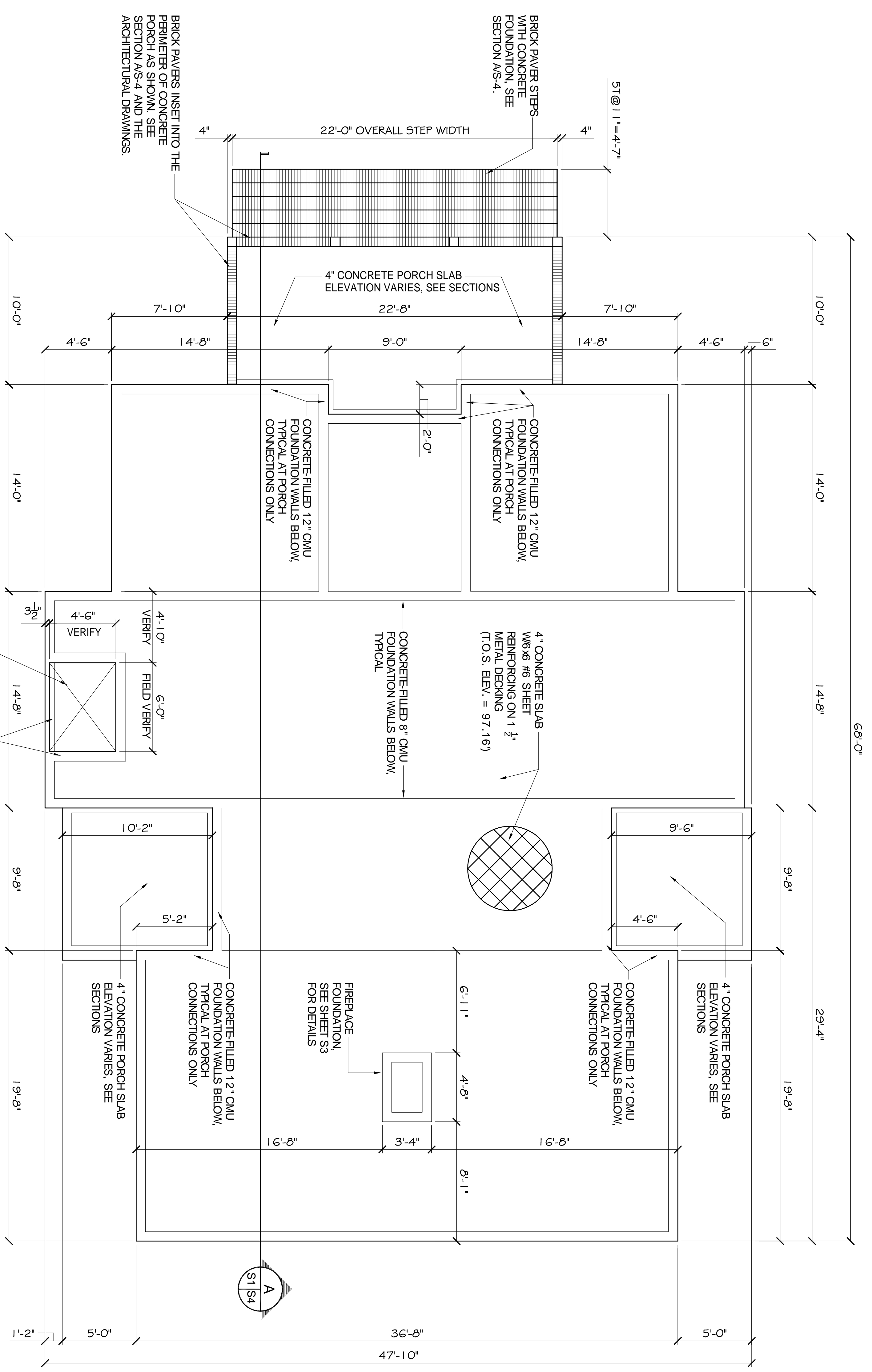

FOUNDATION PLAN AT FLOOR LEVEL  
SCALE: 1/4" = 1'

- NOTES:
1. CONTRACTOR SHALL FIELD VERIFY ALL DIMENSIONS & DEPRESSIONS PRIOR TO COMMENCING WORK
  2. MUCK OUT 24" DEEP FOR FOUNDATION PAD MINIMUM OR TO UNDISTURBED SOIL CAPABLE OF 1500 PSF BEARING.
  3. DIRT SHALL BE INSTALLED IN 6" LIFTS AND COMPACTED TO 95% PROCTOR.
  4. TREAT SOIL BELOW SLAB FOR TERMITES.
  5. CONCRETE MIX SHALL BE 3000 PSI, MINIMUM.
  6. NO FIELD SUPERVISION OR INSPECTION PROVIDED UNDER THIS SEAL UNLESS NOTED OTHERWISE
  7. THIS SUPPORTED FOUNDATION IS DESIGNED TO MEET THE GENERAL SOIL CONDITIONS OF THE AREA OF WORK. THE CONTRACTOR OR OWNER IS ADVISED THAT A SOILS ANALYSIS SHOULD BE MADE TO CONFIRM THE DESIGN.
  8. AS A MINIMUM, INSTALLATION OF RIGID FLOOR TILES, BRICK, ETC., SHALL BE OVER AN ELASTIC BOND BREAKER. ANY CRACKS IN CONCRETE FLOOR SHALL BE TREATED PRIOR TO INSTALLATION OF TILES. ELASTOMERIC ADHESIVE IS RECOMMENDED FOR CERAMIC FLOOR TILES. WHERE DECORATIVE CONCRETE IS USED, ADDITIONAL REINFORCEMENT WILL BE REQUIRED.