

**SITE PREPARATION NOTES:**

1. REMOVE TOP SOIL (8" TO 12")
2. COMPACT SUBBASE TO 95% MAXIMUM DENSITY (D-698).
3. PLACE FILL DIRT (A-4) MATERIAL OR BETTER IN 8" LIFTS COMPACTED TO 95% MAX. DENSITY. CONFIRM W/TESTING.

**TEST DOCUMENTATION TO BE PROVIDED TO ENGINEER:**

1. SUBBASE COMPACTION TEST RESULTS
2. FILL COMPACTION TEST RESULTS
3. SLUMP TEST RESULTS
4. CYLINDER RESULTS

**CONCRETE NOTES:**

1. REFER TO BUILDING PLANS FOR DOOR OPENINGS AND EXACT DIMENSIONS.
2. USED CONCRETE BRICK SUPPORTS TO MAINTAIN REINFORCING CLEARANCES. DO NOT USE CMU OR FACE BRICKS.
3. FOUNDATION DESIGN BASED ON A-4 FILL DIRT COMPACTED TO 95% DENSITY (ASTM D-1957). FILL PLACED @ 8" LIFTS.
4. ALL CONCRETE SHALL DEVELOP 3000 PSI COMPRESSIVE STRENGTH @28 DAYS. PLACE CONCRETE W/ MAXIMUM SLUMP OF 6". PROVIDE SLUMP TEST AND CYLINDERS AT BEGINING AND MIDPOINT OF POUR.
5. GRADE 40 DEFORMED REINFORCING.
6. ASTM-185 WWF REINFORCING
7. APPLY A LIQUID MEMBRANE CURING CHEMICAL TO ALL CONCRETE SURFACES IN ACCORDANCE WITH MANUFACTURER'S RECOMMENDATIONS. W.R. GRADE OR EQUAL.
8. CONTRACTOR SHALL COORDINATE ALL DOOR LOCATIONS AND OMIT NOTCHES ACCORDINGLY.
9. INTERIOR GRADE BEAMS ARE TO BE CENTERED ON INTERIOR WALLS. REFER TO BUILDING PLANS FOR LAYOUT OF GRADE BEAMS.

**IRC 2021 NOTES**  
SECTION 301 - DESIGN LIVE LOAD = 100 PSF

SECTION 401 - FOUNDATION DESIGN BASED ON AN ALLOWABLE BEARING PRESSURE OF 1500 PSF

SECTION 402  
- 3,000 PSI CONCRETE  
SECTION 403  
- 12" MINIMUM FOOTING WIDTH  
- ANCHOR FLOOR PLATES TO SLAB WITH 5/8" A307 ANCHOR BOLTS (3" LEG) WITH A MINIMUM EMBEDMENT OF 7" WITH 3" X 3" X 1/8" WASHERS SPACED @ 12" O.C.  
- BEGINNING 12" FROM THE CORNER AND RUNNING FOR 4'-0". BEYOND 4'-0" FROM THE CORNER, SPACE THE BOLTS @ 36" O.C. MAX.

SECTION 404  
- CONCRETE SHALL CONFORM TO ACI 318, LATEST EDITION  
- SLUMP NOT TO EXCEED 6"  
- 3" COVER FOR REINFORCING, TOP AND SIDES

SECTION 506  
- MINIMUM FLOOR THICKNESS 3.5"  
- 6 MIL VAPOR BARRIER REQUIRED.

SECTION 811  
- 25" LAP WITH 2 TIES REQUIRED AT REINFORCING SPLICES.  
- 12" HOOK REQUIRED AT CORNERS

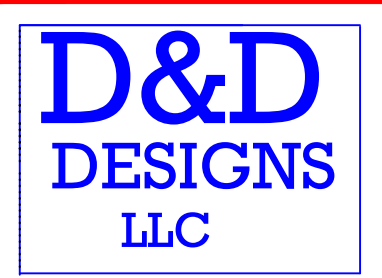
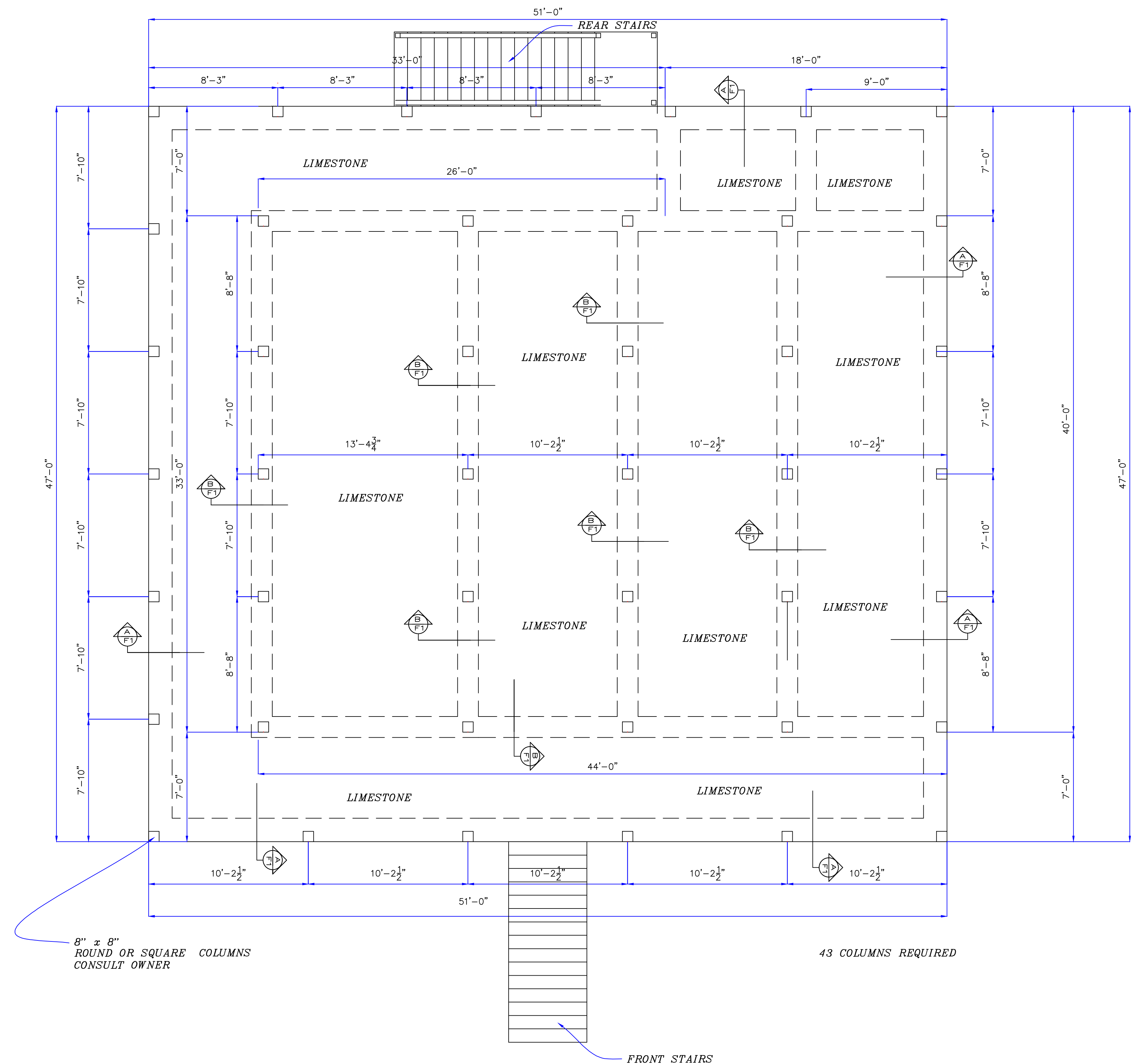
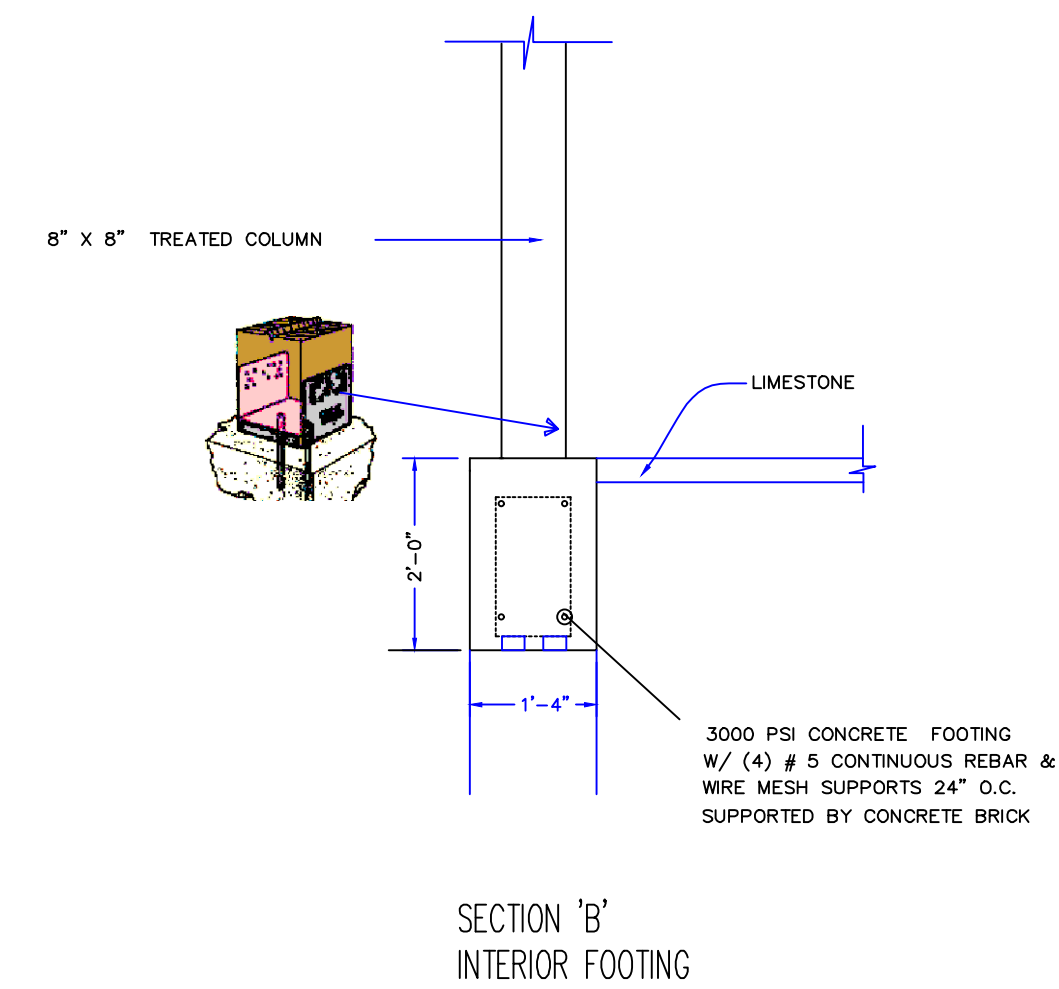
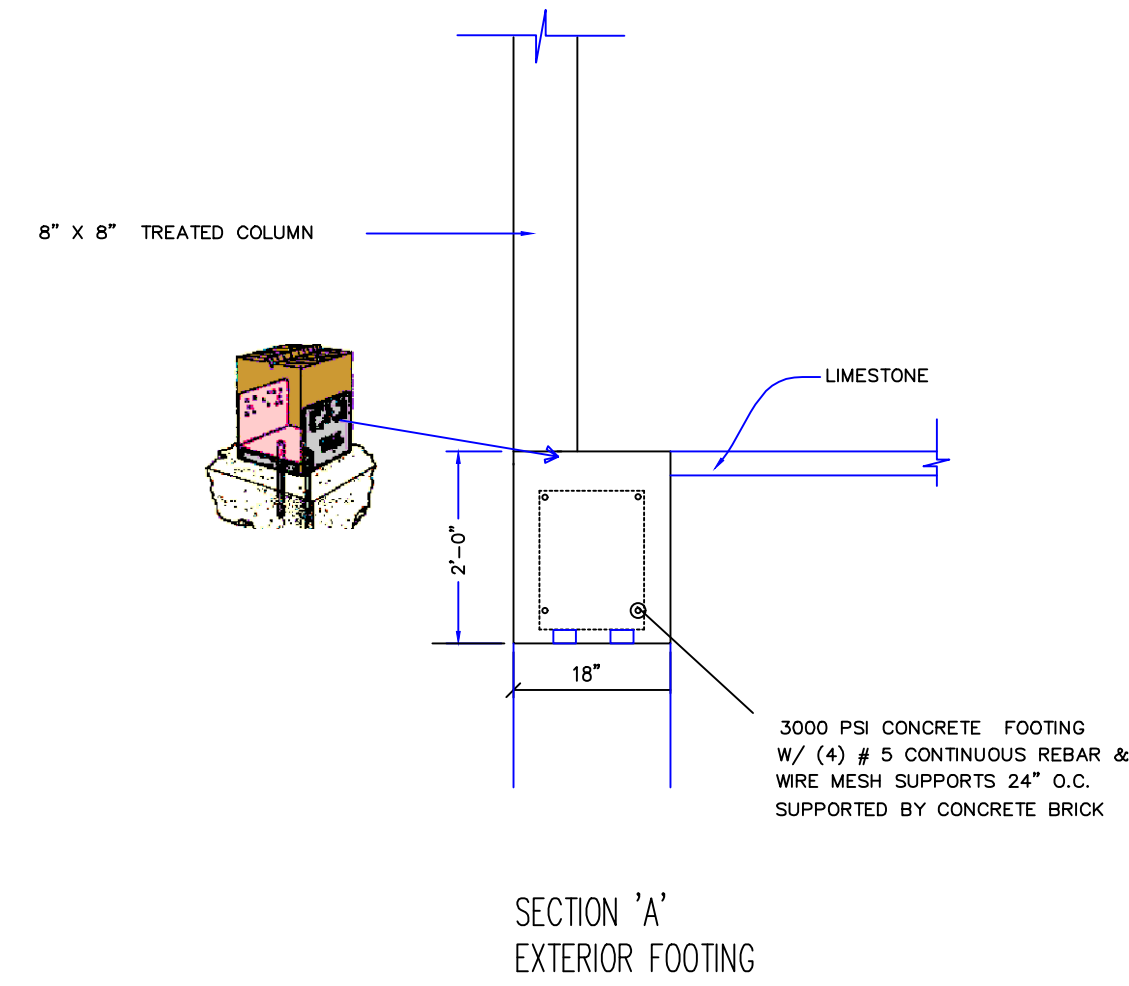

22247 7TH. STREET  
ABITA SPRINGS, LA  
70420  
(985) 893-2074

**DRAWING RELEASED FOR:**

- PRELIMINARY - NOT FOR CONSTRUCTION
- PRICING: NOT FOR CONSTRUCTION
- FOR CONSTRUCTION

**DRAWING RELEASE DATES**

NO.	DATE	PURPOSE
1.	4-17-2023	
2.	4-18-2023	
3.	4-19-2023	
4.	4-20-2023	
5.		
6.		

JOHN AND LAURA FONTENOT

SHEET NO. 1

1. CONCRETE NOTES

2. FOOTING DETAILS  
SCALE 1/2" = 1'-0"

3. FOUNDATION PLAN  
SCALE 1/4" = 1'-0"