

roof plan

scaled at 1/8" = 1'-0"

GENERAL ROOF NOTES:

ROOFING INSTALLATION SHALL MEET ALL REQUIREMENTS TO MEET IBHS FORTIFIED ROOF 2020 STANDARDS.

ROOF SHEATHING SHALL BE 5/8" OSB WITH FOIL BACKING. USE MINIMUM 8D X 2-3/8" LONG ROOF SHEATHING RING-SHANK NAILS FOR CONNECTION OF ALL SHEATHING. RING-SHANK NAILS SHOULD COMPLY WITH ASTM F1667. TAPE ALL SEAMS WITH 4" SELF-ADHERING TAPE AND SEAL DECK PER FORTIFIED ROOF 2020 STANDARDS.

ALL ROOFS SHALL HAVE 2 LAYERS OF UNDERLAYMENT UNDERLAYMENT SHALL MEET 2 LAYERS ASTM D226 TYPE II #30 ASTM D4869 TYPE III OR TYPE IV #30 UNDERLAYMENT INSTALL PER FORTIFIED ROOF 2020 STANDARDS. EDGES SHALL BE SEALED AND DRIP EDGE INSTALLED TO MEET FORTIFIED ROOF 2020 STANDARDS. PROVIDE ADDITIONAL UNDERLAY AT ANY PITCH LESS THAN 4 ON 12.

ALL ROOFS SHALL HAVE 2 LAYERS OF UNDERLAYMENT ROOFING SHALL BE MINIMUM 30 YEAR ASPHALT SHINGLES INSTALLED TO MEET FORTIFIED ROOF 2020 STANDARDS.

RIDGE AND OFF-RIDGE VENTS MUST BE TAS 100(A) RATED AND ANCHORED IN COMPLIANCE WITH MANUFACTURER RECOMMENDATIONS FOR HIGH WINDS. IN LOCATIONS WITH CLAY RIDGE TILE, PROVIDE LINEAR ROOF VENTS ALONG RIDGE AS REQD FOR VENTILATION

ALL ROOF PROTRUSIONS SHALL BE LOCATED ON REAR ROOF SURFACES AND PAINTED TO MATCH ROOFING.

PROVIDE MECHANICAL VENTILATION AS REQUIRED TO VENT ROOF

DOOR SCHEDULE

MARK	SIZE	THICK	DESCRIPTION
1	3'-0" X 8'-0"	1 3/4"	2 PANEL, FIBERGLASS, EXTERIOR GRADE, 20 MIN RATING
2	6'-0" X 9'-0"	1 3/4"	PAIR, FIBERGLASS, EXTERIOR GRADE, 1 LITE, FULL GLASS
3	6'-0" X 8'-0"	1 3/4"	PAIR, 2 PANEL, FIBERGLASS, EXTERIOR GRADE
4	3'-0" X 8'-0"	1 3/4"	FIBERGLASS, EXTERIOR GRADE, 1 LITE, FULL GLASS
5	2'-8" X 8'-0"	1 3/4"	2 PANEL, FIBERGLASS, EXTERIOR GRADE
6	2'-4" X 8'-0"	1 3/4"	2 PANEL, FIBERGLASS, EXTERIOR GRADE
7	3'-0" X 8'-0"	1 3/8"	2 PANEL, SMOOTH MASONITE FACE, INTERIOR GRADE
8	2'-8" X 8'-0"	1 3/8"	2 PANEL, SMOOTH MASONITE FACE, INTERIOR GRADE
9	2'-4" X 8'-0"	1 3/8"	2 PANEL, SMOOTH MASONITE FACE, INTERIOR GRADE
10	3'-0" X 8'-0"	1 3/8"	2 PANEL, SMOOTH MASONITE FACE, INTERIOR GRADE, POCKET
11	4'-0" X 8'-0"	1 3/8"	PAIR, 2 PANEL, SMOOTH MASONITE FACE, INTERIOR GRADE
12	3'-0" X 8'-0"	1 3/8"	PAIR, 2 PANEL, SMOOTH MASONITE FACE, INTERIOR GRADE
13	4'-6" X 8'-0"	1 3/8"	CUSTOM BARN DOOR ON SURFACE MOUNT TRACK, AS SELECTED BY OWNER
14	3'-0" X 8'-0"	1 3/4"	2 PANEL, FIBERGLASS, EXTERIOR GRADE
15	6'-0" X 8'-0"	STD	OVERHEAD GARAGE DOOR W/ AUTO OPENER, 140 MPH PRESSURE RATED

WINDOW SCHEDULE

MARK	SIZE	LITES	DESCRIPTION
A	5'-0" X 6'-0"	1/1	FIXED, VINYL, INSULATING W/ 5'-0" X 2'-0", 1-LITE TRANSOM, MULLED
B	2 - 5'-0" X 6'-0"	1/1	PAIR, FIXED, VINYL, INSULATING W/ 5'-0" X 2'-0", 1-LITE TRANSOM, MULLED
C	8'-0" X 5'-6"	1	FIXED, VINYL, INSULATING
D	5'-0" X 5'-0"	1	FIXED, VINYL, INSULATING - TEMPERED
E	3 - 4'-0" X 6'-0"	1/1	TRIPLE, FIXED, VINYL, INSULATING W/ 4'-0" X 2'-0" 1-LITE TRANSOMS, MULLED
F	4'-0" X 6'-0"	1/1	FIXED, VINYL, INSULATING W/ 4'-0" X 2'-0" 1-LITE TRANSOM, MULLED
G	3'-0" X 5'-6"	1	CASEMENT, VINYL, INSULATING
H	3'-0" X 5'-0"	1	FIXED, VINYL, INSULATING
J	3'-0" X 5'-0"	1	CASEMENT, VINYL, INSULATING

WINDOW NOTES:

- ALL WINDOWS TO HAVE 2" BRICK MOULD TRIM, TYPICAL.
- ALL WINDOW UNITS SHALL MEET ALL LOCAL WIND AND ENERGY REQUIREMENTS AS PER IRC 2021
- ALL WINDOWS SHALL HAVE BOTH INTERIOR AND EXTERIOR APPLIED, RAISED PROFILE MULLIONS
- TEMPERED GLAZING REQUIRED AS PER IRC 2021 R308.4.3 AT LOCATIONS AS LISTED.
- WINDOW MANUFACTURER TO PROVIDE AS REQUIRED.
- 1- PANE IS LARGER THAN 9 SQ FT
- 2- BOTTOM EDGE OF GLASS IS LESS THAN 18" AFF
- 3- TOP EDGE OF GLASS IS MORE THAN 36" AFF
- 4- ONE OR MORE WALKING SURFACE IS WITHIN 36" OF THE WINDOW
- 5- ALL DOOR GLAZING SHALL BE TEMPERED
- 6- ALL GLAZING WITHIN 24" OF A DOOR

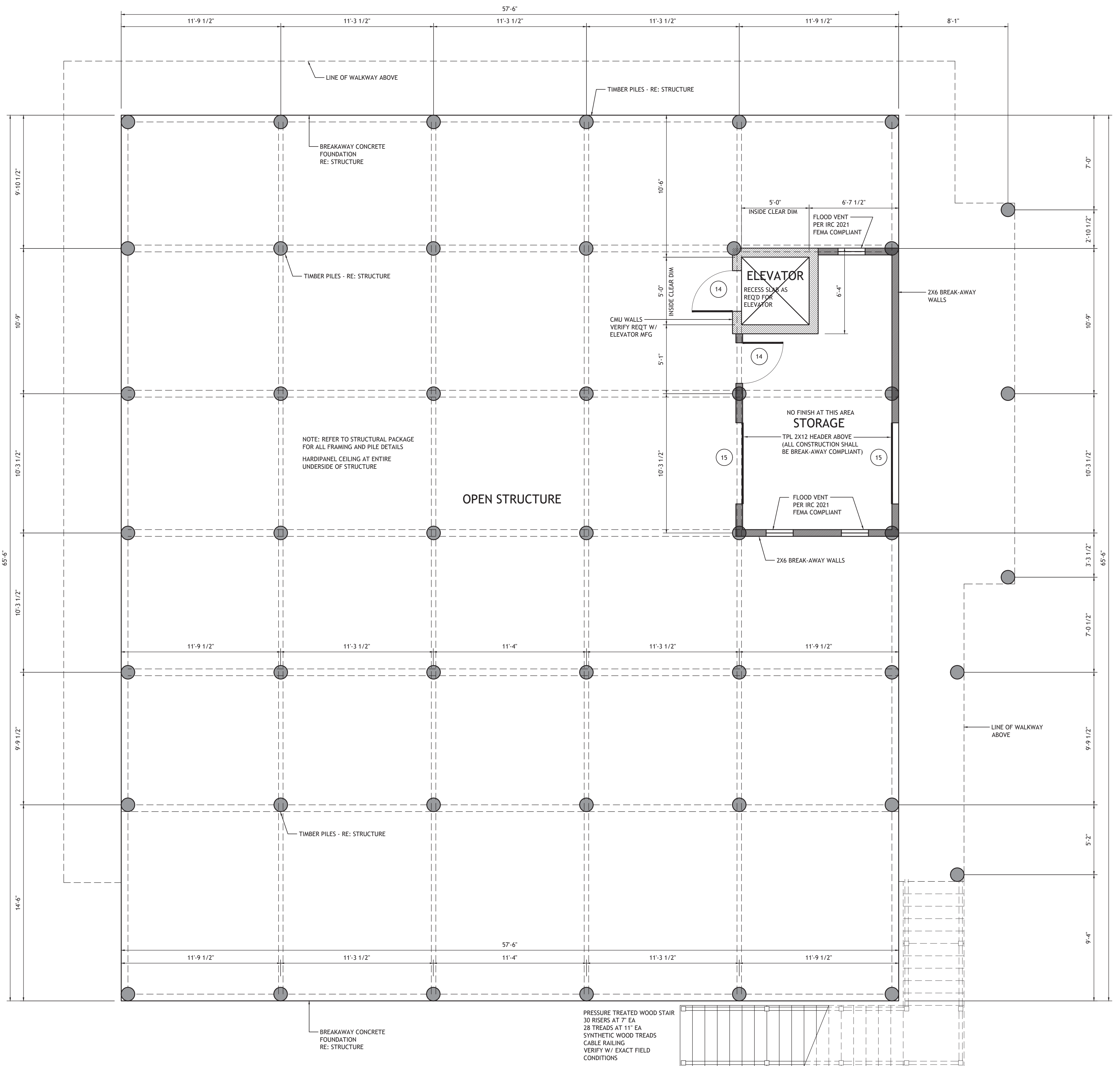

floor plan - grade level

scaled at 1/4" = 1'-0"

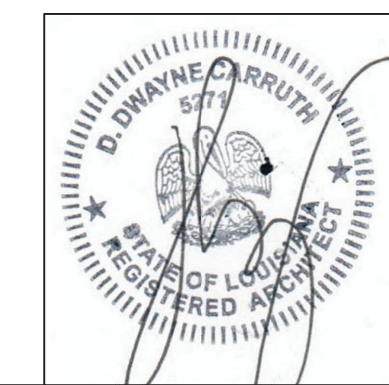

builder shall be allowed to deviate from all plans and specifications in such that given changes do not affect structural or design integrity - builder shall verify all dimensions - plans remain the property of the front door design studio and are released for the sole residence hereby noted - illegal use of drawings will be prosecuted

lot 55, treasure isle
slidell, louisiana

the divincinti residence

project 21-154

thefrontdoor **fd**
design studio
1010 nicholson drive . baton rouge . 225 . 338 . 9353 www.thefrontdoor-architecture.com

december 11, 2023
june 28, 2024
july 17, 2024

a-1.4