

EXISTING 200 AMP SERVICE
AND METER TO REMAIN

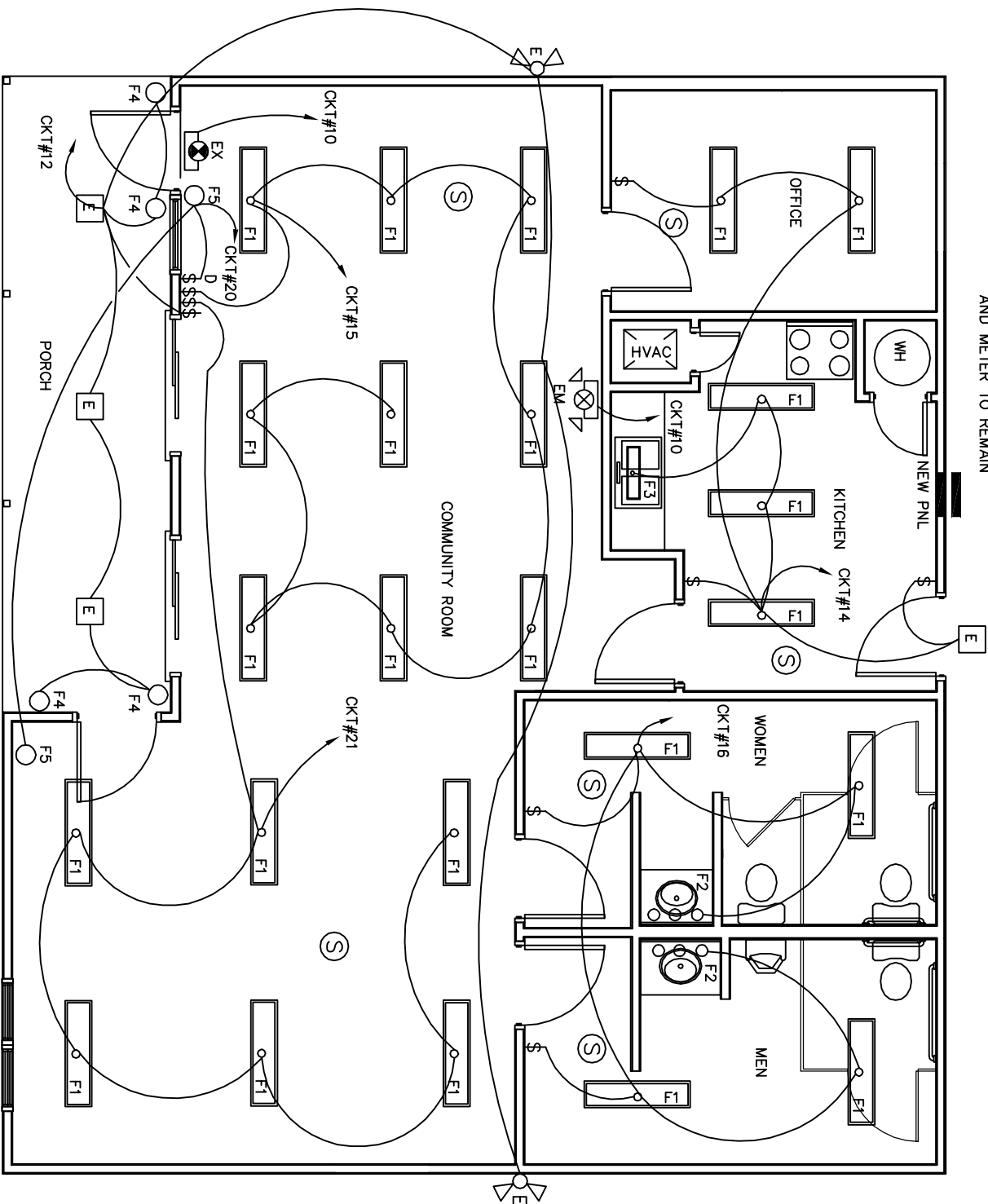

LIGHTING PLAN

SCALE - 1/4" = 1'

- F1 323765
- F2 320233
- F3 310288
- F4 326908
- F5 326503

- E EXISTING TO REMAIN
- EM EMERGENCY EGRESS LIGHT
W/ 90 MIN. BATTERY BACKUP
EELP LIGHTING EM-KR5-NI
- EX WALL MOUNTED LED EXIT SIGN
EELP LIGHTING XE2 R WE EM

PANEL: LP-1		LOCATION: KITCHEN		FEEDER SOURCE: CLECO		VOLTAGE: 120/240V, 200A 1Ø, 3W, MLO				
		FLUSH MOUNTED W/EQUIPMENT GND BAR								
QCT. NO.	WIRE SIZE	LOAD DESCRIPTION	BREAKER AMP	POLE	LOAD (VA)	BREAKER POLE AMP	LOAD DESCRIPTION	THREE PHASE SIZE	QCT. NO.	
1	#6	AHU #1 10 KW	60	2	5000	40	A/C COMPRESSOR #1	#8	2	
3	#12	COMMUNITY ROOM RECEPTACLES	20	1	5000	40	COMMUNITY ROOM RECEPTACLES	#12	4	
5	#12	OFFICE ROOM RECEPTACLES	20	1	1120	20	COMMUNITY ROOM RECEPTACLES	#12	6	
7	#12	OFFICE ROOM RECEPTACLES	20	1	960	20	KITCHEN ROOM RECEPTACLES	#12	8	
9	#8	STOVE	50	2	6000	20	EXIT LIGHT & EMERGENCY LIGHT	#12	10	
11	#12	REFRIGERATOR RECEPTACLE	20	1	6000	20	EXTERIOR LIGHTS FRONT PORCH	#12	12	
13	#12	COMMUNITY ROOM LIGHTS	20	1	180	20	KITCHEN/OFFICE LIGHTS	#12	14	
15	#8	WATER HEATER 30 GALLON	30	2	1800	20	MEN/WOMEN LIGHTS	#12	16	
17	#8	COMMUNITY ROOM LIGHTS	30	2	3800	20	MICROWAVE/GRIT	#12	18	
19	#12	COMMUNITY ROOM LIGHTS	20	1	1200	20	WALL SCONCES	#12	20	
21	-	BLANK	-	-	-	-	BLANK	-	22	
23	-	BLANK	-	-	-	-	BLANK	-	24	
TOTAL CONNECTED LOAD (VA) =					A4=		B4=		GROUND BUS GROUND WIRE (Ø)	