

LEGEND

TO BE DEMOLISHED - - - - -

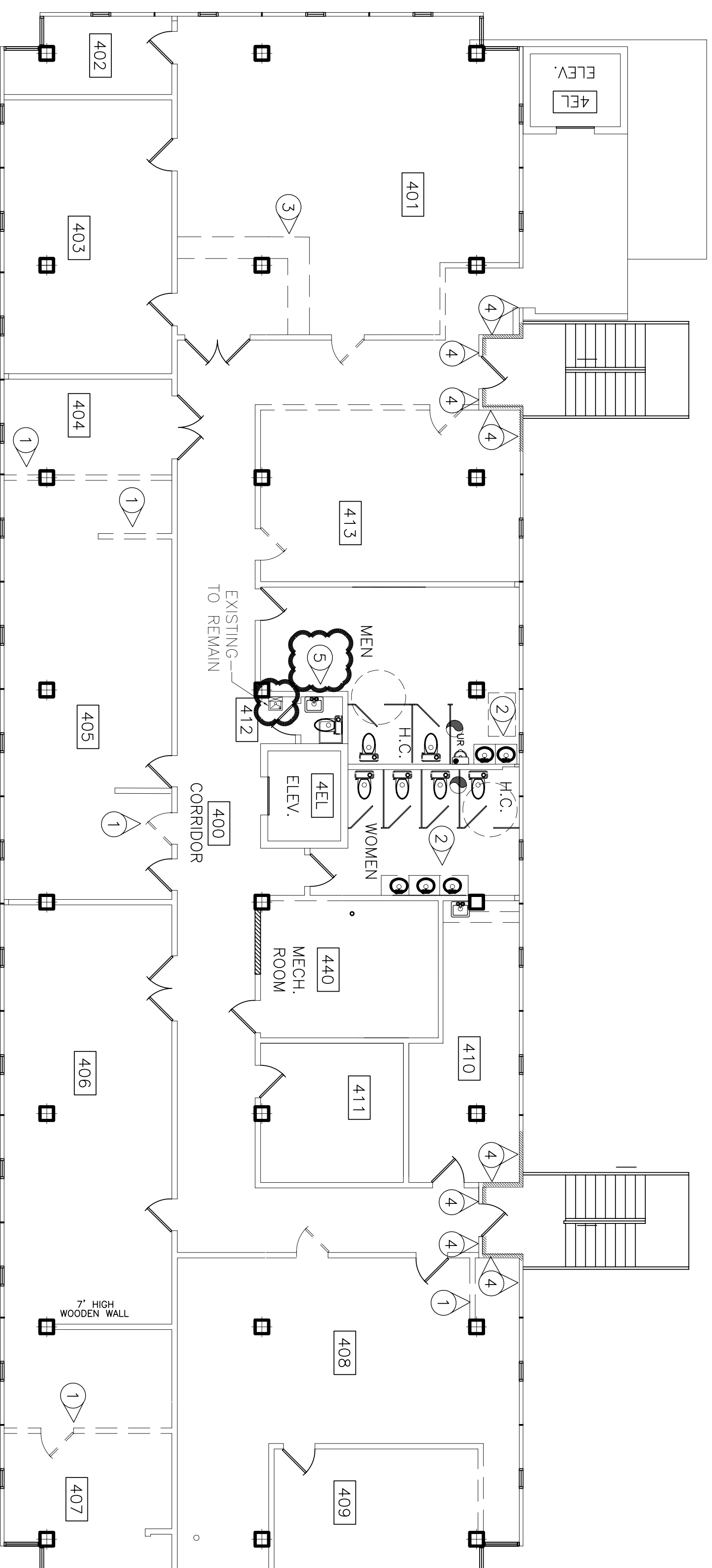

4TH FLOOR
DEMOLITION PLAN
SCALE: 1/8" = 1'-0"

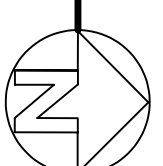

DEMOLITION NOTES 4TH FLOOR

SEE GENERAL NOTES FOR WORK APPLYING TO ALL FLOORS.

- 1. REMOVE EXISTING WALLS & DOORS.
- 2. REMOVE ALL EXISTING LAVATORIES; UNUSABLE WATER CLOSETS, URINALS & PARTITIONS. PROTECT PIPING FOR RENOVATIONS
- 3. REMOVE EXISTING COUNTER.
- 4. REMOVE WALLS IN THESE AREAS FOR INSTALLATION OF 1 HR. FIREWALL.
- 5. REMOVE EXISTING LAVATORY AND WATER CLOSET IN ROOM 412.

GENERAL NOTES - ALL FLOORS

1. ALL DEMOLITION SHALL BE PERFORMED WITH AN UNDERSTANDING OF THE NEW WORK TO BE ACCOMPLISHED IN THIS PROJECT. AS IT PERTAINS TO THE AREA OF DEMOLITION, REPORT ANY VARIANCES TO THE ABOVE TO THE ENGINEER PRIOR TO STARTING ANY WORK.
2. REMOVE ALL A/C SYSTEM COMPONENTS ON EACH FLOOR, INCLUDING:
 - A. WATER COOLED DX UNITS. REMOVE SUPPLY & RETURN HOT & COOLING WATER PIPING, INCLUDING RISERS.
 - B. DEMOLISH AIR HANDLER, COOLING & HEATING COILS, FRAME, RETURN AIR PLENUM & REGISTER, ETC. TO PREPARE FOR NEW SYSTEM.
 - C. DEMOLISH ALL WIRING ASSOCIATED WITH COOLING SYSTEM. REMOVE THERMOSTATS & WIRING.
3. REMOVE SUSPENDED CEILINGS FROM ALL ROOMS & HALLWAYS & REMOVE EXISTING SUPPLY DUCT SYSTEM.
4. REMOVE ALL VINYL TILE & CARPET.
5. PROTECT ALL FLOOR & WALL SURFACES THAT ARE TO REMAIN FOR REFURBISHMENT.
6. THE CONTRACTOR SHALL PROVIDE ALL DEMOLITION REQUIRED TO PERFORM THE WORK SHOWN ON THE DESIGN DRAWINGS AS WELL AS WORK SHOWN ON DEMOLITION DRAWINGS.
7. CUTTING & PATCHING SHALL BE PERFORMED AS REQUIRED TO MEET THE NEEDS OF THE PROJECT. TO PROVIDE A COMPLETE & OPERABLE BUILDING. NO CUTTING OF STRUCTURAL SUPPORTS SHALL BE INITIATED WITHOUT PERMISSION OF THE ENGINEER.
8. DEMOLITION OF ALL EXTERIOR WALL PANELS & WINDOW SYSTEMS, 2ND THROUGH 6TH FLOOR, SHALL BE ACCOMPLISHED IN A PREDETERMINED ORDER (SCHEDULE) TO PROTECT BUILDING INTERIOR. EXTERIOR WALL PANELS CONTAIN NON-FRABLE ASEBESTOS AND MUST BE DISCARDED AT LANDFILL, WRAPPED UP AND CONTAINING RECORDS SHOWING OWNERSHIP, ETC., OR AS OTHERWISE DIRECTED BY LA. DEPT. OF ENVIRONMENTAL PROTECTION. CONTRACTOR & ENGINEER SHALL WORK OUT SCHEDULE DETAILS OF REMOVING PRODUCT & TRANSPORTATION.
9. REMOVE EXISTING STAIR TOWER SYSTEM. SEE NEW STAIR DESIGN.
10. PATCH HOLES IN FLOORS AS REQUIRED TO MAKE SAFE & PREPARE FOR NEW WORK.

 = ADDENDUM 3 CHANGE

DEMOLITION FLOOR PLANS

ST. TAMMANY PARISH ADMIN. COMPLEX
520 OLD SPANISH TRAIL
SLIDELL, LOUISIANA

RENOVATE OFFICE BUILDING

DAMMON ENGINEERING. INC.
1095 FLORIDA AVENUE 985-649-5832 SLIDELL, LA. 70458
DAMMONENGINEERING.COM

SCALE: AS NOTED

FILE:

JOB NO.: 1729

DATE: 1-8-07

SHEET

D-4

OF

ADDENDUM 3 REVISED: 08/20/07ab
REVISED: 05/21/07ab

CONTRACT SET - 10/10/07