

N. T. S.

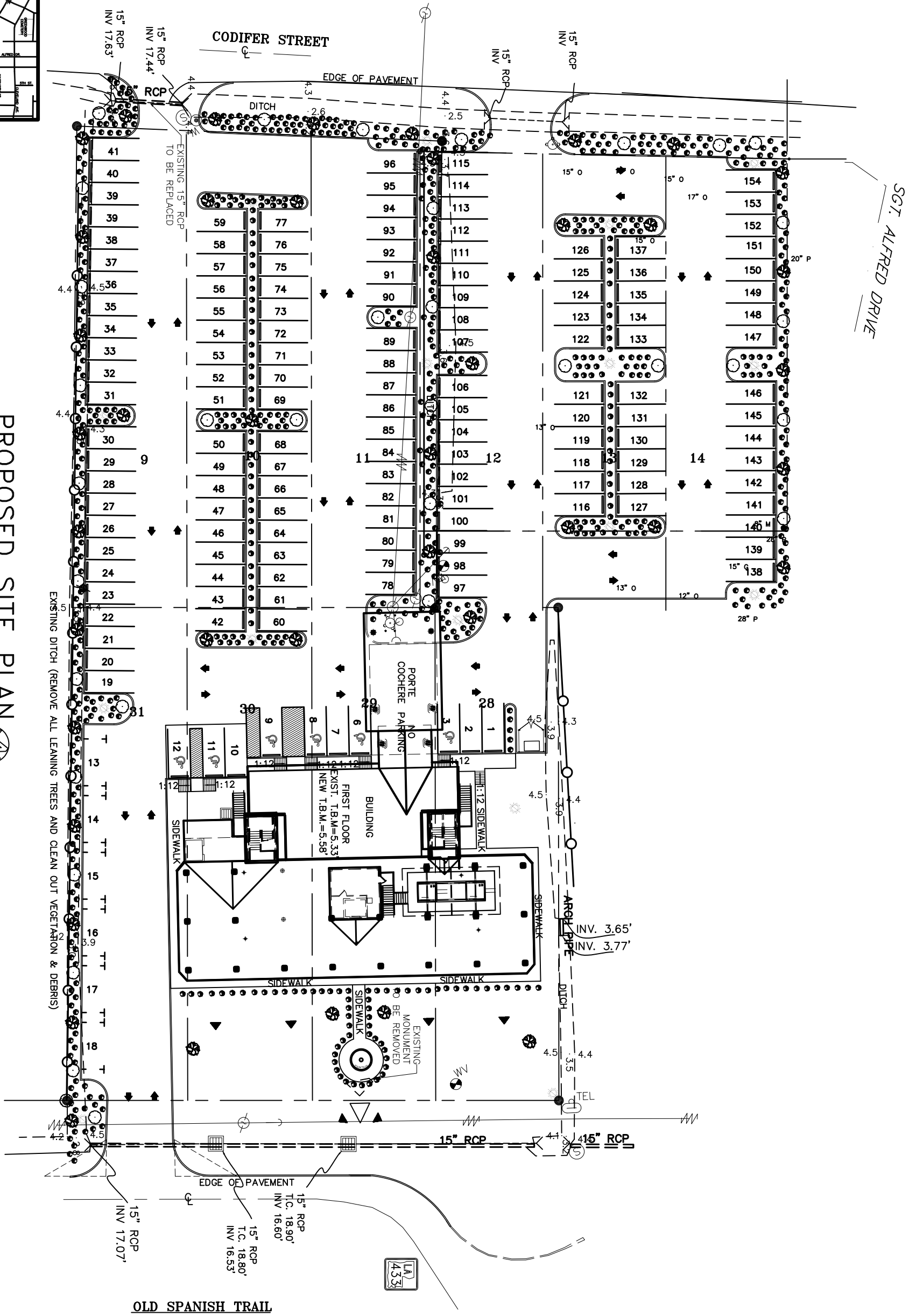

PROPOSED SITE PLAN

SCALE: 1"=20'-0"

- PARKING REQUIREMENT-
- TOTAL AREA= 42,928 SQ. FT.
- TOTAL USABLE AREA= 34,246 SQ. FT.
- 171 PARKING SPACES REQUIRED, 1 PER 200 SQ. FT.
- FURNISHED-
- 154 PARKING SPACES FURNISHED
- 6 ACCESSIBLE, 4 VAN SPACES

EXISTING DITCH (REMOVE ALL LEANING TREES AND CLEAN OUT VEGETATION & DEBRIS)

OLD SPANISH TRAIL

SGT. ALFRED DRIVE