

N. T. S.

VICINITY MAP

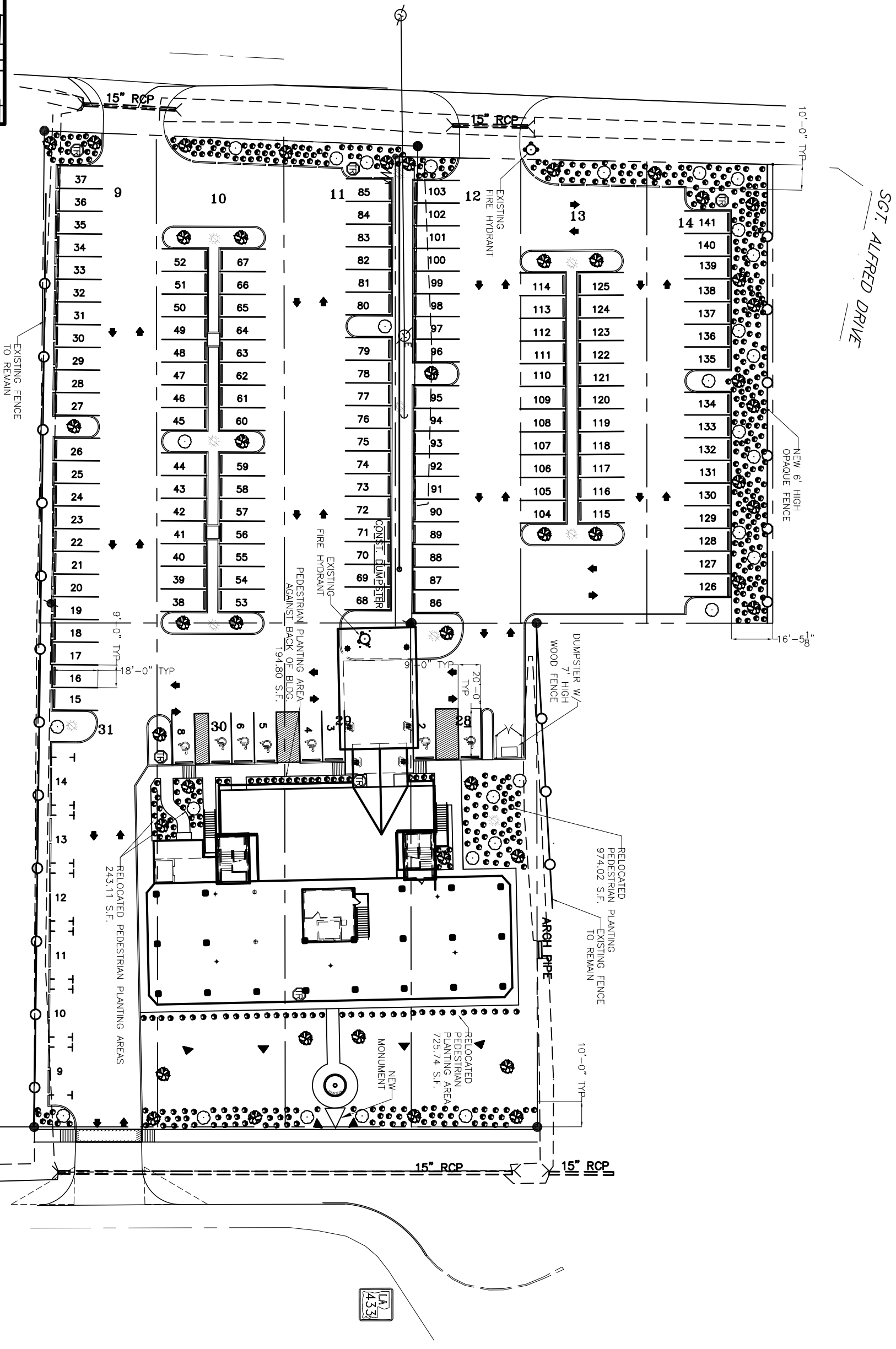

PROPOSED SITE PLAN

SCALE: 1"=20'-0"

REQUIRED PEDESTRIAN PLANTING: 1103.84 S.F.
 SUPPLIED PEDESTRIAN PLANTING: 2137.67 S.F.

—PARKING REQUIREMENT—
 TOTAL AREA= 42,928 SQ. FT.
 TOTAL USABLE AREA= 34,246 SQ. FT.
 171 PARKING SPACES REQUIRED, 1 PER 200 SQ. FT.
 9 ACCESSIBLE, 3 VAN SPACES
 PREVIOUSLY AVAILABLE-90 SPACES

—FURNISHED—
 141 PARKING SPACES FURNISHED
 7 ACCESSIBLE, 4 VAN SPACES

- LEGEND**
- CENTERLINE OF ROAD
 - PROPERTY LINE
 - NEW BUILDING
 - EXISTING FENCE LINE
 - SETBACK LINE
 - CREPE MYRTLE
 - SHUMARD OAK
 - LARGE CAMELLIA
 - HORN BEAM
 - SHRUB
 - NEW DROP INLET
 - LANDSCAPE UPLIGHT
 - LIGHT POLE
 - TRASH RECEPTACLE

<p>SCALE: 1"=20'</p> <p>FILE:</p> <p>JOB NO. 1729</p> <p>DATE: 1-8-07</p> <p>SHEET</p> <p style="font-size: 2em; font-weight: bold;">C-3</p>	<p>RENOVATE OFFICE BUILDING</p> <p style="font-size: 2em; font-weight: bold;">DAMMON ENGINEERING, INC.</p> <p>1095 FLORIDA AVENUE 985-649-5832 SLIDELL, LA. 70458 DAMMONENGINEERING.COM</p>	<p>PROPOSED SITE PLAN</p> <p>ST. TAMMANY PARISH OFFICE BUILDING 520 OLD SPANISH TRAIL SLIDELL, LOUISIANA</p>
--	--	--