

NOTE:
 REPLACE VERTICAL FIRE STANDPIPES AT EACH EXTERIOR STAIR, WITH AN OUTLET AT EACH FLOOR. MAKE NEW CONNECTIONS AT EACH FLOOR.

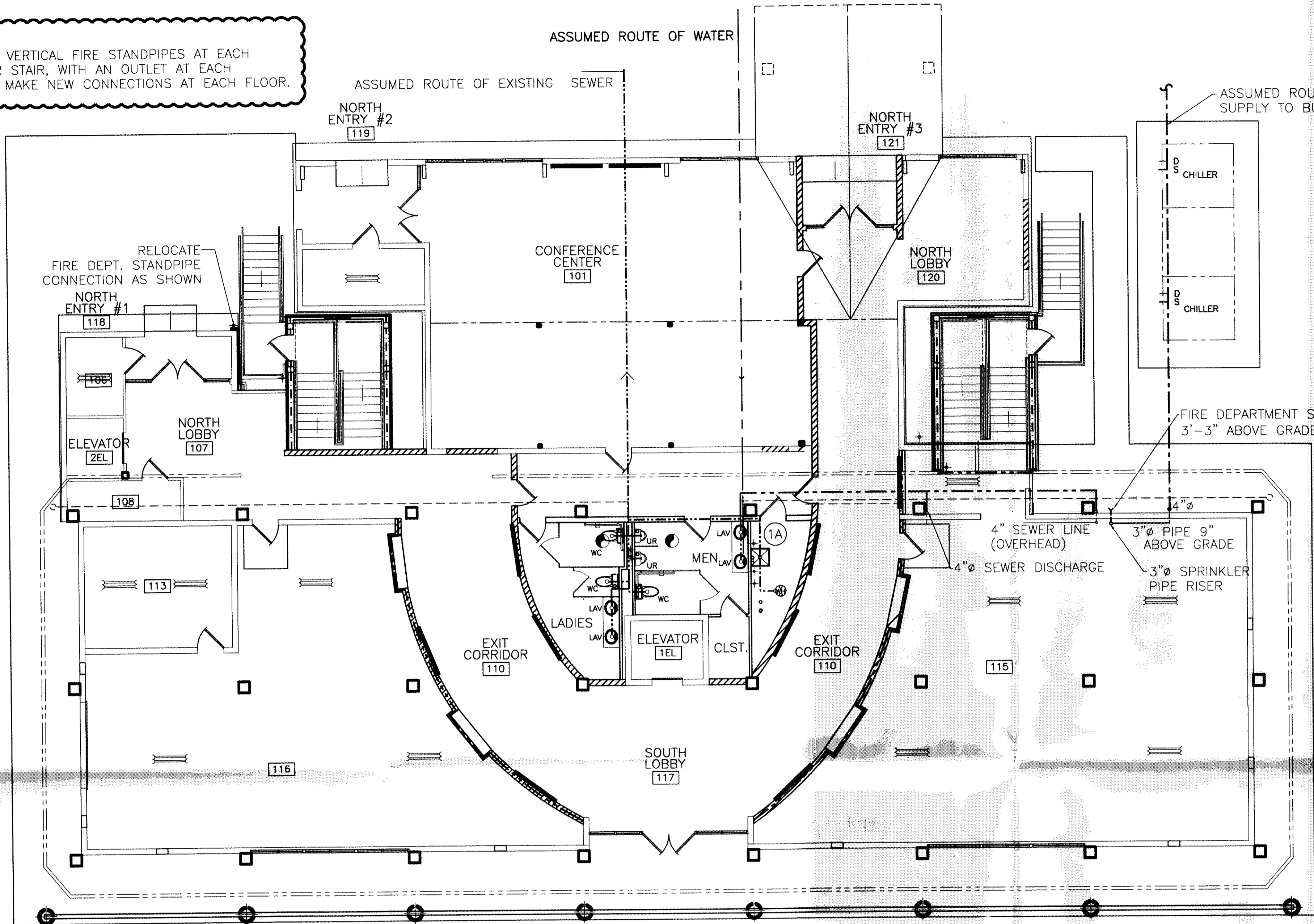

- LEGEND**
- ☒ - MOP SINK & STAND
 - ⊕ - 6 GALLON, 120 VAC, 1 PH. COMPACT WATER HEATER
 - - SANITARY SEWER LINE

FIRST FLOOR PLUMBING PLAN
 SCALE: 1/8" = 1'-0"

NOTES:

1. THESE ARE NEW RESTROOMS AND WILL REQUIRE EXISTING SERVICES THRU THE WALL, NEW WALL SUPPORTS FOR WALL HUNG FIXTURES, ETC. DRAIN FROM LAVATORIES AND SANITARY FACILITIES MAY BE CONNECTED TO EXISTING FLOOR DRAINS AND EXTENDED TO EXISTING SERVICE IF THE LINES ARE TESTED AND FOUND SOUND.
2. NEW VENT LINES SHELL RUN TO N.E. CORNER VERTICAL OPENING TO ROOF.
3. PROVIDE ALL NEW MENS ROOM WATER CLOSETS, LAVATORIES, URINALS, PIPING AND PIPING FIXTURES.
4. PROVIDE ALL NEW LADIES ROOM WATER CLOSETS, LAVATORIES, PIPING, AND PIPING FIXTURES.
5. PROVIDE ALL NEW TOILET SEATS AND SANITARY NAPKIN DISPOSAL.
6. INSTALL OWNER PROVIDED SOAP DISPENSERS, TOILET PAPER HOLDERS, AND PAPER TOWEL HOLDERS.
7. INTEGRAL LAVATORY/VANITY: CULTURED MARBLE, SIZE AS SHOWN ON DRAWING A-21.
8. URINALS: TOTO UT447 (OR EQUAL) WITH TOTO TMU1NNC 1Gpf FLUSH VALVE (OR EQUAL).
9. WATER CLOSETS: TOTO CT705 (CT705L FOR HANDICAP) WITH TOTO TMT1NNC-32 1.6 Gpf FLUSH VALVE, AMERICAN STANDARD 2234 WITH SLOAN 111 ROYAL 1.6 Gpf FLUSHMETER VALVE (OR EQUAL).
10. TOILET SEATS: KOHLER K-4710-T (MENS), K-4752 (LADIES) (OR EQUALS).
11. PARTITIONS: BOBRICK 1080 SERIES PHENOLIC (OR EQUAL).
12. MIRRORS: SHEET MIRROR 3'-0" HIGH X LENGTH OF VANITY, MOUNTED 3'-4" ABOVE FLOOR.
13. SANITARY NAPKIN DISPOSAL: BOBRICK B354 (LADIES PARTITIONS) (OR EQUAL).

PLUMBING NOTES

1. PROVIDE ALL LABOR, MATERIAL AND EQUIPMENT FOR A COMPLETE OPERATING SYSTEM. THE SYSTEM SHALL INCLUDE HOT AND COLD WATER PIPING, SEWER AND VENT PIPING, INSULATION, WATER HEATER, HANGERS, VALVES, AND ALL SUPPORTS WITHOUT ANY RESTRICTIONS TO VOLUME. CUT AND PATCH AS REQUIRED TO INSTALL PIPES.
2. ALL WORK AND MATERIAL TO COMPLY STRICTLY TO THE LATEST LOCAL CITY, PARISH, STATE, AND NATIONAL GOVERNING CODES.
3. CONTRACTOR IS TO FIELD VERIFY ALL EXISTING UTILITY LOCATIONS, ELEVATIONS, AND SIZES PRIOR TO COMMENCING ANY WORK. CONTRACTOR SHALL PAY NECESSARY FEES FOR THE UTILITIES CONNECTIONS.
4. CONTRACTOR TO BE RESPONSIBLE TO VERIFY ANY EXISTING INVERTS AND SET NEW INVERTS OF SEWAGE AND DRAINAGE PIPES.
5. SEWAGE LINES 3" AND SMALLER SHALL BE SLOPED 1/4" PER FOOT AND LINES 4" AND LARGER SHALL BE 1/8" PER FOOT.
6. TEST ALL PIPING AT REQUIRED PRESSURE.
7. ALL PLUMBING SHALL BE CLOSELY COORDINATED WITH STRUCTURAL, MECHANICAL, AND ELECTRICAL SYSTEMS TO INSURE NO TRADES WILL CONFLICT WITH EACH OTHER.
8. DO NOT SCALE DRAWINGS; SEE DIMENSIONS ON ARCHITECTURAL DRAWINGS FOR EXACT LOCATIONS OF DOORS, WINDOWS, WALLS, FIXTURES, ETC.
9. ALL WATER MAINS AND PIPING NOT SHOWN FOR CLARITY, ALL LOCATIONS FIELD VERIFIED.
10. DOMESTIC HOT AND COLD WATER PIPING AND FITTINGS UNDER SLAB SHALL BE ASTM 888 COPPER WATER TUBE, TYPE 'L' HARD DRAWN WITH COPPER PRESSURE TYPE FITTINGS, ANSI B16.22. THE JOINTS SHALL BE SOLDERED TYPE USING ASTM B32, ALLOY GRADE 95A (95-5) SOLDER.
11. SOIL, WASTE, VENT PIPING AND FITTINGS ABOVE THE SLAB SHALL BE SERVICE WEIGHT CAST IRON PIPE WITH BELL AND SPIGOT ENDS AND ONE PIECE NEOPRENE INSERT TYPE GASKET. USE PVC SCHEDULE 40 OR ABS DWV PIPES AND FITTINGS WHERE INDICATED BY CODE.
12. ALL WATER PIPING AND FITTINGS SHALL BE INSULATED WITH 1/2" THICK FIBERGLASS INSULATION & JACKET.
13. ALL ELECTRICAL, MECHANICAL, AND PLUMBING PENETRATING FIRE WALLS SHALL BE FIRE CAULKED. (PENETRATIONS THROUGH RATED CONSTRUCTION SHALL BE SEALED WITH A MATERIAL CAPABLE OF PREVENTING THE PASSAGE OF FLAMES AND HOT GASES WHEN TESTED IN ACCORDANCE WITH ASTM-E814.)
14. ALL PLUMBING LINES SHOWN ARE DRAWN DIAGRAMMATIC.

RE-STAMP / LOST PLANS

ADDENDUM 4 REVISD: 08/20/07ab
 REVISD: 03/07/07ab
 REVISD: 2/19/07
 REVISD: 1/24/07

1ST FLOOR PLUMBING PLAN
 ST. TAMMANY PARISH ADMIN. COMPLEX
 520 OLD SPANISH TRAIL
 SLIDELL, LOUISIANA

RENOVATE OFFICE BUILDING
DAMMON ENGINEERING, INC.
 1095 FLORIDA AVENUE 985-649-5832 SLIDELL, LA. 70458
 DAMMONENGINEERING.COM

320959
 REVIEWED FOR STATE FIRE MARSHAL AS PER REVIEW LETTER BY WILLIAM D. JONES, ARCHITECT, CBO

SCALE: AS NOTED
 FILE:
 JOB NO. 1729
 DATE: 1-8-07
 SHEET
 P-1
 OF