

FILE NAME: A:\Projects\2022\19-01\19-01-01\19-01-01-01.dwg  
 PLOT DATE: 05/12/2022 10:46:11 AM  
 PLOT BY: BMA

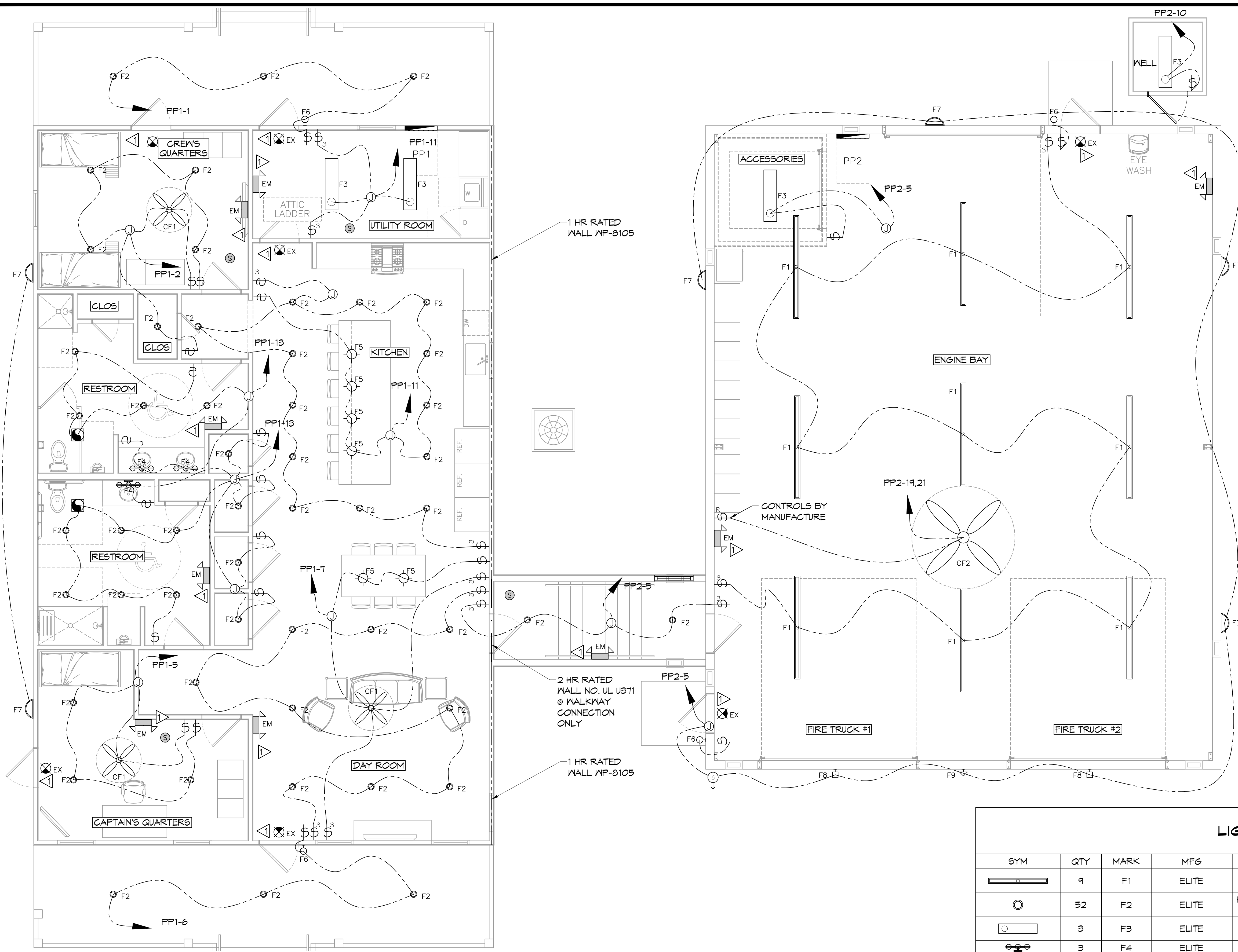

**45 LIGHTING PLAN**  
SCALE: 1/8"=1'-0"

**GENERAL LIGHTING NOTES**

- ALL WORK SHALL COMPLY WITH APPLICABLE NATIONAL, STATE, AND LOCAL CODES, RULES, REGULATIONS, AND REQUIREMENTS OF THE SERVICE UTILITY COMPANY.
- GENERAL CONTRACTOR SHALL NOTIFY THE ARCHITECT IMMEDIATELY IF ANY CONFLICTS OCCUR BETWEEN LIGHTING AND ANY OTHER TRADE. DO NOT PROCEED WITH INSTALLATION IN THAT AREA UNTIL CONFLICT HAS BEEN RESOLVED TO THE SATISFACTION OF THE ARCHITECT AND ENGINEER.
- REFER TO ARCHITECTURAL DRAWINGS FOR EXACT LOCATION AND MOUNTING INSTRUCTIONS FOR ALL LIGHT FIXTURES. NOTIFY THE ARCHITECT AND ENGINEER OF ANY DISCREPANCIES BETWEEN THESE PLANS AND THE ARCHITECTURAL PLANS RELATING TO QUANTITY, TYPE AND LOCATION OF DEVICES AND/OR FIXTURES.
- WHEN SPECIFIC LIGHT FIXTURE HAS BEEN SPECIFIED IN THE FIXTURE SCHEDULE, ELECTRICAL CONTRACTOR SHALL PROVIDE COMPLETE ASSEMBLY INCLUSIVE ALL PARTS AND HARDWARE TO INSURE PROPER FUNCTIONING FIXTURE.
- ALL CONDUCTORS SHALL BE A MINIMUM OF #12 AWG UNLESS NOTED OTHERWISE.
- ALL 120V RUNS LONGER THAN 60 FEET SHALL BE #10 AWG AND 277V RUNS LONGER THAN 150 FEET SHALL BE #10 AWG UNLESS NOTED OTHERWISE.
- ALL CONDUCTORS SHALL BE COPPER.
- WHERE CONDUCTOR SIZES ARE NOTED ON DRAWINGS, THAT WIRE SIZE SHALL BE THROUGH THE ENTIRE RUN UNLESS OTHERWISE NOTED.
- MOUNTED LIGHT SWITCHES 48" AFF UNLESS NOTED OTHERWISE ON ARCHITECTURAL DRAWINGS.
- WHERE MORE THAN ONE SWITCH OCCURS IN THE SAME LOCATION, THEY SHALL BE INSTALLED IN A GANG TYPE BOX UNDER ONE COVER PLATE. ALL GANGED SWITCHES SHALL HAVE A COMMON SEAMLESS FACEPLATE. EACH MULTI-GANGED BOX SHALL BE NO MORE THAN SIX (6) SWITCHES WIDE. WHERE MORE THAN SIX (6) SWITCHES ARE SHOWN AT ONE (1) LOCATION, ADDITIONAL MULTI-GANGED BOXES SHALL BE STACKED VERTICALLY AND THE WIDTH OF THE MULTI-GANGS SHALL BE AS EVEN AS POSSIBLE.
- EACH DIMMER SWITCH SHALL HAVE A WATTAGE RATING 25% HIGHER THAN THE TOTAL WATTAGE OF ALL LIGHTS TO BE CONTROLLED BY THE DIMMER. DIMMER SIZES 600, 1000, AND 2000 WATTS, LUTRON NOVA T-STAR. WHERE SWITCHES ARE GANGED WITH DIMMERS, THE SWITCHES SHALL ALSO BE LUTRON NOVA T-STAR. FLUORESCENT AND LOW VOLTAGE DIMMERS SHALL BE LUTRON NOVA T-STAR.
- WHERE FLUORESCENT FIXTURES ARE SHOWN TO BE DIMMED, THE FIXTURES SHALL HAVE DIMMING TYPE BALLASTS WHICH ARE COMPATIBLE WITH THE SPECIFIED DIMMERS.
- WHERE LED FIXTURES/LAMPS ARE SHOWN TO BE DIMMED, THE DIMMER SHALL BE COMPATIBLE WITH THE FIXTURE/LAMP SPECIFIED OR PROVIDED.
- ALL EMERGENCY EXIT LIGHT FIXTURES SHALL HAVE 90 MINUTE BATTERY BACKUP WITH INTEGRAL TEST BUTTON AND SHALL BURN CONTINUOUSLY.
- ALL FLUORESCENT FIXTURES THAT UTILIZE DOUBLE-ENDED LAMPS AND CONTAIN BALLASTS SHALL BE PROVIDED WITH A DISCONNECTING MEANS IN ACCORDANCE WITH NEC 410.136.

**KEYED NOTES**

- PROVIDE CONNECTION TO UN-SWITCHED HOT OF LIGHTING CIRCUIT AND SHALL HAVE 90 MINUTE EMERGENCY BATTERY BACKUP.

**GENERAL LIGHTING NOTES**

- Ⓢ 3-WAY LIGHT SWITCH
- Ⓡ RHEOSTAT LIGHT SWITCH
- Ⓞ LIGHT SWITCH
- Ⓢ SMOKE DETECTOR
- Ⓞ JUNCTION BOX
- Ⓞ DAYLIGHT SENSOR
- Ⓞ HOME RUN
- Ⓞ EXHAUST FAN - SEE MECHANICAL

SYM	QTY	MARK	MFG	PART NUMBER	DESCRIPTION	HEIGHT
	9	F1	ELITE	8-OEG-LED-14000L/16000L/18000 LDIM10-MVOLT-35K/40K/50K-85	8' LED STRIP SELECTABLE	
	52	F2	ELITE	HH6-LED-1200L-DIM10-MVOLT-30K-ND-90/HH6-6501-CL-VH	6" LED DOWNLIGHT 1200LUMENS 90CRI 30K	9' AFF
	3	F3	ELITE	4-OEG-LED-5000L-DIM10-MVOLT-4 OK-85	4' LED STRIP 5000L 40K	9' AFF
	3	F4	ELITE	ECH-BL-LED-1003-3	24" VANITY LED LIGHT	9' AFF
	6	F5	ELITE	ECH-PL-1025	12" PENDANT	
	4	F6	LIGHT ALARMS	GAMACSDDB-CNP	LED EXT WALL LIGHT - EGRESS	9' AFF
	10	F7	ORION LIGHTING	LSWF1-A1(3000LUMENS)-UNV-FD-8CS (30K)XX-BB-SP	LED WALLPACK 3000 LUMENS 30K BATTERY BACKUP	7' AFF
	2	F8	ALUMILITE	AR14-12/LED-UV-30K-XX-P6-SS-CCA	14" RLM 12W LED STRAIGHT SHROUD 30K PRISMATIC GLASS WET	14'
	1	F9	ALUMILITE	AR14-12/LED-UV-30K-XX-P6-SCA	14" RLM 12W LED ANGLED SHROUD 30K PRISMATIC GLASS WET	17'
	3	CF1	MINKA AIRE	MINKA AIRE F546-B5	42" 5 BLADE INDOOR CEILING FAN	
	1	CF2	BIG ASS FANS	BIG ASS FAN POWERFOIL 8-08	8' DIAMETER INDUSTRIAL FAN	
	6	EX	ELITE	ELX-603 -R-W	LED EXIT	
	9	EM	ELITE	ELM-LED-803-W	LED EMERGENCY LIGHT W/BATTERY BACKUP	
	2	S1	ORION LIGHTING	IAHP1-A1-UNV-FD-730-XX-T4-T52-SP	AREA LIGHT TYPE IV, 30K, 76W 13000 LUMENS ON 16' SQUARE STRAIGHT STEEL POLE	

**DAMMON ENGINEERING, INC.**  
LOUISIANA & MISSISSIPPI

www.dammonengineering.com  
info@dammoneng.com  
PH: 985.649.5832

Field Engineer: Brian Misch, PE  
5650 Old Highway 101, Suite 101  
Slidell, LA 70488

#	DESCRIPTION	DATE



ST. TAMMANY FIRE PROTECTION DISTRICT NO. 1  
**FIRE STATION 19**

5704T ALLEN ROAD  
SLIDELL, LOUISIANA 70461  
JOB No: 2495  
DATE: 05-12-2022  
DRAWN BY: BMA  
CHECKED BY: C&K

SHEET TITLE:  
LIGHTING PLAN

DRAWING NUMBER:  
**E102**

SHEET No: 27 of 24