

REVDATE:

MATCHLINE SEE SHT C6.2 MATCHLINE SEE SHT C6.2 MATCHLINE SEE SHT C6.2

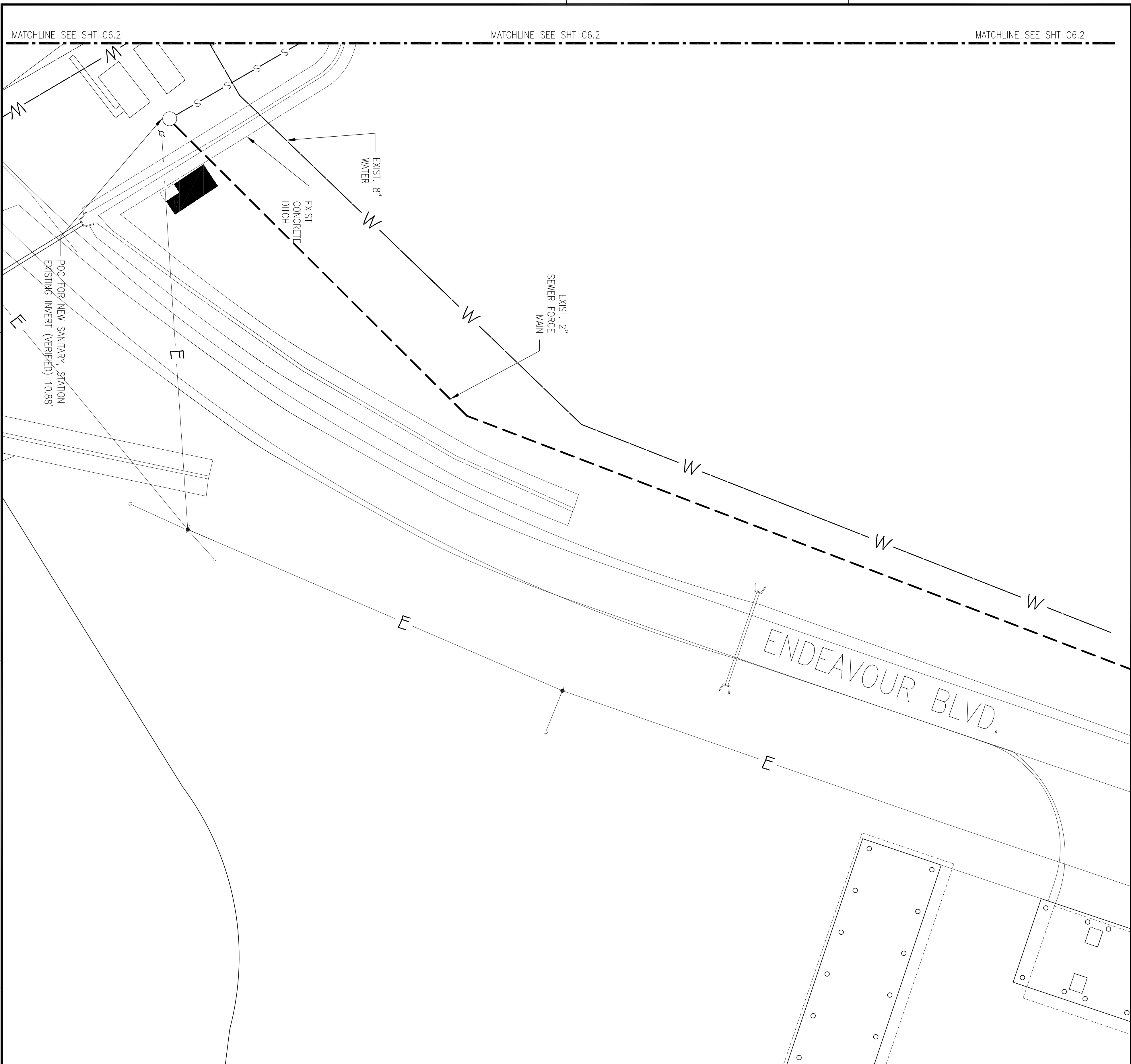

POC FOR NEW SANITARY STATION
EXISTING INVERT (VERIFIED) 10.88'

EXIST. 8"
WATER

EXIST.
CONCRETE
DITCH

EXIST. 2"
SEWER FORCE
MAIN

ENDEAVOUR BLVD.

LEGEND	
SYMBOL	DESCRIPTION
—S—S—S—	SANITARY SEWER
—PW—PW—PW—	COLD WATER (POTABLE)
—E—E—E—	EXISTING SEWER
—F—F—F—	FIRE PROTECTION

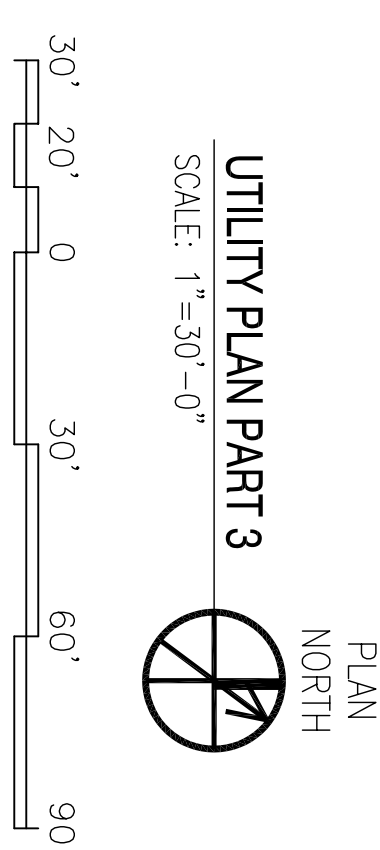

RECORD DRAWING
LETTER DATED -
5-27-10

DEPARTMENT OF THE NAVY NAVAL FACILITIES ENGINEERING COMMAND SOUTHEAST IPT GULF COAST JOHN C. STENNIS SPACE CENTER SOF RIVERINE AND COMBATANT CRAFT OPERATIONS FACILITY - PRE-FINAL MISSISSIPPI UTILITY PLAN PART 3	NAVAL FACILITIES ENGINEERING COMMAND NAVAL AIR STATION JACKSONVILLE MISSISSIPPI	JESSE C. DAMMON DEPT. J. TIFANY ENGINEER BY: R. WILBER DRAWN: T. JARVIS CHECK ENGINEER: E. DAMMON		DAMMON ENGINEERING, INC. 1000 W. UNIVERSITY BLVD., SUITE 200 JACKSONVILLE, FL 32218 (904) 649-5832 <small>ESTABLISHED 1982</small>		SYM	AS-BUILT	DATE	3-12-10	RW
						DESCRIPTION	DATE	APPR		

C64

REVISION: 01 JAN 2009