

**ARMORY**

ALL ARMORY WALLS SHALL BE 8" CMU WITH VERT. #4 REBAR @ 8" O.C. AND HORIZ. JOINT REINF. AT EVERY COURSE. ALL CELLS FILLED WITH 3,000 PSI CONC. IN ACCORDANCE WITH MIL-HDBK-1013/1A

8" CMU WALL WITH 2 HR. FIRE RATING. UL DESIGN NO. U905 SEE DETAIL ON SHEET A1.6

SECTION TYP. AT ALL ROLL-UP DOOR JAMBS

SECTION TYP. AT ALL ROLL-UP DOOR JAMBS

SEE SHEET S3.3 FOR 26' ROLL-UP DOOR LINTEL (TYP)

SEE SHEET S3.3 FOR 26' ROLL-UP DOOR LINTEL (TYP)

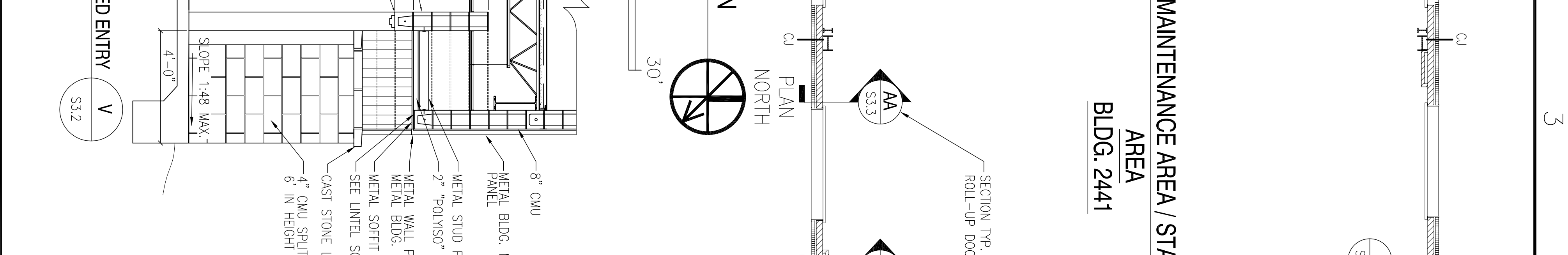
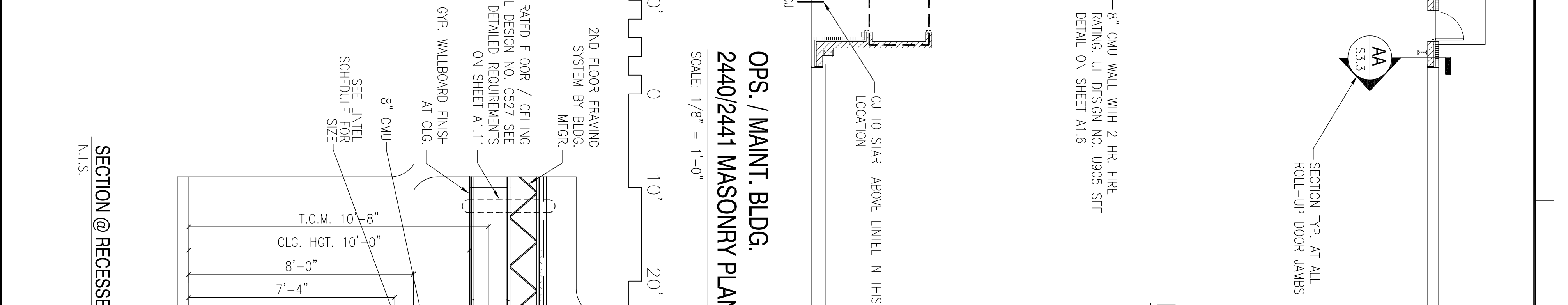
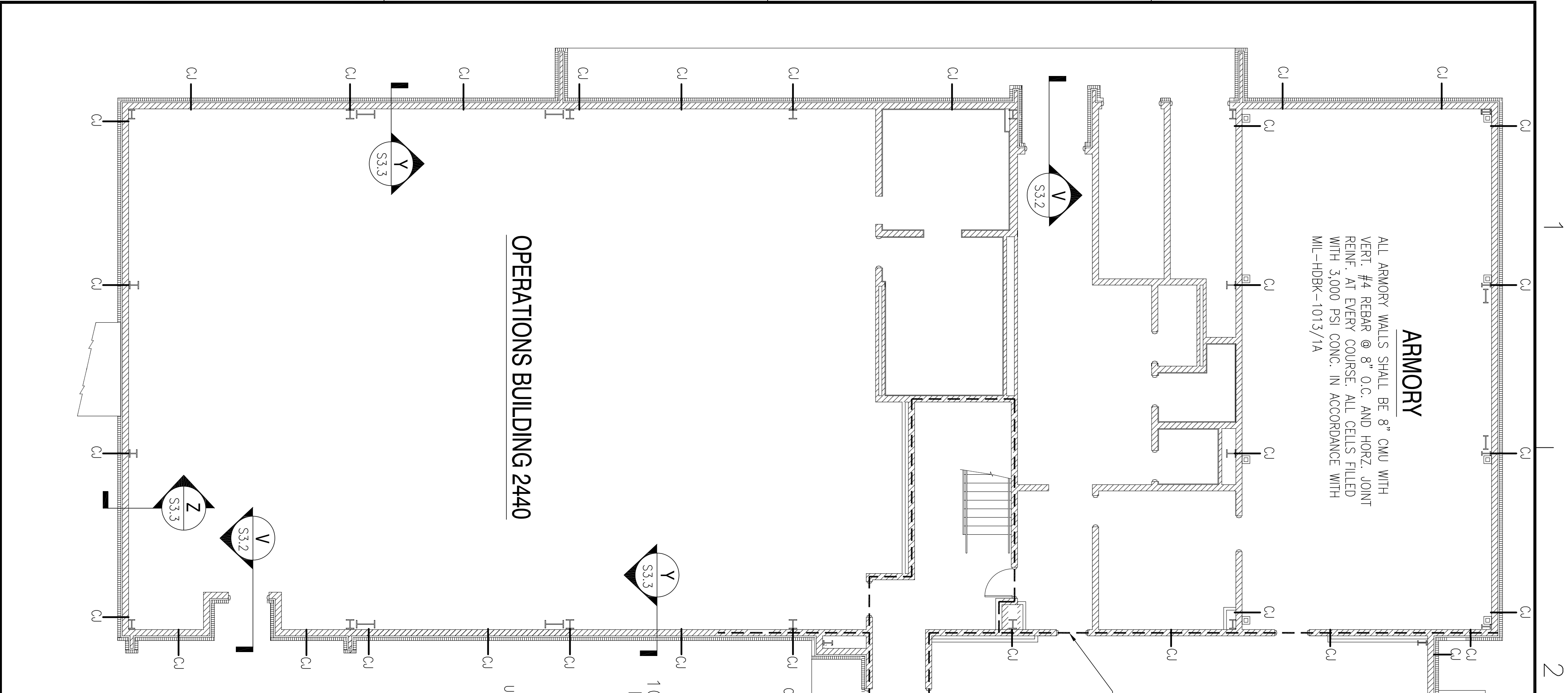

**CMU LINTEL SCHEDULE**

WIDTH (W)	CLEAR SPAN	DEPTH (D)	HORIZ. REINF.
8" TYP AT ALL CMU WALLS	UP TO 3'-4"	8"	(1) #6 BOTTOM
	UP TO 7'-4"	16"	(1) #6 BOTTOM
	UP TO 11'-4"	16"	(2) #6 BOT. (2) #4 TOP
	12' ROLL-UP	16"	(2) #6 BOT. (2) #4 TOP

3000 PSI PEA-GRAY FOR ALL LINTELS.

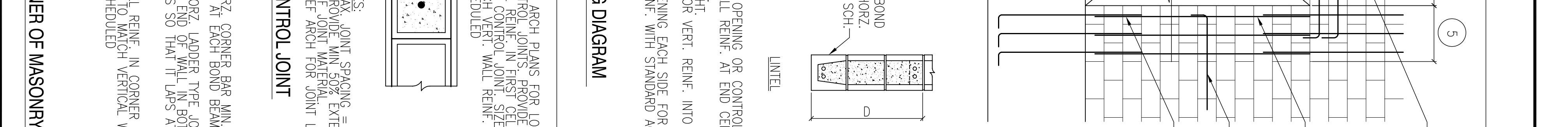
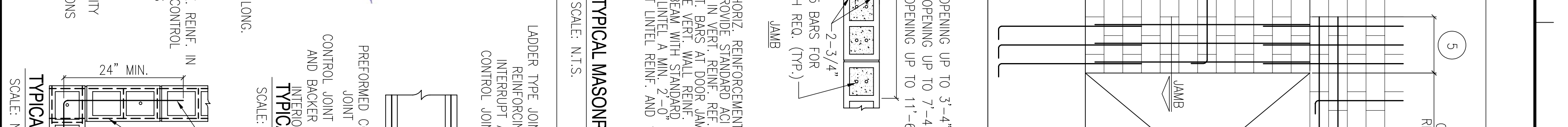

**RECORD DRAWING**  
LETTER DATED -  
5-27-10

**TYPICAL MASONRY WALL OPENING DIAGRAM**  
SCALE: N.T.S.

**CONTROL JOINT @ BOND BEAM**  
SCALE: N.T.S.

**TYPICAL REINF. @ CORNER OF MASONRY**  
SCALE: N.T.S.

**NOTES:**  
1. WHERE HORIZ. REINFORCEMENT IS INTERRUPTED BY OPENING OR CONTROL JOINT PROVIDE STANDARD ACI HOOK WITH VERT. WALL REINF. AT END CELL.  
2. SPLICES IN VERT. REINF. REF. WALL SECTIONS S3.3.  
3. ALL VERT. BARS AT DOOR JAMBS TO BE FULL HEIGHT.  
4. CONTINUE VERT. WALL REINF. OVER OPENING. ANCHOR VERT. REINF. INTO LINTEL BEAM WITH STANDARD ACI HOOK.  
5. EXTEND LINTEL A MIN. 2'-0" BEYOND FACE OF OPENING EACH SIDE FOR STRAIGHT LINTEL REINF. AND 1'-0" BEYOND FACE FOR LINTEL REINF. WITH STANDARD ACI HOOK.

**NOTES:**  
1. MAX. JOINT SPACING = 17'.  
2. PROVIDE MIN. 50% EXTENSIBILITY OF JOINT MATERIAL.  
3. REF ARCH FOR JOINT LOCATIONS.

**NOTES:**  
1. MAX. JOINT SPACING = 17'.  
2. PROVIDE MIN. 50% EXTENSIBILITY OF JOINT MATERIAL.  
3. REF ARCH FOR JOINT LOCATIONS.

**NOTES:**  
1. MAX. JOINT SPACING = 17'.  
2. PROVIDE MIN. 50% EXTENSIBILITY OF JOINT MATERIAL.  
3. REF ARCH FOR JOINT LOCATIONS.

<p>DEPARTMENT OF THE NAVY</p> <p>NAVAL FACILITIES ENGINEERING COMMAND</p> <p>NAVAL FACILITIES ENGINEERING COMMAND SOUTHEAST</p> <p>NAVAL AIR STATION JACKSONVILLE</p> <p>MISSISSIPPI</p> <p>JOHN C. STENNIS SPACE CENTER</p> <p><b>SOF RIVERINE AND COMBATANT CRAFT OPERATIONS FACILITY - PRE-FINAL</b></p> <p>BLDG. 2440 / 2441 MASONRY PLAN</p>	<p>DES. &amp; WASTE: [Signature]</p> <p>DRW. &amp; REVISION: [Signature]</p> <p>REVISIONS BY: [Signature]</p> <p>DATE: [Signature]</p> <p>CHIEF ENGINEER: [Signature]</p> <p>CHIEF ARCHITECT: [Signature]</p>	<p>EMMETT B. DAMMON</p> <p>REGISTERED PROFESSIONAL ENGINEER</p> <p>STATE OF MISSISSIPPI</p> <p>1982</p>	<p>DAVIMON</p> <p>ENGINEERING, INC.</p> <p>CHIEF ENGINEER: [Signature]</p> <p>CHIEF ARCHITECT: [Signature]</p> <p>1500 LOMA MARINE</p> <p>MEMPHIS, TN 38117</p> <p>(901) 649-5312</p> <p>SEPTEMBER 4, 2008</p>	<p>NAVFAC</p> <p>AS-BUILT</p> <p>4-27-10</p> <p>RW</p>
---	---	---	--	--