

A

B

C

D

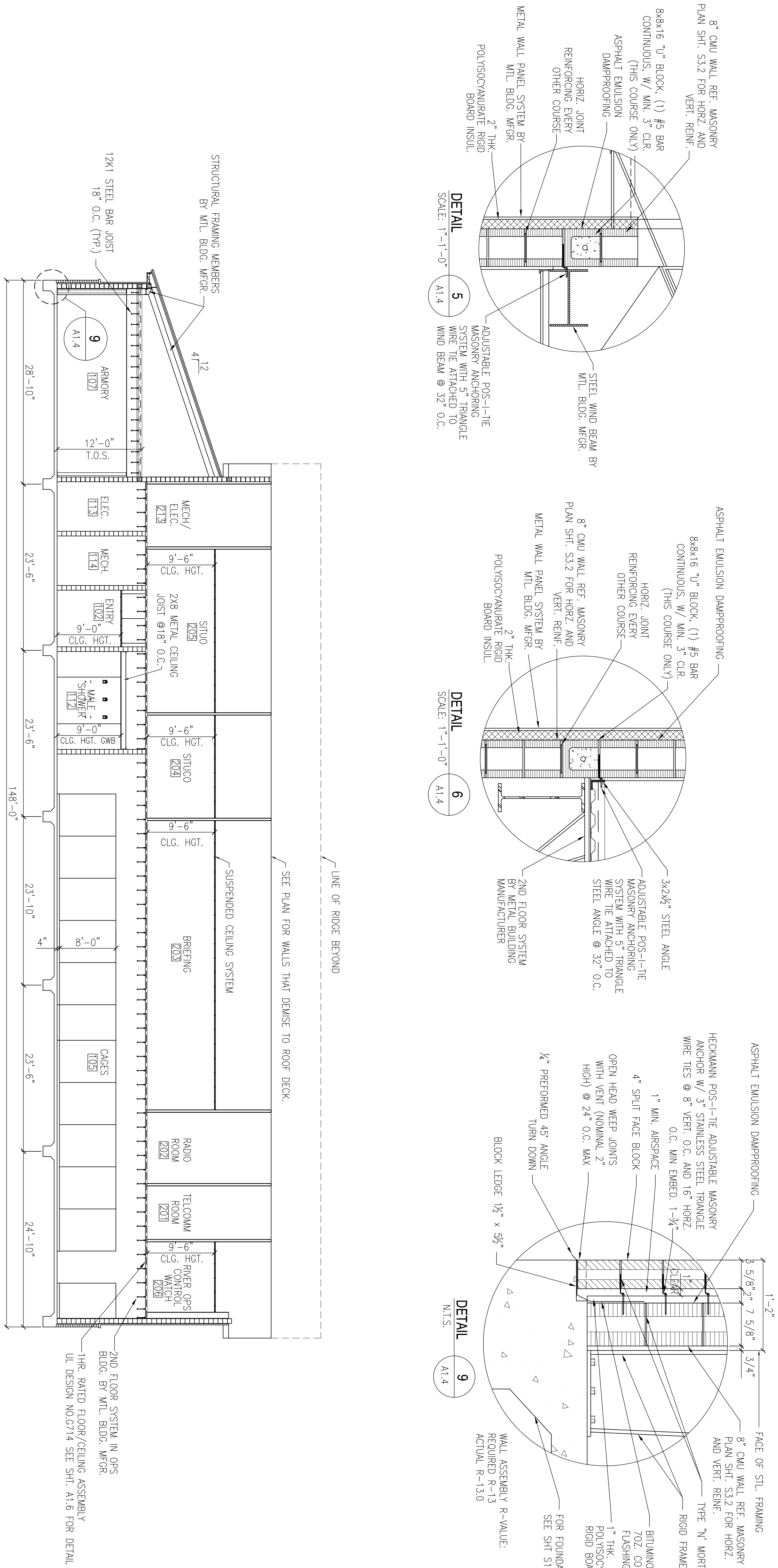

OPERATIONS BLDG.
2440 SECTION
 SCALE: 1/8" = 1'-0"
 A1.1
 A1.2

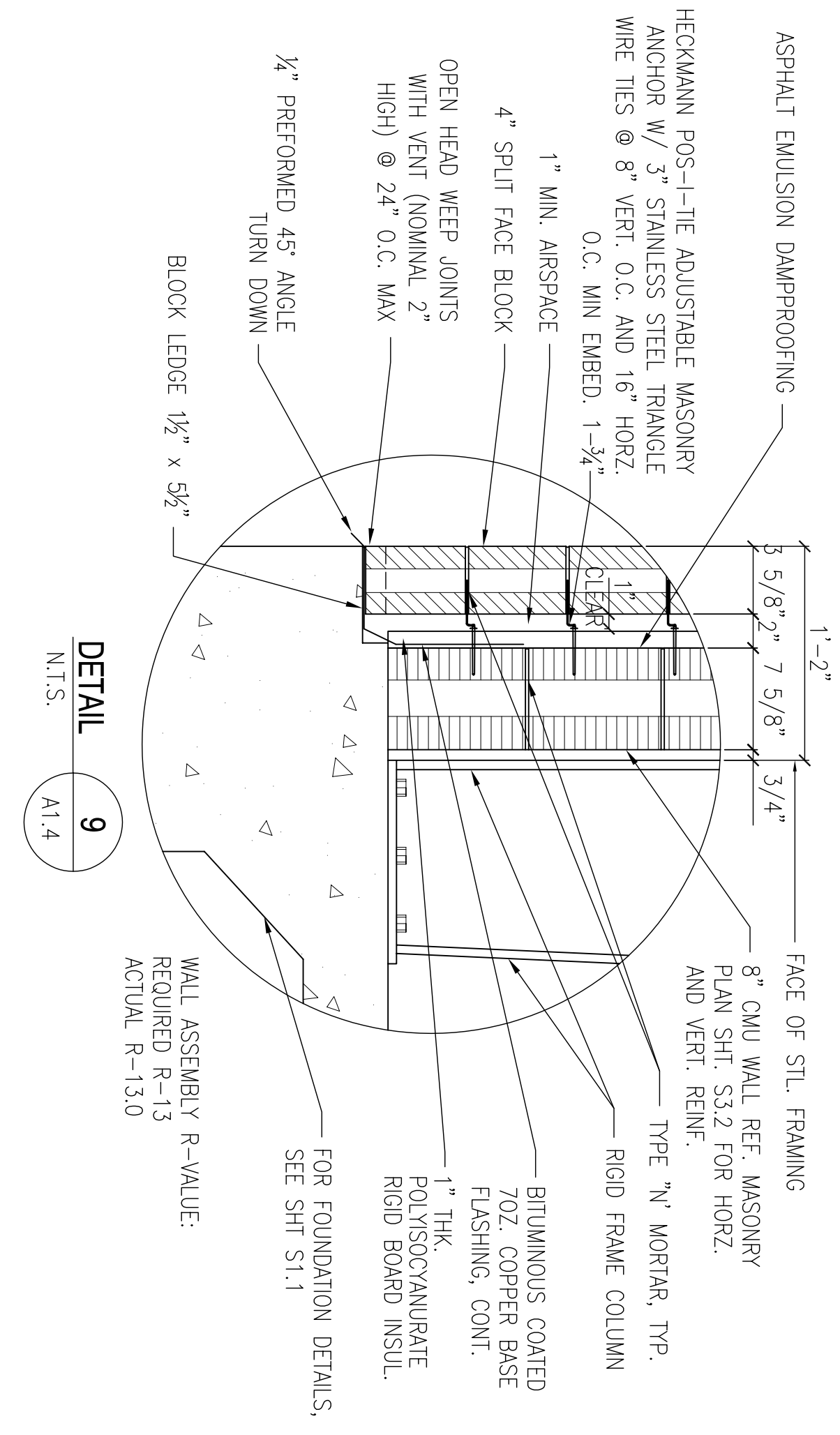
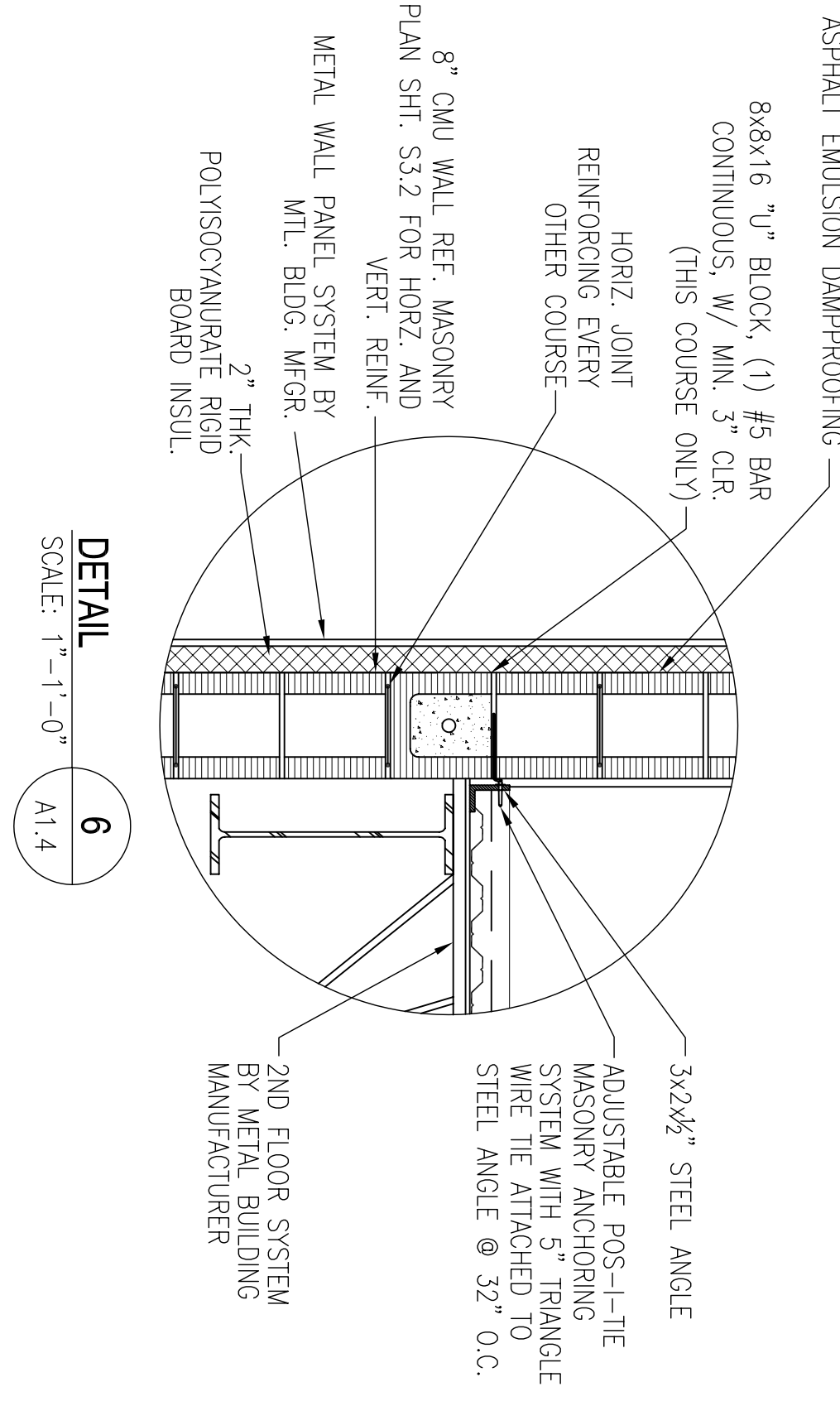
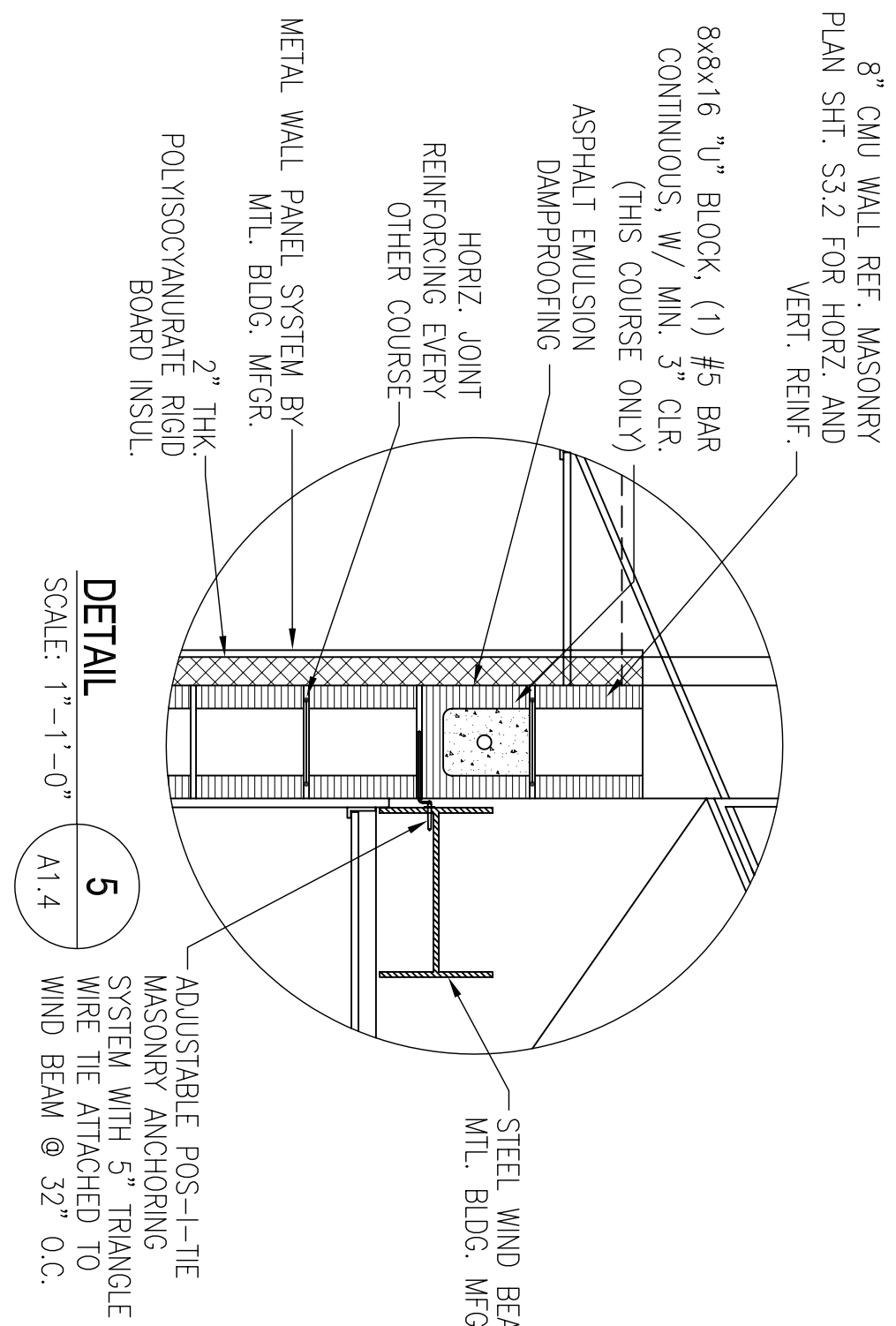

1

2

3

4

5



DEPARTMENT OF THE NAVY NAVAL FACILITIES ENGINEERING COMMAND SOUTHEAST NAVAL AIR STATION JACKSONVILLE JOHN C. STENNIS SPACE CENTER MISSISSIPPI SOF RIVERINE AND COMBATANT CRAFT OPERATIONS FACILITY - PRE-FINAL OPERATIONS BLDG. 2440 SECTION	DAMMON ENGINEERING, INC. ENGINEER CHEF ENGINEER DAMMON & ASSOCIATES SUITE 100 5100 N. LA 7828 (985) 649-5832 ESTABLISHED 1962	EMMETT B. DAMMON LICENSED PROFESSIONAL ENGINEER STATE OF MISSISSIPPI 9662	DESIGNED BY: R. WILSON DRAWN BY: J. WHELAN CHECKED BY: T. JARVIS CHIEF ENGINEER: P. DAMMON	DATE: 11-6-09 APPR: RW
REVISIONS: REVISED AS PER URS COMMENTS 9 OCTOBER 2009	SYM DESCRIPTION DATE			