

**BLDG 2441 INTERIOR ELEVATION 10**  
 1/2" = 1'-0"  
 A1.1

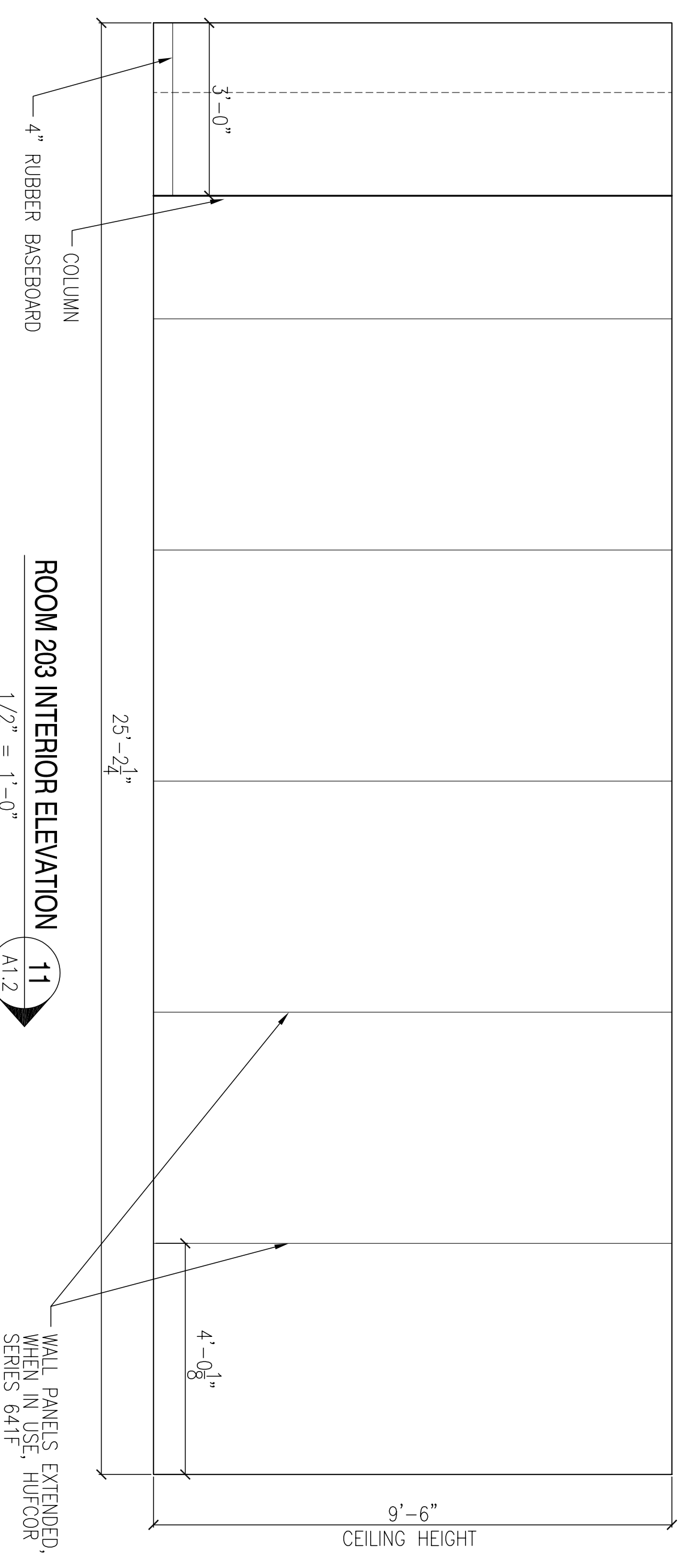

**ROOM 203 INTERIOR ELEVATION 11**  
 1/2" = 1'-0"  
 A1.2

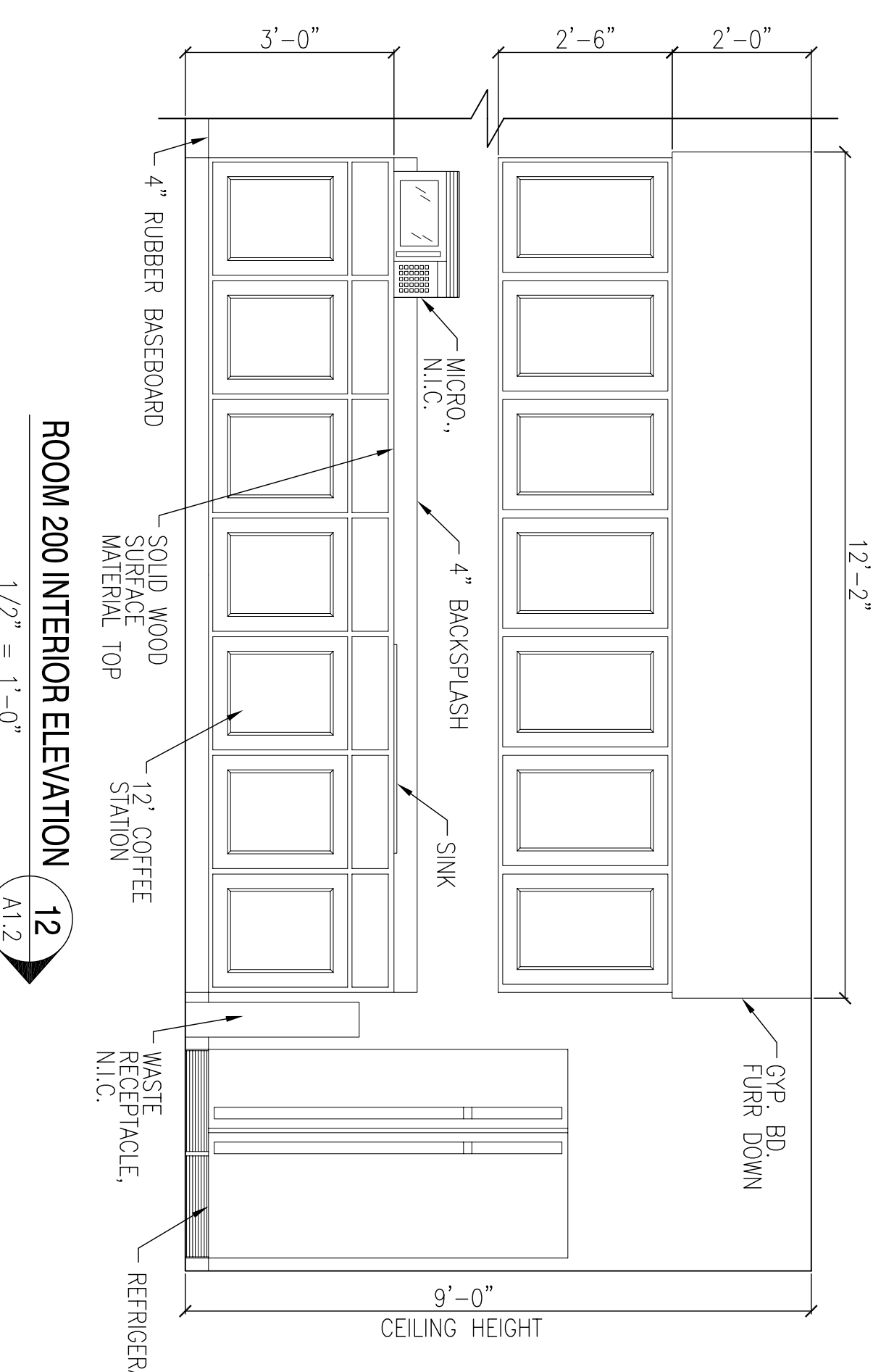

**ROOM 200 INTERIOR ELEVATION 12**  
 1/2" = 1'-0"  
 A1.2

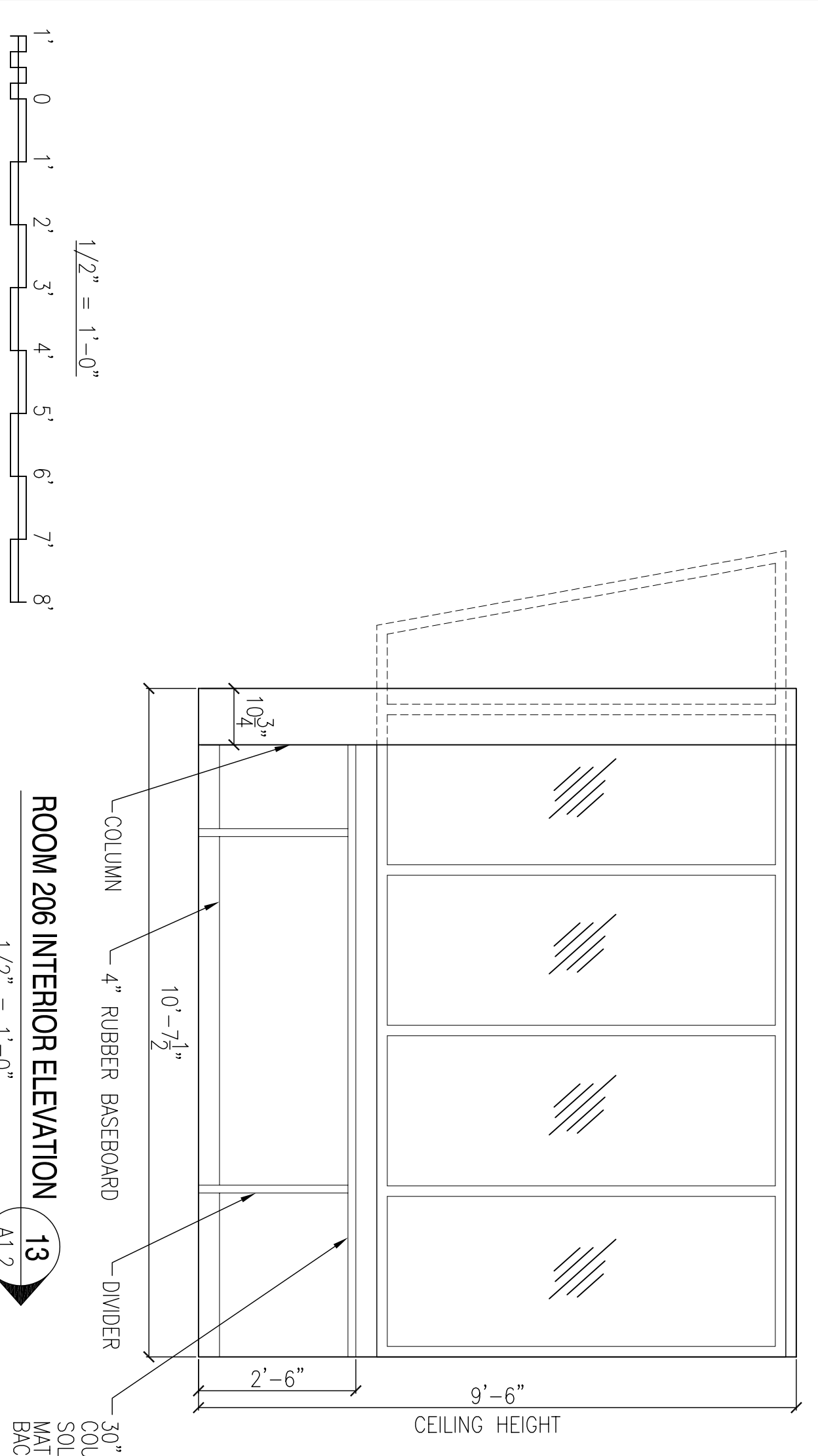

**ROOM 206 INTERIOR ELEVATION 13**  
 1/2" = 1'-0"  
 A1.2

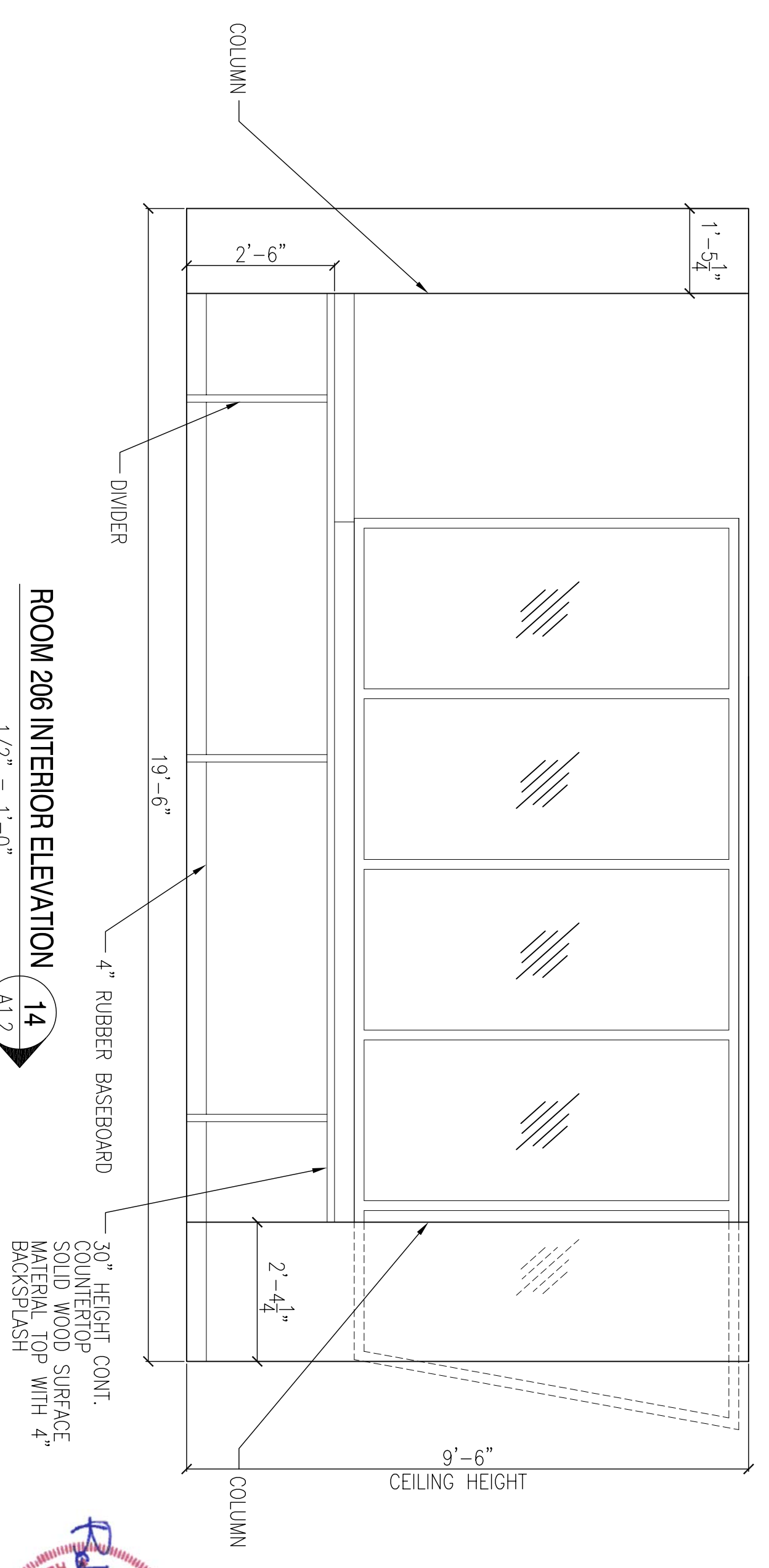

**ROOM 206 INTERIOR ELEVATION 14**  
 1/2" = 1'-0"  
 A1.2

SYM	DESCRIPTION	DATE	APPR

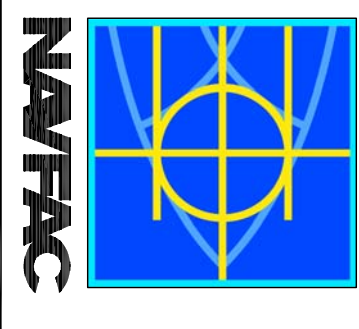

**DAMMON ENGINEERING, INC.**  
 1000 PINEAPPLE CIRCLE  
 SUITE 100  
 DARMON, LA 70028  
 (985) 649-8312



DESIGNED BY: R. WITSE  
 DRAWN BY: J. MEHANN  
 CHECKED BY: T. ARBIB  
 IN CHARGE: P. DAMMON

DEPARTMENT OF THE NAVY  
**NAVAL FACILITIES ENGINEERING COMMAND SOUTHEAST**  
 IPT GULF COAST  
 NAVAL AIR STATION JACKSONVILLE  
 MISSISSIPPI  
**JOHN C. STENNIS SPACE CENTER**  
**SOF RIVERINE AND COMBATANT CRAFT OPERATIONS FACILITY - PRE-FINAL**  
**BLDG. 2440/2441 INTERIOR ELEVATIONS**

SCALE: AS SHOWN  
 SHEET NO.: P-210  
 WORK ORDER NO.: 510247  
 CONTR. CENTER NO.: N62467-05-0-0096  
 DRAWING NUMBER: 15026994  
 DATE: 07/07/13

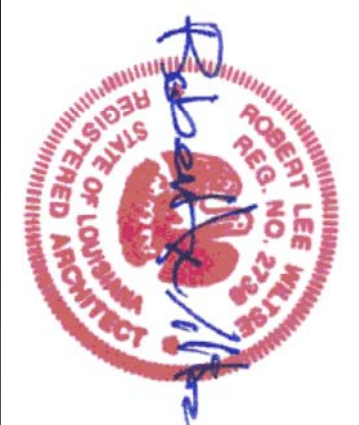

DATE: 07/07/13  
 SHEET: A1.17

REVDATE:

A  
 B  
 C  
 D  
 1  
 2  
 3  
 4  
 5