

ARMORY ROOF BELOW

MECH / ELEC

MALE HEAD

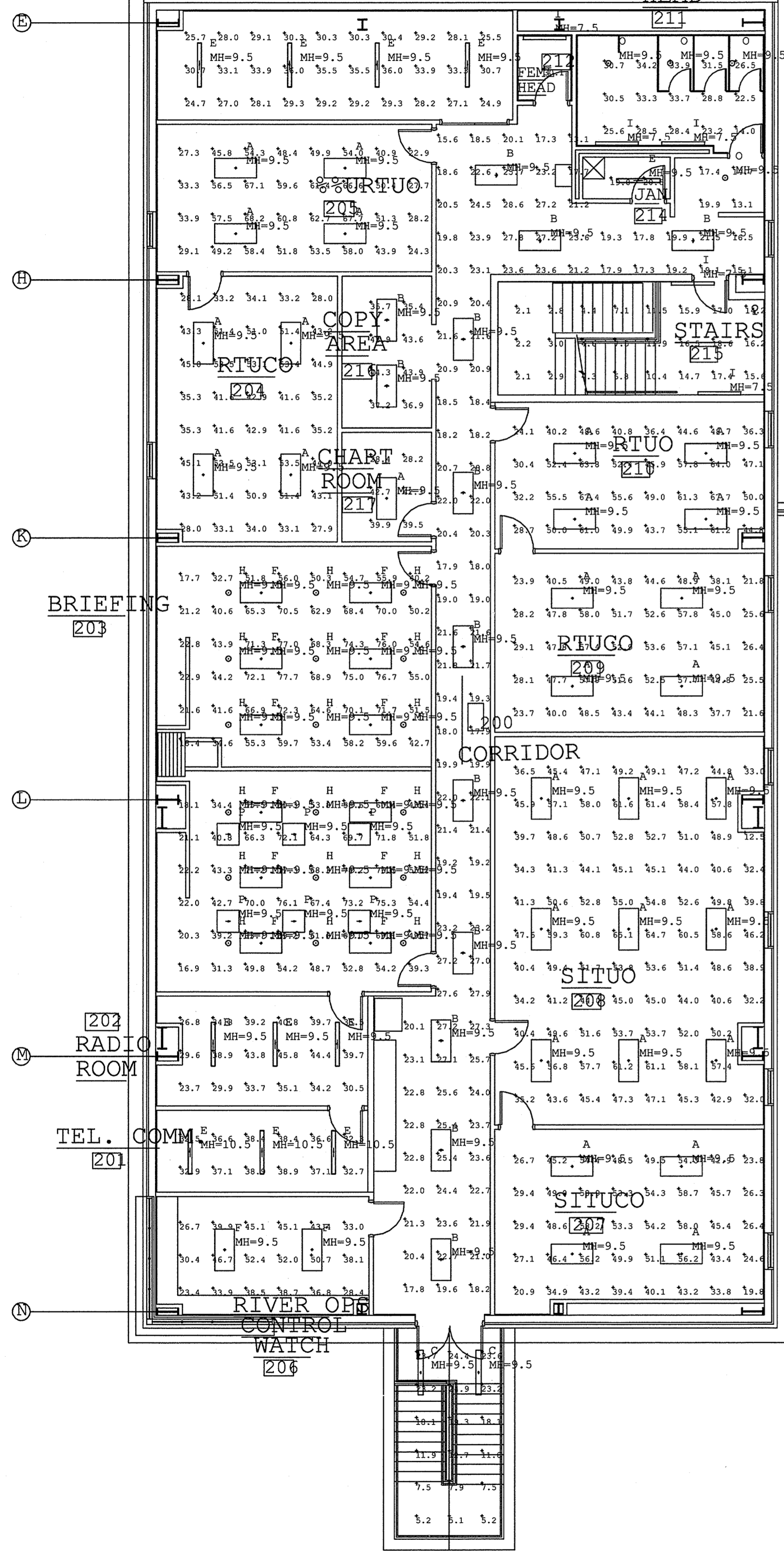

Luminaire Schedule

Symbol	Qty	Label	Arrangement	Lumens	LLF	Description
•	30	A	SINGLE	2850	0.752	2GR8-332A-UNV-GL-TEB81-RIF1-U
•	13	B	SINGLE	2850	0.752	2GR8-232A-UNV-GL-TEB81-RIF1-U
•	2	C	SINGLE	2850	0.752	VT2-232 DR-UNV-TEB81-WL-U
•	11	E	SINGLE	2850	0.752	SS-232-UNV-GL-TEB81-RIF1-WG/SS-4FT-B-U
•	14	F	SINGLE	2850	0.752	2GR8-332A-UNV-GL-TEB82-RIF1-U
○	18	H	SINGLE	3400	0.880	PD6-H142-2DMARX-6HC
○	5	I	SINGLE	2850	0.752	BC-232A-UNV-GL-TEB81-RIF1-U
○	4	O	SINGLE	1800	0.880	PD6-H142E-6HC-26WTTT
-	6	P	SINGLE	3150	0.752	240BXVT-TB

Calculation Summary

Label	CalcType	Units	Avg	Max	Min	Avg/Min	Max/Min
MECH ELEC 213 Workplane	Illuminance	Fc	30.08	36.0	24.7	1.22	1.46
CORR 200 Floor	Illuminance	Fc	21.28	28.6	13.1	1.62	2.18
JAN 214 Floor	Illuminance	Fc	19.80	20.6	19.0	1.04	1.08
MALE HEAD 211 Workplane	Illuminance	Fc	28.35	34.2	14.0	2.03	2.44
RTUCO 205 Workplane	Illuminance	Fc	48.89	68.2	22.9	2.13	2.98
COPY AREA 216 Workplane	Illuminance	Fc	40.11	44.3	35.4	1.13	1.25
CHART RM 217 Workplane	Illuminance	Fc	36.83	42.7	28.2	1.31	1.51
RTUCO 204 Workplane	Illuminance	Fc	42.16	53.5	27.9	1.51	1.92
FEMALE HEAD 212 Workplane	Illuminance	Fc	30.10	30.1	30.1	1.00	1.00
STAIRS 215 Floor	Illuminance	Fc	9.57	18.6	2.1	4.56	8.86
RTUCO 210 Workplane	Illuminance	Fc	48.96	67.7	24.1	2.03	2.81
RTUCO 209 Workplane	Illuminance	Fc	43.00	58.0	21.6	1.99	2.69
BRIEFING 203 (TOP) Workplane	Illuminance	Fc	54.82	77.7	17.7	3.10	4.39
SITUCO 208 Workplane	Illuminance	Fc	48.21	65.1	12.5	3.86	5.21
SITUCO 207 Workplane	Illuminance	Fc	43.09	58.9	19.8	2.18	2.97
RADIO RM 202 Workplane	Illuminance	Fc	35.89	45.8	23.7	1.51	1.93
TELECOMM 201 Workplane	Illuminance	Fc	36.03	38.9	32.3	1.12	1.20
RIVER OPS CTRL 206 Workplane	Illuminance	Fc	39.07	52.4	23.4	1.67	2.24
EXT STAIRS Floor	Illuminance	Fc	15.18	24.9	5.1	2.98	4.88
BRIEFING 203 (BOTTOM) Workplane	Illuminance	Fc	54.14	77.3	16.9	3.20	4.57

GENERAL NOTES THIS SHEET:

ALL FIXTURES TYPE A UNLESS NOTED OTHERWISE.

OPERATIONS BLDG 2440  
 2ND FLOOR PLAN - PHOTOMETRICS  
 SCALE: 1/8"=1'-0"



REVDATE: FILE NAME: C:\Schlafly\ENGR\0810\_SOF\_Riverine\Drawings\Photometrics\OPS level 1 Photometrics pre-final.dwg LAYOUT NAME: PH1.2 PLOTTED: Wednesday, May 13, 2009 - 12:39pm

DEPARTMENT OF THE NAVY  
 NAVAL FACILITIES ENGINEERING COMMAND SOUTHEAST  
 NAVAL AIR STATION JACKSONVILLE  
 MISSISSIPPI  
 JOHN C. STENNIS SPACE CENTER  
 SOF RIVERINE AND COMBATANT CRAFT OPERATIONS FACILITY  
 BLDG 2440 2ND FLOOR PHOTOMETRICS

DES: K. SCHLAFLY | DRW: K. SCHLAFLY  
 REVIEWED BY: R. WILTSE  
 PM/DW: T. ARTRIP  
 CHIEF ENG/ARCH: P. DAMMON

NAVFAC DRAWING NO. #####-##-####  
 SHEET XXX OF XXX

PH1.2

MAY 15, 2009

DRAWING REVISION: 01 JAN 2009