

BUILDING ELECTRICAL POWER PLAN  
SCALE: 1/4" = 1'-0"

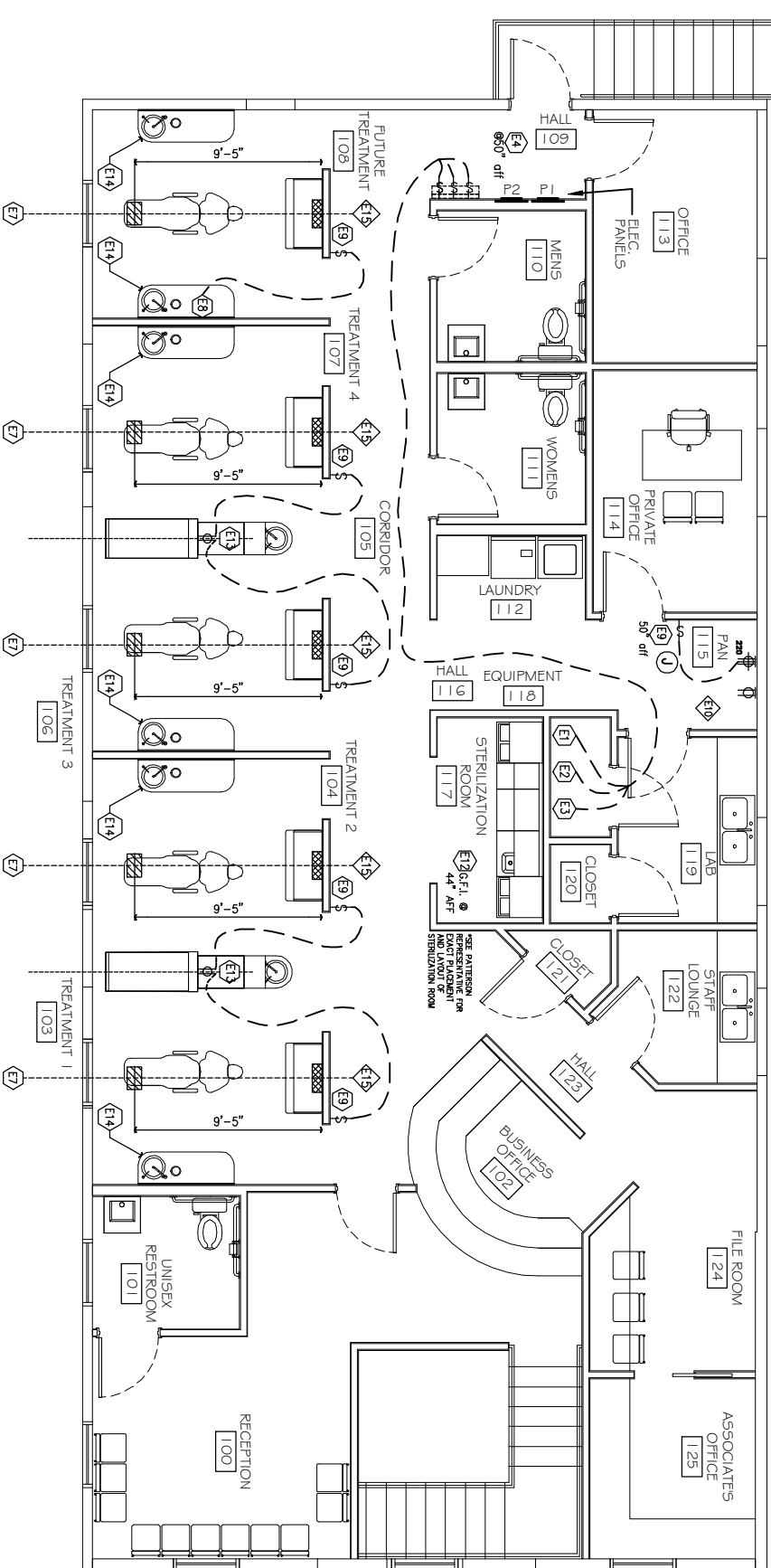

DENTAL EQUIPMENT POWER PLAN  
SCALE: 1/4" = 1'-0"

- POWER LEGEND**
- ⊖ - RECEPTACLE 20A 115V
  - ⊖ - RECEPTACLE 20A 115V MOUNTED ABOVE COUNTER TOP
  - ⊖ - DEDICATED COMPUTER RECEPTACLE 20A MOUNTED ABOVE COUNTER TOP
  - ⊖ - GFI RECEPTACLE 20A 115V
  - ⊖ - GFI RECEPTACLE 20A 115V MOUNTED ABOVE COUNTER TOP
  - ⊖ - DEDICATED RECEPTACLE 20A 115V
  - ⊖ - DEDICATED RECEPTACLE 20A 115V MOUNTED ABOVE COUNTER TOP
  - ⊖ - DEDICATED RECEPTACLE 20A 220V LOCATION BY PATTERSON
  - ⊖ - DEDICATED RECEPTACLE 20A OR 30A 230V (SEE PANEL) LOCATION BY PATTERSON WITH 24V TRANSFORMER
  - ⊖ - DEDICATED RECEPTACLE 10A 110V
  - ⊖ - DEDICATED RECEPTACLE 20A 120V RECESSED FLOOR MOUNTED
  - ⊖ - DATA DROP FOR COMPUTER
  - ⊖ - TELEPHONE
  - ⊖ - DATA OUTLET
  - ⊖ - CABLE TV
  - ⊖ - DISCONNECT

**DENTAL EQUIPMENT ELECTRICAL NOTES**

SYMBOL	DENTAL EQUIPMENT ITEM	SUPPLIED BY	NOTES
E1	AIR COMPRESSOR	PATTERSON DENTAL	ELECTRICIAN TO PROVIDE AND INSTALL 230V, 30 A, SEPARATE AND ISOLATED CIRCUIT @ 24" A.F.F. FROM WALL. SEE PATTERSON NUMBERED DRAWING FOR SPECIFIC EQUIPMENT REPRESENTATIVE FOR EXACT REQUIREMENTS OF EQUIPMENT
E2	VACUUM PUMP	PATTERSON DENTAL	ELECTRICIAN TO PROVIDE AND INSTALL 24V, 20A, SEPARATE AND ISOLATED CIRCUIT @ 60" A.F.F. FROM WALL. SEE PATTERSON NUMBERED DRAWING FOR SPECIFIC EQUIPMENT REPRESENTATIVE FOR EXACT REQUIREMENTS OF EQUIPMENT
E3	WATER FILTER	PATTERSON DENTAL	ELECTRICIAN TO PROVIDE 110V, 10A, SERVICE W/ 110V, X 24 VOLT TRANSFORMER AT LOCATION SHOWN.
E4	MASTER CONTROL PANEL	ELECTRICIAN	ELECTRICIAN TO PROVIDE AND INSTALL 4 SETS OF 4 CONDUCTOR #12 AWG LOW VOLTAGE WIRES FROM MASTER CONTROL PANEL TO THE FOLLOWING: - AIR COMPRESSOR - 1 SET - VACUUM PUMP - 2 SETS - WATER FILTER - 1 SET ELECTRICIAN TO ALSO PROVIDE 110V, SERVICE ABOVE CEILING AS SHOWN W/ 110V, X 24V, TRANSFORMER.
E5	DENTAL CHAIR	PATTERSON DENTAL	ELECTRICIAN TO PROVIDE AND INSTALL 120V, 20A, FLUSH MOUNTED, RECESSED RUNNING LOAD 2 AMPS.
E6	INTRA ORAL X-RAY	PATTERSON DENTAL	ELECTRICIAN TO PROVIDE AND INSTALL 120V, 20A, SEPARATE AND ISOLATED CIRCUIT TO LAMP 48" HGT. FROM WALL. CONTRACTOR TO PROVIDE 30" X 30" BACKING FROM 30" A.F.F. TO 24" A.F.F. FROM WALL. SEE PATTERSON NUMBERED DRAWING FOR SPECIFIC EQUIPMENT REPRESENTATIVE FOR EXACT REQUIREMENTS OF EQUIPMENT
E9	X-RAY REMOTE	ELECTRICIAN	ELECTRICIAN TO PROVIDE AND INSTALL TWO (2) #12 AWG LOW VOLTAGE CONTROL WIRES FROM X-RAY CONTROL TO LOCATIONS - AS SHOWN.
E10	PANORAMIC X-RAY	PATTERSON DENTAL	ELECTRICIAN TO PROVIDE AND INSTALL 230V, 20A, SEPARATE AND ISOLATED CIRCUIT, W/ PULG IN @ 12" A.F.F. AND 120V NON DEDICATED W/ PULG IN @ 12" A.F.F. CONTRACTOR TO PROVIDE AND INSTALL SOLID WOOD BACKING FROM FLOOR TO CEILING. PLEASE USE MINIMUM OF 2" X 8" TO HOLD 4000 LBS. FULL WEIGHT. CONTRACTOR TO PROVIDE 120V PLUG FOR COMPUTER MONITORATION WITH DATA DROP COMPUTER MONITOR PROVIDED AND LOCATED BY CLIENT.
E12	STERILIZATION CENTER	PATTERSON DENTAL	ELECTRICIAN TO PROVIDE AND INSTALL (2) TWO EACH 120V, 20A, NON-DEDICATED AND ISOLATED CIRCUIT (SERIES) THAT THIS IS NEEDED WITH A PATTERSON REMOTE BEFORE INSTALLATION. TO BE MADE UP IN WALL OUTLETS BY ELECTRICIAN @ LOCATION SHOWN. SEE TEMPLATE FOR DETAILS AND INSTRUCTIONS.
E13	CENTRAL CABINET W/ X-RAY	PATTERSON DENTAL	ELECTRICIAN TO PROVIDE AND INSTALL 120V, 10A, SERVICE IN QUAD BOX AS SHOWN ON TEMPLATE. DIRECT HOOKUP BY ELECTRICIAN.
E14	OPERATORY CABINET	PATTERSON DENTAL	ELECTRICIAN TO PROVIDE AND INSTALL 120V, 20A, SEPARATE AND ISOLATED CIRCUIT AS SHOWN. ELECTRICAL BOX AS SHOWN ON TEMPLATE.
E15	UNITY SERVICE CENTER	PATTERSON DENTAL	ELECTRICIAN TO PROVIDE AND INSTALL 120V, 10A, SERVICE IN QUAD ELECTRICAL BOX AS SHOWN ON TEMPLATE. SEE TEMPLATE FOR MORE DETAILS.



CHIEF ARCHITECT: KEVIN KINCHEN  
554 OLD SPANISH TRAIL  
SLIDE, LA 70458

dammoneengineering.com  
dammoneng@bellsouth.net  
PHONE: 985-649-5832  
FAX: 985-641-5950

OFFICE RENOVATION FOR  
DR. KRISTI SOILEAU, DDS, MED  
PERIODONTAL COSMETIC AND REGENERATIVE SURGERY  
3634 COLISEUM  
NEW ORLEANS, LOUISIANA

JOB No: 2188 DATE: 11-13-2013  
DRAWN BY: JTL CHECKED BY: CKD

The above drawings and specifications, designs and measurements represent the work and are not to be construed as a contract. All work shall be done in accordance with the specifications and drawings prepared and approved without written consent of Dammon Engineering, Inc. All work shall be done in accordance with the specifications and drawings prepared and approved without written consent of Dammon Engineering, Inc. All work shall be done in accordance with the specifications and drawings prepared and approved without written consent of Dammon Engineering, Inc.

REVISIONS		DATE
#	DESCRIPTION	

ELECTRICAL  
POWER PLAN

SHEET No: 13 OF 15

E-1