

SOUTH RANGE AVENUE (A/K/A/ LA. HWY 3002)

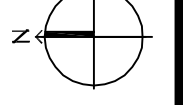

1 SITE PLAN
SCALE: 1" = 20'-0"

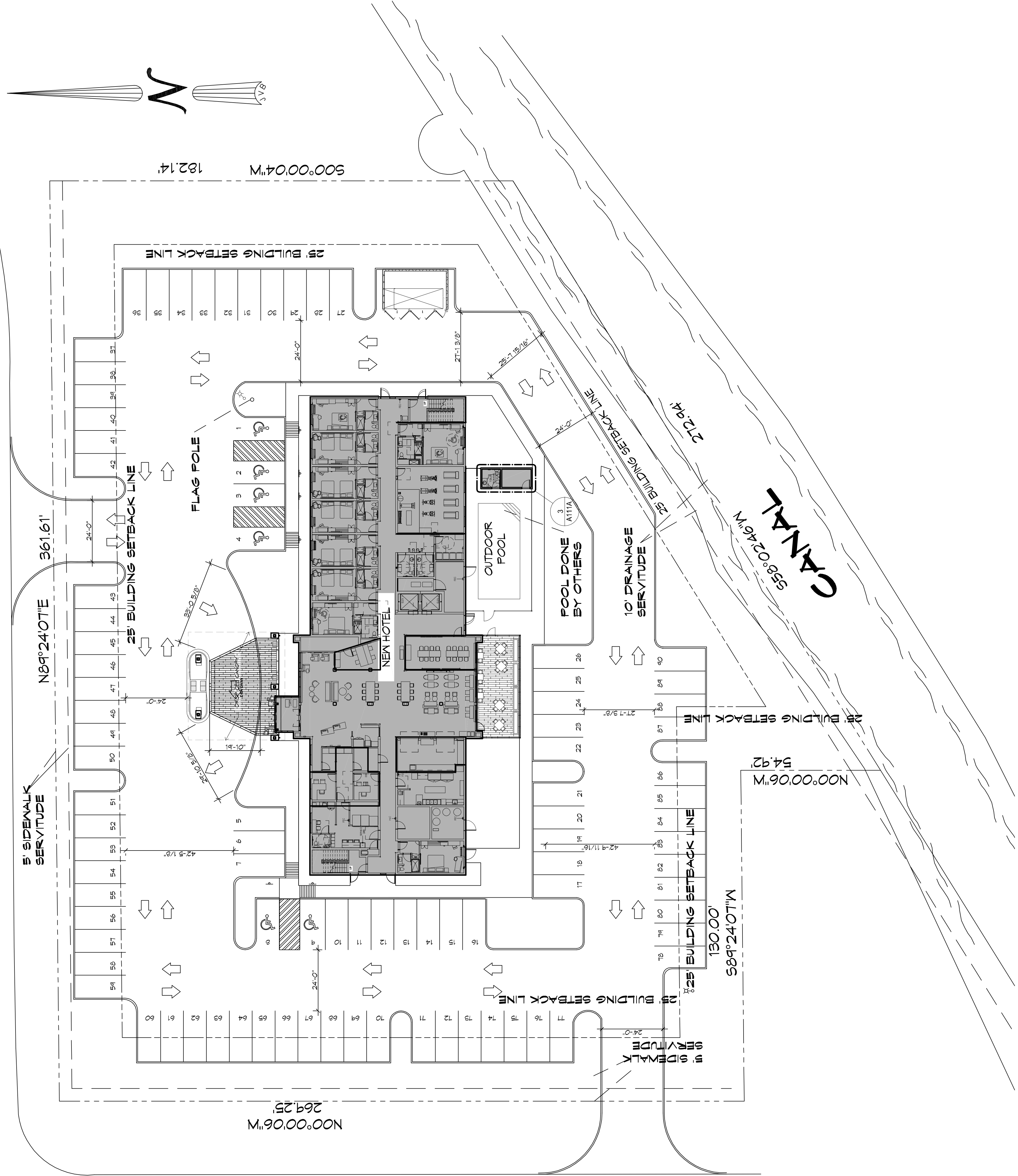

PLANNING	PARKING REQUIREMENTS	BUILDING ELEVATION
<p>ZONED - CS COMMERCIAL</p> <p>PROJECT HOLIDAY INN EXPRESS</p> <p>(4) FOUR STORY WITH (81) EIGHTY ONE GUEST ROOMS</p> <p>(9) NINE ON FIRST LEVEL (24) TWENTY FOUR ON SECOND LEVEL (24) TWENTY FOUR ON THIRD LEVEL (24) TWENTY FOUR ON FOURTH LEVEL TOTAL = 81 ROOMS</p> <p>TOTAL SQUARE FOOTAGE = 47,649 SQ. FT. FIRST LEVEL = 12,011 SQ. FT. SECOND LEVEL = 11,846 SQ. FT. THIRD LEVEL = 11,846 SQ. FT. FOURTH LEVEL = 11,846 SQ. FT.</p> <p>FIRST FLOOR ROOMS: (1 GUESTROOMS TOTAL) DOUBLE QUEEN = 5 EA. ACCESS X-WIDE KING = 1 EA. KING = 3 EA.</p> <p>SECOND, THIRD, & FOURTH FLOOR ROOMS: (24 GUESTROOMS EACH FLOOR) DOUBLE QUEEN = 12 EA. DOUBLE QUEEN SUITE = 3 EA. KING = 4 EA. KING SUITE = 3 EA. X-WIDE KING+2</p> <p>TOTAL ROOM BREAK DOWN: DOUBLE QUEEN = 44 EA. DOUBLE QUEEN SUITE = 9 EA. KING = 15 EA. KING SUITE = 9 EA. X-WIDE KING+2</p> <p>TOTAL GUESTROOMS = 81 EA.</p>	<p>TOTAL PARKING SPACES REQUIRED (1/GUEST BEDROOM) = 81 TOTAL SPACES PROVIDED = 92, INCLUDING 6 HANDICAP.</p>	<p>FLOOD ZONE</p> <p>ZONE 'AE'</p> <p>BASE FLOOD ELEVATION = 34' FINISHED FLOOR ELEVATION = 34'</p>

REVISIONS	DESCRIPTION	DATE

DRAWN BY: JAGM	CHECKED BY: JAGM	DATE: 12-27-17
JOB NO: 2321		
LOCATION NUMBER: 10777		
SHEET TITLE: SITE PLAN		
DRAWING NUMBER: C100		

DAMMON ENGINEERING INC.
LOUISIANA & MISSISSIPPI

Chief Engineer: Brian Mitchell, PE
554 Old Spanish Trail
Sibley, LA 70468
www.dammonengineering.com
info@dammonengineering.com
PH: 985.649.5832