

SECOND FLOOR PLAN (EITHER SCHEME)
SCALE: 1/8" = 1'-0"
32 GUEST ROOMS

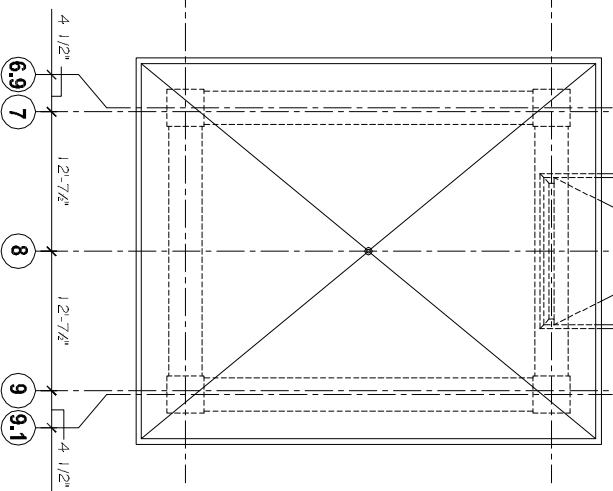

PRELIMINARY (NOT FOR CONSTRUCTION)

REVISIONS	
#	DESCRIPTION

DATE	DESCRIPTION

LAQUINTA INNS & SUITES
HATTIESBURG, MISSISSIPPI

2158 12-19-2012

JTL

DAMMON ENGINEERING, INC.

CHIEF ENGINEER: EMMETT DAMMON, P.E.
554 OLD SPANISH TRAIL
SUDELL, LA 70458

dammonengineering.com
dammoneng@bellsouth.net
PHONE: 905-649-5832
FAX: 905-641-5950