

FINISH LEGEND - INTERIOR

MARK	DESCRIPTION	MODEL	COMMENTS
ACT-2	SUSPENDED VINYL CEILING	"ARMSTRONG" CLEAN ROOM #870, 24"x48"x5/8" OR, WHITE VINYL COVERED 5/8" GYP. BD. ON WHITE GRID.	
ACT-4	SUSPENDED VINYL CEILING	"ARMSTRONG" CLEAN ROOM #870, 24"x24"x5/8" OR, WHITE VINYL COVERED 5/8" GYP. BD. ON WHITE GRID.	
BS-4	COVE BASE	E-QUARRY - EUGENE - 6" X 6"	NICOLE LYONS (704) 517-4461 NICOLELYONS@EMSER.COM
BS-5	TILE BASE	EMSER WOODWORK, EUGENE - 6"X39"	NICOLE LYONS (704) 517-4461 NICOLELYONS@EMSER.COM
FRP-4	FIBERGLASS REINFORCED PANELS	MARLITE, STANDARD FRP, COLOR: P118 NATURAL ALMOND, 4' WIDE	
FT-60	WOOD LOOK FLOOR TILE	WOOD LOOK TILE - GENERAL FLOOR, EMSER WOODWORK, EUGENE - 8"X39", 1/3 RUNNING BOND	GROUT, LATICRETE SPECTRALOCK 2000 IS 67 AUTUMN GREEN, 3/16" WIDE. NICOLE LYONS (704) 517-4461 NICOLELYONS@EMSER.COM
FT-61	PORCELAIN FLOOR TILE	QUARRY TILE, EMSER E-QUARRY, BRICK - 6" X 6" X 3/8" THICK	GROUT, LATICRETE SPECTRALOCK 2000 IS 67 AUTUMN GREEN, 3/16" THICK. NICOLE LYONS (704) 517-4461 NICOLELYONS@EMSER.COM
LM-37	LAMINATE	WILSONART "BLACK" 1595-60	
LM-38	LAMINATE	WILSONART - DOVE GREY "D92-60"	
PT-59	PAINT	LATEX PAINT, 2147-70 ALPINE WHITE, SEMI GLOSS	
PT-60	PAINT	SUPER SPEC HP D.T.M ALKYD; MATCH TO "BOJ. RED" RAL 3011, CALIENTE AF-290, SEMI GLOSS	
PT-61	PAINT	SHERWIN WILLIAMS - CHARCOAL GREY	
SS-20	WALL CAPS & WINDOW SILL	DUPONT CORIAN - MANDARIN, THICKNESS: 12MM (1/2"), 3/4" EDGE	WILLIAM LEE WILLIAM.DAVID.LEE@DUPONT.COM
SS-21	BEV. STATION & CONDIMENT COUNTER	DUPONT CORIAN - COSMOS PRIMA, THICKNESS: 12MM (1/2")	WILLIAM LEE WILLIAM.DAVID.LEE@DUPONT.COM
TR-8	3/8" TILE TRIM	EMSER/BLANKE CUBELINE 740-2808-10025 BRUSHED STAINLESS STEEL 3/8" HIGH, 8" LENGTH	NICOLE LYONS (704) 517-4461 NICOLELYONS@EMSER.COM
TR-9	OUTER CORNER SQUARE PIECE	EMSER/BLANKE CUBELINE 740-2808-100 BRUSHED STAINLESS STEEL 3/8" HIGH, 8" LENGTH	NICOLE LYONS (704) 517-4461 NICOLELYONS@EMSER.COM
WT-5	SERVERY WALL TILE	CITIZEN-CIVILIAN, MATTE, 12" X 24"; STACKING BOND	
WT-6	WALL TILE	SADDLE BROOK - OAK TRAIL SD13 6" X 36; RUNNING BOND	

FINISH LEGEND - EXTERIOR

MARK	DESCRIPTION	MODEL	COMMENTS
BR-3	FACE BRICK	ACME BRICK - BLEND 030 "DOVE GRAY - KING SIZE; STANDARD GRAY MORTAR	
EIFS-3	EIFS	"DRYVIT" INSULATION SYNTHETIC PLASTER WALL SYSTEM ON "DRYVIT" INSULATION BOARD. COLOR: MATCH STO 16279	
EIFS-4	EIFS	"DRYVIT" INSULATION SYNTHETIC PLASTER WALL SYSTEM ON "DRYVIT" INSULATION BOARD. COLOR: MATCH STO 16279	ON ALL EXPOSED CONCRETE STEMWALLS; ABOVE SIDEWALKS. (IF REQUIRED)
FC-1	FIBER CEMENT PANELS	NICHIHA, ILLUMINATION - AWP 1818 X 6' L. COLOR: SHERWIN WILLIAMS SW 7518 "BEACH HOUSE" 288-C3	
FC-2	FIBER CEMENT PANELS	NICHIHA, ILLUMINATION - AWP 1818 X 6' L. COLOR: SHERWIN WILLIAMS SW 7526 "MAISON BLANCHE" 288-C1	
FC-3	FIBER CEMENT PANELS	NICHIHA, ILLUMINATION - AWP 1818 X 6' L. COLOR: SHERWIN WILLIAMS SW 7519 "FRESCO CREAM" 288-C2	
MT-1	PRE-FINISHED METAL COPING CAP	COLOR TO MATCH C-STORE EIFS-1, UNO	
PTX-4	ORANGE (MATCH CANOPIES)	SHERWIN WILLIAMS CO. INDUSTRIAL ENAMEL CUSTOM COLOR - MATCH PANTONE COLOR 173 C (ORANGE)	(IF REQUIRED)

FLOOR FINISH TOTALS FOOD TENANT

MARK	DESCRIPTION	SF
FT-60	WOOD LOOK FLOOR TILE	1484 SF
FT-61	PORCELAIN FLOOR TILE	1944 SF

ROOM FINISH SCHEDULE

ROOM NUMBER	ROOM NAME	FLOOR FINISH	BASE FINISH	TYPICAL SUBSTRATES				FINISHES				CEILING FINISH	COMMENTS
				1	2	3	4	1	2	3	4		
201	DINING	FT-60	PER ELEVS	5/8" DENS SHIELD	5/8" DENS SHIELD	5/8" DENS SHIELD	5/8" DENS SHIELD	PER ELEVS	PER ELEVS	PER ELEVS	PER ELEVS	ACT-4	
202	SERVICE	FT-61	BS-4/BS-5	5/8" DENS SHIELD	5/8" DENS SHIELD	NONE	5/8" DENS SHIELD	PER ELEVS	PER ELEVS	NONE	PER ELEVS	REF BGA121	
203	PREP	FT-61	BS-4	PER PLANS	PER PLANS	PER PLANS	PER PLANS	PER PLAN	PER PLAN	PER PLAN	PER PLAN	ACT-2	
204	OFFICE	FT-61	BS-4	5/8" GYP BD	5/8" GYP BD	5/8" GYP BD	5/8" GYP BD	FRP-4	FRP-4	FRP-4	FRP-4	ACT-2	
205	FREEZER	FACTORY	FACTORY	NONE	NONE	NONE	NONE	FACTORY	FACTORY	FACTORY	FACTORY	FACTORY	
206	COOLER	FT-61	NONE	NONE	NONE	NONE	NONE	FACTORY	FACTORY	FACTORY	FACTORY	FACTORY	
207	CHICKEN COOLER	FT-61	NONE	NONE	NONE	NONE	NONE	FACTORY	FACTORY	FACTORY	FACTORY	FACTORY	

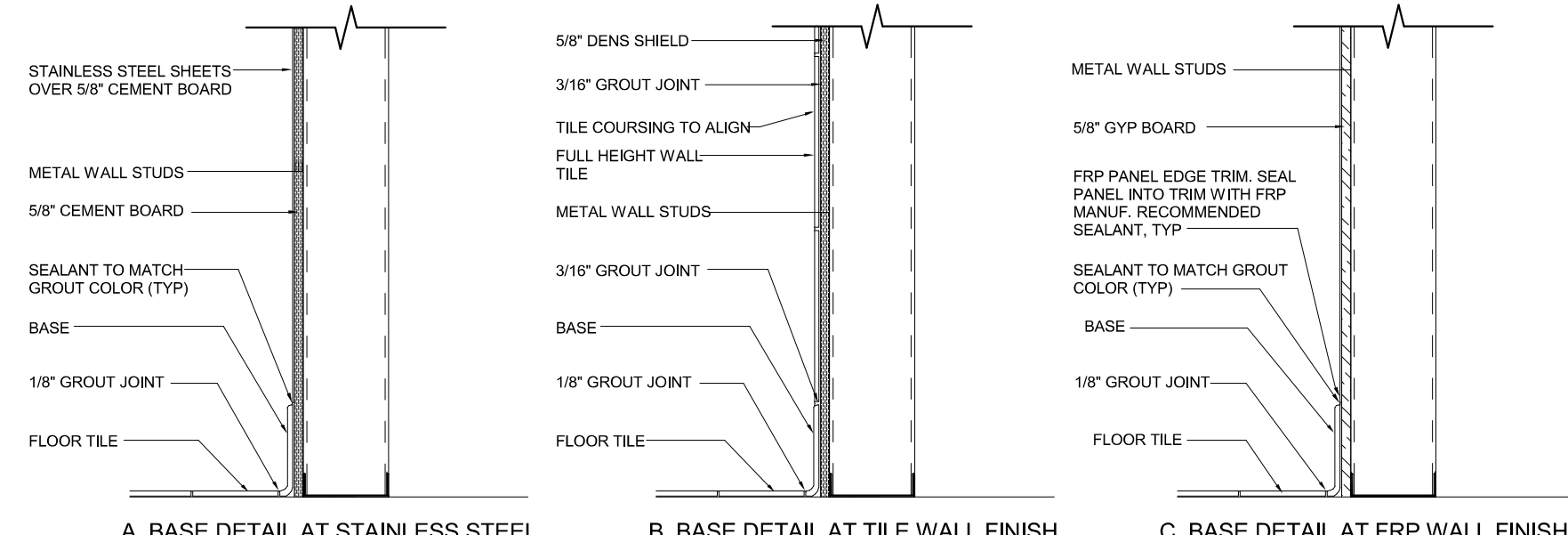

2 BASE DETAIL
1" = 1'-0"

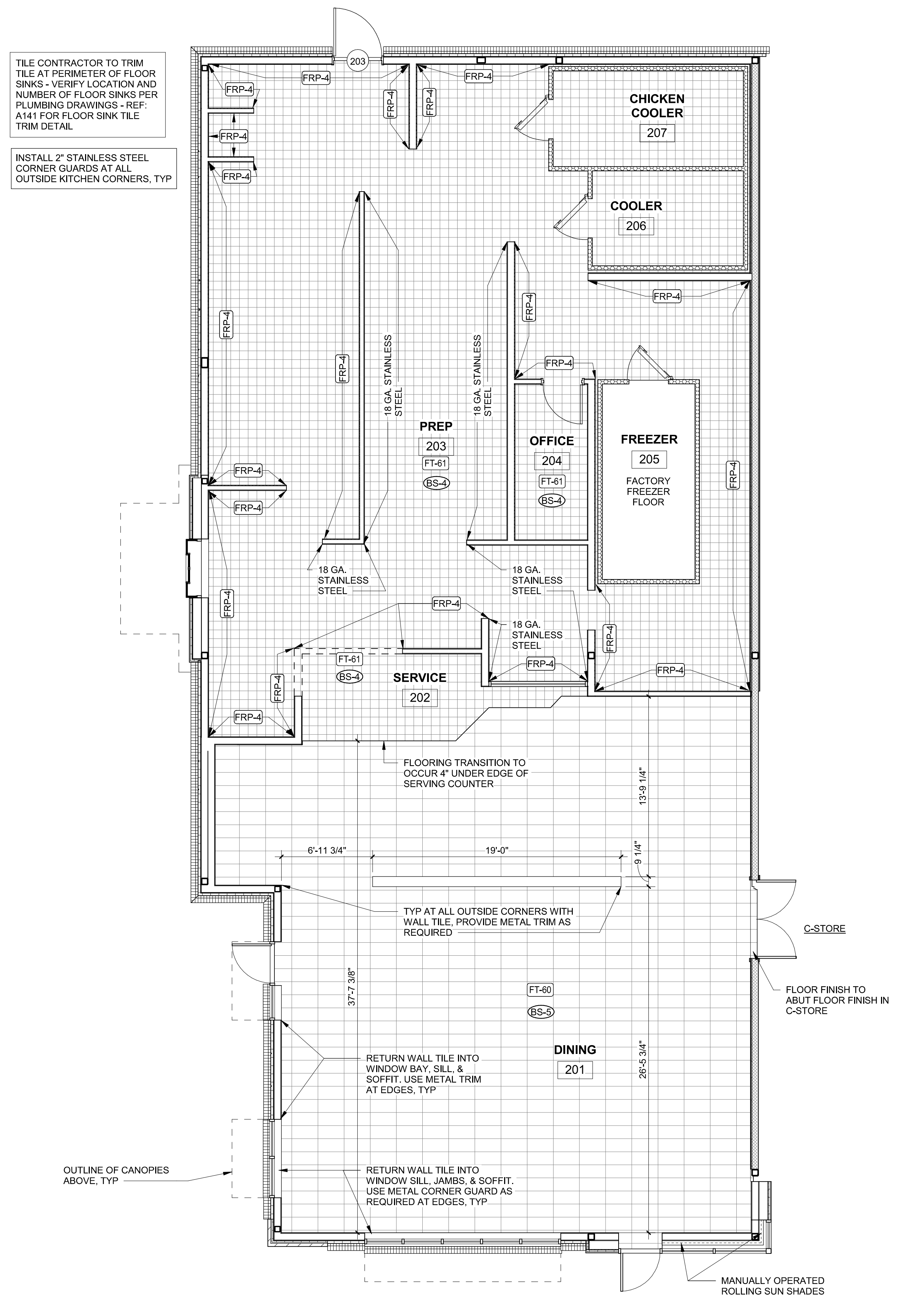

1 FINISH PLAN
3/16" = 1'-0"

HFA
HARRISON FRENCH
& ASSOCIATES, P.L.L.C.
t 479.273.7780
1705 S. Walton Blvd., Suite 3
Bentonville, Arkansas 72712
www.hfa-ac.com

STIPULATION FOR REUSE
THIS DRAWING HAS BEEN PREPARED FOR USE ON A SPECIFIC SITE AT THE CONTINGENT OF THE ARCHITECT'S CONTINGENT LIABILITY. WITH THIS ISSUE, THE ARCHITECT'S LIABILITY IS LIMITED TO THE DESIGN OF THE PROJECT. THE ARCHITECT IS NOT RESPONSIBLE FOR THE PERFORMANCE OF THE PROJECT OR FOR ANY OTHER PROJECTS. THE ARCHITECT'S LIABILITY IS LIMITED TO THE DESIGN OF THE PROJECT. THE ARCHITECT IS NOT RESPONSIBLE FOR THE PERFORMANCE OF THE PROJECT OR FOR ANY OTHER PROJECTS.

Loves
STORE NUMBER: 860
I-59, EXIT 1
NICHOLSON, MS 39466
JOB NUMBER: 03-23-30009

ISSUE BLOCK

CHECKED BY: MAP
DRAWN BY: ASE
DOCUMENT DATE: 02/06/23
PROTO: BOJANGLES
PROTO CYCLE: Q4 - 2022

REGISTERED ARCHITECT
BOGUE L. EBBRECHT
4925
STATE OF MISSISSIPPI
Bogue Louis Ebbrecht
15.05.25-0907

FINISH PLAN AND SCHEDULES

SHEET:
BGA141