

REVISION HISTORY		REVISION	DESCRIPTION	DRAWN BY	CHECKED BY	APPROVED	DATE
1	FIRST ISSUE	W.W.	B.H.	S.B.	S.B.	17.01.13	
2	DRAWING & QUANTITIES UPDATED	R.A.	S.B.	S.B.	S.B.	06.02.13	

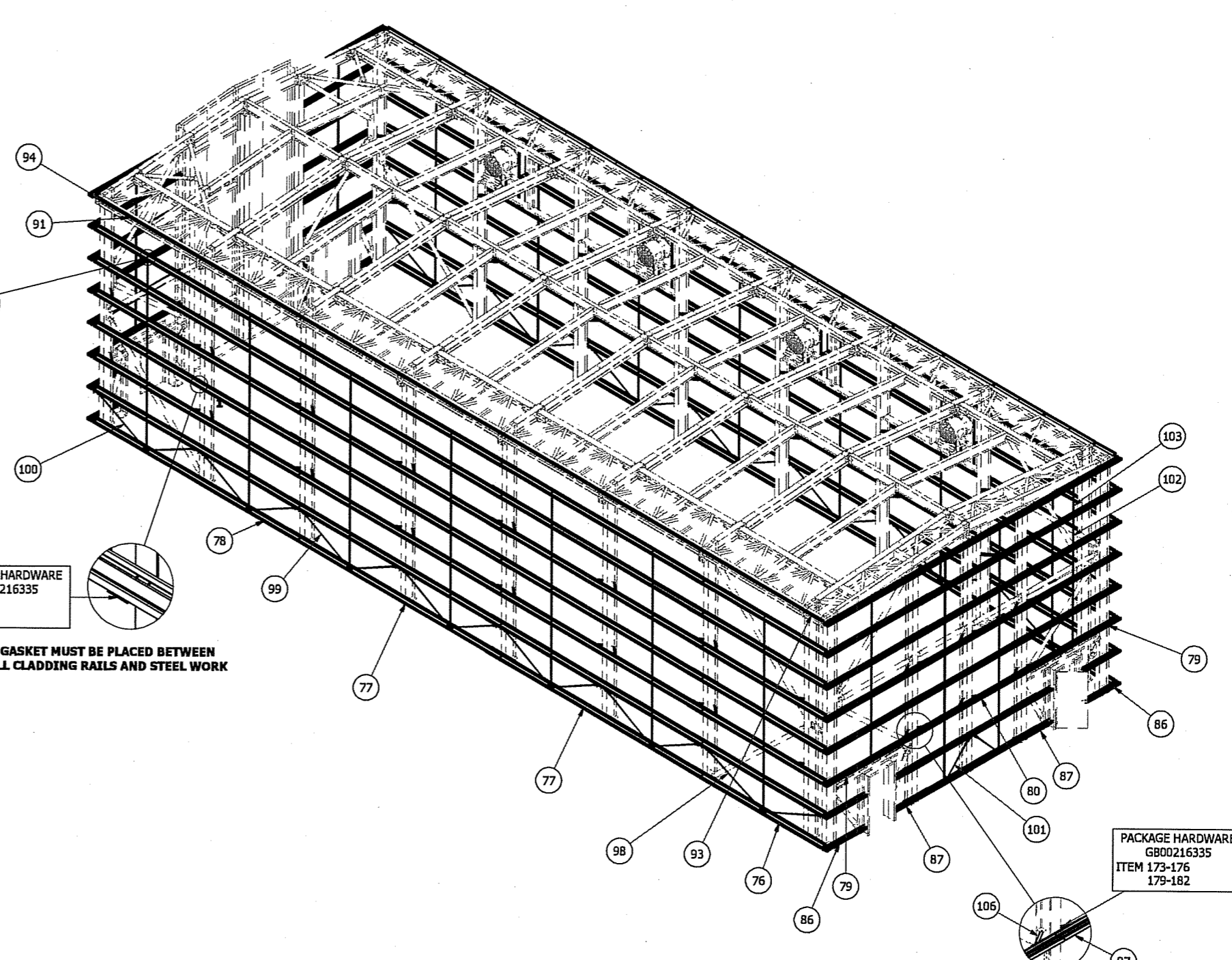
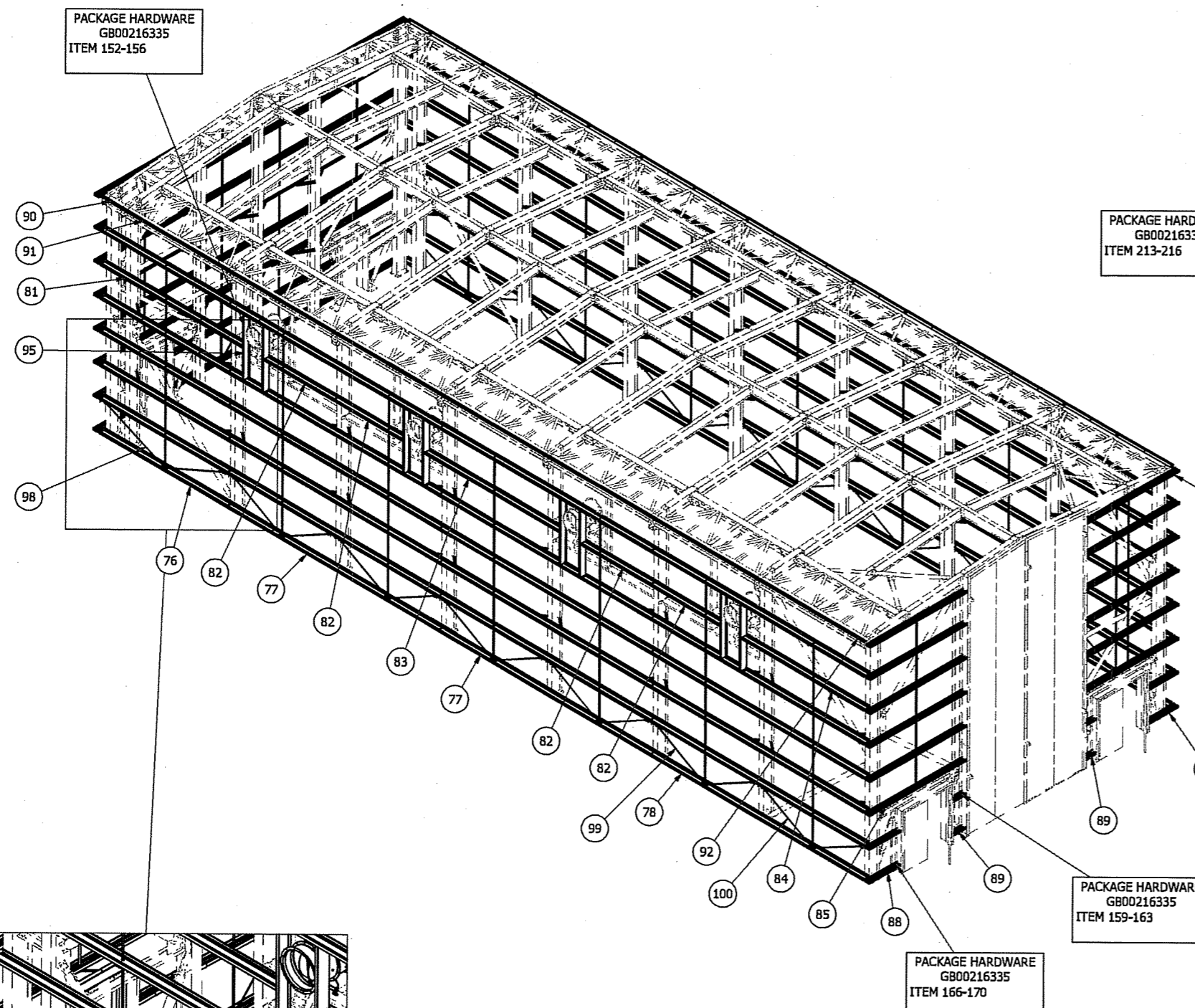

STAGE 6
THIS VIEW SHOWS THE INSTALLATION OF THE CLADDING RAILS AS PER DRAWING GB00214116

ITEM	QTY	PART NUMBER	DESCRIPTION	PCD REMARKS
106	12	GB00214117	RESTRAINT RNB BRACING MARKED '214117-31'	
105	56	GB00214117	RESTRAINT RNB BRACING MARKED '214117-30'	
104	32	GB00214117	CLADDING RAIL END CAP MARKED '214117-29'	
103	6	GB00214117	TUBE STRUT TSA MARKED '214117-28'	
102	112	GB00214117	TUBE STRUT TSA MARKED '214117-27'	
101	2	GB00214117	DIAGONAL TIE WIRE MARKED '214117-26'	
100	2	GB00214117	DIAGONAL TIE WIRE MARKED '214117-25'	
99	10	GB00214117	DIAGONAL TIE WIRE MARKED '214117-24'	
98	2	GB00214117	DIAGONAL TIE WIRE MARKED '214117-23'	
97	16	GB00214117	CLADDING RAIL SLEEVE MARKED '214117-22'	
96	40	GB00214117	CLADDING RAIL SLEEVE MARKED '214117-21'	
95	8	GB00214117	CLADDING RAIL FRAME MARKED '214117-20'	
94	1	GB00214117	OPP HAND TOP FORMED CHANNEL MARKED '214117-19'	
93	1	GB00214117	OPP HAND TOP FORMED CHANNEL MARKED '214117-18'	
92	1	GB00214117	TOP FORMED CHANNEL MARKED '214117-17'	
91	26	GB00214117	TOP FORMED CHANNEL MARKED '214117-16'	
90	1	GB00214117	TOP FORMED CHANNEL MARKED '214117-15'	
89	4	GB00214117	PURLIN MARKED '214117-14'	
88	4	GB00214117	PURLIN MARKED '214117-13'	
87	4	GB00214117	PURLIN MARKED '214117-12'	
86	4	GB00214117	PURLIN MARKED '214117-11'	
85	12	GB00214117	PURLIN MARKED '214117-10'	
84	1	GB00214117	PURLIN MARKED '214117-9'	
83	1	GB00214117	PURLIN MARKED '214117-8'	
82	4	GB00214117	PURLIN MARKED '214117-7'	
81	1	GB00214117	PURLIN MARKED '214117-6'	
80	8	GB00214117	PURLIN MARKED '214117-5'	
79	12	GB00214117	PURLIN MARKED '214117-4'	
78	13	GB00214117	PURLIN MARKED '214117-3'	
77	26	GB00214117	PURLIN MARKED '214117-2'	
76	13	GB00214117	PURLIN MARKED '214117-1'	

	Project: Ninemile Unit 6
SSW #: 143209-P610-01-00287 Issue: A	Job No.: 143209
Client #:	
Vendor #: GB00217621 - SHEET 5 OF 9	
Equipment/Tag No.:	SORVD Number: NPV
Review Status:	
<input checked="" type="checkbox"/> For Information	<input type="checkbox"/> Accepted as Noted (Do Not Resubmit)
<input type="checkbox"/> Accepted	<input type="checkbox"/> Accepted As Certified
<input type="checkbox"/> Accepted as Noted (Resubmit)	<input type="checkbox"/> Revise & Resubmit
Released For: <input type="checkbox"/> Design <input type="checkbox"/> Material Procurement <input checked="" type="checkbox"/> Fabrication <input type="checkbox"/> Construction	
Eng Review Due Date: 3/21/2013 12:21:22 PM	
Signed By: <i>K. Beatty</i>	Beatty, Ken
Date: 3/21/13	
THE ACCEPTANCE OF THIS DATA DOES NOT RELIEVE THE (SUB)CONTRACTOR OR SUPPLIER FROM THE OBLIGATION IMPOSED BY THE PURCHASE ORDER (PO) OR (SUB) CONTRACT	

Dammon Engineering, Inc.
554 Old Spanish Trail
Slidell, LA 70458

NOTICE: THIS DRAWING IS THE PROPERTY OF AAF LTD AND IS LOANED SUBJECT TO THE CONDITION THAT IT SHALL NOT BE COPIED, LOANED OR SUBMITTED TO OUTSIDE PARTIES FOR EXAMINATION WITHOUT WRITTEN CONSENT

FIRST ANGLE PROJECTION

TITLE
ISO BUILD SEQUENCE OF ACOUSTIC ENCLOSURE

CLIENT: TOSHIBA
PROJECT: NINE MILE USA

DRAWING SIZE - A1 DRAWING REV - 2

FIRST ORDER NUMBER MX12027

DRAWING NUMBER
GB00217621

SCALE

DRAWN BY W.W. DATE 03/12/2012

CHECKED BY R.A. DATE 17/01/2013

APPROVED BY S.B. DATE 21/01/2013

WEIGHTS STATED ON THIS DRAWING ARE FOR REFERENCE ONLY AND DO NOT FORM THE BASIS OF A CONTRACT BETWEEN AAF LTD AND THE SUB-CONTRACTOR

AAFLtd
Designation Lane
Crestfield
Northumberland
United Kingdom
NE23 8AF
Tel: 01629 212472
Fax: 01629 214279

Sheet 5 of 9