

CODE COMPLIANCE & REQUIREMENTS

- THE AQUATIC FACILITY SHALL BE IN COMPLIANCE WITH THE MODEL AQUATIC HEALTH CODE (MAHC).
- POOL SHALL HAVE WHITE PLASTER FINISH.
- ALL WALLS SHALL BE VERTICAL AND PLUMB, WITH 1 ° TOLERANCE FROM PLUMB ALLOWED.
- ALL POOL FLOOR SLOPES SHALL MEET OR FALL WITHIN THE TOLERANCES LISTED IN THE MAHC. (SEE PLAN SHEET PL-1.0 , UNDER PLAN SPECIFIC NOTES)
- THE MINIMUM WATER DEPTH FOR THE POOL CAN BE IDENTIFIED AS 3'-6" PER PLAN SHEETS PL-1.0 AND PL-1.1. ALL WATER DEPTHS FOR THE POOL ARE SHOWN ON PLAN SHEETS PL-1.0 AND PL-1.1.
- THE MAXIMUM BATHER LOAD IS 20 SQ. FT. OF WATER SURFACE AREA PER BATHER. (SEE PLAN SHEET PL-1.1)
- ALL SURROUNDING POOL DECK (INCLUDING COPING IS TO MAINTAIN A MINIMUM OF 4 FT DEPTH OF POOL DECK. ALL COPING, AND FINISHED SURFACE OF POOL DECK SHALL RECEIVE A SLIP RESISTANT FINISH.
- POOL DECK CONSTRUCTION SHALL BE IN FULL CONFORMANCE WITH ALL APPLICABLE CODES AND STANDARDS, AND THE ENGINEER'S STRUCTURAL SPECIFICATIONS.
- TWO HANDRAILS PROVIDE THE MINIMUM OF TWO MEANS OF ENTRY/EXITS.
- ALL STEP TREAD DEPTHS ARE 24 INCHES, AND ALL RISERS ARE 12" INCHES PER SHEET PL-1.2 ON DETAIL 04, TREAD DEPTH, AND MEETING THE UNIFORM HEIGHT OF 12 INCHES MAXIMUM RISER HEIGHT.
- THE WATER VELOCITY FOR SUCTION PIPING, DOES NOT EXCEED 6 FEET PER SECOND, AND THE WATER VELOCITY FOR RETURN PIPING DOES NOT EXCEED 10 FEET PER SECOND. AS SHOWN ON PLAN SHEET PL-1.2, IN THE PIPE IDENTIFICATION LEGEND.
- AN IMPACT FLOW METER IS REQUIRED ON TO MEASURE THE RATE OF FLOW THROUGH THE FILTER SYSTEM. SEE PLAN SHEET POOL SYSTEM SCHEMATIC, AND POOL EQUIPMENT LEGEND ON PLAN SHEET PL-1.4 FOR LISTED FLOW METER.
- ALL RETURN INLETS IN THE POOL ARE 3/4" ADJUSTABLE EYEBALL INLETS, AS NOTED THROUGHOUT THE PLAN SET.
- PER LAC TITLE 51 XXIV.511.C, TWO MAIN DRAINS ARE TO BE PROVIDED AS SHOWN THROUGH OUT THE PLANS, AND IDENTIFIED ON PLAN SHEET PL-1.5. ALL MAIN DRAIN GRATES ARE TO BE WHITE COLORED, AND TO BE PROVIDED WITH A CONTRASTING COLORED FRAME SO AS TO EASILY BE IDENTIFIED, AND IN COMPLIANCE WITH LAC TITLE 51 XXIV.511.C.3
- PER LAC TITLE 51 XXIV.515.B, ONE SKIMMER FOR THE POOL SHALL BE PROVIDED FOR EVERY 500 SQUARE FOOT OF WATER SURFACE AREA. FOR THIS POOL DESIGN, A TOTAL WATER SURFACE AREA OF 796 SQUARE FEET IS ADDRESSED WITH THE PROVISION OF 2 SURFACE SKIMMERS.
- PER LAC TITLE 51 XXIV.701, DEPTH MARKERS ARE PROVIDED AS SLIP RESISTING, ON BOTH THE DECK, AND IN CORRESPONDING LOCATIONS WITHIN THE WATERLINE TILE BAND, AND ARE PLACED AND SPACED IN FULL COMPLIANCE WITH THE CODE REQUIREMENTS OF THE CURRENT CODE SPECIFICATION REFERENCED.
- LIFE SAVING EQUIPMENT FOR THIS POOL SHALL BE PROVIDED, CONSISTING OF THE FOLLOWING; 12 STRONG POLE WITH BODY HOOK, 1/4" DIAMETER MINIMUM THROWING ROPE, AND POSTED TELEPHONE NUMBERS OF EMERGENCY SERVICES, ALONG WITH POSTED POOL RULES SIGNS IN COMPLIANCE WITH MACH. (REQUIRED SIGNS TO BE PROVIDED BY OWNER).
- FRESH WATER SUPPLY VIA WATER LEVEL CONTROLLER IS FURNISHED AND IDENTIFIED WITHIN THE POOL EQUIPMENT LEGEND ON PLAN SHEET PL-1.4, AND PER DETAIL 03 ON SHEET PL-1.2. FRESH WATER SUPPLY TO THE EQUIPMENT PAD IS PROVIDED BY OTHERS, AND COORDINATED WITH POOL CONTRACTOR.
- ALL ELECTRICAL REQUIREMENTS OF THE LATEST NATIONAL ELECTRICAL CODE SHALL BE FOLLOWED AND IN FULL COMPLIANCE. POOL CONTRACTOR IS RESPONSIBLE FOR ALL LOW VOLTAGE WIRING (ANYTHING UNDER OR EQUAL TO 120V). ALL ELECTRICAL WORK THAT IS OVER 120V SHALL BE INSTALLED AND PROVIDED BY OTHERS.
- POOL SHALL MEET THE MINIMUM 10 CANDLES PER SQ. FT.FOR UNDERWATER LIGHTING.
- FOR BATHROOM FACILITIES, REFERENCE ARCHITECTURAL PLAN SET. THIS POOL SERVES ALL THOSE PERSONS WHO ARE RENTING A ROOM AT THE HOTEL/CASINO.
- A, POLE HOOK, ROPES WITH BUOYS, AND LIFESAVING EQUIPMENT ARE TO BE PROVIDED AND BE READILY ACCESSIBLE AND VISIBLE, ALONG WITH

A FIRST AID KIT.

- THE POOL SHALL HAVE AUTOMATIC FEEDERS FOR BOTH CHLORINE AND ACID, BOTH CONTROLLED BY THE CHEMICAL CONTROLLER. POOL WATER LEVELS ARE MAINTAINED AUTOMATICALLY WITH A CHEMICAL CONTROLLER.
- A TEST KIT IS TO BE PROVIDED FOR THE POOL WHICH TESTS Ph, CHLORINE OR BROMIDE RESIDUALS, CYANURIC ACID, TOTAL ALKALINITY, AND CALCIUM HARDNESS. THE FOLLOWING LEVEL REQUIREMENTS ARE TO BE MET FOR THE POOL

WATER...

CHLORINE .7 - 1.0 ppm
Ph 7.2 - 7.8

POOL CALCULATIONS

HEAD LOSS CALCULATIONS

1.0" PIPE = $\frac{60}{100} * 4 = 2.4$ FT.
1.5" PIPE = $\frac{95}{100} * 4 = 3.8$ FT.
2.0" PIPE = $\frac{100}{100} * 4.5 = 4.5$ FT.
2.5" PIPE = $\frac{50}{100} * 3.5 = 1.75$ FT.
3.0" PIPE = $\frac{126}{100} * 2.6 = 3.28$ FT.
4.0" PIPE = $\frac{240}{100} * 2.0 = 4.8$ FT.

TOTAL = 20.53 FT.

1.0" FITTINGS = .284 FT.
1.5" FITTINGS = .19 FT.
2.0" FITTINGS = .816 FT.
2.5" FITTINGS = .375 FT.
3.0" FITTINGS = .44 FT.

TOTAL = 2.105 FT.

BALL VALVES = 2 * 18/100
BUTTERFLY VALVES = 5 * $\frac{99}{100} = 4.95$ FT.
CHECK VALVES = $\frac{99}{100} = .99$ FT.
DIRECTIONAL EYEBALL INLET FITTING = 2.66 * 8 EACH = 21.28 FT.
ELEVATION CHANGE = 3.0 FT.

FILTER = 18
SKIMMERS = 4X1.75 = 3.0 FT.

TOTAL HEAD LOSS = 73.855 FT.

POOL DATA

POOL AREA:	1,708 SQ. FT.
POOL VOLUME:	43,377 GALLONS
POOL DECK AREA:	9,894 SQ. FT.
POOL COPING PERIMETER:	186 LN. FT.
DESIGNED TURN OVER RATE:	4 HOURS
DESIGNED FLOW RATE:	181 GPM
SYSTEM DESIGN HEAD:	74 FT.
TOTAL BATHER LOAD:	85 BATHERS
POOL SHELL CONSTRUCTION:	CONCRETE

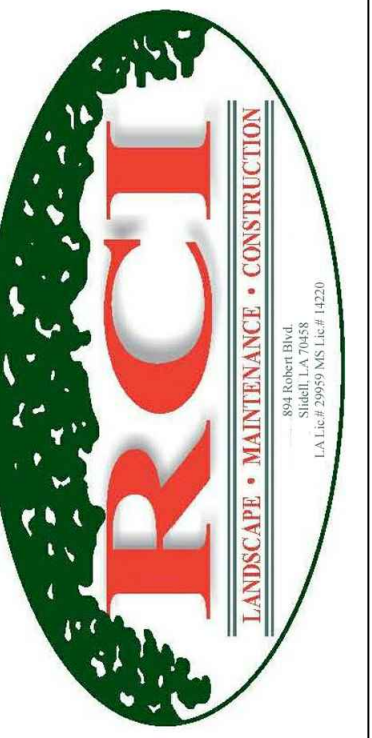

894 ROBERT BOULEVARD
SLIDELL, LOUISIANA 70458
PH. 985-643-2427
FAX 985-643-2691
RROTOLO@ROTOLOCONSULTANTS.COM

SCARLET PEARL CASINO RESORT
POOL DESIGN

10441 LEMOYNE BLVD.
D'LBERVILLE, MISSISSIPPI 39540

Copyright 2014 © RotoLo Consultants Inc.
These drawings or parts thereof, may not be reproduced in any form, by any method, for any purpose, without prior written consent from RotoLo Consultants Inc.

Contact: Rod RotoLo 985-643-2427

Project No:

Revisions:

No:	Date:	Description:

Date: 7-27-2015

Drawn: TJH

Checked: MR

Sheet Title:

NOTES, CODE COMPLIANCE, & POOL CALCULATIONS

Drawing No.

G-1.0

Sheet No.

1 of 6

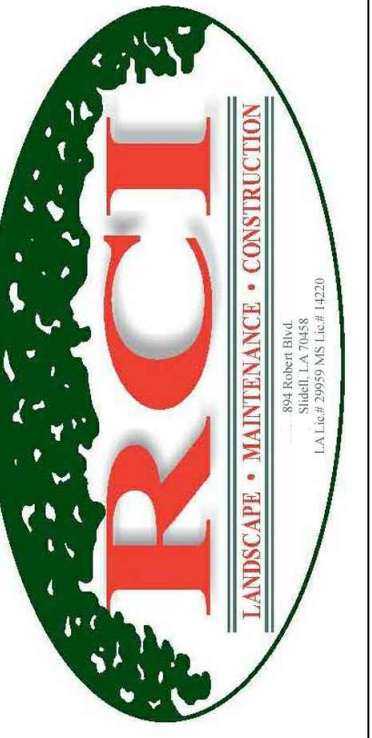

894 ROBERT BOULEVARD
SLIDELL, LOUISIANA 70458
PH: 985-643-2427
FAX: 985-643-2691
ROTULO@ROTULOCONSULTANTS.COM

SCARLET PEARL CASINO RESORT SWIMMING POOL PLAN SET D'LBERVILLE, MS

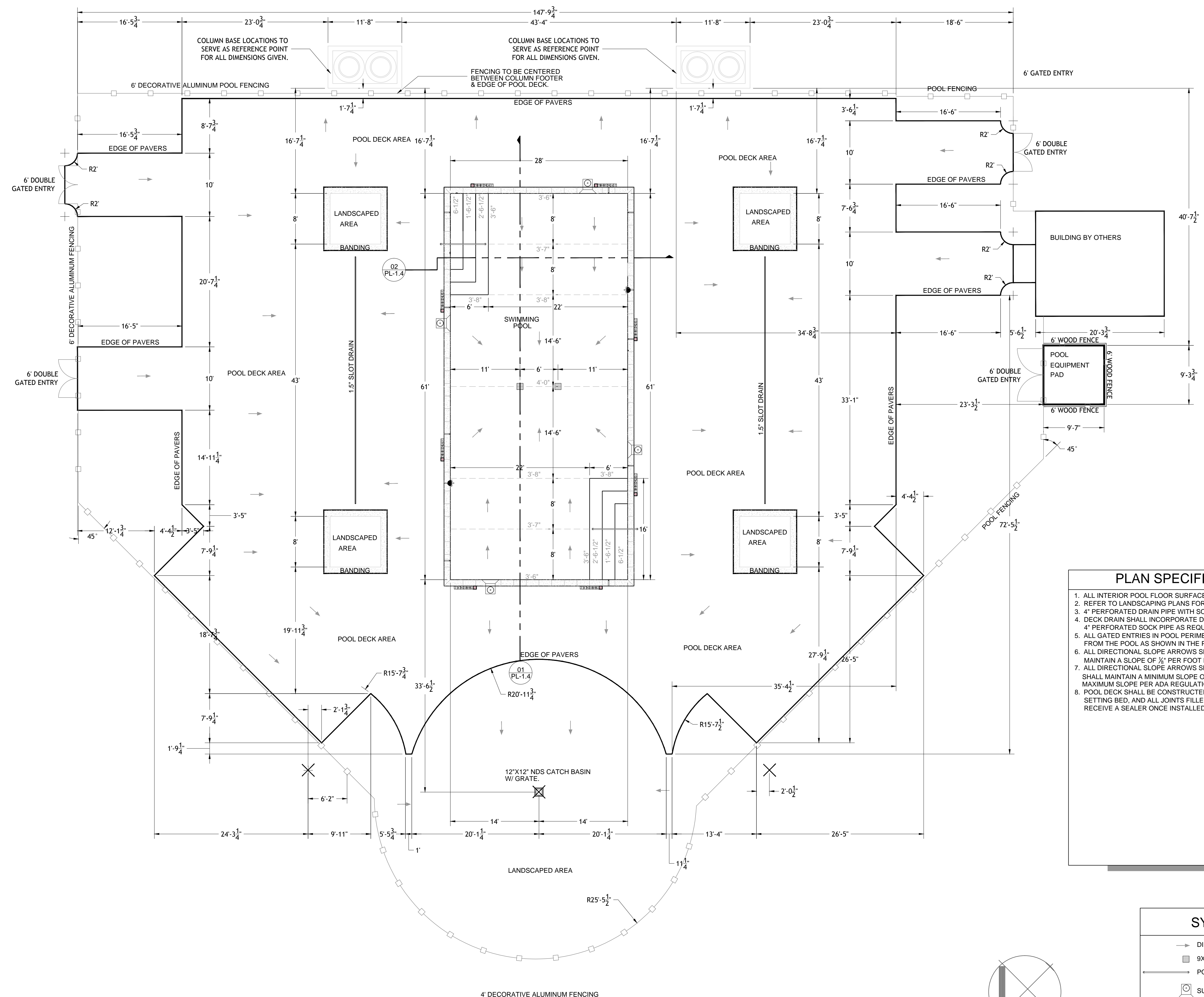

- ### PLAN SPECIFIC NOTES
1. ALL INTERIOR POOL FLOOR SURFACES ARE NOT TO EXCEED 1:12 MAX SLOPE.
 2. REFER TO LANDSCAPING PLANS FOR IDENTIFICATION OF ALL LANDSCAPED AREAS.
 3. 4" PERFORATED DRAIN PIPE WITH SOCK TO BE RUN AS LOCATED ON PLANS.
 4. DECK DRAIN SHALL INCORPORATE DOWN ADAPTORS TO ALLOW CONNECTION OF THE 4" PERFORATED SOCK PIPE AS REQUIRED FOR PROPER DRAINAGE.
 5. ALL GATED ENTRIES IN POOL PERIMETER FENCING SHALL SWING OUTWARD AWAY FROM THE POOL AS SHOWN IN THE PLANS FOR ALL EGRESS AREAS.
 6. ALL DIRECTIONAL SLOPE ARROWS SHOWN WITHIN THE POOL INDICATE A SLOPE THAT MAINTAIN A SLOPE OF 1/8" PER FOOT MINIMUM, AND 1/2" PER FOOT MAXIMUM.
 7. ALL DIRECTIONAL SLOPE ARROWS SHOWN ON THE POOL DECK INDICATE A SLOPE THAT SHALL MAINTAIN A MINIMUM SLOPE OF 1/8" PER FOOT, AND SHALL NOT EXCEED THE MAXIMUM SLOPE PER ADA REGULATIONS.
 8. POOL DECK SHALL BE CONSTRUCTED OF PEDESTRIAN PAVERS, PLACED ON SAND SETTING BED, AND ALL JOINTS FILLED WITH POLYMERIC SAND. ALL PAVERS TO RECEIVE A SEALER ONCE INSTALLED.

SYMBOL LEGEND

- DIRECTIONAL ARROW INDICATING SLOPE
- 9X9 MAIN DRAIN GRATE AND FRAME
- POOL HANDRAIL
- SURFACE SKIMMER
- - - POOL CONTOUR LINE W/ WATER DEPTH ELEVATION
- ↪ DIRECTIONAL EYEBALL INLET RETURN
- POOL LIGHT
- DEPTH MARKERS AND "NO DIVING" SYMBOL
 - RECTANGULAR OVERFLOW FITTING
 - INLET FITTING FOR WATER SAMPLE LINE

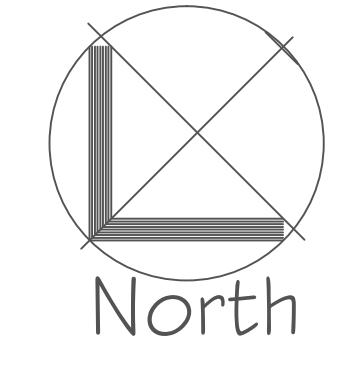

01 **POOL & DECK LAYOUT PLAN**
PL-1.0 SCALE: 1/8" = 1'-0"

Copyright 2014 Rotolo Consultants Inc.
These drawings or parts thereof, may not be reproduced in any form, by any method, for any purpose, without prior written consent from Rotolo Consultants Inc.

Contact: Rod Rotolo 985-643-2427

Project No: _____

Revisions:		
No.	Date	Description
01	8-6-2015	CORING CHANGE

Date: 8-4-2015
Drawn: TJH
Checked: MR

POOL & DECK LAYOUT PLAN PLAN

Drawing No. _____

PL-1.0
Sheet No.
2 of 6

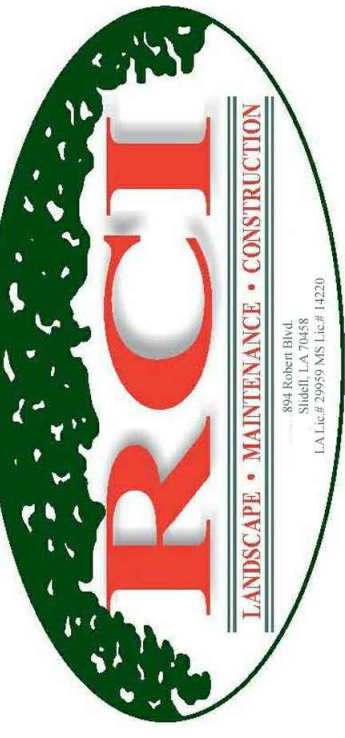

894 ROBERT BOULEVARD
SLIDELL, LOUISIANA 70458
PH: 985-643-2427
FAX: 985-643-2691
RROTULO@RROTULOCONSULTANTS.COM

SCARLET PEARL CASINO RESORT
SWIMMING POOL PLAN SET
D'LBERVILLE, MS

Copyright 2014 Rotulo Consultants Inc.
These drawings or parts thereof, may not be reproduced in any form, by any method, for any purpose, without prior written consent from Rotulo Consultants Inc.
Contact: Rod Rotulo 985-643-2427
Project No:

Revisions:		
No.	Date:	Description:
01	8-6-2015	COPING CHANGE

Date: 8-4-2015
Drawn: TJH
Checked: MR

POOL & DECK GRADING PLAN

Drawing No.

PL-1.1

Sheet No.
3 of 6

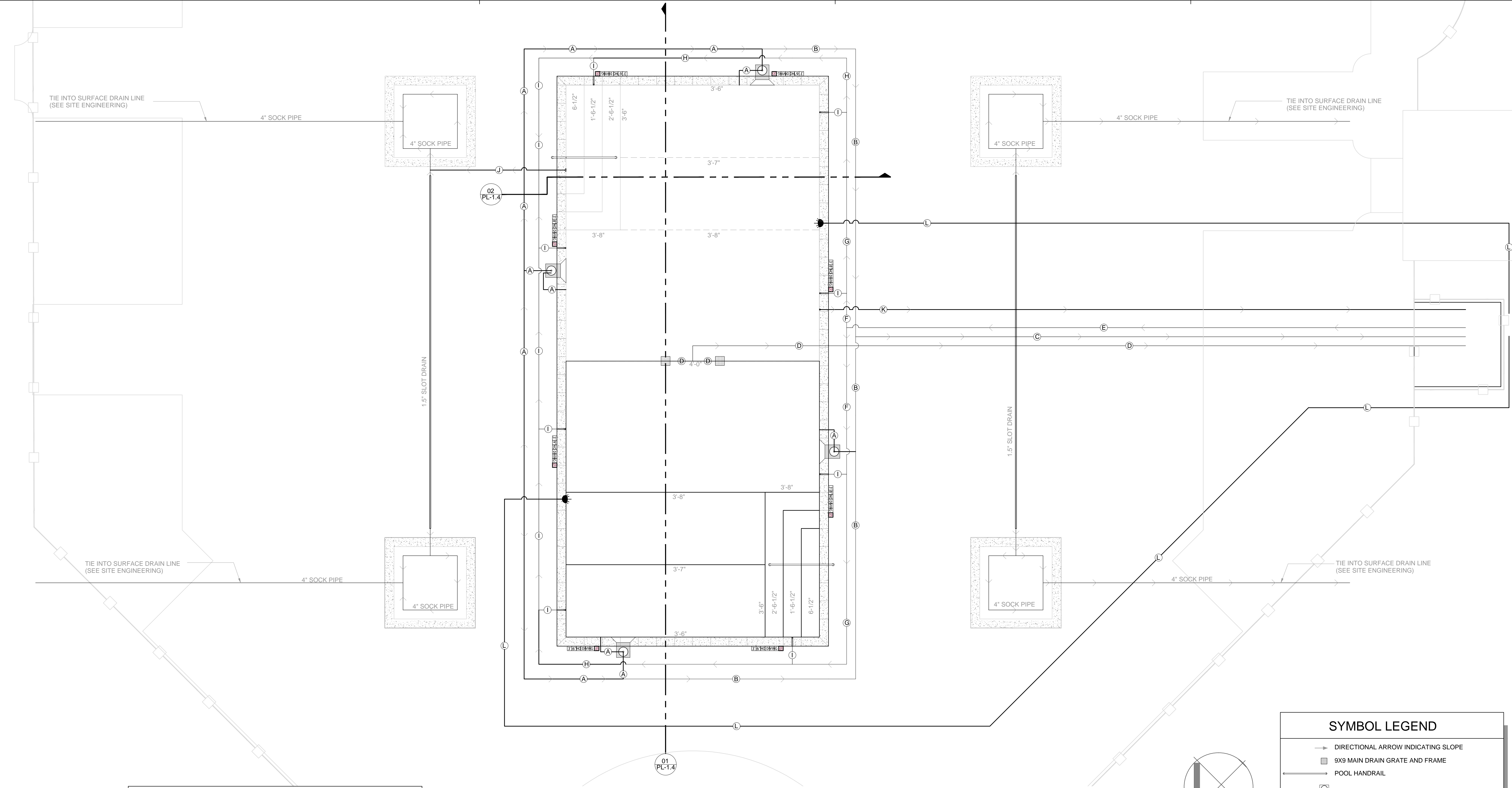

- PLAN SPECIFIC NOTES**
- REFER TO LANDSCAPING PLANS FOR IDENTIFICATION OF ALL LANDSCAPED AREAS.
 - 4" PERFORATED DRAIN PIPE WITH SOCK TO BE RUN AS LOCATED ON PLANS.
 - DECK DRAIN SHALL INCORPORATE DOWN ADAPTORS TO ALLOW CONNECTION OF THE 4" PERFORATED SOCK PIPE AS REQUIRED FOR PROPER DRAINAGE.
 - ALL PIPING SHOWN ON PLAN IS SCHEMATIC FOR COORDINATION PURPOSES, AND ACTUAL PIPE ROUTING AND TRENCHING IS TO BE DETERMINED IN THE FIELD DURING CONSTRUCTION.
 - ALL POOL SUCTION AND RETURN PIPE RUNS ARE PRESSURED.
 - ALL DRAINAGE PIPE (4" SOCK DRAIN PIPE) IS GRAVITY FEED PIPE, REQUIRING A CONSISTENT MINIMUM SPECIFIED SLOPE.
 - ALL PIPE RUNS SHOWN ARE GIVEN DIRECTIONAL FLOW ARROWS INDICATING WATER FLOW.
 - ACTUAL SETUP OF EQUIPMENT AND PIPE RUNS ON EQUIPMENT PAD SHALL BE FIELD DETERMINED. ALL PIPE AND CONDUIT RUNS ABOVE GROUND SHALL BE INSTALLED IN A NEAT, CONSISTENT, AND UNOBSTRUCTED MANNER THAT MAXIMIZES EASY ACCESS AND OPERATION OF ALL EQUIPMENT ON THE PAD.

01 PL-1.0 POOL & DECK GRADING LAYOUT PLAN
SCALE: 3/16" = 1'-1"

PIPE IDENTIFICATION LEGEND

IDENTIFICATION	PLAN ID	SIZE	TYPE	FLOW RATE	VELOCITY
SKIMMER SUCTION	A	2.0"	SCH 40 PVC	45.25 GPM	4.62 FPS
SKIMMER SUCTION	B	3.0"	SCH 40 PVC	90.50 GPM	4.11 FPS
SKIMMER SUCTION	C	4.0"	SCH 40 PVC	181 GPM	4.62 FPS
MAIN DRAIN SUCTION	D	4.0"	SCH 40 PVC	181 GPM	4.62 FPS
INLET RETURN	E	4.0"	SCH 40 PVC	181 GPM	4.62 FPS
INLET RETURN	F	3.0"	SCH 40 PVC	90.50 GPM	4.11 FPS
INLET RETURN	G	3.0"	SCH 40 PVC	67.88 GPM	3.08 FPS
INLET RETURN	H	2.0"	SCH 40 PVC	45.25 GPM	4.62 FPS
INLET RETURN	I	1.5"	SCH 40 PVC	22.63 GPM	4.11 FPS
OVERFLOW LINE	J	1.5"	SCH 40 PVC	N/A	N/A
WL SAMPLE LINE	K	2.0"	SCH 40 PVC	N/A	N/A
ELECTRICAL CONDUIT	L	1.0"	SCH 40	N/A	N/A

SYMBOL LEGEND

- DIRECTIONAL ARROW INDICATING SLOPE
- 9X9 MAIN DRAIN GRATE AND FRAME
- POOL HANDRAIL
- SURFACE SKIMMER
- POOL CONTOUR LINE W/ WATER DEPTH ELEVATION
- DIRECTIONAL EYEBALL INLET RETURN
- POOL LIGHT
- DEPTH MARKERS AND "NO DIVING" SYMBOL
- RECTANGULAR OVERFLOW FITTING
- INLET FITTING FOR WATER SAMPLE LINE

POOL DATA

POOL AREA:	1,708 SQ. FT.
POOL VOLUME:	43,377 GALLONS
POOL DECK AREA:	9,894 SQ. FT.
POOL COPING PERIMETER:	186 LN. FT.
DESIGNED TURN OVER RATE:	4 HOURS
DESIGNED FLOW RATE:	181 GPM
SYSTEM DESIGN HEAD:	74 FT.
TOTAL BATHER LOAD:	85 BATHERS
POOL SHELL CONSTRUCTION:	CONCRETE

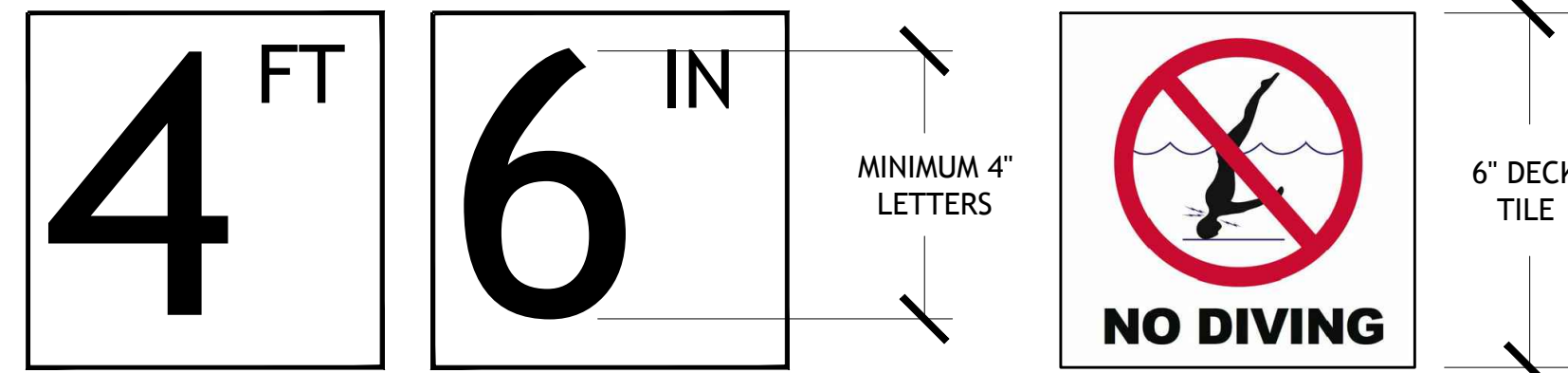
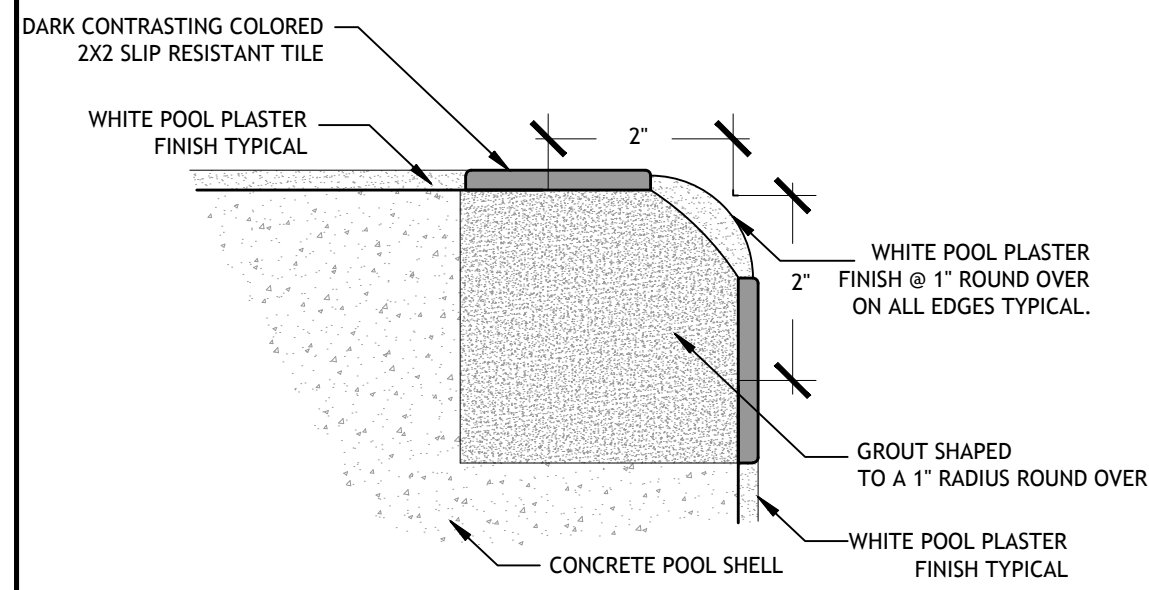

DEPTH MARKERS
MARKER REQUIREMENTS:

1. DEPTH MARKERS BOTH SHOWING FEET AND INCHES
2. "NO DIVING" SYMBOL MARKER WITH EACH DEPTH MARKER.

NOTES:

1. DEPTH MARKERS SHALL BE PLACED ON THE DECK WITH SPACING NOT TO EXCEED 25'-0", NO MORE THAN 2 FOOT OF CHANGE IN SLOPE, AND TO ALSO PLACE A CORRESPONDING DEPTH MARKER IN DUPLICATE ON THE POOL WALL.
2. DECK TILES TO BE WITHIN 18" OF THE POOL WATER SURFACE
3. DECK TILES TO BE POSITIONED TO BE READ WHILE STANDING ON THE DECK FACING THE WATER.
4. DEPTH MARKERS TO BE IN ENGLISH.
5. NUMERICAL COLOR OF LETTERING TO BE BLACK, ON WHITE BACKGROUND.
6. "NO DIVING" INTERNATIONAL SYMBOL MARKER TO BE PLACED AT EVERY LOCATION WHERE A DEPTH MARKER IS LOCATED.
7. ALL DECK DEPTH MARKERS & NO DIVING SYMBOLS ARE TO HAVE A SLIP RESISTANT FINISH TYPICAL.
8. POOL WALL DEPTH MARKERS & NO DIVING SYMBOLS ARE TO HAVE A SMOOTH FINISH.



NO DIVING SYMBOL

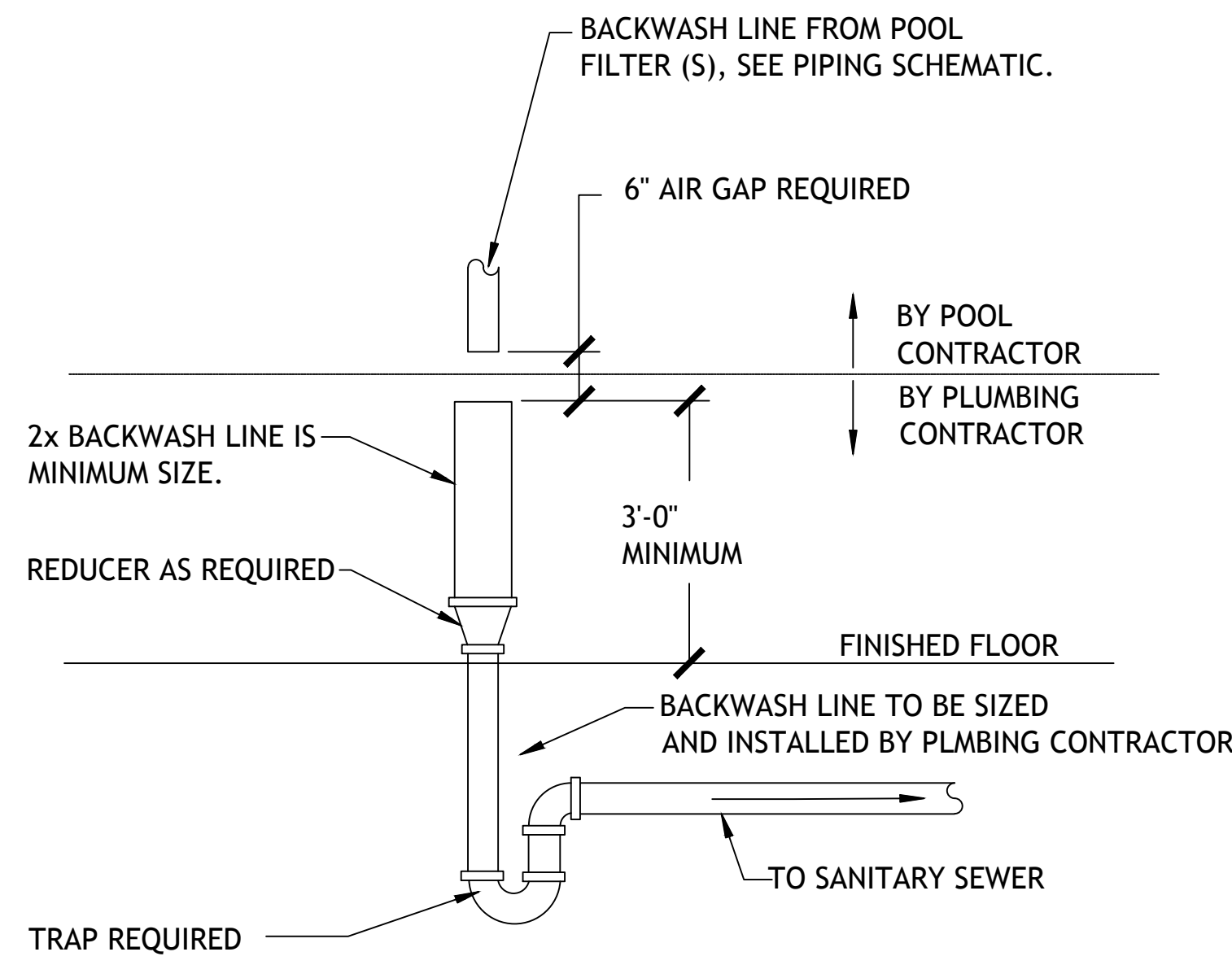

NOTE:
ALSO REFER TO THE INSTALLATION AND OPERATION INSTRUCTIONS FROM THE MANUFACTURER ON THE AUTOMATIC WATER LEVEL CONTROLLER. SEE EQUIPMENT LIST FOR MAKE AND MODEL.

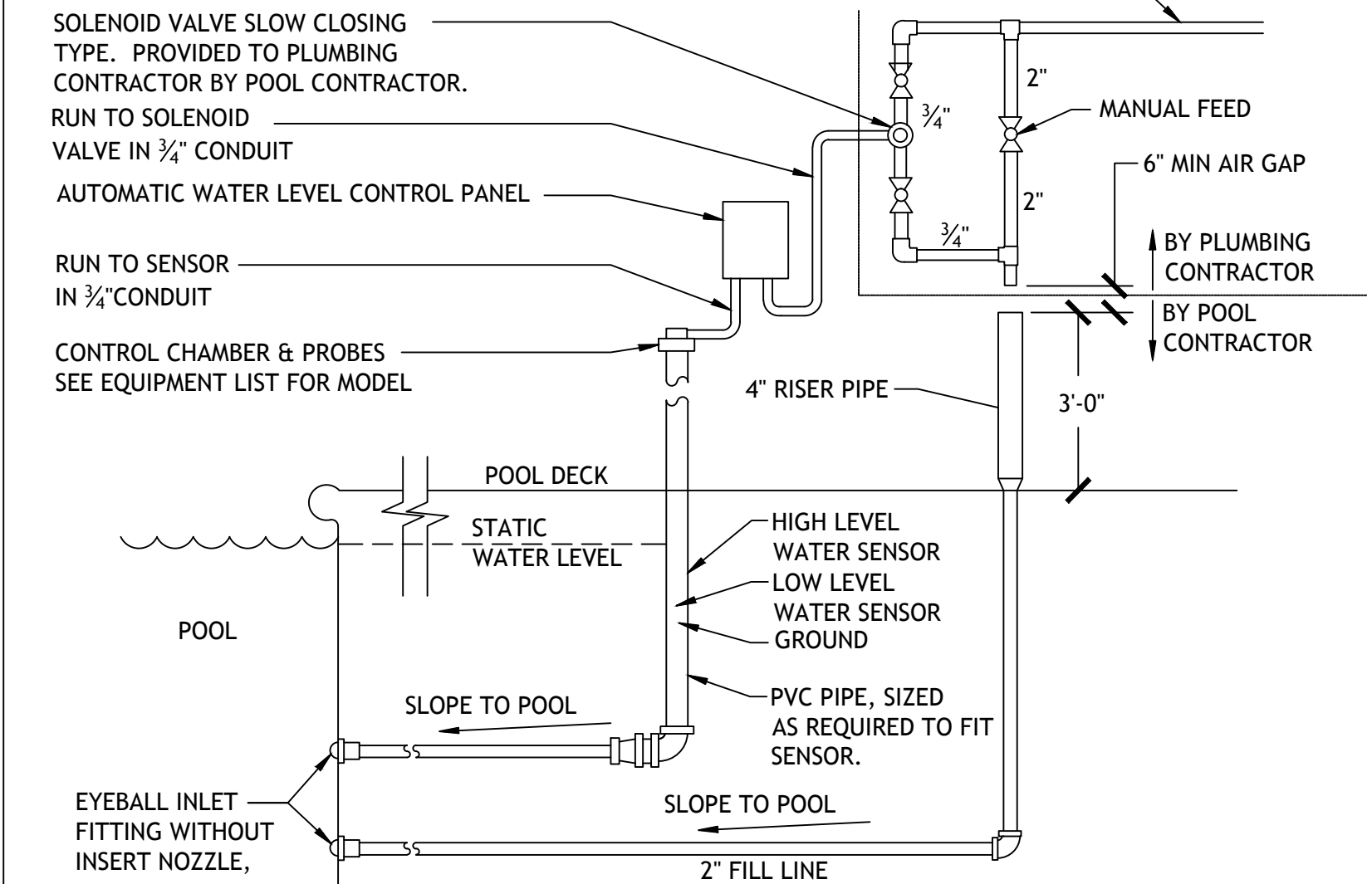

01 DEPTH MARKERS & TILE DETAILS
PL-1.3 NOT TO SCALE

02 BACKWASH TYPICAL DETAIL
PL-1.3 NOT TO SCALE

03 AUTOFILL TYPICAL DETAIL
PL-1.3 NOT TO SCALE

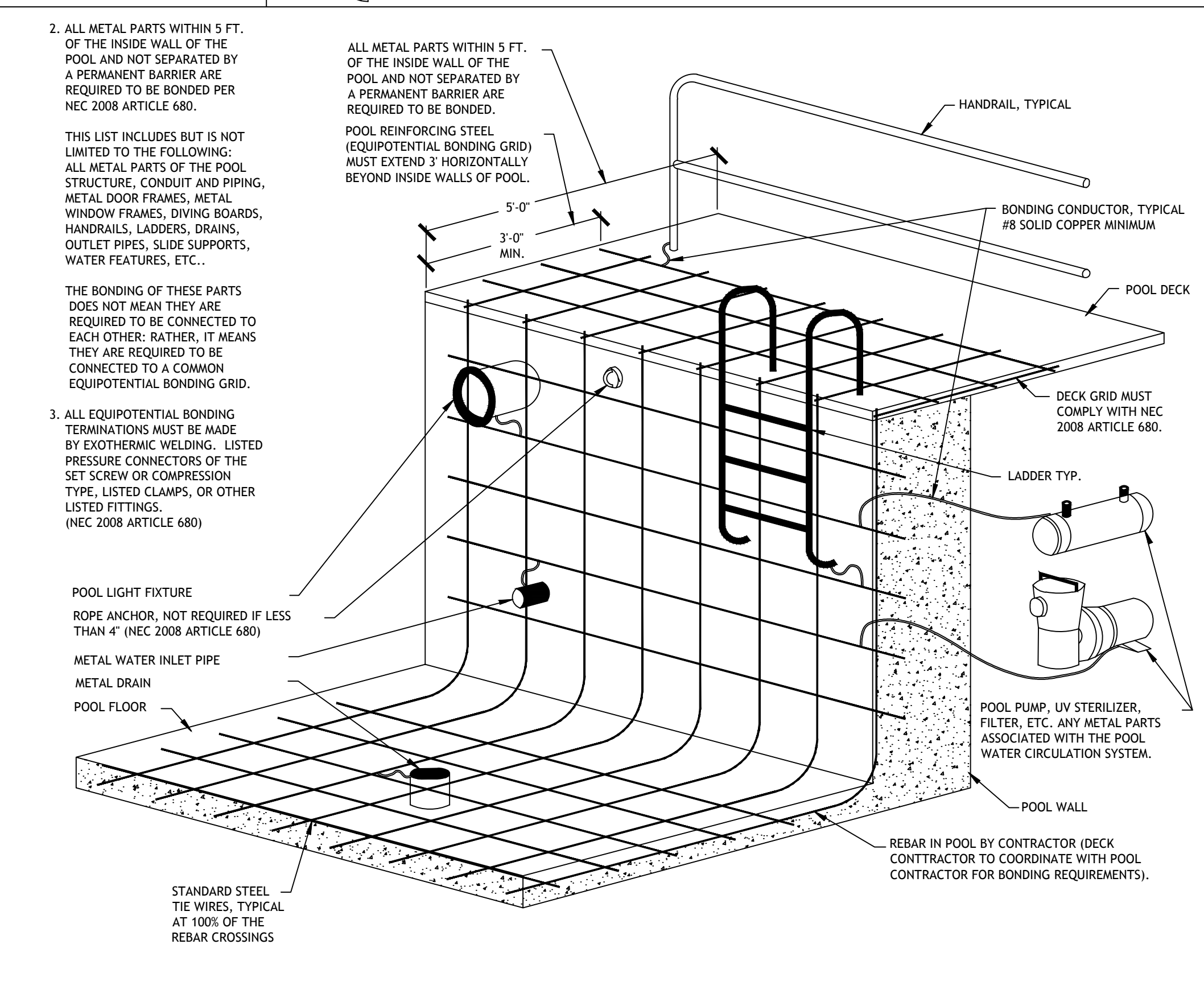
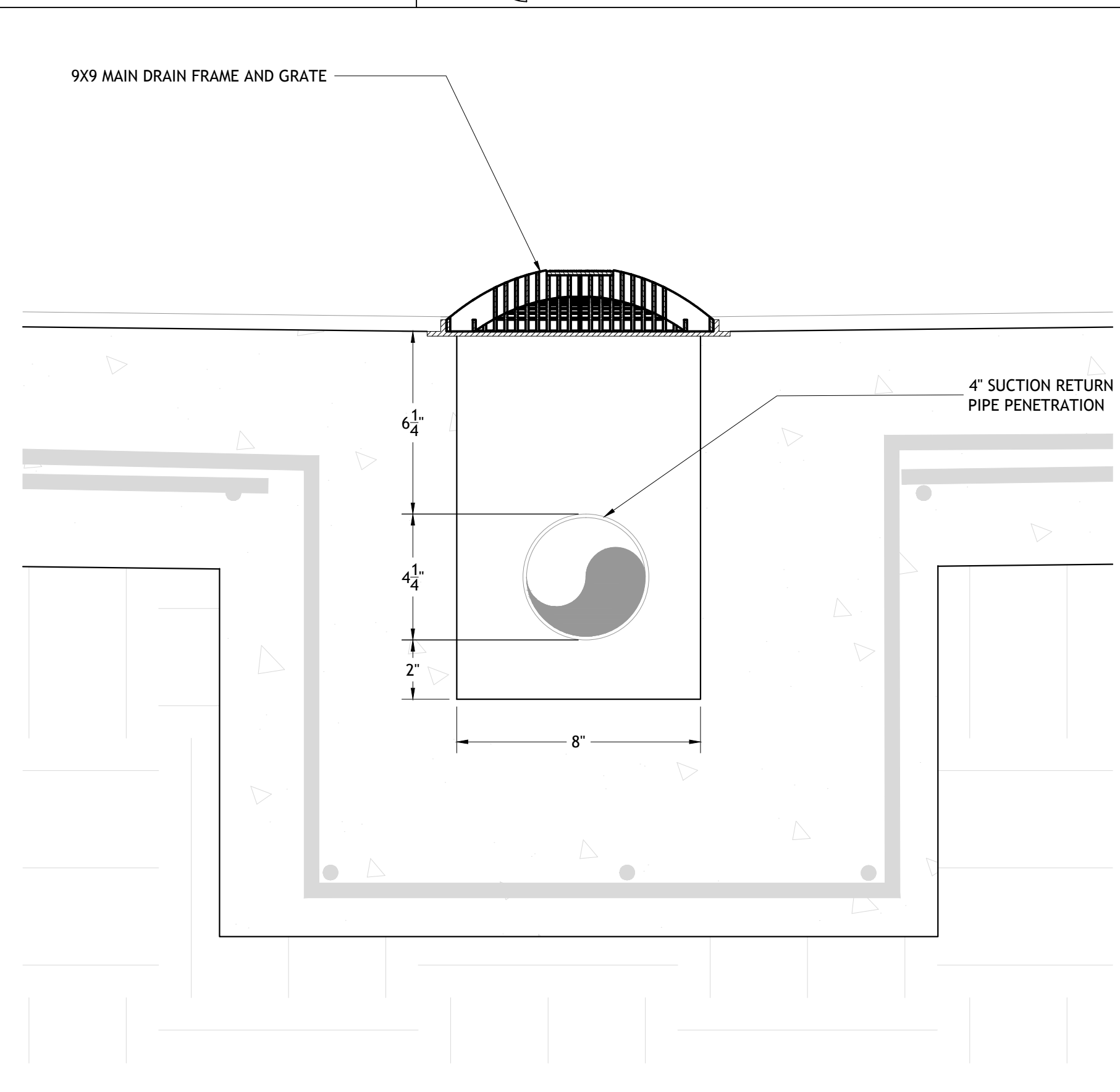
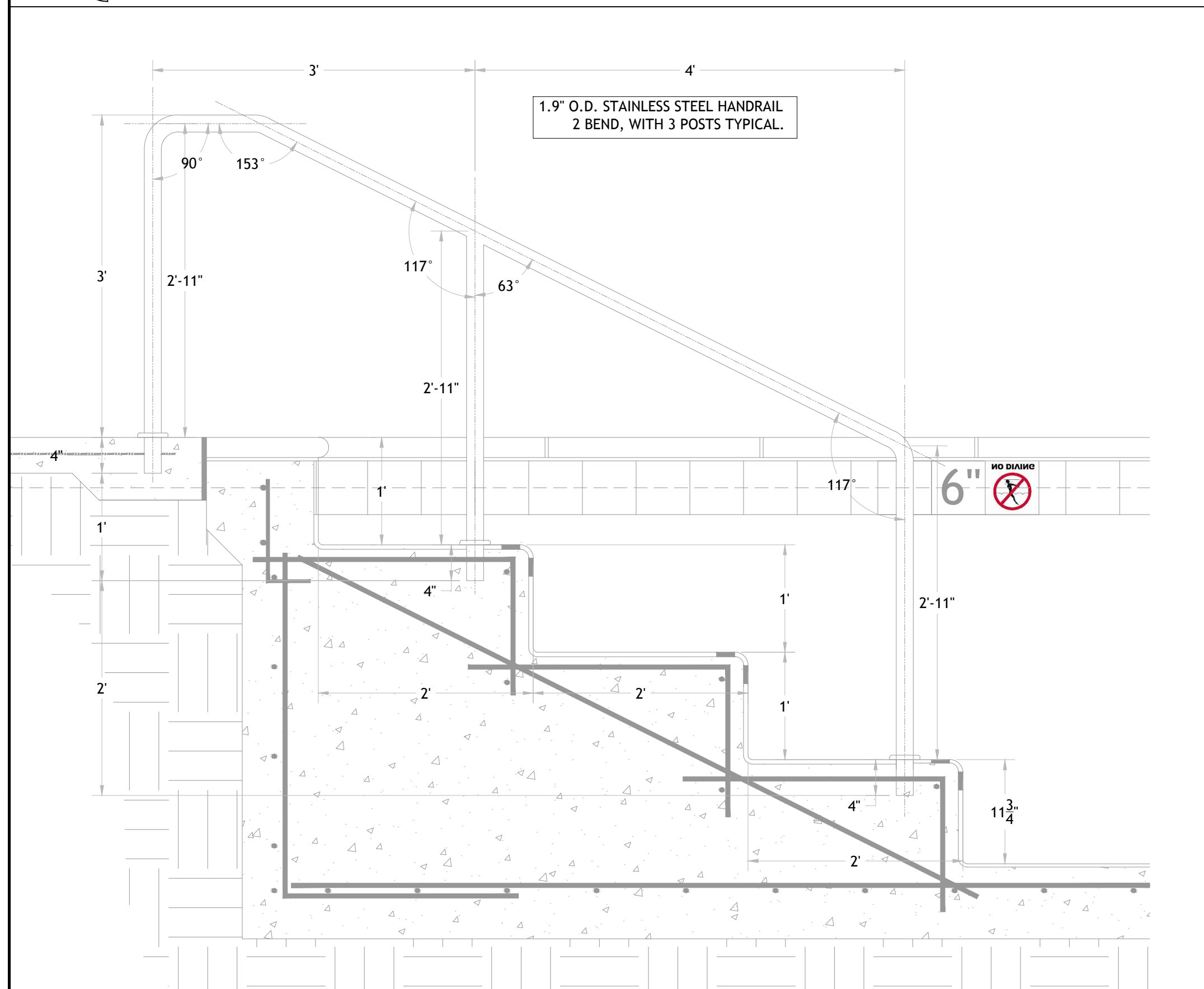

04 HANDRAIL DETAIL
PL-1.3 SCALE: 1" = 1'-0"

05 MAIN DRAIN SUMP DETAIL
PL-1.3 SCALE: 1" = 3"

06 TYPICAL GROUNDING & BONDING DETAIL
PL-1.3 NOT TO SCALE

PLAN SPECIFIC NOTES

1. REFERENCE ENGINEERING SPECIFICATIONS FOR ALL STRUCTURAL REQUIREMENTS ON THE POOL SHELL.

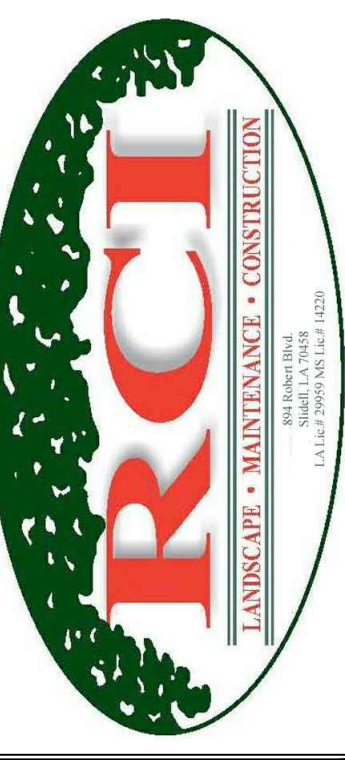

894 ROBERT BOULEVARD
SLIDELL, LOUISIANA 70458
PH: 985-643-2427
FAX: 985-643-2691
ROTULO@ROTULOCONSULTANTS.COM

SCARLET PEARL CASINO RESORT
SWIMMING POOL PLAN SET
D'LBERVILLE, MS

Copyright 2014 Rotolo Consultants Inc.
These drawings or parts thereof, may not be reproduced in any form, by any method, for any purpose, without prior written consent from Rotolo Consultants Inc.
Contact: Rod Rotolo 985-643-2427
Project No:

Revisions:		
No.	Date:	Description:
01	8-6-2015	CORP CHANGE

Date: 8-4-2015
Drawn: TJH
Checked: MR
Sheet Title:

POOL DETAILS

Drawing No.

PL-1.2

Sheet No.
4 of 6

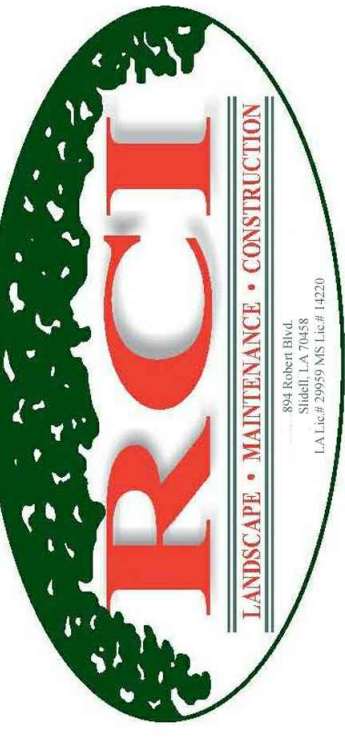

894 ROBERT BOULEVARD
SLIDELL, LOUISIANA 70458
PH: 985-643-2427
FAX: 985-643-2691
ROTOLO@ROTOLOCONSULTANTS.COM

SCARLET PEARL CASINO RESORT
SWIMMING POOL PLAN SET
D'LBERVILLE, MS

Copyright 2014 Roto Consultants Inc.
These drawings or parts thereof, may not be reproduced in any form, by any method, for any purpose, without prior written consent from Roto Consultants Inc.
Contact: Rod Roto 985-643-2427
Project No:

Revisions:		
No.	Date	Description
01	8-6-2015	COPING CHANGE

Date: 8-4-2015
Drawn: TJH
Checked: MR
Sheet Title:

POOL SECTIONS

Drawing No.

PL-1.3

Sheet No.
5 of 6

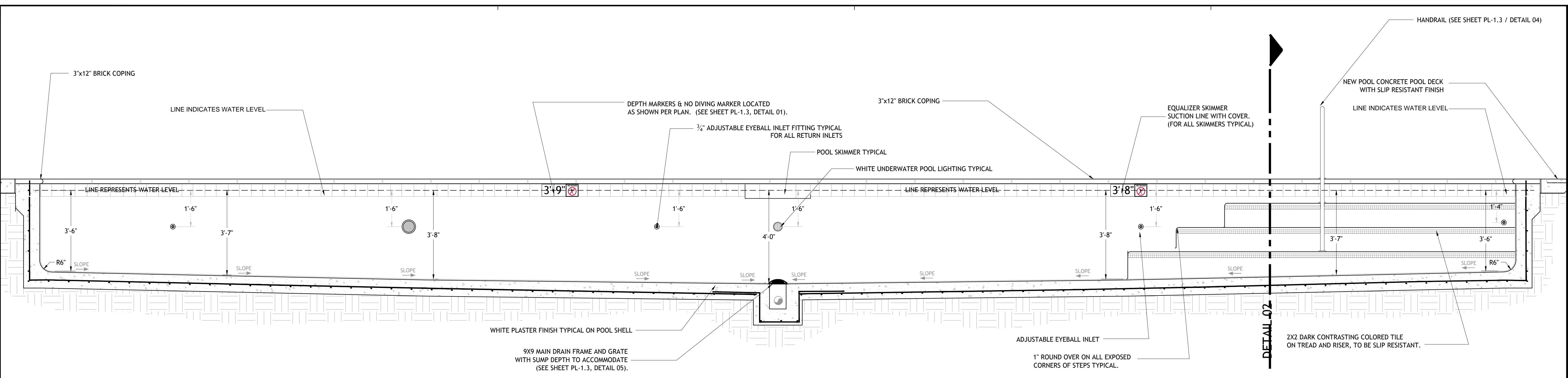

01 LONG CROSS SECTION OF POOL
PL-1.4 SCALE: 1/2" = 1'-0"

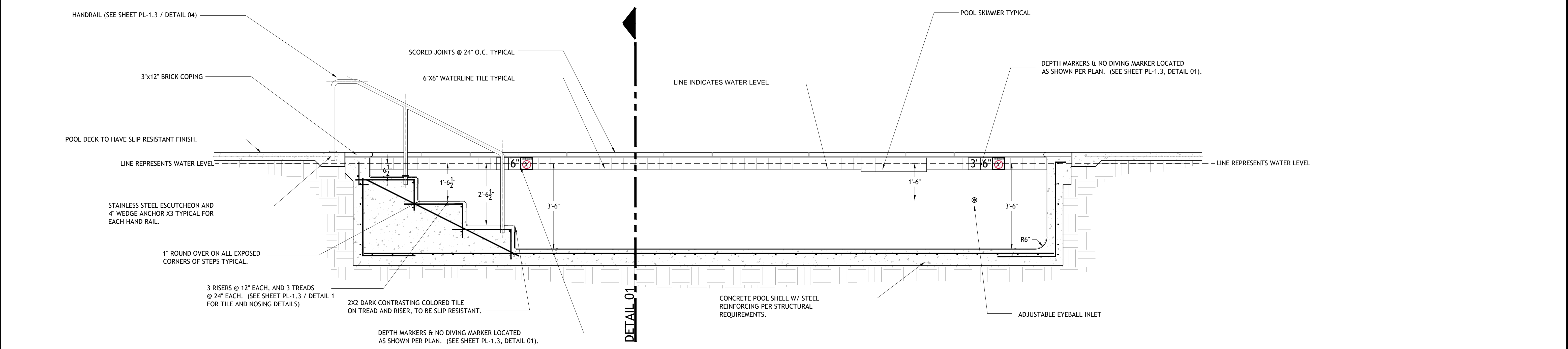

02 SHORT CROSS SECTION
PL-1.4 SCALE: 1/2" = 1'-0"

PLAN SPECIFIC NOTES
1. REFERENCE ENGINEERING SPECIFICATIONS FOR ALL STRUCTURAL REQUIREMENTS ON THE POOL SHELL.

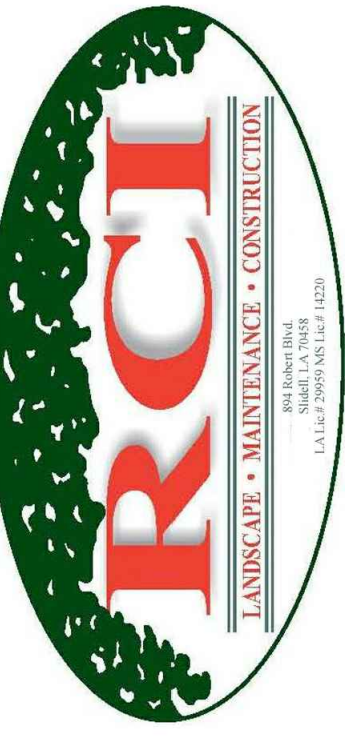

894 ROBERT BOULEVARD
SLIDELL, LOUISIANA 70458
PH: 985-643-2427
FAX: 985-643-2691
RROTOL@RROTOLCONSULTANTS.COM

SCARLET PEARL CASINO RESORT
SWIMMING POOL PLAN SET
D'LBERVILLE, MS

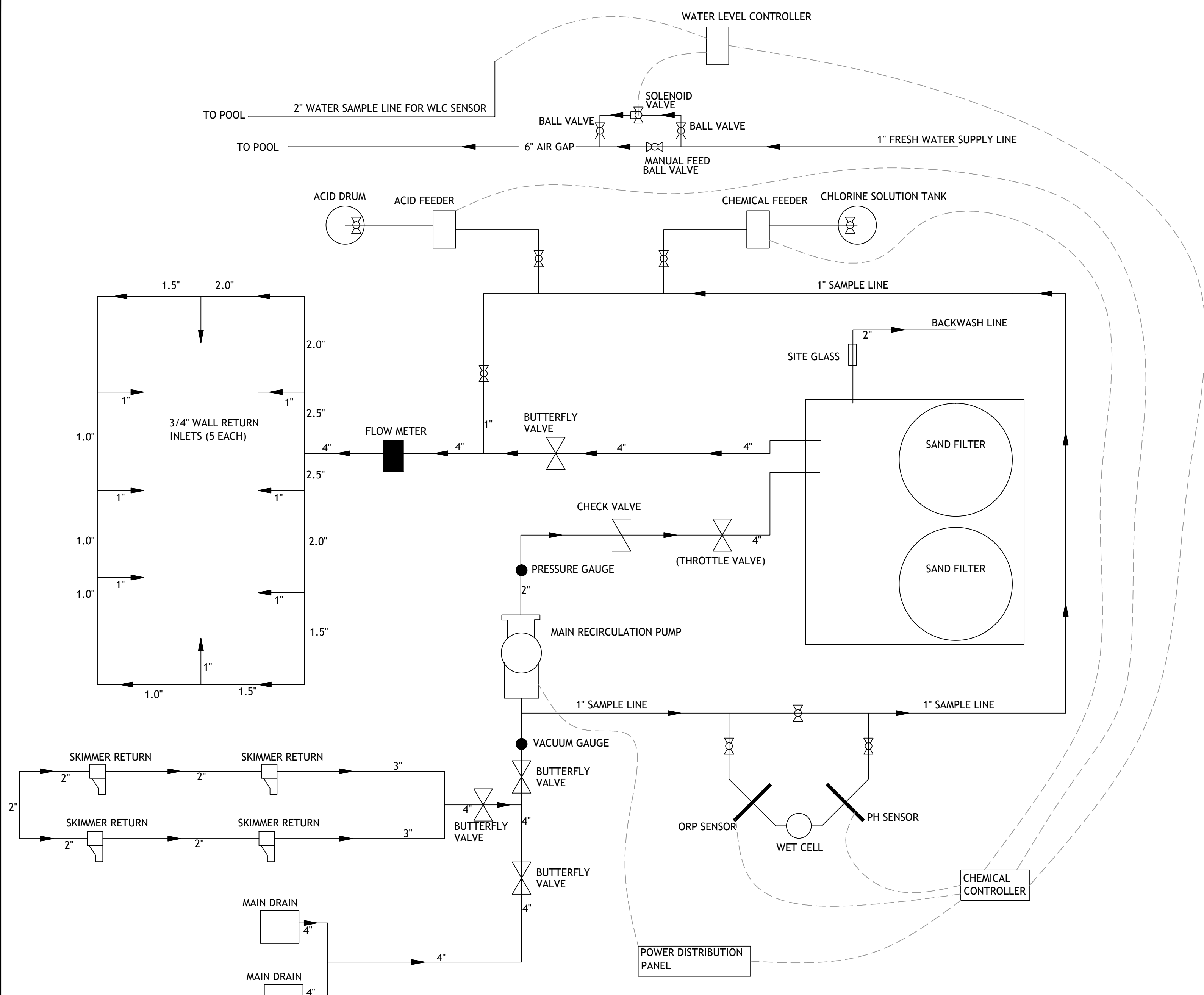

01 POOL SYSTEM SCHEMATIC
PL-1.5 SCALE: NOT TO SCALE

PLAN SPECIFIC NOTES

1. ALL PIPE RUNS SHOWN ARE GIVEN DIRECTIONAL FLOW ARROWS INDICATING WATER FLOW.
2. ACTUAL SETUP OF EQUIPMENT AND PIPE RUNS ON EQUIPMENT PAD SHALL BE FIELD DETERMINED. ALL PIPE AND CONDUIT RUNS ABOVE GROUND SHALL BE INSTALLED IN A NEAT, CONSISTENT, AND UNOBSTRUCTED MANNER THAT MAXIMIZES EASY ACCESS AND OPERATION OF ALL EQUIPMENT ON THE PAD.

POOL EQUIPMENT LEGEND

QTY	DESCRIPTION
2	TR140C-3 SAND FILTER BY PENTAIR
1	4" FACE TANDEM FACE PIPING KIT FOR TWO TR100C FILTERS
1	4" SIGHT GLASS
3	PRESSURE GAUGE WITH SNUBBER AND GAUGE COCK
1	VACUUM GAUGE WITH SNUBBER AND GAUGE COCK
1	WHISPERFLO SHP PUMP XFE-20 HIGH EFFICIENCY
1	CHEMTROL PC2000 - CHEMICAL CONTROLLER WITH ORP AND pH SENSORS
1	1" NORMALLY CLOSED, SLOW CLOSING SOLENOID VALVE - 110V
2	9"X9" FRAME & GRATE
2	PLASTIC LIGHT NICHE FOR 300 WATT POOL LIGHT
2	300 W WHITE POOL LIGHT W/ 150" CHORD
4	4" BLUE-WHITE IMPACT FLOW METER
1	STENNER ACID FEEDER PUMP (85M SERIES)
1	STENNER CHEMICAL FEEDER PUMP (85M SERIES)
1	15 GALLON ACID DRUM
1	150 GALLON CHLORINE SOLUTION TANK
1	TWO DRUM MODULAR SPILL PLATFORM WITH RAMP
8	SP1419D HAYWARD 3/4" DIRECTIONAL EYEBALL
10	HAY-25-1504 SP1022S INLET SLIP FITTING
4	HAY-25-1507 SP1026 GRATE INSERT (FOR SKIMMER EQ LINES)
1	HAY-25-1500 SP1019 GUTTER DRAIN (FOR OVERFLOW INLET)
4	U-3 SKIMMER
1	TIMER FOR LIGHTS AND PUMP
1	LEVELOR - WATER LEVEL CONTROLLER MODEL K-1100 - SOLENOID VALVE TO BE INCLUDED
1	TRUE UNION BALL VALVES FOR PIPE SIZE 1" - 3"
1	CHECK VALVES TO BE WAFER BODY STYLE
1	BUTTERFLY VALVES TO HAVE EPDM COATING, AND MOUNTED WITH 150 LB RATED FLANGES
1	STAINLESS STEEL BOLT KIT HARDWARE
1	SCH 40 PVC PIPE FOR ALL SUCTION, RETURN, AND EQUIPMENT ROOM PIPING
1	ADA POOL LIFT - TO BE PORTABLE WITH MOUNTING KIT
1	CUSTOM 1.90" O.D. HANDRAIL (3 BEND, THREE POSTS)
6	4" WEDGE ANCHORS (1.90" O.D.) FOR HANDRAILS
6	1.90" O.D. ESCUTCHEONS FOR HANDRAIL AND LADDER
1	6X6 WATERLINE TILE
1	2X2 KEYSTONE TILE FOR STEPS, TANNING LEDGES, AND UNDERWATER BENCHES
1	6X6 DEPTH MARKERS, BLACK LETTERING ON WHITE BACKGROUND (SLIP RESISTANT FINISH)
1	6X6 INTERNATIONAL "NO DIVING" SYMBOL
1	6X6 MESSAGE TILES WITH "NO DIVING" FOR DECK ONLY - TO HAVE SLIP-RESISTANT FINISH
1	WHITE PLASTER
1	16' STRAIGHT POLE WITH LIFE SAVING HOOK AND HARDWARE
1	MOUNTING HOOKS FOR POLES
1	24" RING BUOY
1	35' MINIMUM ROPE WITH 6"X9" BOUY
1	OWNER TO PROVIDE ALL REQUIRED POOL SIGNS PER CODE.
1	WALL CLEANING BRUSH
1	8' TO 12' EXTENDING TELEPOLE
1	25 PERSON FIRST AID KIT
1	PORTABLE TEST TUBE
1	TAYLOR TEST COMMERCIAL TEST KIT COMPLETE

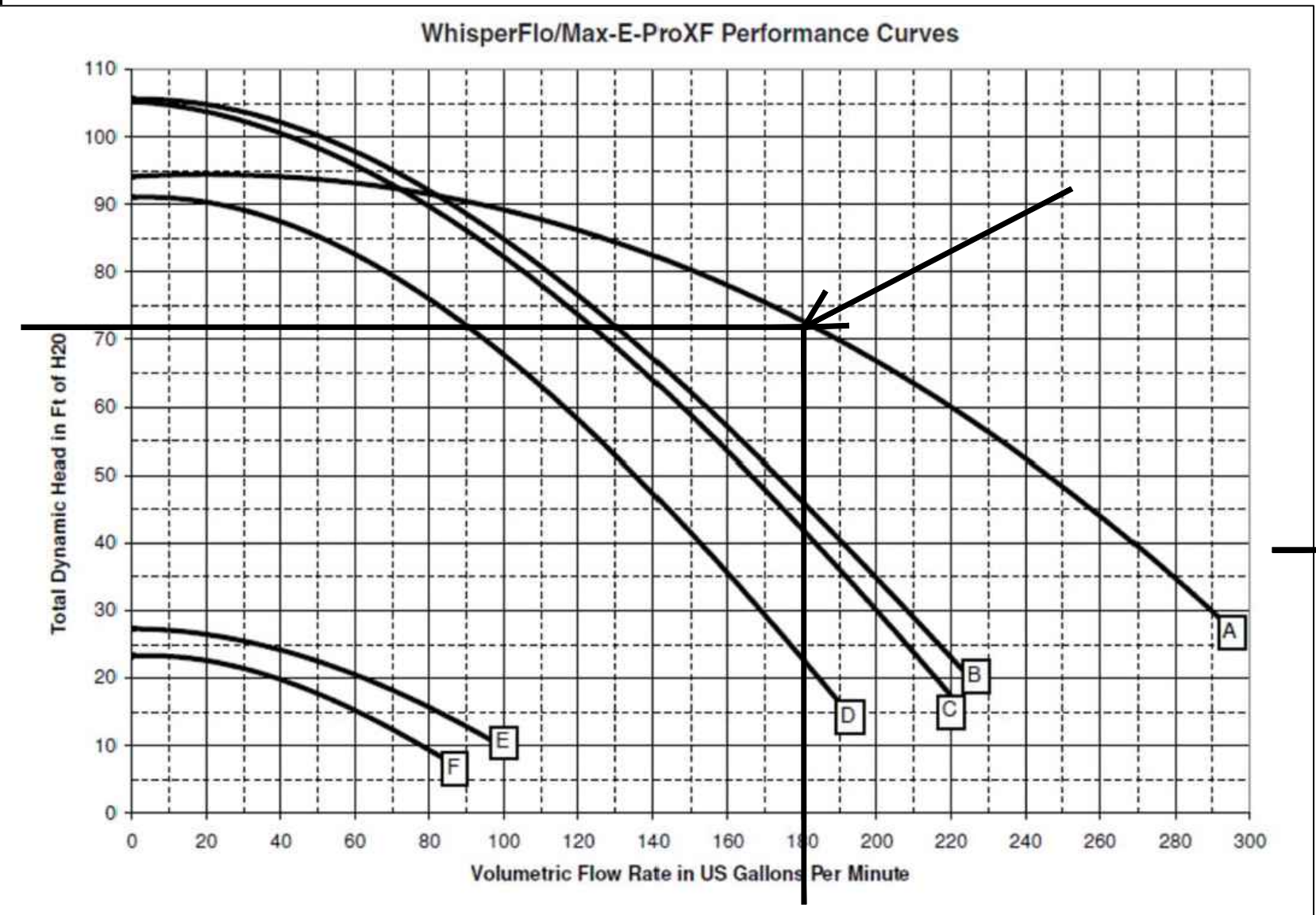

07 MAIN PUMP CURVE
PL-1.5 SCALE: NOT TO SCALE

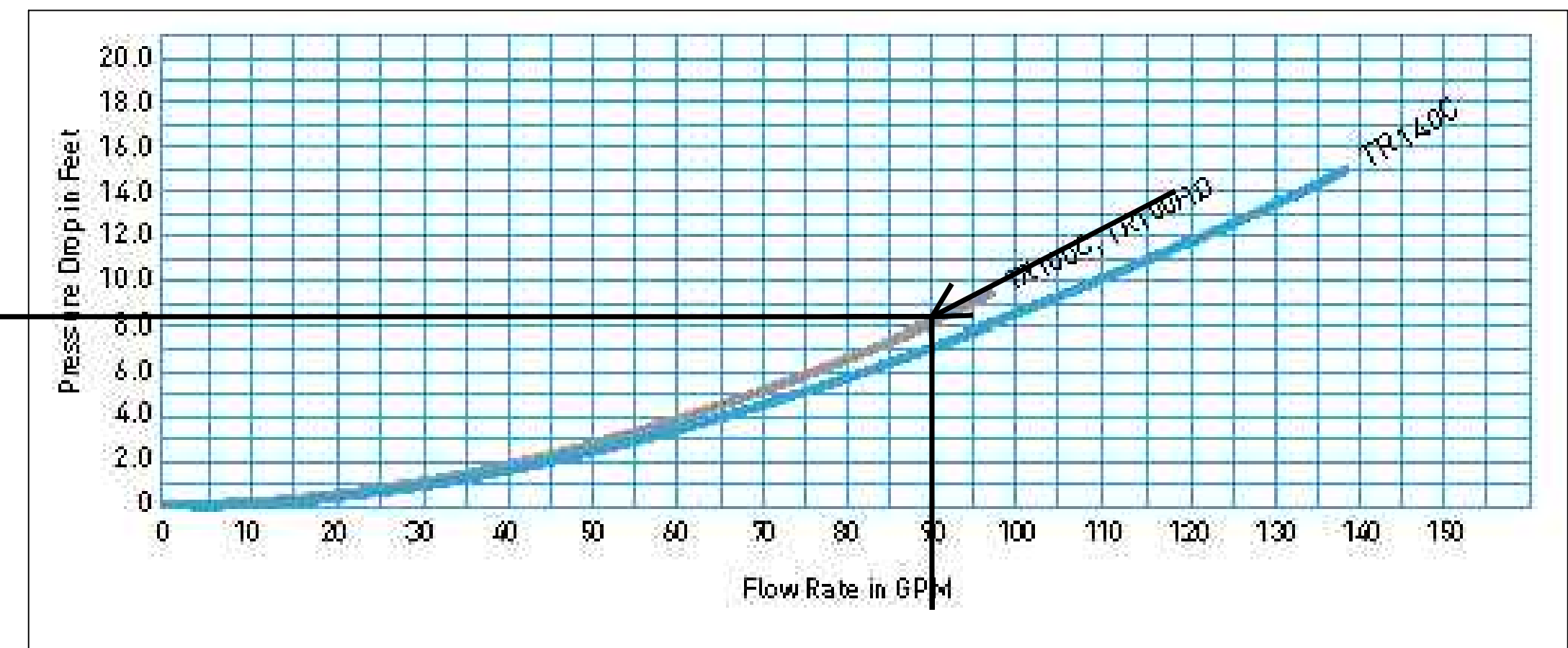

02 FILTER CURVES
PL-1.5 SCALE: NOT TO SCALE

Copyright 2014 Rotolo Consultants Inc.
These drawings or parts thereof, may not be reproduced in any form, by any method, for any purpose, without prior written consent from Rotolo Consultants Inc.
Contact: Rod Rotolo 985-643-2427

Revisions:

No.	Date	Description
01	8-6-2015	CORING CHANGE

Date: 8-4-2015
Drawn: TJH
Checked: MR

POOL SYSTEMS SCHEMATIC, CURVES, & CUT SHEETS

Drawing No.