

MATCHLINE SEE SHEET C-6.5

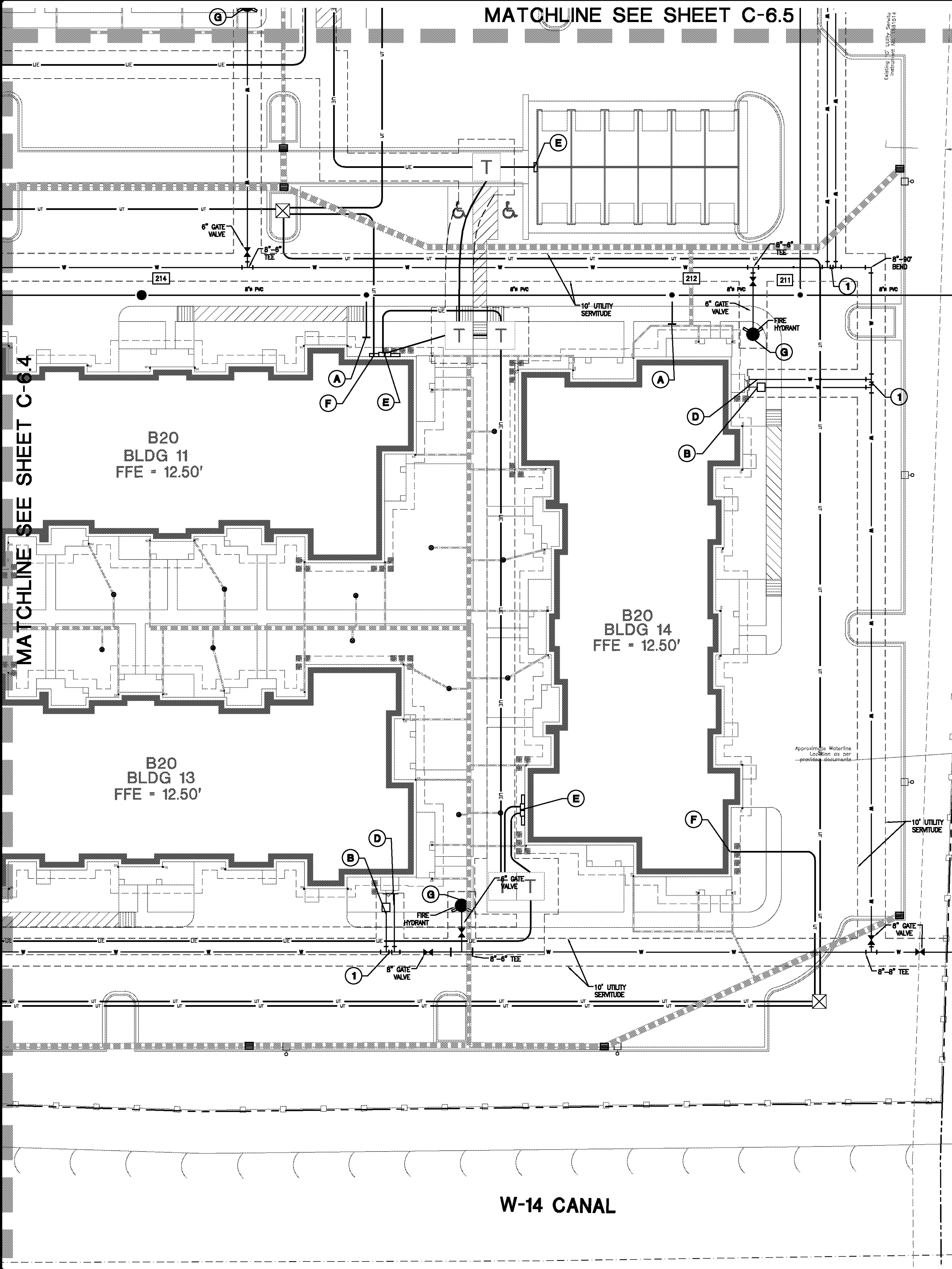

LEGEND-EXISTING

- FOUND PROPERTY CORNER (AS NOTED) ○
- EXISTING POWER POLE ○
- EXISTING POWER POLE WITH LIGHT ○
- EXISTING PARKING LOT LIGHT ○
- EXISTING GUY ANCHOR ○
- EXISTING TELEPHONE PEDESTAL ○
- EXISTING CABLE TV PEDESTAL ○
- EXISTING UNDERGROUND POWER LINE ○
- EXISTING OVERHEAD POWER LINE ○
- EXISTING TELEPHONE LINE ○
- EXISTING CABLE TV LINE ○
- EXISTING GAS METER ○
- EXISTING GAS VALVE ○
- EXISTING GAS LINE ○
- EXISTING BARR WIRE FENCE LINE ○
- EXISTING CHAIN LINK LINE ○
- EXISTING WOOD FENCE LINE ○
- EXISTING HIGH DENSITY POLYETHYLENE PIPE 12" HDPE
- EXISTING POLYVINYL CHLORIDE PIPE 12" PVC
- ELEVATION OF TOP OF STRUCTURE TOP = 18.00
- ELEVATION OF BOTTOM OF STRUCTURE INV. = 15.00
- EXISTING SPOT ELEVATION × 10.63
- ELEVATION OF TOP OF CURB 18.50 TC
- ELEVATION OF FACE OF CURB 18.00 FD
- EXISTING SEWER MANHOLE ○
- EXISTING SEWER CLEANOUT ○
- EXISTING GRAVITY SEWER LINE ○
- EXISTING SEWER FORCE MAIN ○
- EXISTING DRAINAGE MANHOLE ○
- EXISTING SUBSURFACE DRAINAGE ○
- EXISTING CATCH BASIN/DROP INLET ○
- EXISTING FIRE HYDRANT ○
- EXISTING WATER METER ○
- EXISTING WATER VALVE ○
- EXISTING WATER LINE ○
- EXISTING TERZA-COTTA PIPE 8" TC
- EXISTING REINFORCED CONCRETE PIPE 18" RCP
- EXISTING CORRUGATED METAL PIPE 24" CMP

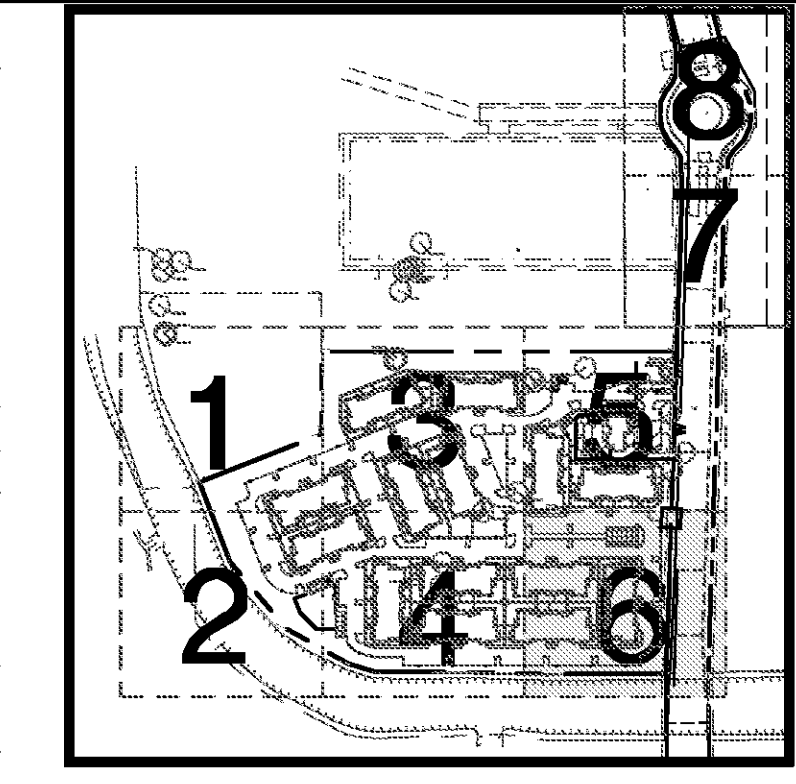

SEE SHEET C2.00 FOR GENERAL NOTES
SEE SHEET D3 FOR DETAILS

LEGEND - NEW IMPROVEMENTS

- WATERLINE
- SANITARY SEWERLINE
- GAS LINE
- UNDERGROUND ELECTRIC (5" TYP)
- UNDERGROUND TELEPHONE (2 - 4" TYP)
- STORM DRAIN SYSTEM
- POWER POLE
- SEWER MANHOLE AND STRUCTURE #
- FULL DEPTH SAWCUT AND PAVEMENT PATCHING
- TELEPHONE PEDESTAL
- CLEANOUT
- OIL/WATER SEPERATOR
- WATER VALVE
- WATER METER
- DOUBLE DETECTOR CHECK BACKFLOW PREVENTER
- FIRE HYDRANT
- AT&T HAND HOLE
- AT&T NEMA BOX (D-MARK)
- ELECTRICAL PULL BOXES
- TRANSFORMER PAD
- REFER TO SHEET C-6.0 FOR DETAIL

UTILITY LEGEND

- (A) 8" SANITARY SEWER LATERAL AT MINIMUM 1.00% SLOPE WITH CLEANOUT 3' OFF BUILDING. COORDINATE WITH ARCHITECTURAL PLANS FOR EXACT ENTRY LOCATION & ELEVATION.
- (B) 2" DOMESTIC WATER ENTRY. CONTRACTOR TO COORDINATE WITH ARCHITECTURAL PLANS FOR EXACT ENTRY LOCATIONS INTO THE BUILDINGS. CONTRACTOR IS REQUIRED TO INSTALL AN RPZ BACKFLOW PREVENTER ON THE 2" DOMESTIC LINE INSIDE THE BUILDING. REFER TO ARCHITECTURAL PLANS FOR DETAILS. THE DOMESTIC WATER METER SHALL BE SET OUTSIDE THE BUILDING, AS SHOWN. CONTRACTOR TO COORDINATE WITH CITY OF SLIDELL ON SIZE AND TYPE OF METER REQUIRED.
- (C) 2" IRRIGATION METER. CONTRACTOR TO COORDINATE WITH LANDSCAPE PLANS FOR DETAILS. CONTRACTOR TO COORDINATE WITH CITY OF SLIDELL FOR TYPE OF METER.
- (D) 4" FIREWATER ENTRY. CONTRACTOR TO COORDINATE WITH ARCHITECTURAL PLANS FOR EXACT ENTRY LOCATION INTO BUILDING. CONTRACTOR IS REQUIRED TO INSTALL A DOUBLE DETECTOR CHECK BACKFLOW PREVENTER ON 4" FIRE LINE INSIDE THE BUILDING. REFER TO ARCHITECTURAL PLANS FOR DETAILS.
- (E) UNDERGROUND ELECTRIC TO BE EXTENDED TO BUILDING BY THE ELECTRIC CONTRACTOR. CLECO WILL PROVIDE PAD MOUNTED TRANSFORMER. CONTRACTOR SHALL SUPPLY CONCRETE PAD AND CONDUIT FROM THE TIE-IN LOCATION AT THE RIGHT OF WAY TO THE TRANSFORMER. CONTRACTOR TO PROVIDE 1-5" CONDUIT FOR PRIMARY ROUTING OF ELECTRIC SERVICE. CONTRACTOR TO PROVIDE 1-4" SECONDARY CONDUIT TO THE BUILDING. CONTRACTOR TO COORDINATE WITH CLECO FOR SAID WORK. REFER TO ARCHITECTURAL PLANS FOR ENTRY LOCATION & METER DESIGN.
- (F) UNDERGROUND TELEPHONE WIRING TO BE EXTENDED TO BUILDING BY AT&T. CONTRACTOR SHALL INSTALL (2)-4" CONDUIT FOR UNDERGROUND TELEPHONE SERVICE. CONTRACTOR SHALL BE RESPONSIBLE FOR ANY TRENCHING, BEDDING, BACK FILL WHICH MAY BE REQUIRED. CONTRACTOR SHALL COORDINATE WITH TELEPHONE COMPANY FOR SAID WORK. REFER TO ARCHITECTURAL PLANS FOR ENTRY LOCATION, PANEL SIZE, & GROUND.
- (G) FIRE HYDRANT & ASSEMBLY. CONTRACTOR TO COORDINATE WITH ST. TAMMANY PARISH FIRE DEPARTMENT FOR FIRE HYDRANT TYPE & ASSEMBLY. TYPICAL AS INDICATED. CONTRACTOR TO PROVIDE BOLLARD PROTECTION WHERE SHOWN.
- (H) 2" SIGN CONDUIT SYSTEM. CONTRACTOR TO COORDINATE WITH THE DEVELOPER FOR INSTALLATION OF CONDUIT AND SIGN.

STRUCTURE TABLE

STRUCTURE NUMBER	TYPE	OUTLET/CASTING ELEV	INVERT IN	ELEVATION OUT	PIPE LENGTH	PIPE TYPE	PIPE SLOPE
208	MANHOLE	10.54	4.93 (211)	4.83 (205)	288.28	10" PVC	0.28%
205-206			5.29 ()	5.25 (206)	63.37	8" PVC	0.50%
211	CLEANOUT	10.88	5.29 ()	5.25 (206)	63.37	8" PVC	0.50%
205-211			5.25 (212)	5.25 (206)	63.37	8" PVC	0.50%
212	CLEANOUT	11.84	5.48 (213)	5.48 (211)	46.02	8" PVC	0.50%
211-212			5.52 ()	5.48 (211)	46.02	8" PVC	0.50%
213	CLEANOUT	11.28	6.03 (214)	6.03 (212)	108.78	8" PVC	0.50%
212-213			6.07 ()	6.03 (212)	108.78	8" PVC	0.50%
214	MANHOLE	12.19	6.53 (214A)	6.43 (213)	80.84	8" PVC	0.50%
213-214			6.43 (213)	6.43 (213)	80.84	8" PVC	0.50%

UTILITY PLAN SECTION 6

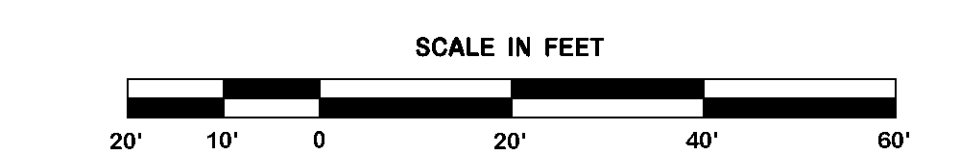

REVISION	BY

DDG
 DUPONTIS DESIGN GROUP, PC
 CIVIL ENGINEERING ARCHITECTURE
 34 LOUIS PRIMA DRIVE COVINGTON, LA 70433
 WWW.DDGPC.COM PHONE: 985-496-6860 FAX: 985-496-9190
 THIBODAUX | COVINGTON | HOUSTON | BATON ROUGE | HOUMA

PROGRESS SET - FOR REVIEW ONLY
 Issued 07/08/14
 These documents are for Design Review and not intended for construction. No liability is assumed. Signs or on the plans for the issuance of a permit. They were prepared by, or under the supervision of, Douglas E. Barillieux, P.E., #34541 Dupontis Design Group, PC

SPRINGS AT FREMAUX TOWN CENTER
 SLIDELL, LOUISIANA
 ST. TAMMANY PARISH
 FOR CONTINENTAL 294 FUND LLC
 MEMONEE FALLS, WI

DRAWN DGS
CHECKED DEB
ISSUED DATE 8/23/14
ISSUED FOR PERMITTING
PROJECT NO. 14-248
FILE 14-248 C-6 UTILITY
SHEET C-6.6