

MATCHLINE (SEE SHEET C-4.5)

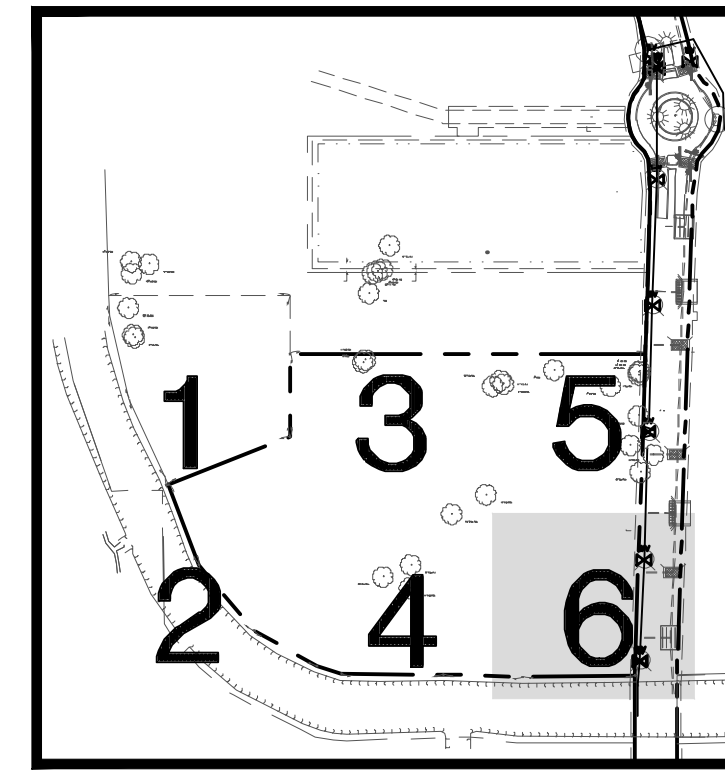

KEY MAP  
N.T.S.

LEGEND - PROPOSED

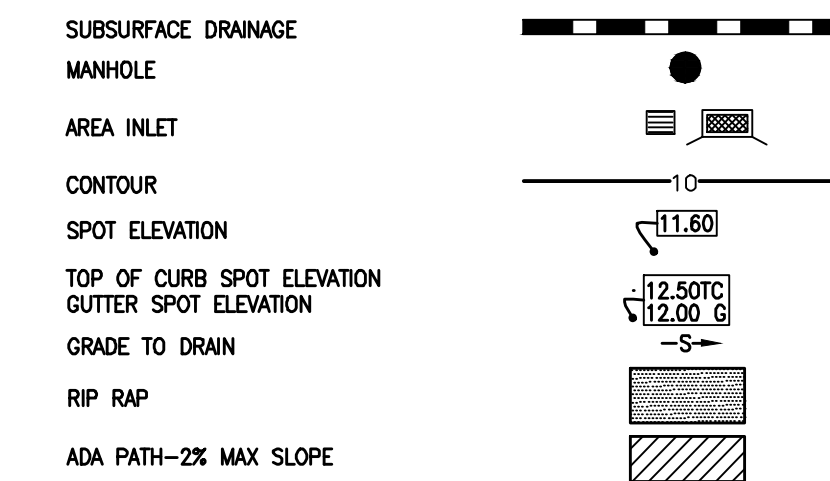

LEGEND-EXISTING

FOUND PROPERTY CORNER (AS NOTED)	○	ELEVATION OF TOP OF STRUCTURE	TOP = 18.00
EXISTING POWER POLE	⊗	ELEVATION OF BOTTOM OF STRUCTURE	INV. = 15.00
EXISTING POWER POLE WITH LIGHT	⊗*	EXISTING SPOT ELEVATION	x
EXISTING PARKING LOT LIGHT	⊗*	ELEVATION OF TOP OF CURB	18.50 TC
EXISTING GUY ANCHOR	⊗	ELEVATION OF FACE OF CURB	18.00 FC
EXISTING TELEPHONE PEDESTAL	⊞	EXISTING SEWER MANHOLE	⊞
EXISTING CABLE TV PEDESTAL	⊞	EXISTING SEWER CLEANOUT	⊞
EXISTING UNDERGROUND POWER LINE	—UE—	EXISTING GRAVITY SEWER LINE	—S—
EXISTING OVERHEAD POWER LINE	—OE—	EXISTING SEWER FORCE MAIN	—SFM—
EXISTING TELEPHONE LINE	—T—	EXISTING DRAINAGE MANHOLE	⊞
EXISTING CABLE TV LINE	—C—	EXISTING SUBSURFACE DRAINAGE	=====
EXISTING GAS METER	GM	EXISTING CATCH BASIN/DROP INLET	⊞
EXISTING GAS VALVE	GV	EXISTING FIRE HYDRANT	⊞
EXISTING GAS LINE	—G—	EXISTING WATER METER	WM
EXISTING BARB WIRE FENCE LINE	—X—	EXISTING WATER VALVE	⊞
EXISTING CHAIN LINK LINE	—O—	EXISTING WATER LINE	—W—
EXISTING WOOD FENCE LINE	—□—	EXISTING TERRA-COTTA PIPE	8" TC
EXISTING HIGH DENSITY POLYETHYLENE PIPE	12" HDPE	EXISTING REINFORCED CONCRETE PIPE	18" RCP
EXISTING POLYVINYL CHLORIDE PIPE	12" PVC	EXISTING CORRUGATED METAL PIPE	24" CMP

STRUCTURE TABLE

STRUCTURE NUMBER	TYPE	GUTTER/CASTING ELEV	INVERT IN	ELEVATION OUT	PIPE LENGTH	PIPE TYPE	PIPE SLOPE
29	AREA INLET	10.25	6.58 (29A)	6.58 (10)	157.37	30" PVC	0.20%
10-29			6.58 (28)				
29A	22.5" BEND	9.32	6.69 (29B)	6.69 (29)	55.81	24" PVC	0.20%
29B	OPEN PIPE	9.50	6.88 (29C)	6.88 (29A)	94.76	24" PVC	0.20%
29A-29B			7.13 (425)				
29C	45" BEND	12.69	6.97 (51)	6.97 (29B)	46.33	24" PVC	0.19%
29B-29C							
48	TEE	11.11	8.28 (56)	7.38 (47B)	72.84	24" PVC	0.20%
47-48							
48-49							
49	AREA INLET	10.25	7.48 (50)	7.48 (48)	48.61	24" PVC	0.20%
48-49							
50	AREA INLET	10.65	7.71 (49)	116.09	24" PVC	0.20%	
49-50							
51	AREA INLET	10.00	7.05 (29C)	40.20	24" PVC	0.20%	
29C-51							
55B	90" BEND	10.89	9.10 (55)	99.23	15" PVC	0.53%	
55-55B							
56	TEE	11.66	9.03 (56A)	9.03 (48)	149.94	18" PVC	0.50%
48-56							
56A	90" BEND	11.68	-0.62 (56)	114.50	15" PVC	-8.43%	
56-56A							

GRADING PLAN  
SECTION 6

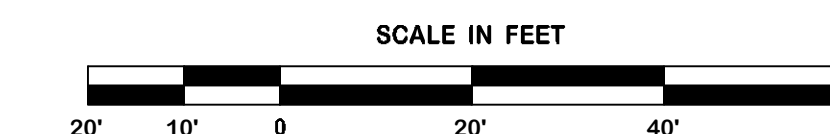

REVISION	BY
7-24-14 ADDENDUM 1	SMT
8-13-14 CITY COMMENTS	SMT
10/09/14 BUILDING UPDATE	SMT

**DDG**  
DUPLANTIS DESIGN GROUP, PC  
CIVIL ENGINEERING - ARCHITECTURE  
34 LOUIS PRIMA DRIVE COVINGTON, LA 70433  
WWW.DDGP.COM PHONE: 985-249-6860 FAX: 985-249-6190  
THIBODAUX | COVINGTON | HOUSTON | BATON ROUGE | HOUMA

STAMP  
STATE OF LOUISIANA  
DOUGLAS E. BARRILEAU  
License No. 34541  
PROFESSIONAL ENGINEER

SIGNATURE: *Ad E. Barrileau*  
DATE: 10-09-2014

SPRINGS AT FREMAUX TOWN CENTER  
SLIDELL, LOUISIANA  
ST. TAMMANY PARISH  
FOR CONTINENTAL 294 FUND LLC  
MEMONONEE FALLS, WI

DRAWN  
DGS  
CHECKED  
DEB  
ISSUED DATE  
10/09/2014  
ISSUED FOR  
PERMITTING  
PROJECT NO.  
14-248  
FILE  
14-248 C-4 GRADING  
SHEET