

TRITON® II FIBERGLASS SAND FILTER



THE #1 SAND FILTER IN THE WORLD

The Triton II filter is the result of over 40 years of product evolution and refinement. It has set the industry standard for effectiveness, efficiency, long runs between service and providing years of dependable, low maintenance operation.

The Triton II filter features a special internal design that keeps the sand bed level, ensuring even water flow and resulting in the most efficient filtration possible.

- Time-proven internal design ensures that all water receives maximum filtration for crystal clear results.
- GlasLok™ Process creates a one-piece, fiberglass-reinforced tank with a UV-resistant coating for years of dependable, corrosion-resistant service.
- Flow system design controls filtration quality and ensures maximum run times between backwashing to save you time.

THE BEST REPUTATION IN THE INDUSTRY FOR ALL THE RIGHT REASONS

Besides its superior filtration performance, the Triton II filter delivers a level of dependability and ease of operation and maintenance for a track record that's unsurpassed. Every design detail has been refined to make the Triton II filter the industry standard.

ADDITIONAL FEATURES INCLUDE:

- Combination sand and water drain speeds servicing and winterizing.
- All internal parts are threaded for ease of maintenance.
- Swing-away water diffuser allows instant access to sand and all internal parts.



TRITON® II FIBERGLASS SAND FILTER

Easy access, heavy-duty closure with built-in pressure relief valve makes inspection and maintenance fast, safer and easy

Threaded bulkhead connectors for easier installation and service

GlasLok™ Process creates a one-piece, fiberglass-reinforced tank with UV-resistant surface finish for years of unequaled strength and durability

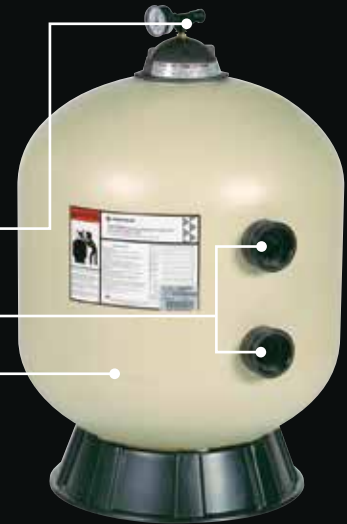

Model Number	Filter Area Sq. Ft.	Vertical Clearance*	Filter Diameter	Required Sand† (lbs)	Flow Rate GPM (Comm.)	Turnover Capacity-Res. (Gallons)		
						8 hrs.	10 hrs.	12 hrs.
TR 40	1.92	32.5"	19"	175	38	18,240	22,800	27,360
TR 50	2.46	36.75"	21"	225	49	23,520	29,400	35,280
TR 60	3.14	37.5"	24"	325	63	30,240	37,800	45,360
TR 100	4.91	41.75"	30"	600	74	35,520	44,400	53,280
TR 140	7.06	47.25"	36"	925	106	50,880	63,600	76,320

†Use standard #20 silica sand.

*Required clearance to remove the closure.

AVAILABLE FROM:



1620 HAWKINS AVE, SANFORD, NC 27330 800.831.7133 WWW.PENTAIRPOOL.COM

All Pentair trademarks and logos are owned by Pentair or one of its global affiliates. Triton® and GlasLok™ are trademarks and/or registered trademarks of Pentair Water Pool and Spa, Inc. and/or its affiliated companies in the United States and/or other countries. Because we are continuously improving our products and services, Pentair reserves the right to change specifications without prior notice. Pentair is an equal opportunity employer.

pumps • filters • heaters • heat pumps • automation • lighting • cleaners • sanitizers • water features • maintenance products

Pressure Loss Curves (TR100, TR140)

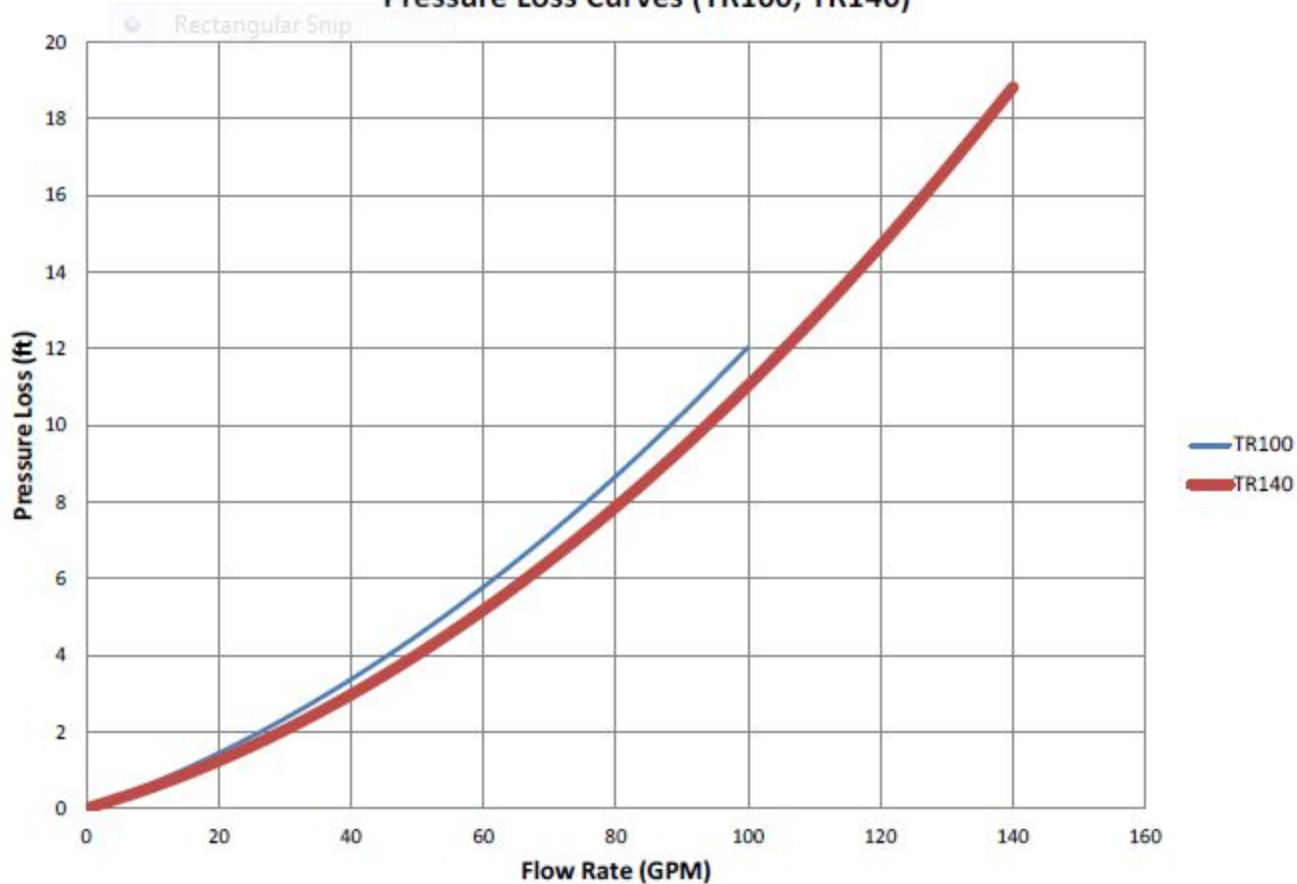

WHISPERFLO®

HIGH PERFORMANCE PUMP



THE INDUSTRY STANDARD BY EVERY MEASURE

We call it the WhisperFlo pump for good reason. This innovative hydraulic design moves water more efficiently and more quietly than competitive pumps. Under typical operating conditions, the WhisperFlo pump offers the highest water flow of any high performance pump—yet with the lowest electricity consumption. And, the WhisperFlo pump is designed to be a tireless workhorse. Its engineered thermoplastic housing withstands extreme heat and resists corrosion. The commercial grade motor frame has a rustproof, stainless steel motor shaft and sealed bearings that never need lubrication. Engineered to provide optimum performance in any size pool or pool and spa combination, the WhisperFlo pump is built to last a lifetime, and as a result, has become the industry's top seller for years.

The WhisperFlo pump costs less to operate, because it uses less horsepower to produce required water flow.

- Specially-engineered design assures whisper-quiet operation.
- Oversized strainer basket extends time between cleanings.
- See-through lid makes inspection fast and easy—engineered polymer remains clear and strong for years.
- The user-friendly Cam and Ramp™ Lid is easy to remove and quickly locks in place with a quarter-turn.

WHISPERFLO[®]

HIGH PERFORMANCE PUMP

Cam and Ramp™ Lid makes inspection and cleaning easy and quick

Heavy-duty threading for dependable worry-free connections

Durable, commercial-grade motor never needs lubrication

Oversized strainer basket extends time between cleanings

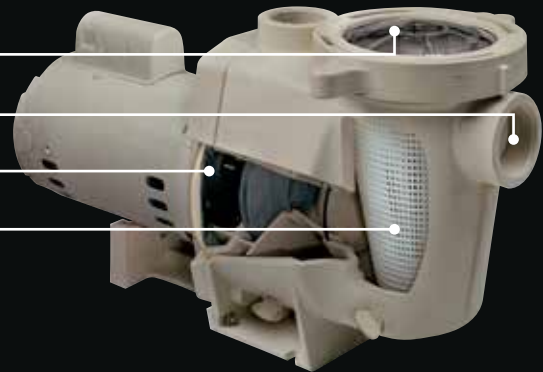

QUIET. EFFICIENT. DURABLE.

The WhisperFlo pump delivers maximum circulation efficiency at the lowest operating cost, and long, trouble-free life with minimal maintenance. Our legendary hydraulic design has been refined over 40 years for superior performance. No wonder more than 2 million Pentair pumps have been selected by pool professionals.

- Advanced FunnelFlo™ Diffuser and high-efficiency impeller maximize water flow and energy efficiency while minimizing turbulence and noise.
- Energy-efficient motor with commercial-grade frame, rustproof stainless steel shaft and permanently lubricated, sealed bearings for long life.
- Available in single-speed and two-speed models.
- Ideal for pool and spa combinations and for operating in-floor cleaning systems.

PERFORMANCE CURVES

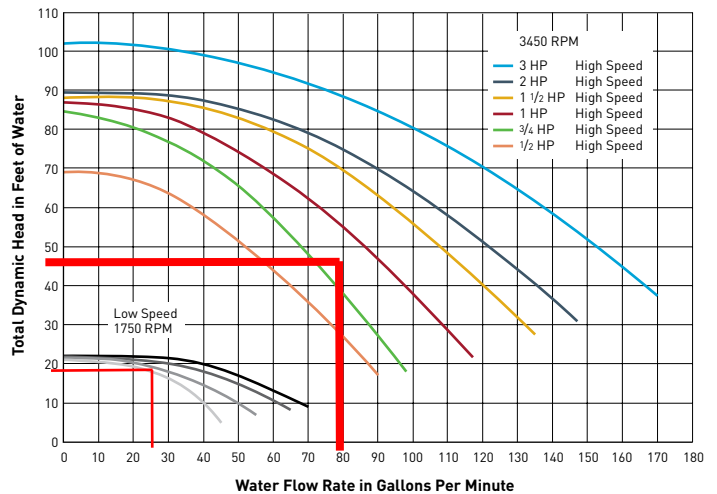

AVAILABLE FROM:



1620 HAWKINS AVE, SANFORD, NC 27330 800.831.7133 WWW.PENTAIRPOOL.COM

All Pentair trademarks and logos are owned by Pentair or one of its global affiliates. WhisperFlo®, Cam and Ramp™ and FunnelFlo™ are trademarks and/or registered trademarks of Pentair Water Pool and Spa, Inc. and/or its affiliated companies in the United States and/or other countries. Because we are continuously improving our products and services, Pentair reserves the right to change specifications without prior notice. Pentair is an equal opportunity employer.

pumps • filters • heaters • heat pumps • automation • lighting • cleaners • sanitizers • water features • maintenance products

11/14 Part # P1-222 ©2014 Pentair Water Pool and Spa, Inc. All rights reserved.



F-300

U-300

D-300

Clamp-on Insertion Mount

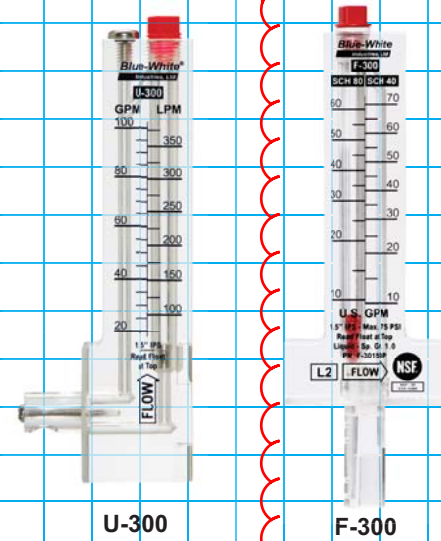

Features:

- 1" through 8" pipe sizes.
- Flow rates from 4 to 1900 GPM (15 to 7200 LPM).
- Corrosion resistant 316SS, PTFE, or PVDF internal float materials.
- One piece machined acrylic body.
- Mounts to existing pipe. No unions or adapters required.
- Models for mounting on horizontal or vertical pipe.
- Mounting clamps and gasket included.
- NSF Listed (1, 1 1/4", 1 1/2", and 2" horizontal only)

Specifications:

Pipe Requirements: IPS inch pipe size (ASTM-D-1785)
Max. Psi (bar): 75 PSI (5.2 bar) @ 70° F (21° C)
Fluid temp. range: 0° to 190° F / -18° to 88° C @ 0 PSI
Ambient temp. range: 0° to 110° F / -18° to 43° C
Note: Temperature & Pressure ratings of meter only. Actual pipe rating may vary.

Full scale accuracy: 1", 1 1/2", 2", and 3" 5%, all other 10%
Power requirement: No power required
Enclosure: NEMA 4X (IP56)
Approximate shipping wt: 1"-4" units: 1 lb. (.45 kg)
 6"-8" units: 2 lb. (.91 kg)

Materials of Construction:

Meter Body: Cast Acrylic
Float: Standard range models = 316SS or PVDF
 Low range models = PTFE

Gasket: Neoprene
Pipe Clamp: 316 series Stainless Steel
Pitot screw: 300 series stainless Steel (1", 1 1/2", 2", and 3" do not use screw)

Installation Requirements:

Minimum Straight Pipe Length Requirements

The meter's accuracy is affected by disturbances such as pumps, elbows, tees, valves, etc., in the flow stream. Install the meter in a straight run of pipe **as far as possible** from any disturbances.

Example of Minimum Straight Pipe Length Requirements

Nominal Pipe Diameter	Minimum Inlet Pipe Length	Minimum Outlet Pipe Length
4 inch	40 inch (10 X 4")	16 inch (4 X 4")
6 inch	60 inch (10 x 6")	24 inch (4 x 6")

Mounting location

- The meter is designed to withstand outdoor conditions.
- F series meters must be mounted at the vertical (twelve o'clock) position on horizontal pipe only.
- U & D series meters must be mounted on vertical pipe only.
- The pipe must be completely full of water at all times.
- See the minimum straight length of pipe requirement chart above.
- The meter can accurately measure flow from one direction only.
- U-series meters measure upward flows only.
- D-series meters measure downward flows only.

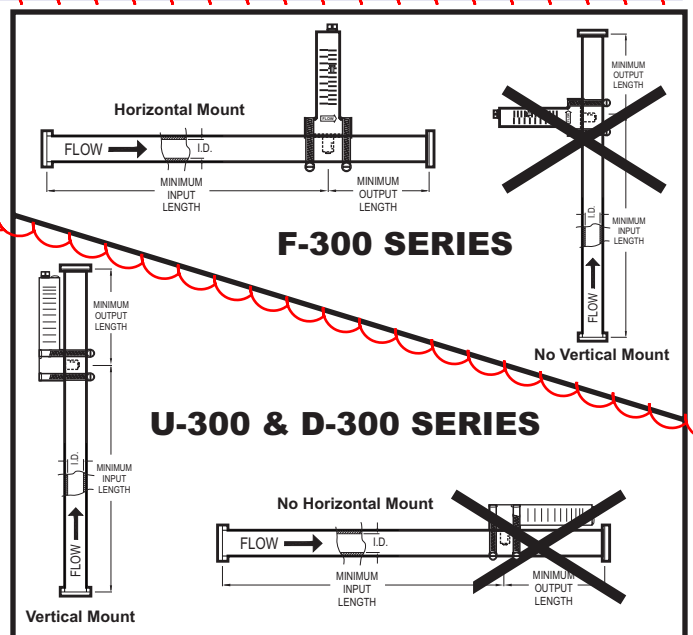

Dimensions:

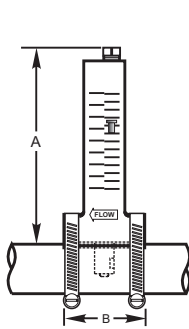

F-300 Series

Pipe Size	A	B
1"	6"	2-7/16"
1-1/4"	6"	2-7/16"
1-1/2"	6"	2-7/16"
2"	6"	2-7/16"
2-1/2"	6"	2-7/16"
3"	6"	2-7/16"
4"	6"	2-7/16"
6"	7-1/2"	2-7/16"
8"	7-1/2"	2-7/16"

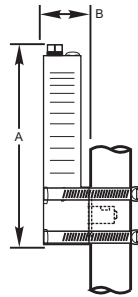

U/D-300 Series

Pipe Size	A	B
1-1/2"	6"	1-9/16"
2"	6"	1-9/16"

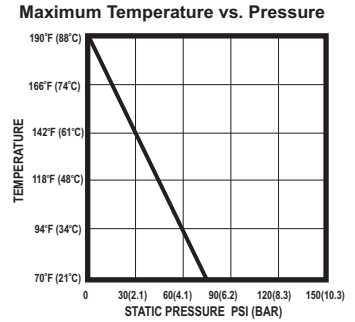

Flow Stream Requirements:

Low viscosity fluids with a specific gravity of 1.0.

Model Number Matrix:

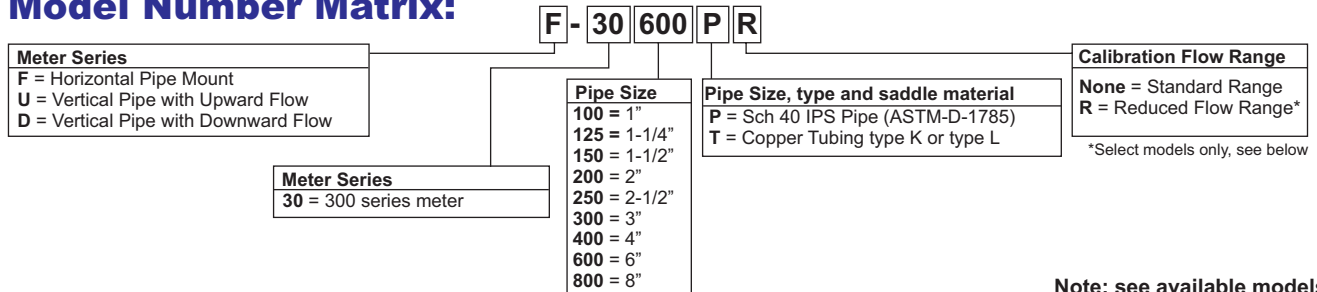

Note: see available models below.

Pipe Size, Flow Range and Display Model Options:

Models for Mounting on Horizontal Pipe

Models for U.S. IPS Sch40 Pipe (ASTM 1785) Display in U.S. Gallons and Liters per Minute

Pipe Size	GPM Flow Range	LPM Flow Range	Model Number
4"	125 to 500	550 to 2000	F-30400P
6"	250 to 1050	900 to 3900	F-30600P
8"	500 to 1900	2000 to 7200	F-30800P

Models for Copper Tubing types K & L Display in U.S. Gallons and Liters per Minute

Pipe Size	GPM Flow Range	LPM Flow Range	Model Number
4"	125 to 500	550 to 2000	F-30400T
6"	250 to 1050	900 to 3900	F-30600T
8"	500 to 1900	2000 to 7200	F-30800T

Models for U.S. IPS Sch40 & 80 Pipe (ASTM 1785) Display in U.S. Gallons per Minute

Pipe Size	Sch40	Sch80	Model Number
1"	5 to 35	4 to 26	F-30100P
1-1/4"	9 to 50	8 to 40	F-30125P
1-1/2"	10 to 70	10 to 60	F-30150P
2"	20 to 120	18 to 100	F-30200P
2-1/2"	29 to 150	25 to 130	F-30250P
3"	45 to 240	40 to 215	F-30300P

Models for Copper Tubing types K & L Display in U.S. Gallons and Liters per Minute

Pipe Size	GPM Flow Range	LPM Flow Range	Model Number
1"	4 to 26	15 to 100	F-30100T
1-1/2"	10 to 65	50 to 250	F-30150T
2"	20 to 105	75 to 400	F-30200T

Models for Mounting on Vertical Pipe

Models for U.S. IPS Sch40 Pipe (ASTM 1785) Display in U.S. Gallons and Liters per Minute

Pipe Size	GPM Flow Range	LPM Flow Range	Flow Direction	Model Number
1-1/2"	20 to 100	75 to 375	UP	U-30150P
1-1/2"	20 to 100	75 to 375	DOWN	D-30150P
1-1/2"	9 to 30	30 to 120	UP	U-30150PR
1-1/2"	9 to 30	30 to 120	DOWN	D-30150PR
2"	40 to 150	150 to 550	UP	U-30200P
2"	40 to 150	150 to 550	DOWN	D-30200P
2"	18 to 70	70 to 280	UP	U-30200PR
2"	18 to 70	70 to 280	DOWN	D-30200PR

Models for Copper Tubing types K & L Display in U.S. Gallons and Liters per Minute

Pipe Size	GPM Flow Range	LPM Flow Range	Flow Direction	Model Number
1-1/2"	20 to 100	75 to 375	UP	U-30150T
1-1/2"	20 to 100	75 to 375	DOWN	D-30150T
1-1/2"	9 to 30	30 to 120	UP	U-30150TR
1-1/2"	9 to 30	30 to 120	DOWN	D-30150TR
2"	40 to 150	150 to 550	UP	U-30200T
2"	40 to 150	150 to 550	DOWN	D-30200T
2"	18 to 70	70 to 280	UP	U-30200TR
2"	18 to 70	70 to 280	DOWN	D-30200TR

CAUTION

Do not install feeder into copper plumbing. Pipe damage could occur.
 Never install feeder before heater.
 Heater damage could occur.

#300-302 CHLORINE / BROMINE FEEDER PARTS BREAK DOWN DRAWING

Item	Qty.	Part No.	Description
1	1	R172008	3" Threaded cap
2	1	R172009	O-Ring cap
*3	1	R172020	Check valve
*4	1	R172022	Chlorine control valve
5	8'	R172023	3/8" OD x 1/4" ID tubing
*6	1	R172029	Male tube fitting 1/4" NPT
8	1	R172031	Female tube fitting 1/4" NPT
9	2	R170032	Tube fitting with nut
10	2	R172033	Gasket
11	2	R172034	Saddle clamp
12	1	R172035	Body assy. w/stand #300
12A	1	R172075	Body assy. w/stand #300-19
12B	1	R172076	Body assy. w/stand #300-29
12C	1	R172035A	Body assy. w/stand #302
*13	1	R172038	90° tube fitting-female 1/4" NPT
14	1	R172037	Spa chamber #302 only
17	1	R172052	Cap wrench (optional)
18	1	R172060	Control valve 1/4" NPT x tube with nut
19	1	R172036	Silicone lubricant
20	1	R172061	Combination check valve/elbow
21	Optional	R172080	Flow indicator
23	Optional	R172288	1 1/2"-2" Corrosion resistant check valve
24	Optional	R172323	1/4" Corrosion resistant check valve
25	1	R172061B	Standpipe adapter
26	1	R18761	6" Standpipe 3/8" OD x 1/4" ID

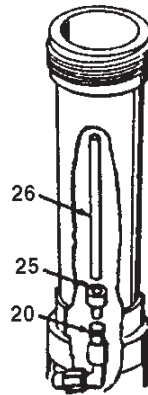

Bromine Standpipe Installation

To increase erosion of small Bromine tablets install Bromine Standpipe as follows:

1. Insert adapter (25) into check valve (20) opening end at bottom of chamber.
2. Push end of 6" tub (26) supplied into adapter opening.

FEEDER INLET LINE

If pool/spa has heater, install between filter and heater. if no heater, install between pump and filter.

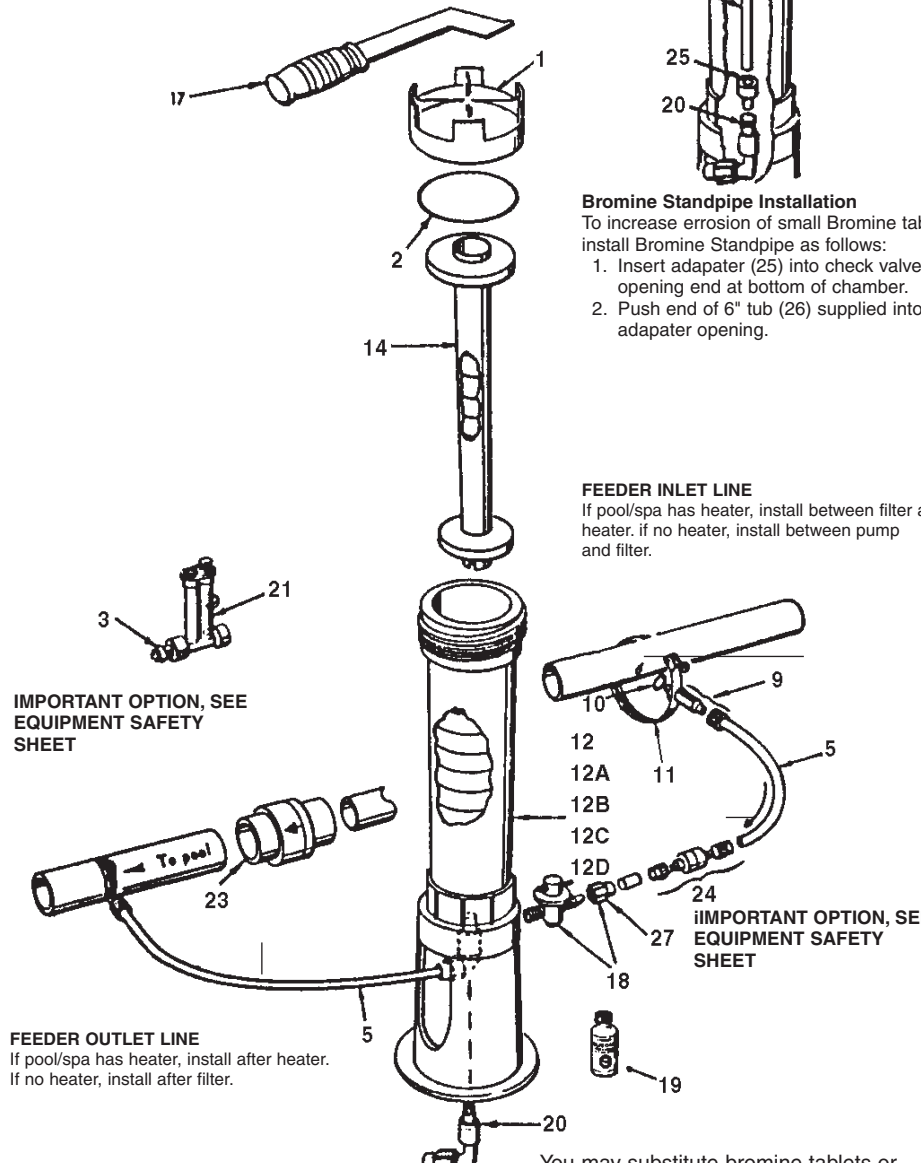

IMPORTANT OPTION, SEE EQUIPMENT SAFETY SHEET

IMPORTANT OPTION, SEE EQUIPMENT SAFETY SHEET

FEEDER OUTLET LINE

If pool/spa has heater, install after heater. If no heater, install after filter.

You may substitute bromine tablets or sticks for trichlor in these feeders. **DO NOT MIX.**

CALCIUM HYPOCHLORITE IS NOT TO BE USED IN ANY FORM.

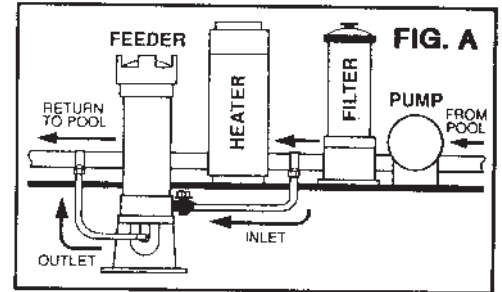

Typical installation with heater

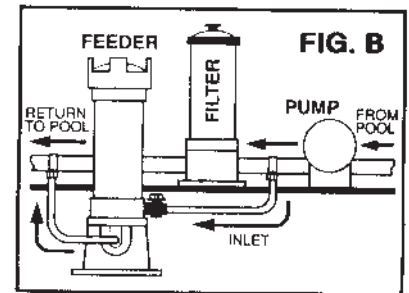

Typical installation without heater

NSF.

NSF listed for public or residential use in Swimming Pools, Spas or Hot Tubs using Trichlor or Bromine and when used with a flow indicating device such as Rainbow Lifeguard Model # R172080.





EXTENSIONS

- Going on vacation?
- Need more chlorine?
- Filling Chlorinator/Brominator too frequently?

LIFEGARD CHLORINATOR EXTENSIONS SOLVE THE ABOVE PROBLEMS BY:

1. Increasing tablet capacity.
2. Larger chamber size allows more erosion of tablets. (See special instructions below)

The 10" extension doubles and the 20" extension triples (approximately) the capacity and time between refills. ***AVAILABLE THROUGH LIFEGARD DEALERS ONLY.**

NOTE: On free standing #300 series chlorinators, the base of the chlorinator should be secured to prevent the possibility of the chlorinator tipping over due to increased height.

INSTALLATION INSTRUCTIONS

1. Follow recharging instructions to the point of filling with tablets
2. Making sure O-Ring is clean, lubricated with Lifeguard Silicone and in place, screw on extension tightly and secure with lock screw. (You may wish to wait until back in operation before tightening screw to insure against leaks).
3. Fill with tablets and continue with normal recharging procedure.

SPECIAL INSTRUCTIONS:

The large chamber size will result in more chlorine being dispensed at the same valve setting, therefore, once installed, several days monitoring will be necessary to readjust chlorinator output.

*Does not apply to large capacity #300-19 or #300-29.

Parts Breakdown Drawing

Item	Quantity	Part No.	Description
1	1	R172078	Lockscrew (bottom collar)
2	1	R172009	O-Ring

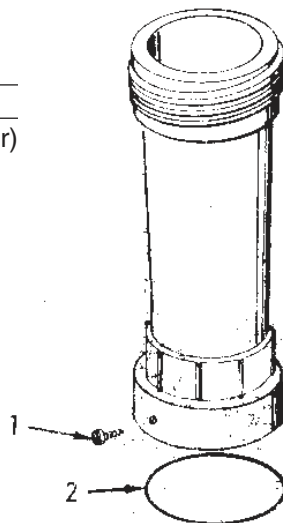

#R172087
10" Chlorinator extension complete

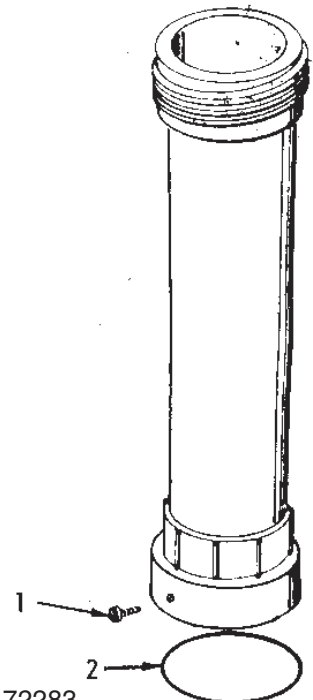

#R172283
20" Chlorinator extension complete





#R172323, #R172324 & #R172288 CHECK VALVE INSTALLATION INSTRUCTIONS

NOTE: MAKE SURE ALL PUMPS AND TIMER SWITCHES ARE IN THE OFF POSITION.

#R172323* 1/4" CHECK VALVE & #R172324* 1/2" CHECK VALVE INSTALLATION:

1. Cut Chlorinator inlet line at desired location.
2. Slide compression nut over one end of line. Make sure arrow on check valve is pointing toward Chlorinator, insert barbed end of check valve into line and tighten the nut finger tight. Repeat procedure for other end of check valve.

#R172288 1 1/2"-2" CHECK VALVE INSTALLATION:

1. Cut piping at required location for your situation (refer to drawings).
2. Making sure arrow on check valve is pointing away from equipment and in the direction of water flow to the pool/spa, glue in check valve using PVC solvent cement. 1 1/2" pipe will glue directly in valve, 2" pipe requires two 2" slip x slip couplings

WITH HEATER

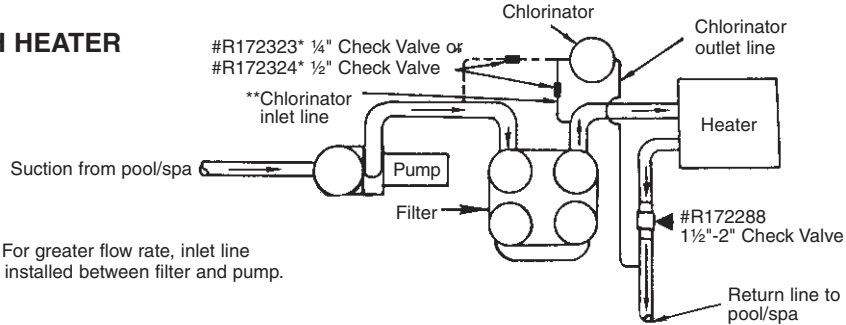

**Note: For greater flow rate, inlet line may be installed between filter and pump.

NOTE: If heaters are used, a FIREMAN'S SWITCH or equivalent must be installed to prevent possible damage and improper operation of CHECK VALVE and other equipment subject to heat damage.

WITHOUT HEATER

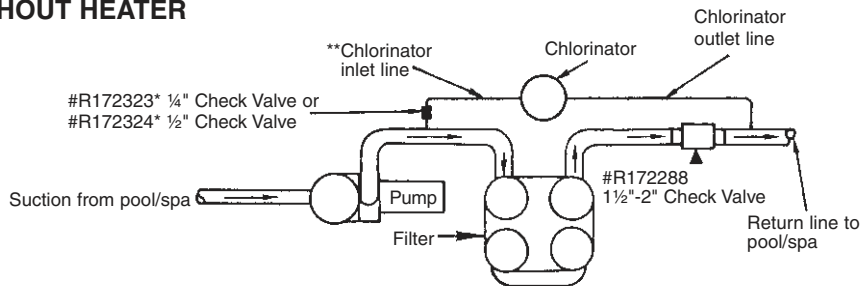

EQUIPMENT SAFETY

CAUTION

PLEASE READ CAREFULLY

Since most pool plumbing is not airtight, and a mixture of air and chlorine is highly corrosive to metals, it is important to protect these items from corrosion in the OFF period when no circulation is taking place. (There is no chance for chlorine corrosion when the circulating system is in operation.)

Of course, corrosion or erosion of metal components can still occur independently of any chlorinator installation for the following reasons:

1. Water velocity too high.
2. Water pH less than 7.2.
3. Total alkalinity less than 100 PPM.

If your pool or spa has any of the following equipment, special plumbing procedures must be followed for safe operation:

1. Brass or bronze gate, rotary or backwash valves.
2. The preceding valves constructed of PVC or other plastic material with metallic shafts.
3. Filters, heaters, heat exchanges or other items with metallic tanks, shafts, coils or tubes.
4. **NOT FOR USE IN COPPER PLUMBING.**

Installation of the **OPTIONAL** Rainbow #R172288, #R172323* and #R172324* positive seal, corrosion resistant check valve **SHOWN ON REVERSE SIDE** will prevent the backflow of corrosive liquids and gases that can damage equipment containing metallic components. Examples listed above.

*Note: Valve size and tubing size must match.

WARNING: If your pool is equipped with a permanent built in pool-cleaning system, damage could occur to that system if materials are not compatible with low pH Tri-Chloro feeders. Check with manufacturer for compatibility.



© 2010 Pentair Water Pool and Spa, Inc. All rights reserved

1620 Hawkins Ave., Sanford, NC 27330 • (919) 566-8000

10951 West Los Angeles Ave., Moorpark, CA 93021 • (805) 553-5000

Rainbow LifeGuard™ and Pentair Water Pool and Spa® is a trademark and/or a registered trademark of Pentair Water Pool and Spa, Inc. and/or its affiliated companies in the United States and/or other countries. Unless noted, names and brands of others that may be used in this document are not used to indicate an affiliation or endorsement between the proprietors of these names and brands and Pentair Water Pool and Spa, Inc. Those names and brands may be the trademarks or registered trademarks of those parties or others.

Technical Support: (800) 831-7133



R24292 Rev C

Fig.1

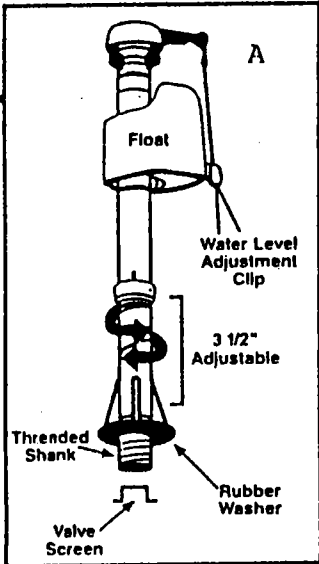
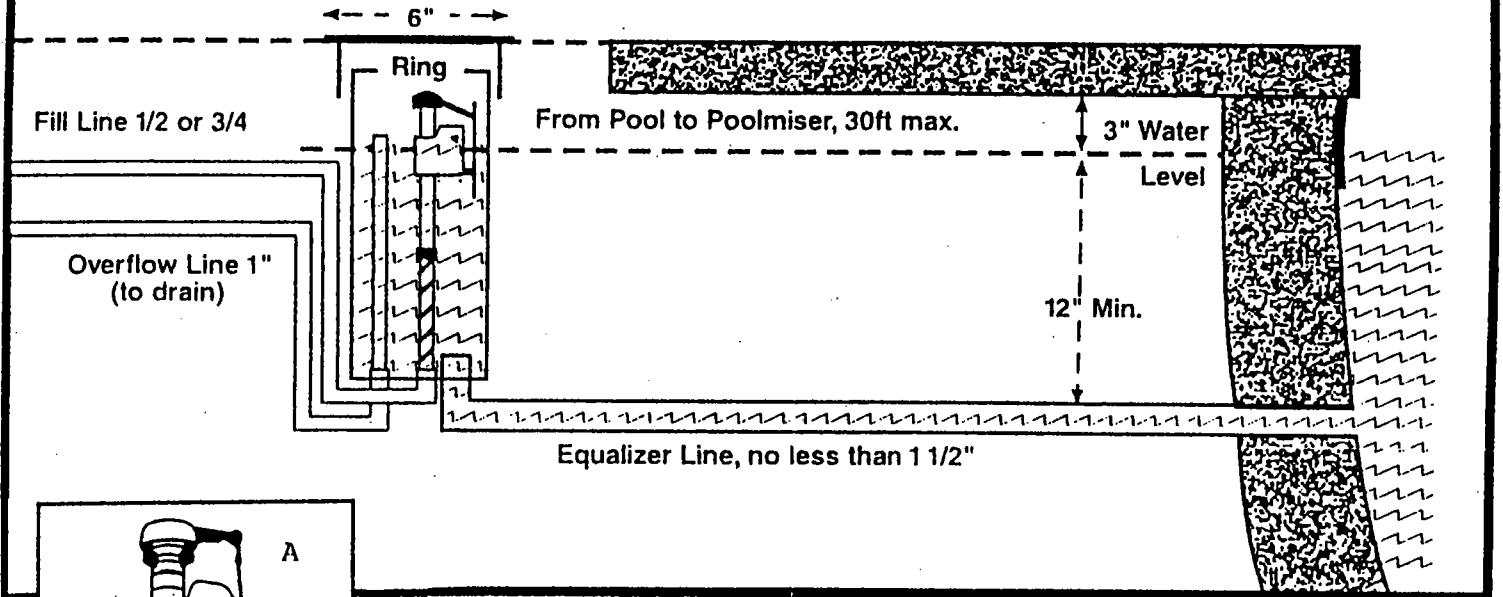
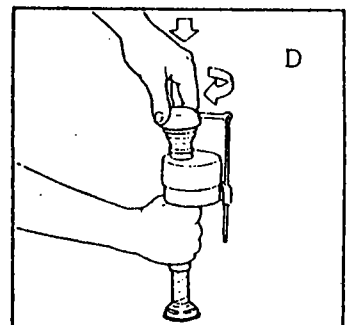
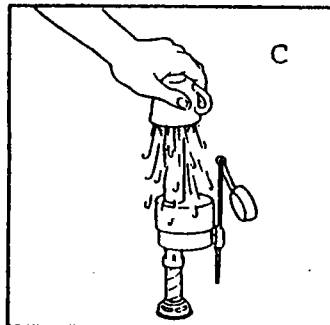
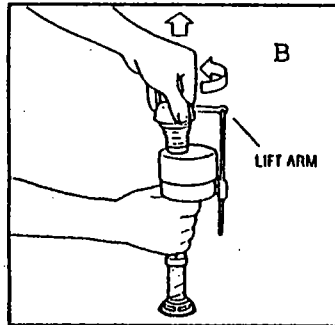

Fig.2 (CLEARING SAND AND RUST FROM VALVE)



Clear sand and rust from system: Remove valve TOP by lifting arm and rotating top 1/8 turn counterclockwise. While holding a container over the uncapped VALVE to prevent splashing, turn water supply on and off a few times. Replace TOP by engaging lugs and rotating 1/8 turn clockwise. MAKE CERTAIN TOP IS TURNED TO THE LOCKED POSITION. VALVE MAY NOT TURN ON IF TOP IS NOT FULLY TO THE LOCKED POSITION.

PACKING LIST:

- 1 = Tank
- 1 = Ring Lid
- 1 = Valve
- 1 = 1" x 10" Overflow PVC Pipe
- 1 = Instruction Sheet w/pkg. of 3 screws, 1 filter, 1 washer

WARRANTY

POOLMISER WILL WARRANTY THAT THE TANK, RING AND LID WILL BE FREE FROM DEFECTS AT THE TIME OF SHIPMENT. INSPECT CAREFULLY BEFORE YOU INSTALL THEM. THE FLUIDMASTER VALVE HAS A MANUFACTURER'S WARRANTY TO BE FREE FROM DEFECTIVE MATERIALS AND WORKMANSHIP FOR A PERIOD OF THREE YEARS.

FILL IN INFORMATION BELOW; AFFIX POSTAGE AND MAIL TODAY

CUT HERE

Date purchased _____

Installed by Pool contractor

Date installed _____

Plumber

Your name and address _____

Yourself

Purchased from _____

Name and address _____

Signature _____

★ ★ INSTRUCTIONS ★ ★

LOCATION VERY IMPORTANT

To eliminate possible earth movement problems, we suggest installing the POOLMISER outside of the decking area. We recommend that the POOLMISER and all pipes within 3 feet be backfilled with sand.

STEP 1

BUILT-IN POOLS (GUNITE OR CONCRETE): Before you gunite, place the POOLMISER (with the tank top) 3 inches higher than desired water level (see Fig.1). Extend the 1 1/2" equalizer line through the gunite, allowing enough to extend through finished plaster, (can be cut later). **VERY IMPORTANT:** The equalizer line must be a minimum of 12 inches below desired water level. Hook up the threaded fill inlet to the water line and connect the overflow line to a convenient drain. (It is recommended to add a shut-off valve between the POOLMISER and the main water line). When guniting, fill tank with newspaper to make clean-up easier.

***VINYL LINER IN-GROUND POOLS, ABOVE GROUND POOLS, STEEL WALL POOLS, TUBS OR SPAS:** Use the same process as above. The only difference is the equalizer line must go through the wall, using an inlet fitting.

STEP 2

Before installing the valve into the tank, remove newspaper, insert the black washer seal and the filter screen, (see Fig. 2A); flush the lines two or three times. Remove the cap from the valve (see Fig.2B) to permit it to screw freely into the tank. Hand tighten the valve into the tank.

Before replacing the cap, flush the whole system one more time, (see Fig. 2C). Put the cap back on (see Fig. 2D); turn on your water supply, and your POOLMISER is now ready to operate.

NOTE 1

To adjust water level, turn off water supply, remove the cap (see Fig. 2B); adjust the shank (turn to the left for lower and to the right for higher) to the proper desired level, and replace the cap (see Fig. 2D). Water level is usually set between 3 and 4 inches below the top of the cap. Turn on the water supply. A final tune-up can be made by adjusting the clip on the side of the float (see Fig. 2A).

VERY IMPORTANT (Please Read)

- A) *Do not reduce the equalizer line; 1 1/2" is the minimum (line can be bigger). Equalizer line can be installed at any depth below 12" from top of water (up to 10 feet).
- B) *For better results, keep the fill line between 30 psi to 60 psi.
- C) *It is a good idea to take the valve apart before you install your first unit to know how the valve functions, for adjustments and for maintenance.
- D) *Overflow line should always be hooked up to prevent overflowing from heavy rain or malfunction of the system.
*The provided overflow stand pipe is tight-fitting; Do Not Glue.

.....

GENERAL INFORMATION

- *The POOLMISER will operate the same if it is placed one foot from the pool or up to 15 feet away.
- *The POOLMISER is capable of adding up to 4000 gallons of water in a 24 hour period.
- *The POOLMISER should be turned off completely for 15 days after installation, to make sure your pool is not leaking.
- *If the valve does not close completely, or if it drips, there is some dirt or debris in the valve cap. Clean cap under running water, and flush the line (see Fig. 2B, 2C. & 2D).
- *Water hammer can be caused by a variety of factors...if you experience water hammer in the operation of your POOLMISER, consult with a plumber.
- *The POOLMISER is made of ABS plastic; most of the piping is made of PVC plastic. Be sure to use a pipe cement compatible with both materials.

.....

PLACE
STAMP
HERE

POOLMISER, INC.
307 Sixth Street
Petaluma, CA 94952



In-Ground Skimmers

FOR CONCRETE POOLS

Hayward in-ground pool skimmers are the preferred choice of professional pool builders. Engineered for residential and commercial applications, these large capacity skimmers are manufactured to Hayward's rigorous quality standards. Their durable, unibody construction is molded of rugged ABS, and they've been designed without submerged joints. Hayward skimmers come with multiple plumbing connections for easier installations.

All Hayward skimmers are non-corrosive, non-conductive and virtually indestructible, no matter what Mother Nature dishes out.

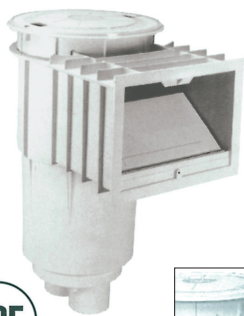

SP10712



Overflow Port

Skim-Master™ Series

Skim Master is a non-corrosive, large capacity automatic surface skimmer featuring a round, tamper-proof access cover, self-adjusting 8" weir with stainless steel spring for added strength, dual outlets, and threaded internal connections for pressure testing. The optional float/bypass valve provides a main drain-thru-skimmer system and an automatic safety bypass for low water conditions. No glue is used in manufacturing, promoting maximum strength and longevity. SP1070 Series provide a knockout overflow port that guards against overflow or pool water refill. All Skim-Master Series Skimmers are available with Float Valve and Equalizer Kit to meet specific NSF commercial requirements.

Model Number	Pipe Size	Cover Style	Throat Length	Ctn. Qty.	Ctn. Weight	Product Descriptions
SP1070	1 1/2" FIP	Round	4 1/2"	1	8 lbs.	ABS Body adjustable cover (deck) collar. Round tamper-proof cover, basket, weir, overflow port, Flo-Control plate. Dual outlets, have threaded internal cZons for pressure testing.
SP1070S	1 1/2" SKT	Round	4 1/2"	1	8 lbs.	
SP10712	2" FIP	Round	4 1/2"	1	8 lbs.	Same as SP1070 plus weir incorporated with Stainless Steel Spring.
SP10712S*,**	2" SKT	Round	4 1/2"	1	8 lbs.	

*Available in Gray, Dark Gray and Black. Add suffix GR for Gray, DGR for Dark Gray and BLK for Black.
 **Available with tan collar and cover. Add suffix 10 to model number.
 For skimmer packaged with float valve, add suffix FVA to model number.

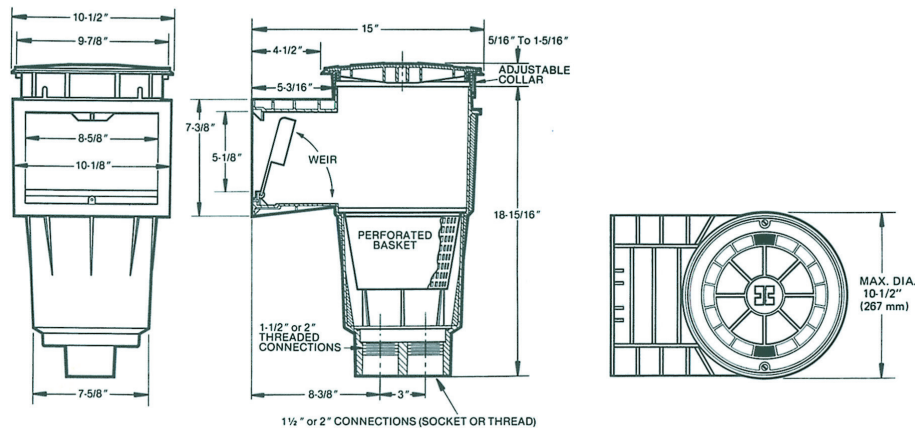

Measurements are for reference only.



SP 1080 Auto-Skim™ Series

Auto-Skim features include an automatic by-pass for low water conditions, adjustable cover collar, snap-in weir that adjusts automatically to water level fluctuations up to 4 1/2", a rigid, 163 cubic inch basket, integral Flo-Control slide plate and a choice of threads for piping versatility. Molded of 3/16" ABS, they are ideal for pools located in colder climates. All SP1080 Series Skimmers are available with Float Valve and Equalizer Kit to meet specific NSF commercial requirements.

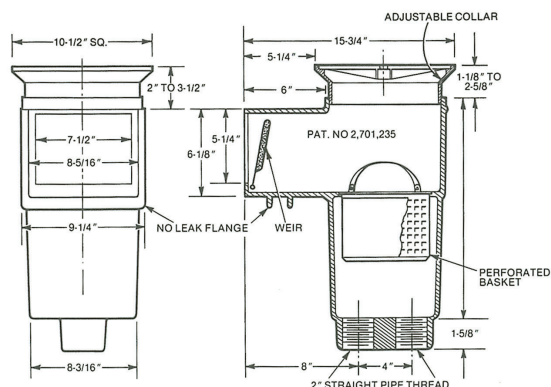

Measurements are for reference only.

Model Number	Pipe Size	Cover Style	Throat Length	Ctn. Qty.	Ctn. Weight	Product Descriptions
SP10821	1 1/2" FIP	Square	5 1/4"	1	10 lbs.	ABS Body, adjustable cover collar, Tamper-proof cover, basket, weir, Flo-Control slide plate.
SP1082*	2" FIP	Square	5 1/4"	1	10 lbs.	
SP10821R	1 1/2" FIP	Round	5 1/4"	1	10 lbs.	Same as SP10821, but with 9 1/2" diameter ROUND cover.
SP1082RC*	2" FIP	Round	5 1/4"	1	10 lbs.	

*Available in Dark Gray. Add Suffix DGR to model number for Dark Gray.



SP 1096 Auto-Skim™ PT & Economy Series

The PT Skimmer features a tamper-proof cover with a stackable deck collar that allows 2" vertical height extension, a snap-in, self-adjusting weir which accommodates fluctuations in water level, integral flow control slide plate, and a rigid basket with load extender ribs. Dual ports for pump and main drain connection are compatible with both 1" and 2" piping, which can be used with the same installation selections as standard Auto-Skim.

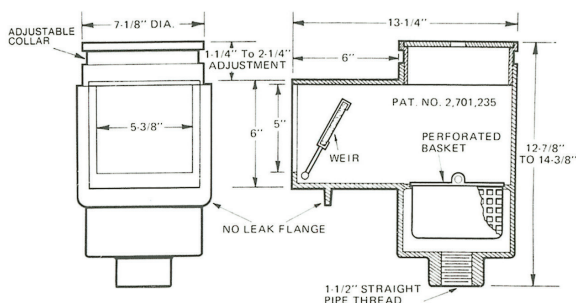

Measurements are for reference only.

Model Number	Pipe Size	Cover Style	Throat	Ctn. Qty.	Ctn. Weight	Product Descriptions
SP1096	1 1/2" FIP	Round	6"	1	6 lbs.	ABS Body, adjustable cover collar, cover, basket, weir

To find out more information about In-ground Gunite Skimmers or other Hayward products, go to hayward.com or call 1-888-HAYWARD.

CERTIFICATION OF COMPLIANCE

8" TRU FLO DRAIN COVER



Contents: **1**

Part Number: **640-18XX V**

Description: **Round Tru Flo Drain & Frame**

Size: **8"**

Open Area: **14.8 in²**

GPM @ 1.5 fps: **68**

Floor Flow Rate: **153 GPM**

Wall Flow Rate: **96 GPM**



Date of Manufacture:

Date of Installation: _____

Name of Installer: _____

Signature of Installer: _____

This product has been tested, certified and listed to the requirements of **ASME/ANSI A112.19.8-2007, ASME/ANSI A112.19.8a-2008, ASME/ANSI A112.19.8b-2009 and APSP-16-2011** per §1404 of the Virginia Graham Baker (VGB 2008) Pool and Spa Safety Act. Certified by: Underwriters Laboratories, Inc., 2929 E. Imperial Highway, Suite 100, Brea, CA 92821-6729

This product is certified to comply with §1404 of the Virginia Graham Baker (VGB 2008) Pool and Spa Safety Act. A copy of the test results for the above may be found at www.waterwayplastics.com or go to: www.ul.com. This product is manufactured by Waterway Plastics, Oxnard CA 93030

This certificate not valid without signature.



Waterway™

2200 East Sturgis Road Oxnard CA 93030 • Phone 805.981.0262 • Fax 805.981.9403
waterway@waterwayplastics.com • www.waterwayplastics.com

Fittings



Hayward fittings are manufactured to the highest standards of design and material to provide extra durability and long lasting performance. All are manufactured by Hayward of high quality, UV resistant, ABS and have been installed by pool professionals throughout the world setting the standard for excellence and value.

Vacuum Fitting/ Receptacle For Concrete Pools



SP-1022* 1 1/2" FIP, White
SP-1022S 1 1/2" Socket, White.

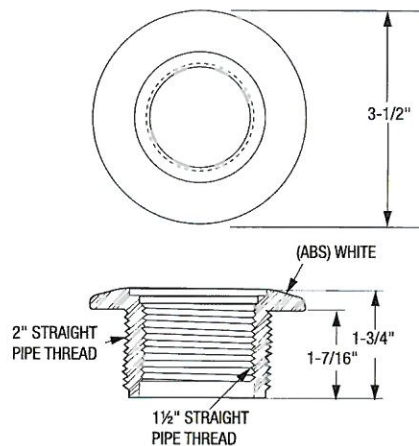

Directional Flow Inlet Fittings



SP-1419B Hydrostream 3/8" opening
SP-1419C Hydrostream 1/2" opening
SP-1419D Hydrostream 3/4" opening
SP-1419E Hydrostream 1" opening

Extended Flange Directional Flow Eyeball Fitting



SP1418D 1 1/2" MIP Hydrostream 3/4" opening
SP1422D 1 1/2" slip Hydrostream Insider 3/4" opening
SP1422E 1 1/2" slip Hydrostream Insider 1" opening

Type 1422D-2" Hydrostream Insider Fitting
for 2" Schedule 40 PVC pipe

Gutter Drain Attractive and Streamlined

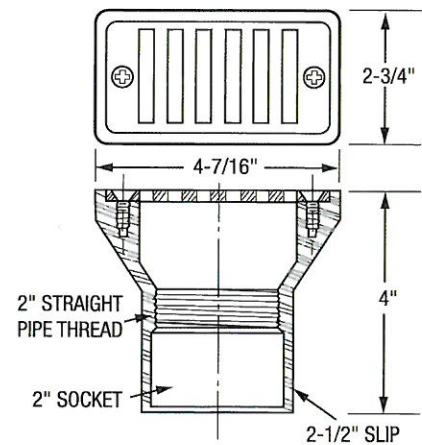

Model No.	Description
SP-1019	2" FIP plus 2" Socket Connection. White Body and Grate.

Superior Series S-350 Lift

Standard Features

- ADA Compliant Pool Lift
- Stainless Steel Construction
- Powder Coat Finish
- Lift Capacity 350 lbs
- Battery Powered 24 volt system
- User Friendly controls
- 5-year Structural Warranty
- Arm Rests
- Foot Rest
- Safety Seat Belt
- UPS Packaging for easy shipping
- Used for spas and pools
- Fits Most Standard Pool Applications
- UV Resistant
- Right Seat Application
- Includes Battery Charging Station
- Sleeve Anchor System (Optional)

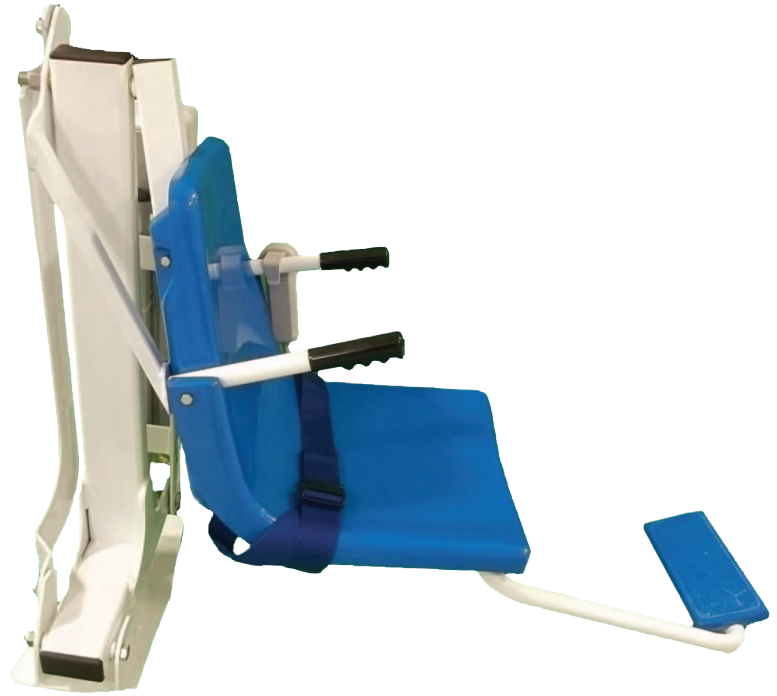

Global Lift Corp. Products are Laboratory tested to meet ADA Standards

The new Anti-Pinch Linkage System (Patent Pending) holds the seat in a level position with an external linkage system that virtually eliminates pinch points.

Options



Protective Cover



Extra Battery



2012

New ADA Laws

- All of our lifts are compliant with the New ADA Laws
- All swimming pools in the USA that fall under Title II or Title III need to comply with the new laws.

Title II (Public Industry) municipal pools, school pools, government owned pools, etc.

Title III (Private Industry) place of recreation, place of lodging, which addresses public accommodations

- Existing pools shall become compliant with accessibility by March 15, 2012
- There are tax incentives available
See details at www.GlobalLiftCorp.com

S-350

DECK CONFIGURATOR FORM

PLEASE CHOOSE WHICH APPLICATION YOUR POOL GUTTER BEST REPRESENTS

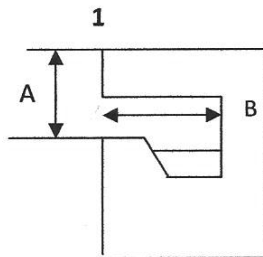

Fully Recessed Gutter

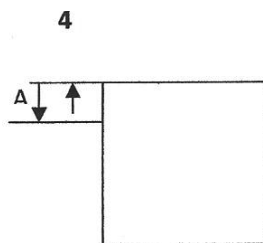

Gutter less Deck

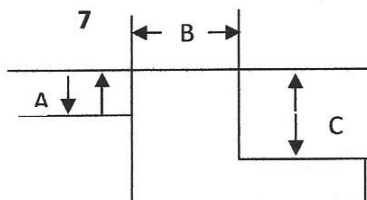

Above Ground Pool

LEGEND MIN/MAX

A= (Draft) pool deck to water line 0 – 7"

B= Width of Gutter 1 – 12"

C= Height of Curb 1 – 2"

NOTE: If your pool doesn't fall within these measurements, Please contact your dealer for assistance

Dealer:

Taylor's 2000 Series Test Kits

INTRODUCTION

The 2000 Series™ was designed to permit users to **build up their test kits in a stepwise fashion** as their testing needs grow without having to purchase duplicate components. The family of products includes the **Starter™**, **Test 4™**, **Complete™**, **Service Complete™**, and **Pool Inspector™** models. Thanks to this upgrade system, a buyer can begin with the fundamentals in the Starter kit and build his way to a comprehensive testing tool called, appropriately enough, the Complete kit.

Options in the 2000 Series include high- or low-range sanitizer values, .75 oz. or 2 oz. reagent bottles, and kits in Spanish. All cases feature a piano-style interlocking hinge and a handle for easy transport.

Over the years, salt systems have become a popular way to sanitize pools and spas. To be successful, these systems require a minimum salt concentration. Too low, and not enough chlorine will be produced to inhibit algae and bacterial growth. To monitor the salt concentration, Taylor has added a new kit to its lineup—**K-2005-SALT**. This kit contains the same tests as the K-2005, plus a test for sodium chloride.

The heart of any test kit is the comparator block, used for obtaining the water sample, mixing the reagents, and matching colors. Ours are the finest available. Advantages include **raised fill marks** to help ensure proper test volumes; **frosted backing** for uniform color perception; and **dilution guides** that make dealing with high concentrations a breeze. In 2012 we improved the visibility of the CYA test scale by adding a flange, and we resized the large comparator tube to work with our optional sample-sizing tools #6190 and #6191.

Several of the kits in this series feature **FAS-DPD drop tests**, which can measure free and combined chlorine directly as low as 0.2 ppm. The reading is made by noting a distinct change from vibrant pink to colorless in the reacted water sample. This method is also beneficial when testing samples with a high level of sanitizer (>3–20 ppm chlorine) because there is no need to interpret close shades of pink. The method is a boon for colorblind users too.

All kits include a copy of *Pool & Spa Water Chemistry: A Testing & Treatment Guide*. Written by experts in water chemistry, this waterproof booklet contains information about sanitation and water balance, as well as **tables for water treatment**. (Spanish kits have translated instructions and a Spanish guide.)



Testing with a Complete kit will answer how much sanitizer to add, when and how much to shock treat, and what adjustments are needed to prevent corrosion and scaling conditions.

Complete and Service Complete kits also contain Taylor's unique **Watergram®** for quick water balance calculations.

Topnotch chemistry and easy-to-follow instructions make the 2000 Series the perfect choice for service technicians, public pool operators, environmental health pool inspection programs, and do-it-yourself consumers.

To save money, inquire about the availability of multipacks.

2000 SERIES

K-2000 (available in English or Spanish)

Starter-high (uses DPD): chlorine 1–10 ppm; bromine 2–20 ppm; pH 7.0–8.0; acid & base demand; .75 oz. bottles

K-2100

Starter-low (uses DPD): chlorine .25–2.5 ppm; bromine .5–5 ppm; pH 7.0–8.0; acid & base demand; total alkalinity; .75 oz. bottles

K-2015

Test 4-high (uses DPD): chlorine 1–10 ppm; bromine 2–20 ppm; pH 7.0–8.0; acid & base demand; total alkalinity; .75 oz. bottles

K-2115

Test 4-low (uses DPD): chlorine .25–2.5 ppm; bromine .5–5 ppm; pH 7.0–8.0; acid & base demand; total alkalinity; .75 oz. bottles

K-2005 (available in English or Spanish)

Complete-high (uses DPD): chlorine 1–10 ppm; bromine 2–20 ppm; pH 7.0–8.0; acid & base demand; total alkalinity; calcium hardness; cyanuric acid; .75 oz. bottles

K-2005-SALT

Same tests as K-2005, plus a test for sodium chloride.



the most trusted name in water testing

Taylor Technologies, Inc.
410-472-4340
800-TEST KIT (837-8548)
www.taylortechnologies.com

ISO 9001:2008 Certified

2000 SERIES (cont'd)

K-2006 (available in English or Spanish)

Complete-high (uses FAS-DPD): chlorine 1 drop = 0.2 or 0.5 ppm; pH 7.0–8.0; acid & base demand; total alkalinity; calcium hardness; cyanuric acid; .75 oz. bottles

K-2006-SALT

Same tests as K-2006, plus a test for sodium chloride.

K-2105

Complete-low (uses DPD): chlorine .25–2.5 ppm; bromine .5–5 ppm; pH 7.0–8.0; acid & base demand; total alkalinity; calcium hardness; cyanuric acid; .75 oz. bottles

K-2106 (available in English or Spanish)

Complete-high (uses FAS-DPD): bromine 1 drop = 0.5 or 1.25 ppm; pH 7.0–8.0; acid & base demand; total alkalinity; calcium hardness; .75 oz. bottles

K-2005C (available in English or Spanish)

Service Complete-high (uses DPD): chlorine 1–10 ppm; bromine 2–20 ppm; pH 7.0–8.0; acid & base demand; total alkalinity; calcium hardness (w/ pipet option); cyanuric acid; 2 oz. bottles

K-2006C (available in English or Spanish)

Service Complete-high (uses FAS-DPD): chlorine 1 drop = 0.2 or 0.5 ppm; pH 7.0–8.0; acid & base demand; total alkalinity; calcium hardness (w/ pipet option); cyanuric acid; 2 oz. bottles

K-2105C

Service Complete-low (uses DPD): chlorine .25–2.5 ppm; bromine .5–5 ppm; pH 7.0–8.0; acid & base demand; total alkalinity; calcium hardness (w/ pipet option); cyanuric acid; 2 oz. bottles

K-2007

Pool Inspector-high (uses DPD): chlorine 1–10 ppm; bromine 2–20 ppm; pH 7.0–8.0; extra cyanuric acid; .75 oz. bottles

K-2007C

Same tests as K-2007, except bottles are 2 oz.

K-2009

Pool Inspector-low (uses FAS-DPD): chlorine 1 drop = 0.2 or 0.5 ppm; pH 7.0–8.0; extra cyanuric acid; .75 oz. bottles

USER BENEFITS

- Reagents dispense completely—**no waiting for tablets to dissolve.**
- Printed-color standards, sealed in plastic for protection against water, chemicals, and scratches, provide **reliable color matches.**
- **Waterproof instructions** are printed on plastic-impregnated paper that resists fading and tearing.
- Custom-molded, durable plastic cases provide **safe storage** for all tests. Complete and Service Complete cases will now hold up to seven additional bottles.
- **Proven chemistries** are based on *Standard Methods for the Examination of Water and Wastewater*, APHA, Washington, DC, and/or *American Society for Testing and Materials*, ASTM, Philadelphia, PA. Some methods use proprietary chemistry developed by Taylor Technologies.

ALSO AVAILABLE

- **Deox Reagent** add-on to eliminate interference in DPD and FAS-DPD chlorine tests from monopersulfate oxidizing shock treatments in the water; K-2041 (.75 oz.) or K-2042 (2 oz.).
- **FAS-DPD** drop test add-on: the K-1515 measures both free and combined chlorine at increments as low as 0.2 ppm; the K-1517 measures total bromine as low as 0.5 ppm.
- **SampleSizer**® measurement tools to speed up testing (#6190 for alkalinity and hardness; #6191 for pH).
- **SpeedStir**® magnetic stirrer for any drop test performed in the #9198 sample tube instead of the comparator block. Both fit in a Service Complete case.
- A wide array of single- and multiparameter kits featuring color-matching and/or drop-count tests.
- Taylor's **TTI**® **Colorimeter** (M-2000); test more than a dozen parameters commonly encountered in pool/spa settings and transfer results to a PC database.
- Testing supplies and kit replacement parts (e.g., burets, flasks, test tubes, and test cells).
- **Video demonstrations** for new users posted on our website.
- Toll-free technical assistance at **800-TEST KIT.**

REPRESENTATIVE TEST PROCEDURE

Reproduced from
K-2006C instruction:

Guidebook (#2004B) amplifies these instructions and should be read to use this product properly.		POOL & SPA WATER TESTS		6. Rinse tubes before and after each test. Instr. #5140	
Free & Combined Chlorine Test 1. Rinse and fill large comparator tube to desired mark with water to be tested. NOTE: For 1 drop = 0.2 ppm, use 25 mL sample. For 1 drop = 0.5 ppm, use 10 mL sample. 2. Add 2 dippers R-0870. Swirl until dissolved. If free chlorine is present, sample will turn pink. NOTE: If pink color disappears, add R-0870 until color turns pink. 3. Add R-0871 dropwise, swirling and counting after each drop, until color changes from pink to colorless. 4. Multiply drops in Step 3 by drop equivalence (Step 1). Record as parts per million (ppm) free chlorine (FC). 5. Add 5 drops R-0003. Swirl to mix. If combined chlorine is present, sample will turn pink. 6. Add R-0871 dropwise, swirling and counting after each drop, until color changes from pink to colorless. 7. Multiply drops in Step 6 by drop equivalence (Step 1). Record as ppm combined chlorine (CC).	Free Chlorine Test 1. Rinse and fill large comparator tube to 44 mL mark with water to be tested. 2. Add 5 drops R-0004. Cap and invert to mix. 3. Match color with color standard. Record as pH units and save sample if pH needs adjustment. If sample color is between two values, pH is average of the two. To LOWER pH: See acid demand test. To RAISE pH: See base demand test.	Total Alkalinity Test 1. Rinse and fill large comparator tube to 25 mL mark with water to be tested.* 2. Add 2 drops R-0007. Swirl to mix. 3. Add 5 drops R-0008. Swirl to mix. Sample should turn green. 4. Add R-0009 dropwise. After each drop, count and swirl to mix until color changes from green to red. 5. Multiply drops in Step 4 by 10. Record as parts per million (ppm) total alkalinity as calcium carbonate. *When high TA is anticipated, this procedure may be used: Use 10 mL sample, 1 drop R-0007, 3 drops R-0008, and multiply drops in Step 4 by 25.	Calcium Hardness Test 1. Rinse and fill large comparator tube to 25 mL mark with water to be tested.* 2. Add 20 drops R-0010 (or use pipet provided and fill to 1 mL mark). Swirl to mix. 3. Add 5 drops R-0011L. Swirl to mix. If calcium hardness is present, sample will turn red. 4. Add R-0012 dropwise. After each drop, count and swirl to mix until color changes from red to blue. 5. Multiply drops in Step 4 by 10. Record as parts per million (ppm) calcium hardness as calcium carbonate. *When high CH is anticipated, this procedure may be used: Use 10 mL sample, 10 drops R-0010 (or use pipet provided and fill to 0.5 mL mark), 3 drops R-0011L, and multiply drops in Step 4 by 25.	Cyanuric Acid Test 1. Rinse and fill CYA dispensing bottle (#9191) to 7 mL mark with water to be tested. 2. Add R-0013 to 14 mL mark. Cap and mix for 30 seconds. 3. Slowly transfer clearly solution to small comparator tube until black dot on bottom just disappears when viewed from top. 4. Read tube at liquid level on back of comparator block. Record reading as parts per million (ppm) cyanuric acid.	Sodium Chloride (Salt) Test For 1 drop = 200 ppm 1. Rinse and fill sample tube (#9198) to 10 mL mark with water to be tested. 2. Add 1 drop R-0830. Swirl to mix. Sample should turn yellow. 3. Add R-0718 dropwise, swirling and counting after each drop, until color changes from yellow to a milky salmon (brick) red. Always hold bottle in vertical position. NOTE: Do not add enough R-0718 to give a brown color. First change from yellow to a milky salmon (brick) red is the endpoint. 4. Multiply drops of R-0718 by 200. Record as parts per million (ppm) salt as sodium chloride.

Only Service Complete kits have pipet option.



rev. 050415



INNOVATIONS IN POOL AND SPA LIGHTING

At day's end, let the magic begin with
the world's leader in underwater lighting

MAKE WATER COME ALIVE WITH ENERGY-EFFICIENT, UNDERWATER POOL AND SPA LIGHTING

Pentair underwater lighting continues to set new standards in energy efficiency, reliability and performance. We offer the most energy-efficient LED lighting technology available, as well as traditional incandescent and halogen options to add brilliance, mood and relaxation to any nighttime underwater environment.

INTELLIBRITE® 5G UNDERWATER COLOR-CHANGING LED POOL AND SPA LIGHTS

IntelliBrite Underwater 5g Color-Changing Pool and Spa Lights feature LED technology for the best in energy efficiency, lifetime value and quality of light. The IntelliBrite 5g light mixes and matches individual LED colors to achieve a vibrant spectrum of color* that can cycle at varying speeds and in different color sequences. Combined with a custom reflector and innovative lens design, the IntelliBrite 5g light is the most energy-efficient underwater LED light available.

- Custom reflector and superior lens geometry eliminate “hot spots” and improve color effects.

- Compatible with IntelliTouch® or EasyTouch® Control Systems for centralized, fully automated control.
- Outstanding energy efficiency—consuming only 26 watts for pool lights and 18 watts for spa lights.
- UL Listed when installed in Pentair niches.

IntelliBrite 5g Underwater White LED Pool Lights deliver pure, white light the most efficient way.

- Pure, white light uses 89% less energy than incandescent lights.

- Superior light intensity and distribution—no hot spots or glare.
- Long-lasting durability.
- The most efficient lighting technology available—an Eco Select® brand product.



Products aligned with the Eco Select brand are the most environmentally responsible choices within the Pentair product family.

IntelliBrite Standard Light Shows



SAm® Mode:
Cycles through the color spectrum of the SAm light



Party Mode:
Rapid color changing builds energy and excitement



Romance Mode:
Slow transition for a mesmerizing and calming routine



California Sunset Mode:
Dramatic transitions of orange, red and magenta tones



American Mode:
Patriotic red, white and blue transitions



Caribbean Mode:
Transitions between a variety of blues and greens



Royal Mode:
Cycle that selects only rich, deep tones of color

Fixed Color Choices



Blue



Magenta



Green



White



Red

*Light intensity and light color may vary from pool to pool depending upon a number of factors, including, but not limited to, light location, plaster color, pool depth/shape/geometry, overall lighting, etc.



IntelliBrite 5g Pool and Spa Lights



Amerlite Incandescent Light and Lens Covers



AmerBrite LED Replacement Lamp for Amerlite Housing

AMERLITE® INCANDESCENT LIGHTS

The world standard of reliability for underwater pool and spa lighting for decades, Amerlite systems light more than 3 million pools around the world.

- 8-1/8" prismatic tempered glass lenses for optimum light diffusion.
- Create different moods with optional snap-on lens covers in blue, red, green and amber.
- Heat-sensing cutoff for low water protection.
- Optional plastic snap-on face rings let you coordinate with your pool's finish.
- Allow bulb changes without lowering your water level.
- UL Listed when installed in Pentair niches.

AMERBRITE® LED REPLACEMENT LAMP FOR THE AMERLITE LIGHT SERIES

Bring the luminous splendor of LED technology to the best-selling Amerlite light series without the hassle and cost of replacing your existing Amerlite light fixture. Your installer can simply unscrew your inefficient, high-wattage incandescent bulb and screw in a high-efficiency AmerBrite LED lamp. You'll experience the efficiency of today's best pool lighting technology and watch your pool transform into a rejuvenating spectrum of breathtaking color or vibrant white light.

- The most efficient LED replacement pool lamp on the market.
- AmerBrite color lamps use 36 watts of power, while white lamps use between 34–51 watts.
- Color lamps feature five brilliant, fixed colors and seven dazzling, preprogrammed light shows.
- Superior reflector design creates more uniform light distribution.
- Adjustable to provide wide or narrow beam pattern.
- Solid-state LED technology provides longer life.



AQUALIGHT® HALOGEN LIGHTS AND SPABRITE® INCANDESCENT LIGHTS

These compact units are designed to provide big lighting performance for smaller pools and spas. No matter which light you choose, your pool or spa will shine brilliantly when the sun goes down.

- Prismatic tempered glass lens for optimum light diffusion.
- Heat-sensing cutoff for low water protection.

- Stainless-steel clamp for quick and easy bulb replacement.
- Plastic snap-on face rings available to coordinate with your pool's finish.
- Optional blue, magenta, green, purple and blue-green, mood-setting, snap-on lenses.
- SpaBrite lights available in 120V halogen and 12V incandescent options.
- UL Listed when installed in Pentair niches.



AQUALUMIN® III NICHELESS LIGHT

The AquaLumin III Nicheless Light is the third generation of the industry's first and only nicheless light for swimming pools, offering luminous, double-contact halogen quartz lighting. With its revolutionary and innovative design, the AquaLumin III light mounts directly on the pool wall for simple installation in vinyl pools. Plus, it's the perfect choice for adding nighttime brilliance to new or existing pools.

LIGHT SELECTION GUIDE

	White LED Light		Incandescent Light		Halogen Light		
	IntelliBrite 5g	IntelliBrite 5g Spa	Amerlite	SpaBrite	AquaLight	AquaLumin III	SpaBrite
Size of Light	Large	Small	Large	Small	Small	Small	Small
120V Wattage	55W (equivalent to 500W)	18W	300W 400W 500W	N/A	100W 250W	250W	60W
12V Wattage	55W (equivalent to 500W)	18W	100W 300W	100W	75W	100W	N/A

