

ROOM FINISH SCHEDULE

ROOM	NAME	FLOOR	BASE	WALLS				CEILING	CLG. HT.	REMARKS
				North	South	East	West			
100	CUSTOMER LINE	FLOOR TILE #4	COVERED CERAMIC TILE BASE	#3	#3	#3	#3	OPEN TO STRUCT.	OPEN TO STRUCT.	
101	CUSTOMER SEATING AREA	FLOOR TILE #4	COVERED CERAMIC TILE BASE	#3	#3	#3	#3	OPEN TO STRUCT.	OPEN TO STRUCT.	
102	BAR AREA	CERAMIC TILE #5	CERAMIC TILE BASE	CERAMIC TILE #5	CERAMIC TILE #5	CERAMIC TILE #5	CERAMIC TILE #5	WVNT CEILING TILE	10'-0" AFF.	
103	EMPLOYEE AREA	CERAMIC TILE #5	CERAMIC TILE BASE	F.R.P.	F.R.P.	F.R.P.	F.R.P.	WVNT CEILING TILE	10'-0" AFF.	
104	STORAGE AREA	CERAMIC TILE #5	CERAMIC TILE BASE	F.R.P.	F.R.P.	F.R.P.	F.R.P.	WVNT CEILING TILE	10'-0" AFF.	
105	OFFICE	CERAMIC TILE #5	CERAMIC TILE BASE	#3	#3	#3	#3	ACoustICAL TILE	10'-0" AFF.	
106	RESTROOMS	CERAMIC TILE #5	CERAMIC TILE BASE	CERAMIC TILE #5	CERAMIC TILE #5	CERAMIC TILE #5	CERAMIC TILE #5	ACoustICAL TILE	10'-0" AFF.	
200	HALLWAY	FLOOR TILE #4	COVERED CERAMIC TILE BASE	#3	#3	#3	#3	ACoustICAL TILE	10'-0" AFF.	
201	GAMEROOM/PARTY ROOM	FLOOR TILE #4	COVERED CERAMIC TILE BASE	#3	#3	#3	#3	OPEN TO STRUCT.	OPEN TO STRUCT.	

FINISH SCHEDULE / G.C. REQUIREMENTS:

- G.C. TO INSTALL D-BOARD AS REQUIRED BY WINGS-PIZZA-N-THINGS.
- G.C. TO PROVIDE CONT. WOOD TRIM SPANNING THE ENTIRE RESTAURANT APPROXIMATELY 4 FEET FROM THE FLOOR. THE SPAN SHALL BE FROM THE DOOR THRESHOLD TO THE TRIMMERS TEAKY AMERICAN (12 COATS) OR BLACK WALNUT (1 COAT).
- G.C. TO PAINT WALLS IN PREMIUM BEHR 'BUFFED' AND THE CEILING IS TO BE PAINTED PREMIUM BEHR 'CONNABAR'.
- G.C. TO PROVIDE AND INSTALL FLOOR TILE THROUGHOUT THE RESTAURANT PER WINGS-PIZZA-N-THINGS ORIGINAL VERDESTEAN A356299 OR CRYNTEL ITEM #185389, MODEL #00812-B.
- G.C. TO INSTALL CERAMIC TILE AND F.R.P. IN KITCHEN AND RESTROOM PER WINGS-PIZZA-N-THINGS.

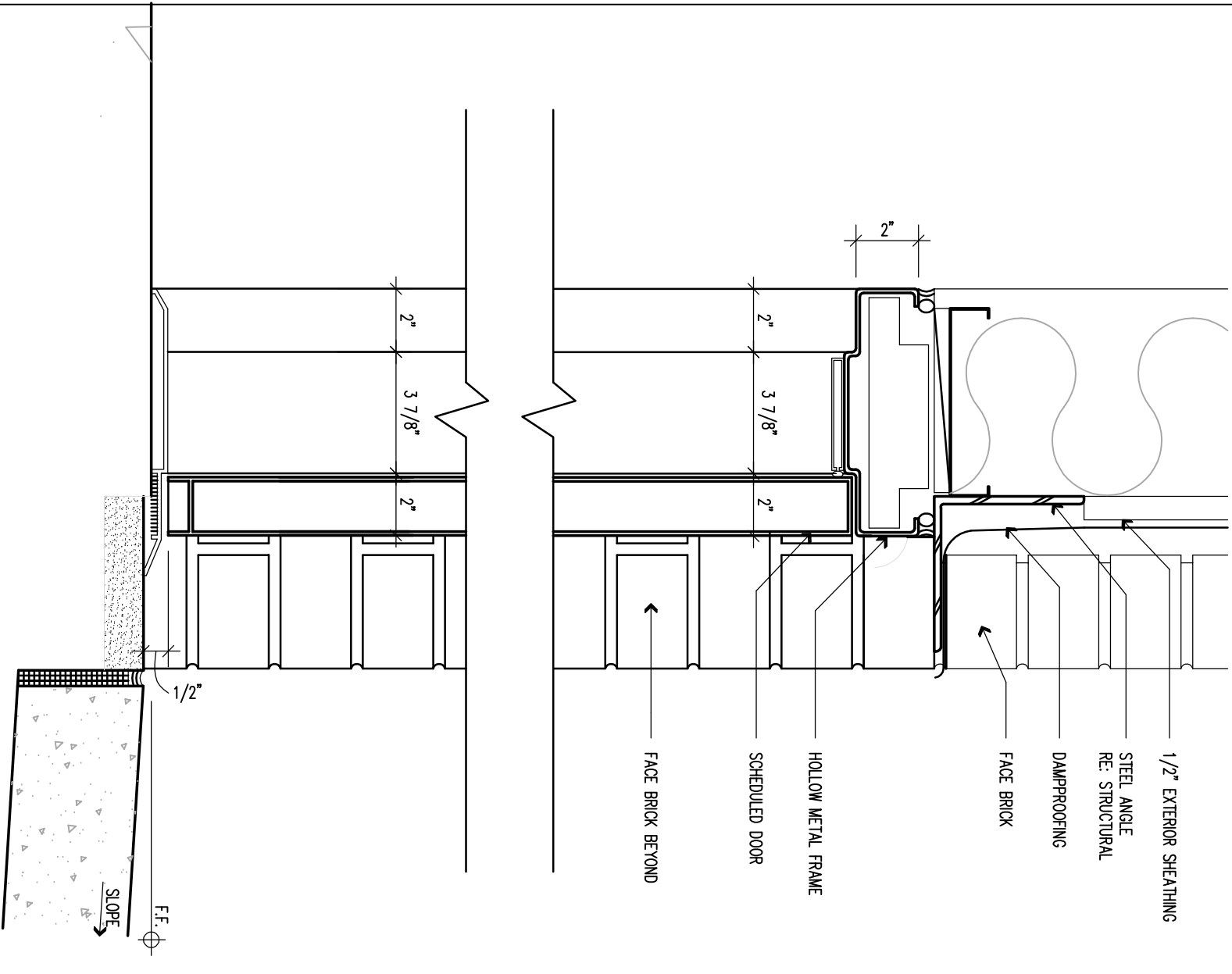

EXTERIOR EXIT DOOR SECTION

ROOM FINISH SPECIFICATIONS

ROOM FINISH SCHEDULE

3

MARK	LOCATION	SIZE	TYPE	DOOR MATERIAL	DOOR FINISH	FRAME MATERIAL	FRAME FINISH	HWFR. SET	REMARKS
1-2	EXISTING ENTRY/EXIT DOOR	3'-0" x 7'-0" (V.I.F.)	EXIST.	EXIST.	EXIST.	EXIST.	EXIST.	EXIST.	EXISTING DOORS TO BE SELF CLOSING. DOORS AND HARDWARE ARE EXISTING - ADD SIGNAL TO DOOR #1 STAINING THIS DOOR TO REMAIN UNLOCKED WHEN BUILDING IS OCCUPIED PER BIC SECTION 1008.18.3.
3	NEW EXIT DOOR	3'-0" x 7'-0" (V.I.F.)	B	HOLLOW METAL	PAINT	METAL	PAINT	#3	SELF CLOSING DOOR
4-5	RESTROOM	3'-0" x 7'-0" x 1 1/2"	A	HOLLOW METAL	PAINT	METAL	PAINT	#2	SELF CLOSING DOOR
6	OFFICE	3'-0" x 7'-0" x 1 1/2"	A	HOLLOW METAL	PAINT	METAL	PAINT	#2	SELF CLOSING DOOR
7	STORAGE	3'-0" x 7'-0" x 1 1/2"	A	HOLLOW METAL	PAINT	METAL	PAINT	#2	SELF CLOSING DOOR
8	DOUBLE ACTING DOOR	3'-0" x 7'-0" x 1 1/2"	C	HOLLOW METAL	PAINT	METAL	PAINT	#1	SELF CLOSING DOUBLE ACTING DOOR

NOTE: G.C. TO FIELD VERIFY SIZE OF DOOR ROUGH OPENINGS AND DOOR SIZES BEFORE FABRICATION

DOOR SCHEDULE

2

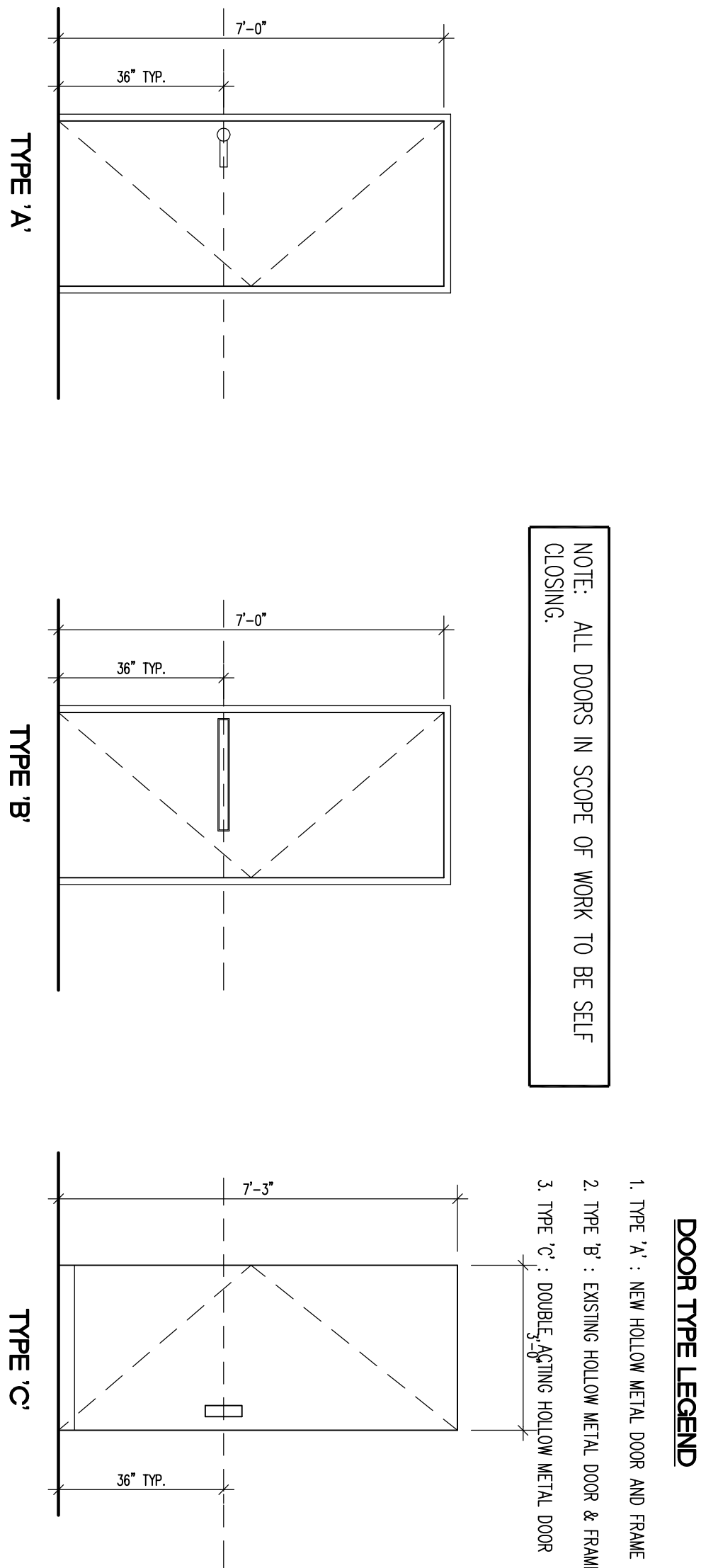

NOTE: ALL DOORS IN SCOPE OF WORK TO BE SELF CLOSING.

DOOR TYPE LEGEND

- TYPE 'A': NEW HOLLOW METAL DOOR AND FRAME
- TYPE 'B': EXISTING HOLLOW METAL DOOR & FRAME
- TYPE 'C': DOUBLE ACTING HOLLOW METAL DOOR

NOTE:
CONTRACTOR ASSUMES ALL RESPONSIBILITY TO CONFIRM AND FIELD VERIFY THAT ALL STRUCTURAL, PLUMBING, ELECTRICAL, AND MECHANICAL DESIGNS IN THIS SET OF DWGS. MEET ALL REQUIREMENTS PER EXISTING SITE CONDITIONS, LOCAL BUILDING CODES, DEED RESTRICTIONS, AND OWNER SPECIFICATIONS PRIOR TO SUBMITTING FINAL PRICING.

DOOR TYPES

HARDWARE SCHEDULE

1

SET	PART	Q	MANUFACTURER	MODEL #	FINISH	REMARKS
1	TOP PIVOT HINGE	1	RYSON	28 X 564 CENTERHANG		SELF CLOSING DOUBLE ACTING HINGE
	BOTTOM PIVOT HINGE	1	RYSON	H540 CENTERHANG		SELF CLOSING DOUBLE ACTING HINGE
	FLOOR STOP	2	MES	F5408		VERIFY LOCATION W/ ARCHITECT
2	KICK PLATE	1	TBD	TBD		1/2" X 2' X 10' PUSH PLATE MTD. * 36" AFF. ON BOTH SIDES OF DOOR
	HINGE	3	MES	55B1-HW 4 1/2" X 4 1/2"		
	SILENCERS	3	ROCKWOOD	608		
3	FIRE RATED EXIT DENCE	1	VON DUPRE	991-F799RL		DOOR TO BE SELF CLOSING
	RAM CYLINDER	1	VON DUPRE	20-012		
	WALL STOP	1	NORTON	P5501 x 5N8		DOOR TO BE SELF CLOSING
4	WALL STOP	1	MES	WS402		
	KICK PLATE	2	MES	8400		
	KICK PLATE	2	MES	8400		