

XBDW Type 1, Baffle Filter Double Wall - Exhaust Only Wall Canopy

Model	Hood Length (in.)	Width (in.)	Bottom Width (in.)	Height (in.)		Exhaust Volume (CFM)	Exhaust SP (in. w.g.)	Double Island
				Front	Back			
XBDW	336	54	54	24	24	7700	0.477	No

Selected Options & Accessories:

Option or Accessory	Description
Mounting Height	80 in. off Finished Floor.
Double Shell Front	Listed for Zero Clearance to Combustibles.
Integral Air Space	Factory Mounted on Back - 3" wide
Ceiling Enclosures	18 in. High on Left Front Right
Filter Type	Stainless Steel Baffle Filters
Backsplash Panel	80 in High 336 in Long 0 in Wide
Continuous Capture	UL listed connection to join multiple sections.

Material: 430 SS Where Exposed
UL Listing: UL 710 w/out Exhaust Fire Damper

Features:
 Performance Enhancing Lip (PEL)
 Standing Seam Construction for Superior Strength
 Stainless Steel Finish for Higher Corrosion Resistance

Hood End Conditions:
 Back Wall - Limited Combustible

Section Data:

Section Num.	Length (in.)	Volume (CFM)	SP (in. wg)	Filter Qty		Filter Ht. (in.)	Temp. Rating	Light Qty	Light Type	Foot Candles	Drain Location	Weight (lbs)
				16" W	20" W							
1	168	3850	0.477	8	2	20	600 deg F	6	Incandescent / CFL	48.36	Left	616
2	168	3850	0.477	8	2	20	600 deg F	6	Incandescent / CFL	48.36	Right	616

Exhaust Collar Data:

Section Num.	Collar Num.	Collar Size (LxW) in. or Diameter (in.)	Pos. Off Left (in.)	Pos Off Back (in.)	Velocity (fpm)	Mounting Option
1	1	36 x 10	84	7	1540	Shipped Loose Exhaust Collar(s)
2	1	36 x 10	84	7	1540	Shipped Loose Exhaust Collar(s)

External Supply Plenum Data:

Supply: 7140 CFM

MUA: 5320 CFM

AC: 1820 CFM

Section Num.	Plenum Num.	Side	Type	Length (in.)	Width (in.)	Height (in.)	Volume (CFM)	SP (in. wg)	Insulated
1	1	Front	Split Air Curtain Supply (ASP) - MUA	168	14	10	2660	0.163	No
1	1	Front	Split Air Curtain Supply (ASP) - AC	168	10	10	910	0.009	Yes
2	1	Front	Split Air Curtain Supply (ASP) - MUA	168	14	10	2660	0.163	No
2	1	Front	Split Air Curtain Supply (ASP) - AC	168	10	10	910	0.009	Yes

External Supply Collar Data:

Section Num.	Plenum Num.	Side	Collar Num.	Collar Size (LxW) in. or Diameter (in.)	Pos. Off Left (in.)	Pos. Off Front (in.)	Velocity (fpm)	Mounting Option
1	1	Front	1	40 x 10	42	7	479	Factory Mounted Supply Collar(s)
1	1	Front	2	40 x 10	126	7	479	Factory Mounted Supply Collar(s)
1	1	Front	1		8	21	653	Factory Mounted Supply Collar(s)
1	1	Front	2		8	63	653	Factory Mounted Supply Collar(s)
1	1	Front	3		8	105	653	Factory Mounted Supply Collar(s)
1	1	Front	4		8	147	653	Factory Mounted Supply Collar(s)
2	1	Front	1	40 x 10	42	7	479	Factory Mounted Supply Collar(s)
2	1	Front	2	40 x 10	126	7	479	Factory Mounted Supply Collar(s)
2	1	Front	1		8	21	653	Factory Mounted Supply Collar(s)
2	1	Front	2		8	63	653	Factory Mounted Supply Collar(s)
2	1	Front	3		8	105	653	Factory Mounted Supply Collar(s)
2	1	Front	4		8	147	653	Factory Mounted Supply Collar(s)

Hanger Bracket Locations			
Sec #	Brkt #	Distance Off Left (in)	Distance Off Front (in)
1	1	3.50	2.50
1	2	55.94	2.50
1	3	111.89	2.50
1	4	164.50	2.50
1	5	3.50	50.00
1	6	55.94	50.00
1	7	111.89	50.00
1	8	164.50	50.00
2	1	3.50	2.50
2	2	55.94	2.50
2	3	111.89	2.50
2	4	164.50	2.50
2	5	3.50	50.00
2	6	55.94	50.00
2	7	111.89	50.00
2	8	164.50	50.00
Bracket Mounting Position for an 8 Bracket Hood			

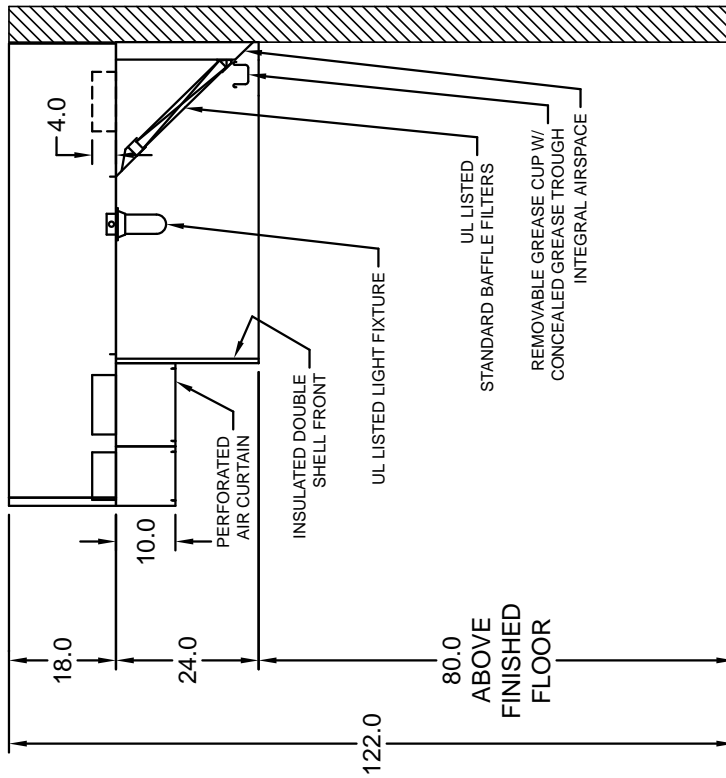
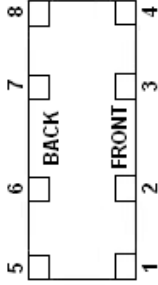

MARK: H-1 (LAST HOOD IN ROW)

NOTE: All dimensions are in units of in.



Model: XRUB-200-20

Belt Drive Upblast Centrifugal Roof Exhaust Fan

Dimensional	
Quantity	1
Weight w/o Acc's (lb)	124
Weight w/ Acc's (lb)	142
Max T Motor Frame Size	184
Roof Opening (in.)	20.5 x 20.5

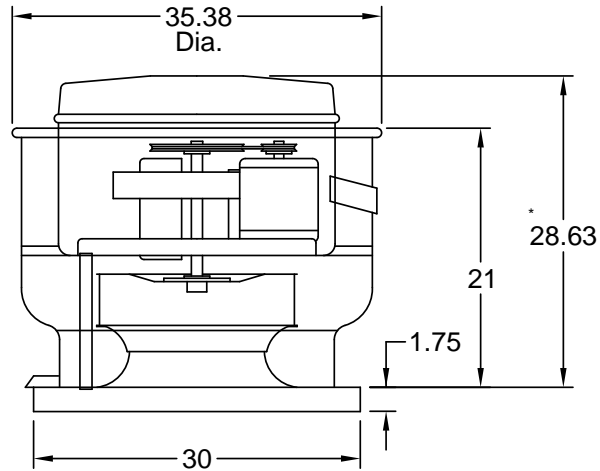

Reference assembly view drawings for actual dimensions with mounted accessories

Performance	
Requested Volume (CFM)	3,850
Actual Volume (CFM)	3,850
External SP (in. wg)	1.1
Total SP (in. wg)	1.1
Fan RPM	1052
Operating Power (hp)	1.43
Elevation (ft)	20
Airstream Temp.(F)	70
Air Density (ft3)	0.075
Drive Loss (%)	5.4
Tip Speed (ft/min)	5,885
Static Eff. (%)	49

Motor	
Motor Mounted	Yes
Size (hp)	2
V/C/P	208/60/3
Enclosure	ODP
Motor RPM	1725
Windings	1
NEC FLA* (Amps)	7.5

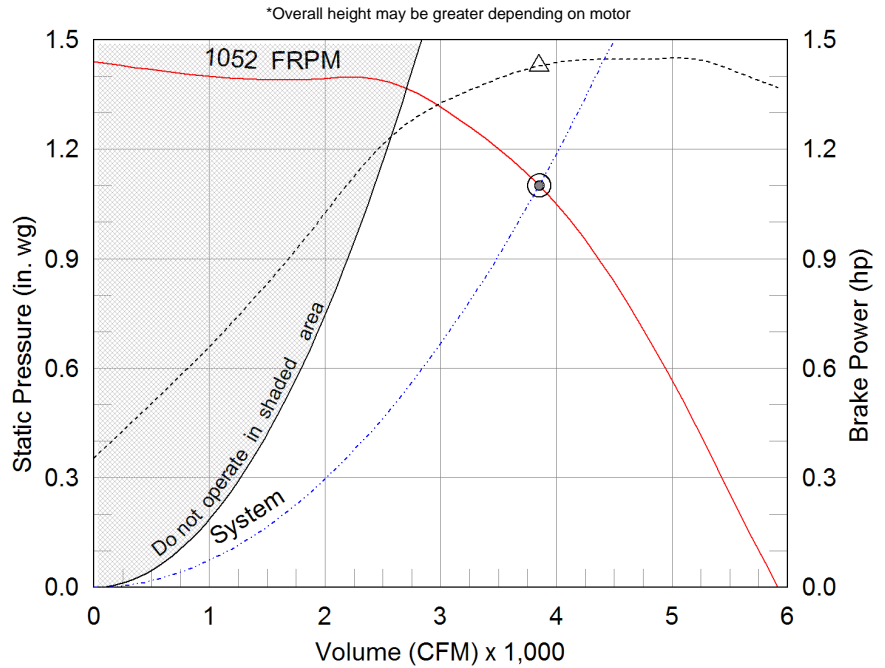

- △ Operating Bhp point
- Operating point at Total SP
- Operating point at External SP
- Fan curve
- - - System curve
- - - Brake horsepower curve

Sound Power by Octave Band

Sound Data	62.5	125	250	500	1000	2000	4000	8000	LwA	dBA	Sones
Inlet	77	81	86	75	68	68	65	60	80	69	17.3

Notes:

All dimensions shown are in units of in.
 *FLA - based on tables 150 or 148 of National Electrical Code 2002. Actual motor FLA may vary, for sizing thermal overload, consult factory.
 LwA - A weighted sound power level, based on ANSI S1.4
 dBA - A weighted sound pressure level, based on 11.5 dB attenuation per Octave band at 5 ft - dBA levels are not licensed by AMCA International
 Sones - calculated using AMCA 301 at 5 ft



Model: XRUB-200-20

Belt Drive Upblast Centrifugal Roof Exhaust Fan

Standard Construction Features:

- Aluminum housing - Backward inclined aluminum wheel - Curb cap with prepunched mounting holes - Motor and drives isolated on shock mounts - Drain trough - Ball bearing motors - Adjustable motor pulley - Adjustable motor plate - Fan shaft mounted in ball bearing pillow blocks - Bearings meet or exceed temperature rating of fan - Static resistant belts - Corrosion resistant fasteners - Internal lifting lugs

Options & Accessories:

UL/cUL 762 Listed - "Power Ventilators for Rest. Exh. Appliances"
Switch, NEMA-3R, Toggle, Junction Box Mounted & Wired
Hinged Base (Attached)
Curb Seal (Attached)
Grease Trap (PN 475538)
Heat Baffle (Attached)
Bearings with Grease Fittings, L10 life of 100,000 hrs (L50 avg. life 500,000 hrs)
Unit Warranty: 1 Yr (Standard)

XKSFB-118-H25-01

CONSTRUCTION FEATURES AND ACCESSORIES

Unit Overview

Model	Airflow (CFM)	Heating	Cooling	Electrical V/C/P
XKSFB-118-H25-01	5,400	No Heat	No Cooling	208/60/3

Features

- Exterior housing constructed of galvanized steel
- Removable access panels
- Painted or galvanized steel blower and bearing supports
- Forward curved steel blower and motor
- Fan assembly is mounted on vibration isolators
- Motor pulleys are adjustable through 15 hp and fixed for 20 hp and greater
- Fan shaft is mounted in permanently lubricated ball bearings (up through size 118) or ball bearing pillow blocks (size 120 and greater)
- Static free belts
- Corrosion resistant fasteners are standard
- Disconnect mounted by factory

Options and Accessories

- Air Flow Arrangement: Outdoor Air Only
- Weatherhood: Aluminum Mesh
- Outdoor Air Intake Position: End
- Discharge Position: Horizontal
- Coating: Galvanized
- Insulation: None
- Access Side: Right-Hand
- Mounting: By Others
- Unit Warranty: 1 Yr (Standard)



-

NOTES:

XKSFB-118-H25-01 PERFORMANCE AND SPECIFICATIONS

Description/Arrangement

Model	Qty	Unit Weight (lb)	Discharge Position	Air Flow Arrangement	Unit Arrangement
XKSFB-118-H25-01	1	366	Horizontal	Outdoor Air Only	Horizontal

Design Conditions

Elevation (ft)	Summer DB (F)	Summer WB (F)	Winter DB (F)
20	94	81	32

Air Performance

Type	Volume (CFM)	External SP (in. wg)	Total SP (in. wg)	RPM	Operating Power (hp)	Motor Size (hp)
Supply	5,400	0.6	0.721	563	1.45	2

Electrical/Motor Specifications

V/C/P	Unit MCA (amps)	Unit MOP (amps)	Enclosure	Supply Motor RPM	Supply Efficiency
208/60/3	9.4	15	ODP	1725	Premium

Sound Performance in Accordance with AMCA

Fan	Sound Power by Octave Band								Lwa	dBA	Sones
	62.5	125	250	500	1000	2000	4000	8000			
Supply	86	76	74	73	68	66	61	55	75	64	11.8

Unit Pressure Drop (in. wg)

Air Stream	Weatherhood	Damper Section	Filter Section	Cooling Section	Heating Section
Supply	0.121	0	0	0	0

XKSFB-118-H25-01 FAN CURVES

Supply Fan Performance

Volume (CFM)	Supply SP (in wg)	Total SP (in wg)	RPM	Operating Power (hp)	Motor Size (hp)	Fan Quantity
5400	0.6	0.721	563	1.45	2	1

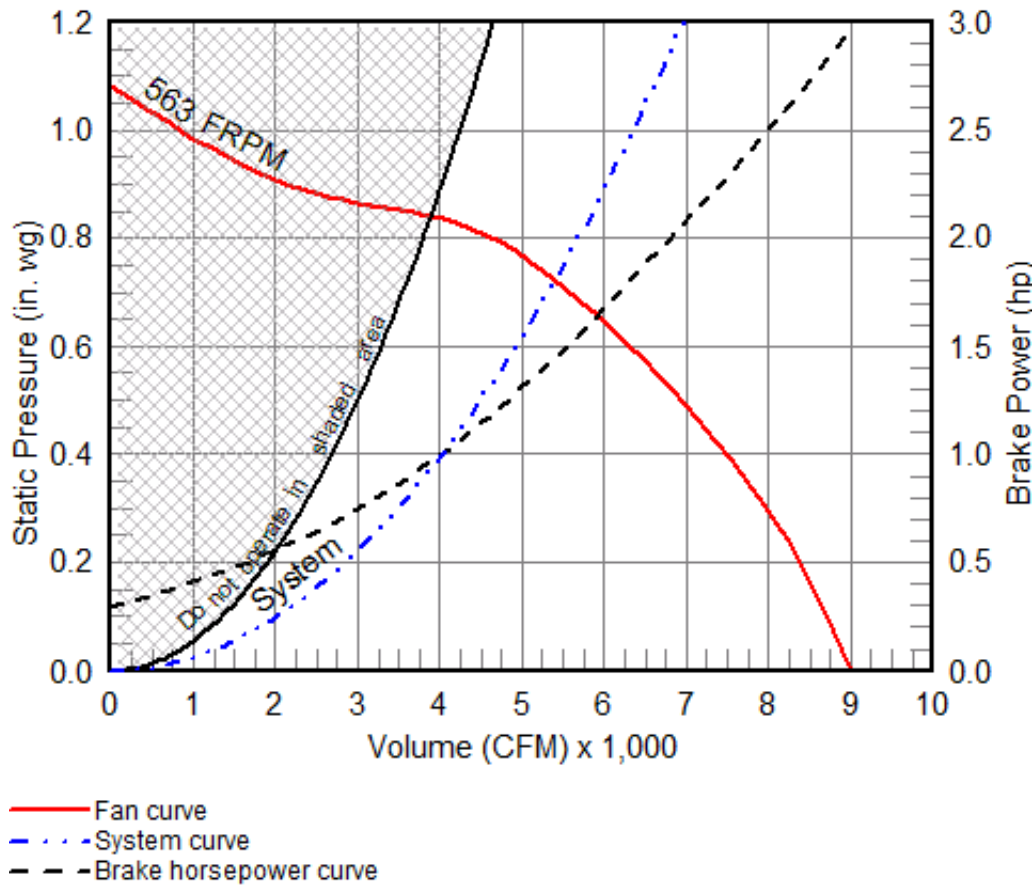

XKSFB-118-H25-01

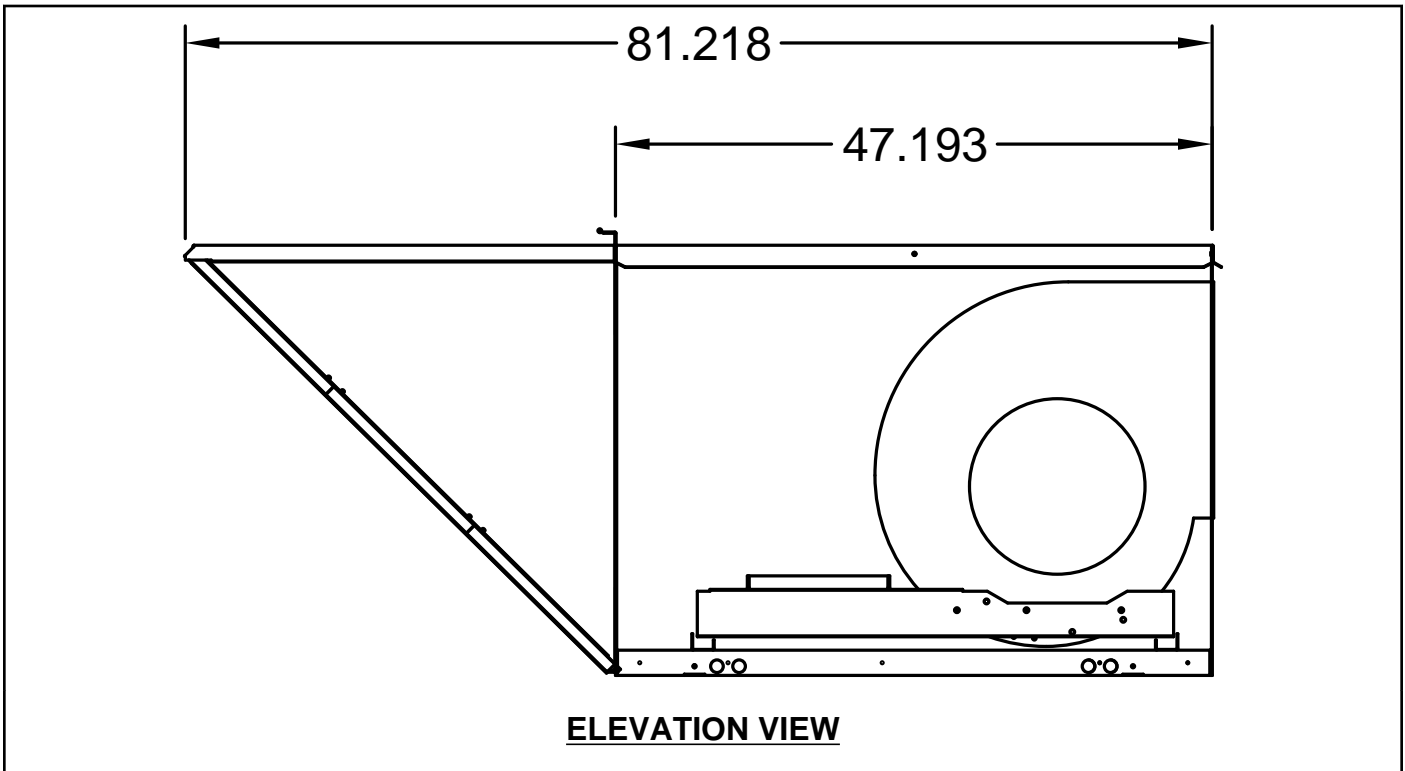

* Standard configuration for unit access is on the right-hand side, when looking into the unit intake in the direction of airflow.

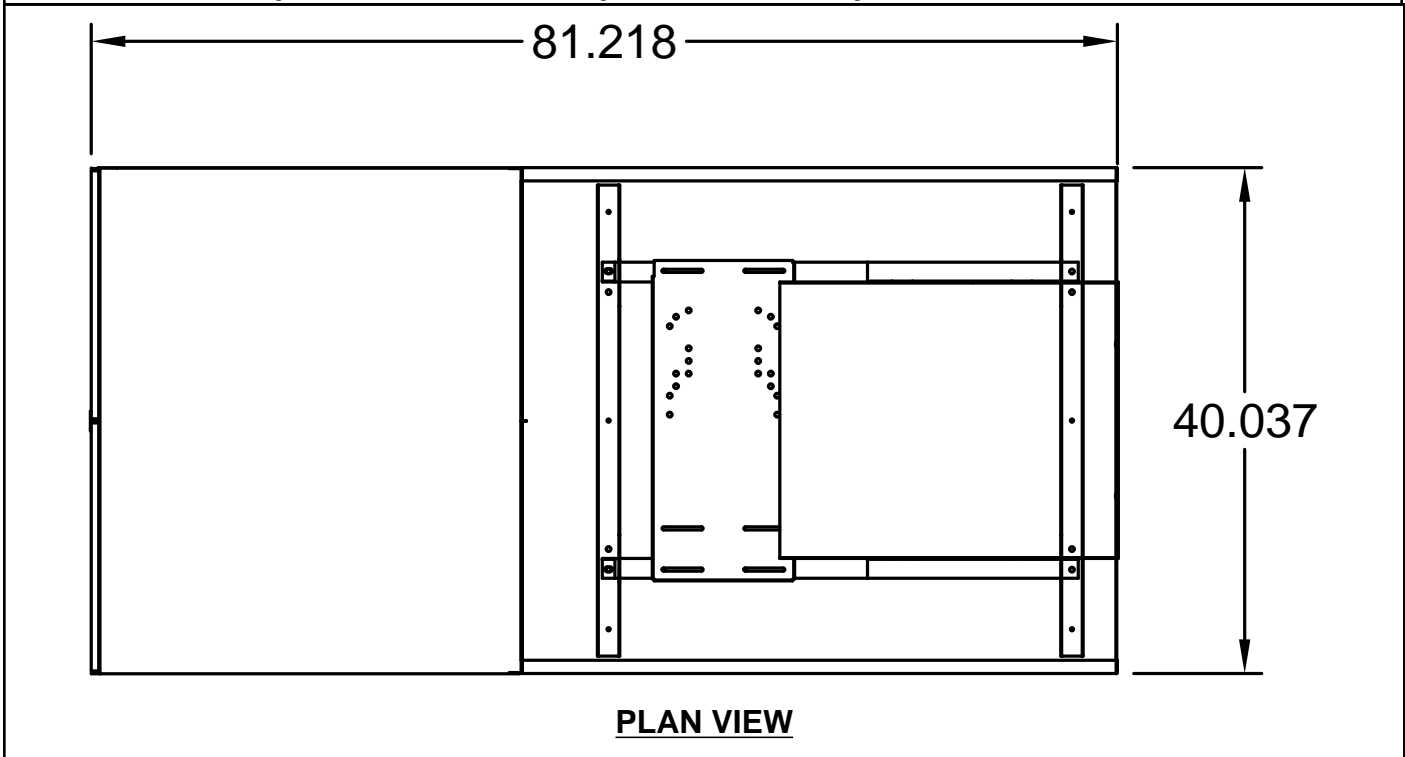

* Standard configuration for unit access is on the right-hand side, when looking into the unit intake in the direction of airflow.

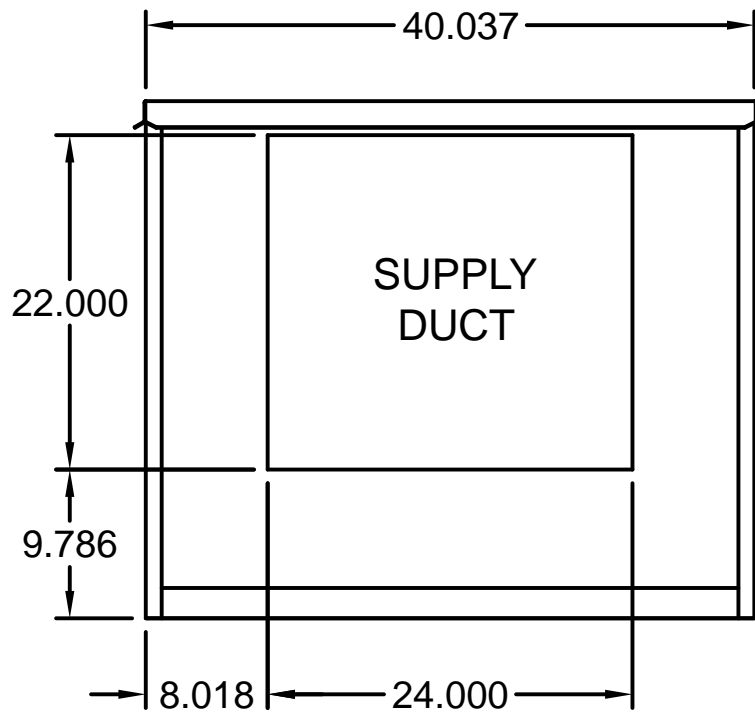

END VIEW

*NOTE: Roof openings can be as large as the curb size -3.5 in. or as small as the duct size + .5 in.

Solid lines indicate the actual curb perimeter.
Dashed lines represent the unit position relative to curb. All dimensions shown are for the curb only.

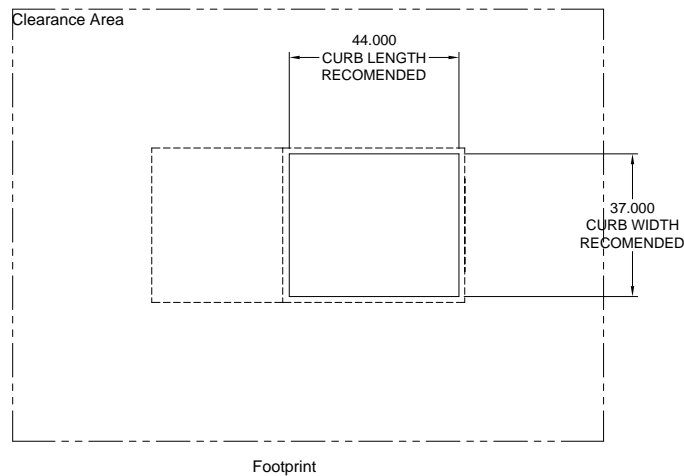

FOOTPRINT VIEW

XFCC-1

Kitchen Fan Control Center (XFCC)

Standard Construction Features:

UL Listed to Standard 891
 12 x 18 x 6 Stainless Steel Enclosure
 Fan Starters (Contactor or Contactor and Overload) - 3 Starters Provided
 Prewired with Wiring Diagram

Options & Accessories:

Mounting Option	Ship Loose
Exhaust Fan Quantity	2
Supply Fan Quantity	1
Light Switch	1 - 2 Position Light Switch
Fan Switch	1 - 2 Position Fan Switch
Switch Mounting Location	Face Mount Right Side of Hood - H-1 Section 2
Turn On Exhaust In Fire	Exhaust fans will run when in fire mode.
Thermal Overloads In Cabinet	Thermal overloads are provided in cabinet for motors.
Power For Shunt Trip	120 volt power to shunt trip breaker activates when in fire mode.

Controlled Fans:

Fan Mark	Fan Type	Supplied By	Phase	HP	Voltage	Speed	RPM	Thermal Overload	NEC FLA	Redundant Starter
Ef-1	Exhaust	Manufacturer	3	2	208	1	1725	No	7.500	No
EF-2	Exhaust	Manufacturer	3	2	208	1	1725	No	7.500	No
Sf-1	Supply	Manufacturer	3	2	208	1	1725	No	7.500	No

Kitchen Fan Control Center (XFCC)
 Electrical Rewire Package
 Reed 28

PART NO. 110-2B-321 REV. 2-2.2
 CAD DRAWING NO. 000

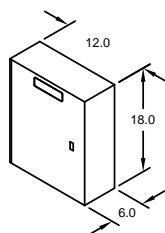
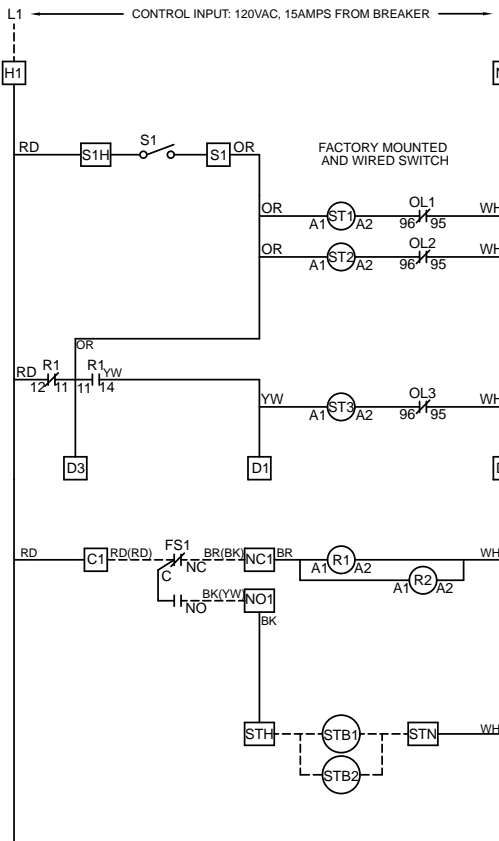

CONTROL PANEL
 Installation Location:
 Ship Loose

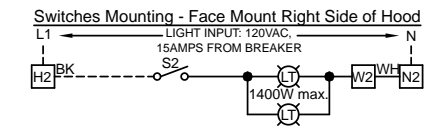
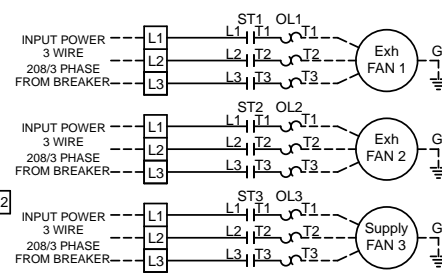

Panel Mark: Elec

Hood Mark(s):

Motor	Fan Mark	HP	Volt	PH	FLA	Wire	Breaker
F1-E	EF-1	2	208	3	7.5	14 ga	15 amp
F2-E	EF-2	2	208	3	7.5	14 ga	15 amp
F3-S	SF-1	2	208	3	7.5	14 ga	15 amp

- Qty. Fan Switches (0-3)
- Qty. Light Switches (0-3)
- Qty. Temp. Switches (0-1)
- One Switch for L & F
- Temperature Interlock
- Mounted Sensors - Factory
- Mounted Sensors - Field
- Heat Switch / Tempering SW
- Cool Switch
- AD Switch
- Hood Switches
- Audible Alarm
- Gas Reset
- Power for Gas Solenoid
- Power for Shunt Trip
- Exhaust in Fire
- MUA Interface
- Lights Out in Fire
- Fire Relay (#1)
- Extra Fire Relay (#2)
- Extra Fire Relay (#3)
- DPDT Relay w/SF
- DPDT Relay w/EF
- Off Delay Relay
- SF Failure Light
- EF Failure Light
- Fan Failure Light (Appl.)
- Aux. Supply Contact
- Tie in WWCP

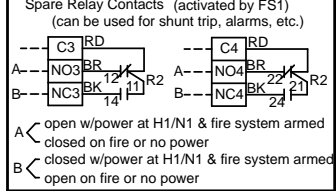
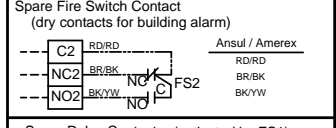

TORQUE:
 TERMINAL BLOCKS = 8 LB.IN
 GROUNDING BLOCKS = 8 LB.IN

FIELD WIRING:
 USE MINIMUM
 60" Copper Wire

LABEL DESCRIPTION

EF Exhaust Fan	-----	FACTORY WIRING
SF Supply Fan	-----	FIELD WIRING
ST Starter	-----	ALL WIRING 90°C 14 GA.
OL OverLoad	-----	UNLESS SPECIFIED
C Contactor		
G Ground		
S Switch		
LT Light		
FS Fire Switch		
R Relay		
AF Air Flow Switch		
SV Gas Solenoid		
STB Shunt Trip Breaker		
D Damper		
PB PushButton		
EC Evap Cooler		
TS Temperature Sensor		
TC Temperature Controller		

WIRE COLOR

BK - black
BL - blue
BR - brown
OR - orange
PR - purple
RD - red
YW - yellow
WH - white

NOTES:
 Drawing shown de-energized at L1 (term. #H1), w/ Fire System armed (non-fire mode). (normal operation, R1 & R2 are energized) If wall mounted prewire, or field installed fire system, the fire system microswitches must be field wired.

UL LISTED UNDER SUBJECT 891
 FILE #E313951

Wiring Diagram #
 110-2B-321

Model: XRUB-200-20

Belt Drive Upblast Centrifugal Roof Exhaust Fan

Dimensional	
Quantity	1
Weight w/o Acc's (lb)	124
Weight w/ Acc's (lb)	142
Max T Motor Frame Size	184
Roof Opening (in.)	20.5 x 20.5

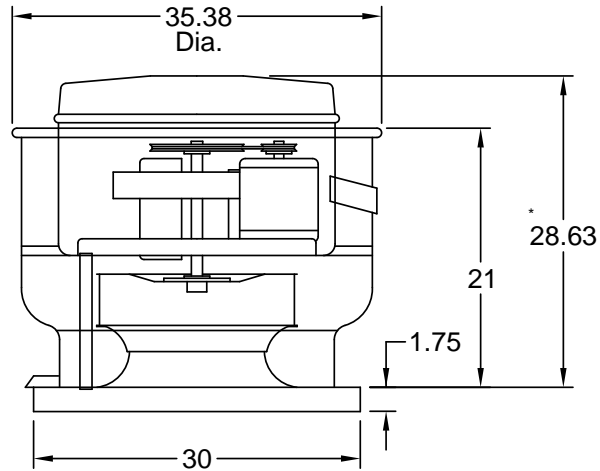

Reference assembly view drawings for actual dimensions with mounted accessories

Performance	
Requested Volume (CFM)	3,850
Actual Volume (CFM)	3,850
External SP (in. wg)	1.1
Total SP (in. wg)	1.1
Fan RPM	1052
Operating Power (hp)	1.43
Elevation (ft)	20
Airstream Temp.(F)	70
Air Density (ft3)	0.075
Drive Loss (%)	5.4
Tip Speed (ft/min)	5,885
Static Eff. (%)	49

Motor	
Motor Mounted	Yes
Size (hp)	2
V/C/P	208/60/3
Enclosure	ODP
Motor RPM	1725
Windings	1
NEC FLA* (Amps)	7.5

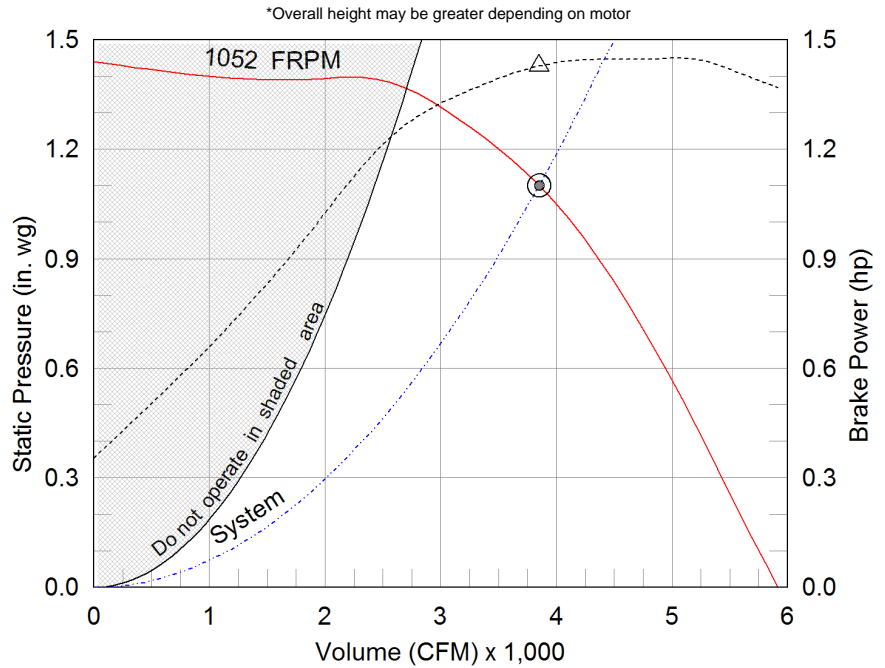

- △ Operating Bhp point
- Operating point at Total SP
- Operating point at External SP
- Fan curve
- - - System curve
- - - Brake horsepower curve

Sound Power by Octave Band

Sound Data	62.5	125	250	500	1000	2000	4000	8000	LwA	dBA	Sones
Inlet	77	81	86	75	68	68	65	60	80	69	17.3

Notes:

All dimensions shown are in units of in.
 *FLA - based on tables 150 or 148 of National Electrical Code 2002. Actual motor FLA may vary, for sizing thermal overload, consult factory.
 LwA - A weighted sound power level, based on ANSI S1.4
 dBA - A weighted sound pressure level, based on 11.5 dB attenuation per Octave band at 5 ft - dBA levels are not licensed by AMCA International
 Sones - calculated using AMCA 301 at 5 ft



Model: XRUB-200-20

Belt Drive Upblast Centrifugal Roof Exhaust Fan

Standard Construction Features:

- Aluminum housing - Backward inclined aluminum wheel - Curb cap with prepunched mounting holes - Motor and drives isolated on shock mounts - Drain trough - Ball bearing motors - Adjustable motor pulley - Adjustable motor plate - Fan shaft mounted in ball bearing pillow blocks - Bearings meet or exceed temperature rating of fan - Static resistant belts - Corrosion resistant fasteners - Internal lifting lugs

Options & Accessories:

UL/cUL 762 Listed - "Power Ventilators for Rest. Exh. Appliances"
Switch, NEMA-3R, Toggle, Junction Box Mounted & Wired
Hinged Base (Attached)
Curb Seal (Attached)
Grease Trap (PN 475538)
Heat Baffle (Attached)
Bearings with Grease Fittings, L10 life of 100,000 hrs (L50 avg. life 500,000 hrs)
Unit Warranty: 1 Yr (Standard)