

LIFE-SAFETY INFORMATION

| | | |
|---|--------------------------------|---------------|
| APPLICABLE CODES | | |
| NFPA 101 LIFE-SAFETY CODE 2012 | | |
| OCCUPANCY TYPE(S) AND CHAPTER(S) | | |
| ASSEMBLY (CHAPTER 12), INDUSTRIAL (CHAPTER 40), BUSINESS (CHAPTER 38) | | |
| MULTIPLE, MIXED, OR SEPARATE OCCUPANCY (REFERENCE CHAPTER 6) | | |
| N/A | | |
| OCCUPANT LOAD FACTOR (REFERENCE TABLE 7.3.1.2) | | |
| LEVEL 1 | | |
| ASSEMBLY (BANQUET HALL) | 3,214 SF NET 1 SF/OCCUPANT NET | 460 OCCUPANTS |
| INDUSTRIAL (KITCHEN) | 311 SF NET | 2 OCCUPANTS |
| BUSINESS | 1,975 SF 100 SF/OCCUPANT | 21 OCCUPANTS |
| TOTAL OCCUPANT LOAD - LEVEL 1 483 OCCUPANTS | | |
| LEVEL 2 | | |
| ASSEMBLY (BANQUET HALL) | 2,382 SF NET 1 SF/OCCUPANT NET | 341 OCCUPANTS |
| ASSEMBLY (BALCONY) | 441 SF NET 1 SF/OCCUPANT NET | 64 OCCUPANTS |
| INDUSTRIAL (KITCHEN) | 311 SF NET | 2 OCCUPANTS |
| BUSINESS | 2,404 SF 100 SF/OCCUPANT | 24 OCCUPANTS |
| TOTAL OCCUPANT LOAD - LEVEL 2 431 OCCUPANTS | | |
| TOTAL OCCUPANT LOAD 914 OCCUPANTS | | |
| CONSTRUCTION TYPE(S) (REFERENCE: CHAPTERS, TABLE A.8.2.1.2 AND COMMENTARY TABLE 6.1 IN HANDBOOK) | | |
| III(200) | | |
| MINIMUM EXIT SEPARATION DISTANCE FOR REMOTELY LOCATED EXITS | | |
| (REFERENCE: SECTION 7.5, SPECIFY 1/2 OR 1/3 DIAGONAL DISTANCE OF AREA SERVED) | | |
| 1/3 DIAGONAL = | 34'-2" | |
| MAXIMUM DEAD-END CORRIDORS (REFERENCE: OCCUPANCY CHAPTER AND TABLE A.1.6) | | |
| 20' | | |
| MAXIMUM COMMON PATH OF TRAVEL DISTANCE (REFERENCE: OCCUPANCY CHAPTER AND TABLE A.1.6) | | |
| 75' | | |
| MAXIMUM TRAVEL DISTANCE TO EXITS (REFERENCE: OCCUPANCY CHAPTER AND TABLE A.1.6) | | |
| 250' | | |
| EXTINGUISHMENT REQUIREMENTS FULLY SPRINKLED | | |
| DETECTION, ALARM, AND COMMUNICATION SYSTEMS THIS BUILDING SHALL HAVE A FULL FIRE ALARM | | |
| ALLOWABLE HEIGHT AND BUILDING AREA PER IBC EQUIVALENT CONSTRUCTION TYPE | | |

BUILDING CODE INFORMATION

| | | |
|---|--------------------------------|---------------|
| APPLICABLE CODES | | |
| IBC 2012 | | |
| ASSEMBLY GROUP A-2 (BANQUET HALL) (IBC 2012 SECTION 303) | | |
| BUSINESS GROUP B (IBC 2012 SECTION 304) | | |
| OCCUPANT LOAD CALCULATIONS (TABLE 1004.1.2) | | |
| LEVEL 1 | | |
| ASSEMBLY (GROUP A-2) | 3,214 SF NET 1 SF/OCCUPANT NET | 460 OCCUPANTS |
| ASSEMBLY (GROUP A-2) - KITCHEN | 311 SF NET | 2 OCCUPANTS |
| BUSINESS (GROUP B) | 1,975 SF 100 SF/OCCUPANT | 20 OCCUPANTS |
| TOTAL OCCUPANT LOAD - LEVEL 1 482 OCCUPANTS | | |
| LEVEL 2 | | |
| ASSEMBLY (GROUP A-2) | 2,382 SF NET 1 SF/OCCUPANT NET | 341 OCCUPANTS |
| ASSEMBLY (GROUP A-2) BALCONY | 441 SF NET 1 SF/OCCUPANT NET | 64 OCCUPANTS |
| ASSEMBLY (GROUP A-2) - KITCHEN | 311 SF NET | 2 OCCUPANTS |
| BUSINESS (GROUP B) | 2,404 SF 100 SF/OCCUPANT | 25 OCCUPANTS |
| TOTAL OCCUPANT LOAD - LEVEL 2 433 OCCUPANTS | | |
| TOTAL OCCUPANT LOAD 914 OCCUPANTS | | |
| CONSTRUCTION TYPE(S) (TABLE 503) | | |
| III(B) (SECTION 503) | | |
| ALLOWABLE HEIGHT AND BUILDING AREA LIMITED BY TYPE OF CONSTRUCTION | | |
| MAXIMUM HEIGHT IN STORIES (SECTION 503 & 504, TABLE 503) | 3 | |
| MAXIMUM AREA IN SQUARE FEET (SECTION 503, 506 & 507, TABLE 503) | 14,000 | |

WIND SPEED DESIGN REQUIREMENTS

THIS BUILDING SHALL BE DESIGNED WITH IBC SEC 1609 AS A FULLY ENCLOSED BLDG USING THE FOLLOWING INFORMATION:

WIND DESIGN DATA:

DETERMINATION OF WIND LOADS SHALL BE IN ACCORDANCE WITH IBC SEC 1609.3 (A), (B), OR (C) DEPENDING ON THE RISK CATEGORY

BASIC WIND SPEED (3 SECOND GUST) = 132 MPH (IBC FIG 1609C)

RISK FACTOR: CATEGORY I BLDG SURFACE ROUGHNESS = C

TOPOGRAPHIC FACTOR = 1 EXPOSURE = C

DESIGN WIND PRESSURE (ASCE 7-10 TABLE 28.6-1): 34.7 PSF

INTERNAL PRESSURE COEFFICIENT (ASCE 7-10 TABLE 26.11-1): ± 0.18

LIVE LOADS (IBC SEC 1607)

STORAGE, LIGHT (IBC TABLE 1607.1): 125 PSF

ROOF LIVE LOADS (IBC TABLE 1607.1): 20 PSF UNIFORM, 300 LB CONCENTRATED

SNOW LOADS (IBC TABLE 1608):

GROUND SNOW LOAD (IBC FIG 1608.2): 5 PSF

GRAPHIC SYMBOLS

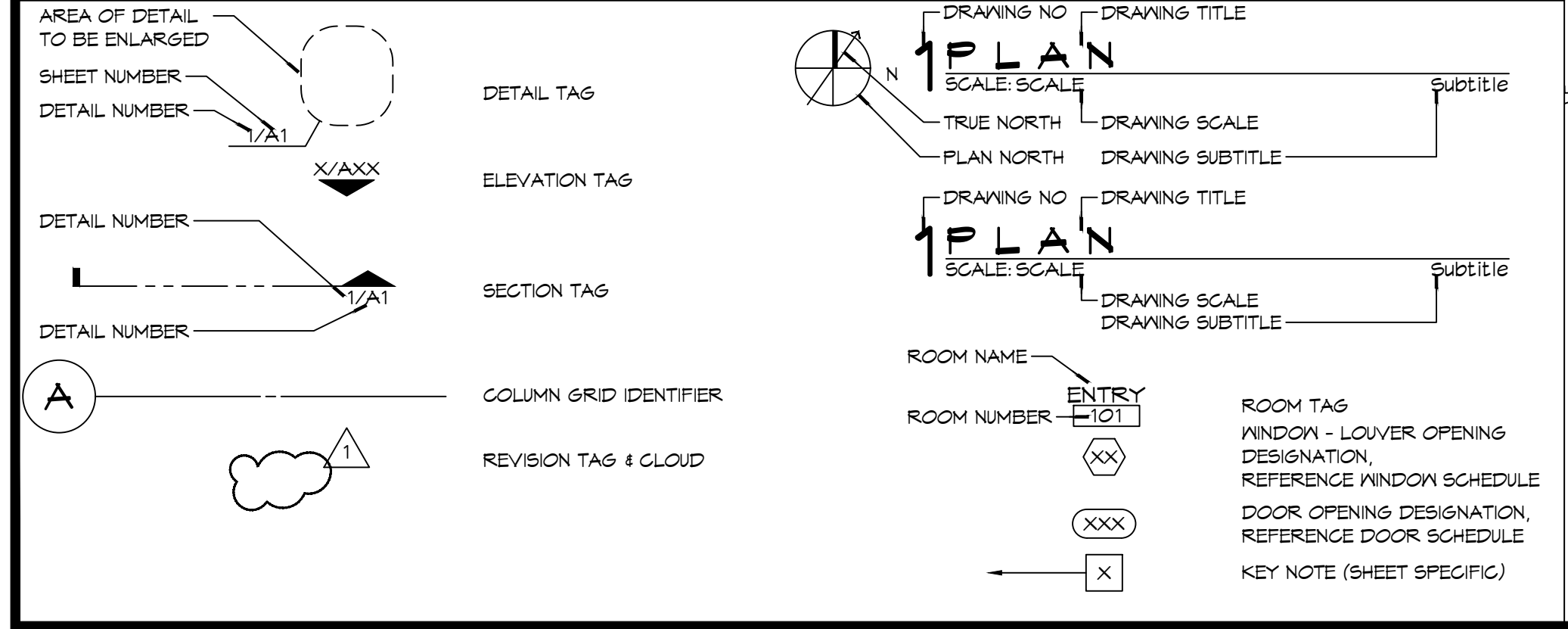

RECEPTION HALL RENOVATION

BEV INCORPORATED

211 COUSIN STREET
SLIDELL, LA 70458

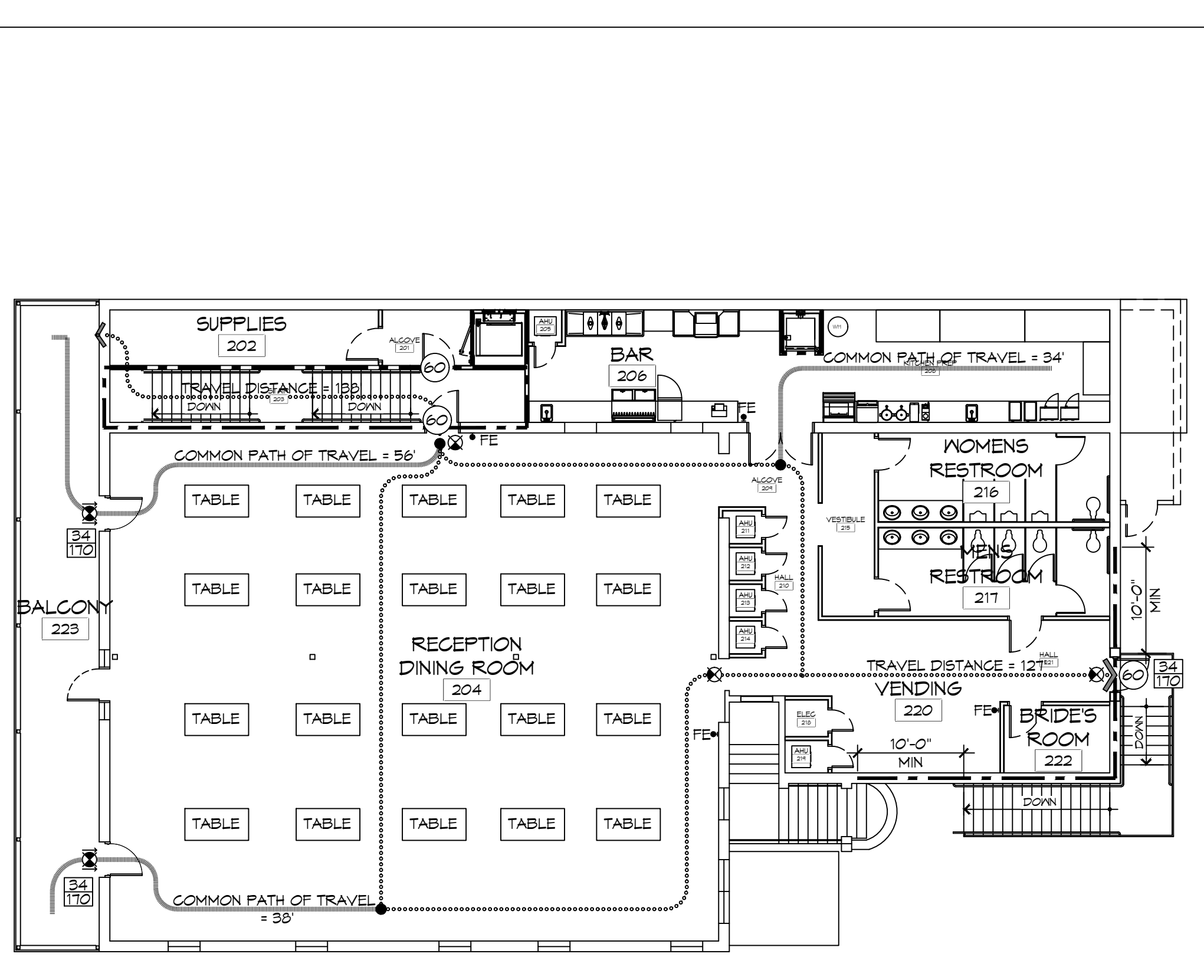

2 LIFE-SAFETY PLAN - LEVEL 2
SCALE: 3/32" = 1'-0"

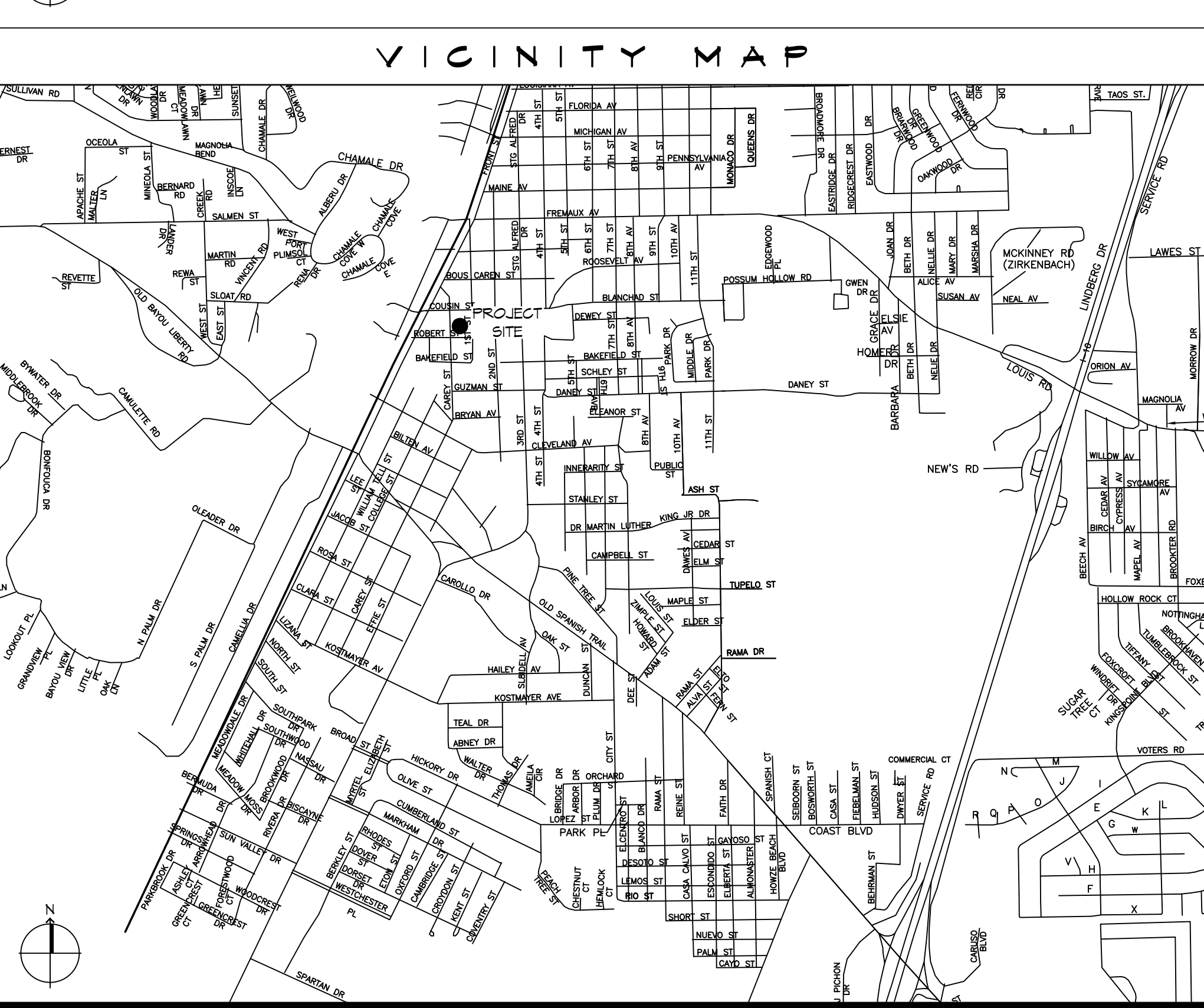

LIFE-SAFETY LEGEND

| SYMBOL | DESCRIPTION |
|---------------------|---------------------------------------|
| ↖ | EXITS |
| 45 | DOOR FIRE RATING (MINUTES) |
| 36/100 | DOOR WIDTH/EGRESS CAPACITY |
| ⊠ | EXIT LIGHT |
| FE | FIRE EXTINGUISHER AND CABINET |
| FE | FIRE EXTINGUISHER W/ WALL MTD BRACKET |
| --- | COMMON PATH OF TRAVEL |
| o-o-o-o-o-o-o-o-o-o | TRAVEL DISTANCE |
| ● | DECISION POINT |
| --- | SMOKE PARTITION |
| --- | ONE-HOUR FIRE RATED PARTITION |
| --- | TWO-HOUR FIRE RATED PARTITION |
| --- | TWO-HOUR FIRE/SMOKE PARTITION |
| --- | FOUR-HOUR RATED PARTITION |

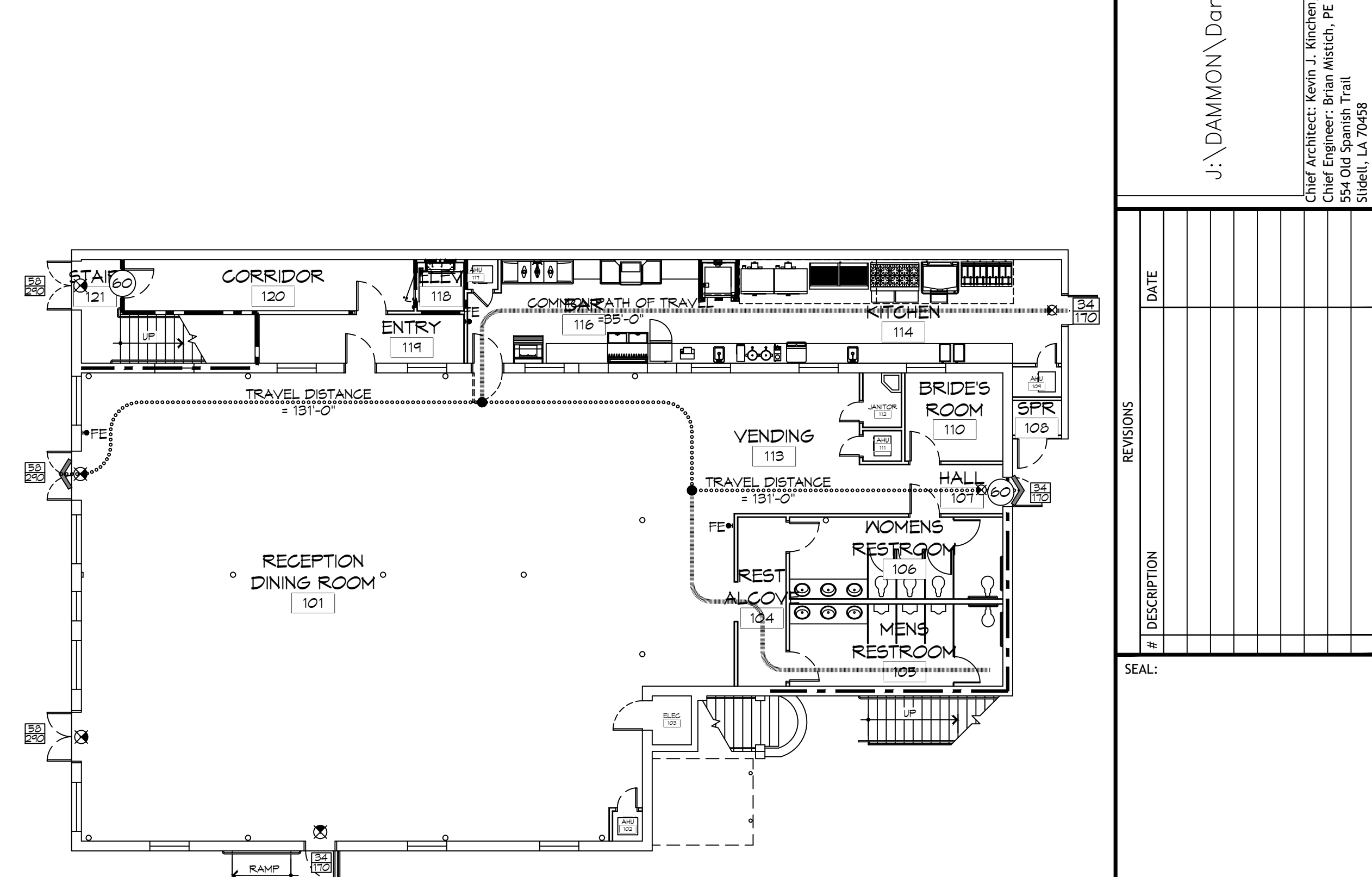

1 LIFE-SAFETY PLAN - LEVEL 1
SCALE: 3/32" = 1'-0"

SHEET INDEX

| SHEET # | SHEET TITLE |
|---------|---|
| G1 | GENERAL INFORMATION, LIFE-SAFETY PLANS, AND CODE DATA |
| G2 | ADAAG INFORMATION SHEET |
| D1 | DEMOLITION PLAN - LEVEL 1 |
| D2 | DEMOLITION PLAN - LEVEL 2 |
| A1 | ARCHITECTURAL FLOOR PLAN - LEVEL 1 |
| A2 | ARCHITECTURAL FLOOR PLAN - LEVEL 2 |
| A3 | SCHEDULES AND NOTES |
| A4 | STAIRS PLAN, SECTIONS, ELEVATIONS, & DETAILS |
| P1 | PLUMBING PLAN - LEVEL 1 |
| P2 | PLUMBING PLAN - LEVEL 2 |
| P3 | SANITARY RISERS & DETAILS |
| M1 | MECHANICAL PLAN - LEVEL 1 |
| M2 | MECHANICAL PLAN - LEVEL 2 |
| M3 | MECHANICAL NOTES, SCHEDULES & DETAILS |
| E1 | ELECTRICAL POWER PLAN - LEVEL 1 |
| E2 | ELECTRICAL LIGHTING PLAN - LEVEL 2 |
| E3 | ELECTRICAL POWER PLAN - LEVEL 1 |
| E4 | ELECTRICAL LIGHTING PLAN - LEVEL 2 |
| E5 | ELECTRICAL CIRCUIT PANELS & ONE-LINE DIAGRAMS |

GENERAL NOTES

- ALL MATERIALS AND WORK, INCIDENTAL TO THE CONSTRUCTION OF THIS PROJECT, SHALL CONFORM TO ALL GOVERNING CODES, AND REGULATIONS OF AGENCIES IN AUTHORITY.
- CONTRACTOR SHALL PROVIDE ALL PUBLIC PROTECTIONS NECESSARY AS REQUIRED BY LAW.
- THE DRAWINGS, SPECIFICATIONS AND ANY SUBSEQUENTLY ISSUED ADDENDA, AMENDMENTS OR SUCH CHANGE ORDERS APPROVED BY THE OWNER AND THE CONTRACTOR ARE PART OF THESE CONTRACT DOCUMENTS.
- DO NOT SCALE DRAWINGS. CONSULT WITH THE ARCHITECT REGARDING ANY ITEMS IN THE CONTRACT DOCUMENTS THAT REQUIRE CLARIFICATION.
- TRASH SHALL BE REMOVED FROM THE SITE NOT LESS THAN TWICE MONTHLY.
- THE GENERAL CONTRACTOR SHALL VERIFY EXISTING CONDITIONS PRIOR TO COMMENCING WORK AND REPORT ANY AND ALL DISCREPANCIES TO THE ARCHITECT.
- CONTRACTOR VEHICLES AND EQUIPMENT NECESSARY FOR CONSTRUCTION MAY BE PARKED ON THE SITE. OTHER VEHICLES PARKED ON THE SITE REQUIRE THE OWNER'S PERMISSION.
- NAMING A CERTAIN BRAND, MAKE OR MANUFACTURER IS TO DESIGNATE THE GENERAL STYLE, TYPE, CHARACTER AND QUALITY STANDARD OF THE PRODUCT DESIRED. SUBSTITUTION REQUESTS MUST BE SUBMITTED PRIOR TO BIDDING.
- ALL MATERIALS/EQUIPMENT SHALL BE INSTALLED PER MANUFACTURER'S RECOMMENDATIONS. WORK NOT CONSISTENT WITH MANUFACTURER'S RECOMMENDATIONS WILL BE REJECTED BY OWNER/ARCHITECT.

PROJECT STATISTICS

| | |
|--|-----------|
| SQUARE FOOTAGE | |
| LEVEL 1 | 5,456 SF |
| LEVEL 2 | 5,397 SF |
| TOTAL ENCLOSED SPACE | 10,853 SF |
| PROJECT LOCATION: | |
| 211 COUSIN STREET SLIDELL, LA 70458 | |
| OWNER: REED INGRAM | |

www.dammonengineering.com
www.dammoninc.com
PH: 985.641.5832
F: 985.641.5950

U:\DAMMON\Dammon Logo\Dammon Logo_Banner.jpg

Chief Architect: Kevin T. Kinchen, NCBAB
Civil Engineer: Brian Mischig, PE
554 Old Spanish Trail
Slidell, LA 70458

RECEPTION HALL RENOVATION FOR:
BEV, INCORPORATED
211 COUSIN STREET
SLIDELL, LOUISIANA 70458
JOB No: 2220
DATE: MARCH 13, 2015
DRAWN BY: K-K
CHECKED BY: K-K