

LIFE-SAFETY INFORMATION

APPLICABLE CODES
 NFPA 101 LIFE-SAFETY CODE 2012
 OCCUPANCY B, CONSTRUCTION TYPE II B
 BUSINESS (CHAPTER 9B)
 OCCUPANT LOAD FACTOR (REFERENCE TABLE 1.3.1.2)
 100 SF PER OCCUPANT
 30 OCCUPANTS
 BUSINESS AREA = 3000 SQ.FT.
 GROSS

TOTAL OCCUPANTS = 30

CLASSIFICATION OF HAZARD OF CONTENTS
 (REFERENCE: OCCUPANCY CHAPTER AND 6.2.2. SPECIFY LOW, ORDINARY, OR HIGH)
 CONSTRUCTION TYPE(S) (REFERENCE: CHAPTERS, TABLE A.8.2.1.2 AND COMMENTARY TABLE B.1 IN HANDBOOK)

MINIMUM EXIT SEPARATION DISTANCE FOR REMOTELY LOCATED EXITS
 (REFERENCE: SECTION 7.5, SPECIFY 1/2 OR 1/3 DIAGONAL DISTANCE OF AREA SERVED)
 1/2 DIAGONAL = N/A
 MAXIMUM DEAD-END CORRIDORS (REFERENCE: OCCUPANCY CHAPTER AND TABLE A.1.6)
 MAXIMUM COMMON PATH OF TRAVEL DISTANCE (REFERENCE: OCCUPANCY CHAPTER AND TABLE A.1.6)
 MAXIMUM TRAVEL DISTANCE TO EXITS (REFERENCE: OCCUPANCY CHAPTER AND TABLE A.1.6)
 MAIN ENTRANCE MUST BE SIGNED TO ACCOMMODATE 1/2 OCCUPANT LOAD OF BUILDING

EXTINGUISHMENT REQUIREMENTS SPRINKLER (NOT REQUIRED)
 DETECTION, ALARM, AND COMMUNICATION SYSTEMS NO
 ALLOWABLE HEIGHT AND BUILDING AREA PER IBC EQUIVALENT CONSTRUCTION TYPE

BUILDING CODE INFORMATION

APPLICABLE CODES
 IBC 2012 (IBC 2012 CHAPTER 10)
 OCCUPANCY B, BUSINESS GROUP B (TABLE 1004.1.2)
 OCCUPANT LOAD CALCULATIONS (TABLE 1004.1.2)
 BUSINESS AREAS = 3000 SQ. FT. 100 SF PER OCCUPANT (GROSS) 30 OCCUPANTS
 TOTAL OCCUPANTS 30
 CONSTRUCTION TYPE(S) (TABLE 503)
 II B (SECTION 503)

ALLOWABLE HEIGHT AND BUILDING AREA LIMITED BY TYPE OF CONSTRUCTION
 2
 MAXIMUM HEIGHT IN STORES (SECTION 503 & 504, TABLE 503) 15.00
 MAXIMUM AREA IN SQUARE FEET (SECTION 503, 506 & 507, TABLE 503)

WIND SPEED DESIGN REQUIREMENTS

THIS BUILDING SHALL BE DESIGNED WITH IBC SEC 1609 AS A FULLY ENCLOSED BLDG USING THE FOLLOWING INFORMATION:
 WIND DESIGN DATA:
 DETERMINATION OF WIND LOADS SHALL BE IN ACCORDANCE WITH IBC SEC 1609.3 (A), (B), OR (C) DEPENDING ON THE RISK CATEGORY
 BASIC WIND SPEED (3 SECOND GUST) = 132 MPH (IBC FIG 1604C)
 RISK FACTOR: SURFACE ROUGHNESS = C
 TOPOGRAPHIC FACTOR = 1 EXPOSURE = C
 DESIGN WIND PRESSURE (ASCE T-10 TABLE 26.6-1): 34.1 PSF
 INTERNAL PRESSURE COEFFICIENT (ASCE T-10 TABLE 26.11-1): ± 0.19
 LIVE LOADS (IBC SEC 1607) 125 PSF
 STORAGE LIGHT (IBC TABLE 1607.1): 20 PSF UNIFORM, 300 LB CONCENTRATED
 ROOF LIVE LOADS (IBC TABLE 1607.1): 5 PSF
 SNOW LOADS (IBC TABLE 1608):
 GROUND SNOW LOAD (IBC FIG 1608.2):

FLOOD ZONE INFORMATION

BASED ON THE SURVEY OF THIS PROPERTY BY R.N. KREBBES LLC, THIS PROPERTY IS IN SPECIAL FLOOD HAZARD AREA. F.I.R.M. COMMUNITY MAP NO 225304 0010 C
 FLOOD ZONE: AE
 BASE FLOOD ELEVATION NSVD 4'0"
 ELEVATIONS REFER TO NSVD 1928 DATUM

LIFE-SAFETY LEGEND

SYMBOL	DESCRIPTION
>	EXITS
(45)	DOOR FIRE RATING (MINUTES)
100	DOOR WIDTH/EGRESS CAPACITY
⊗	EXIT LIGHT
* FE	FIRE EXTINGUISHER W/ WALL MTD BRACKET
.....	COMMON PATH OF TRAVEL
.....	TRAVEL DISTANCE
●	DESIGN POINT

OLD TOWN KITCHEN LA STOR 458 227 COUSIN LANE SLIDEL, LA 70458

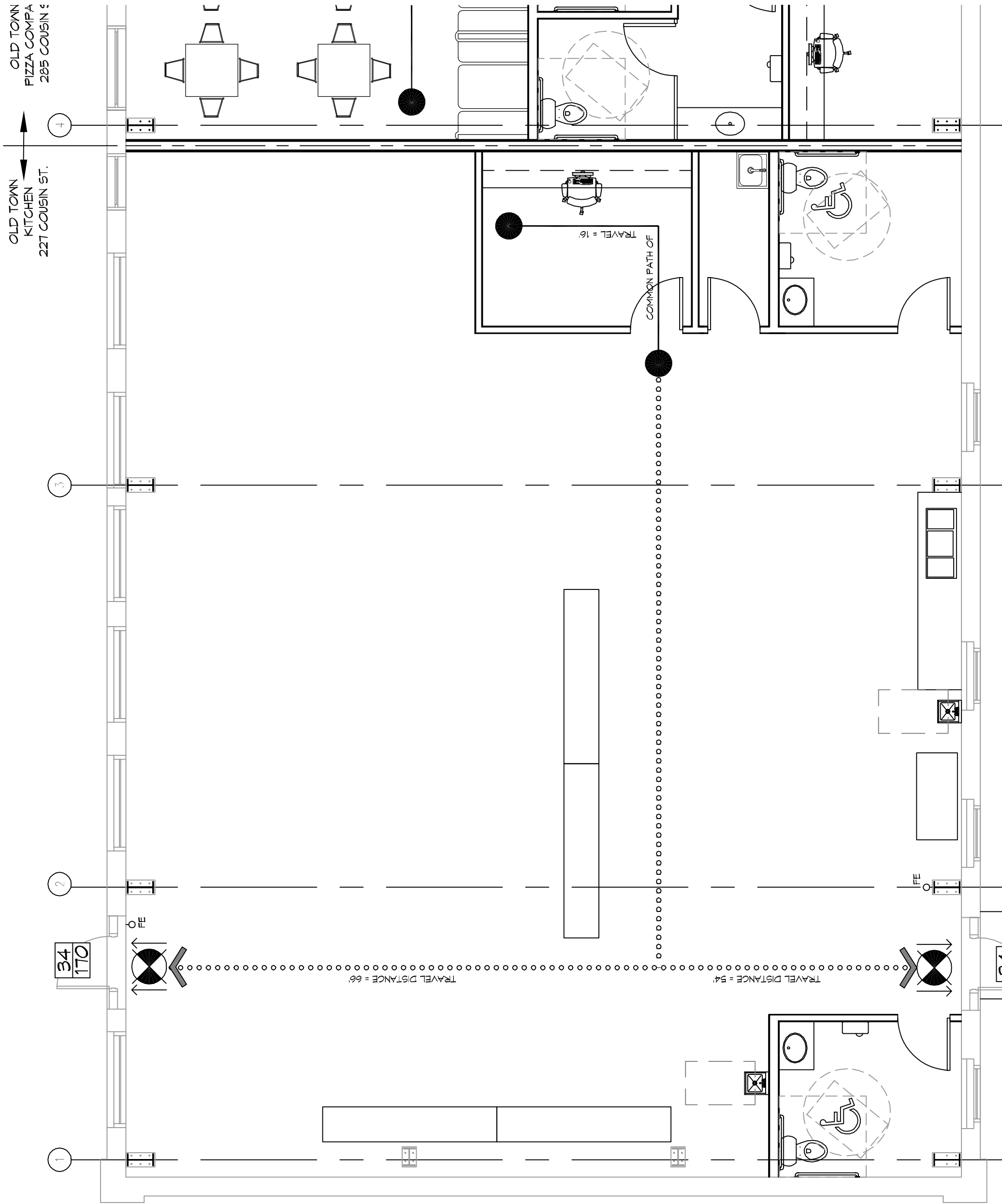

1 LIFE-SAFETY PLAN
 SCALE: 3/4" = 1'-0"

VICINITY MAP

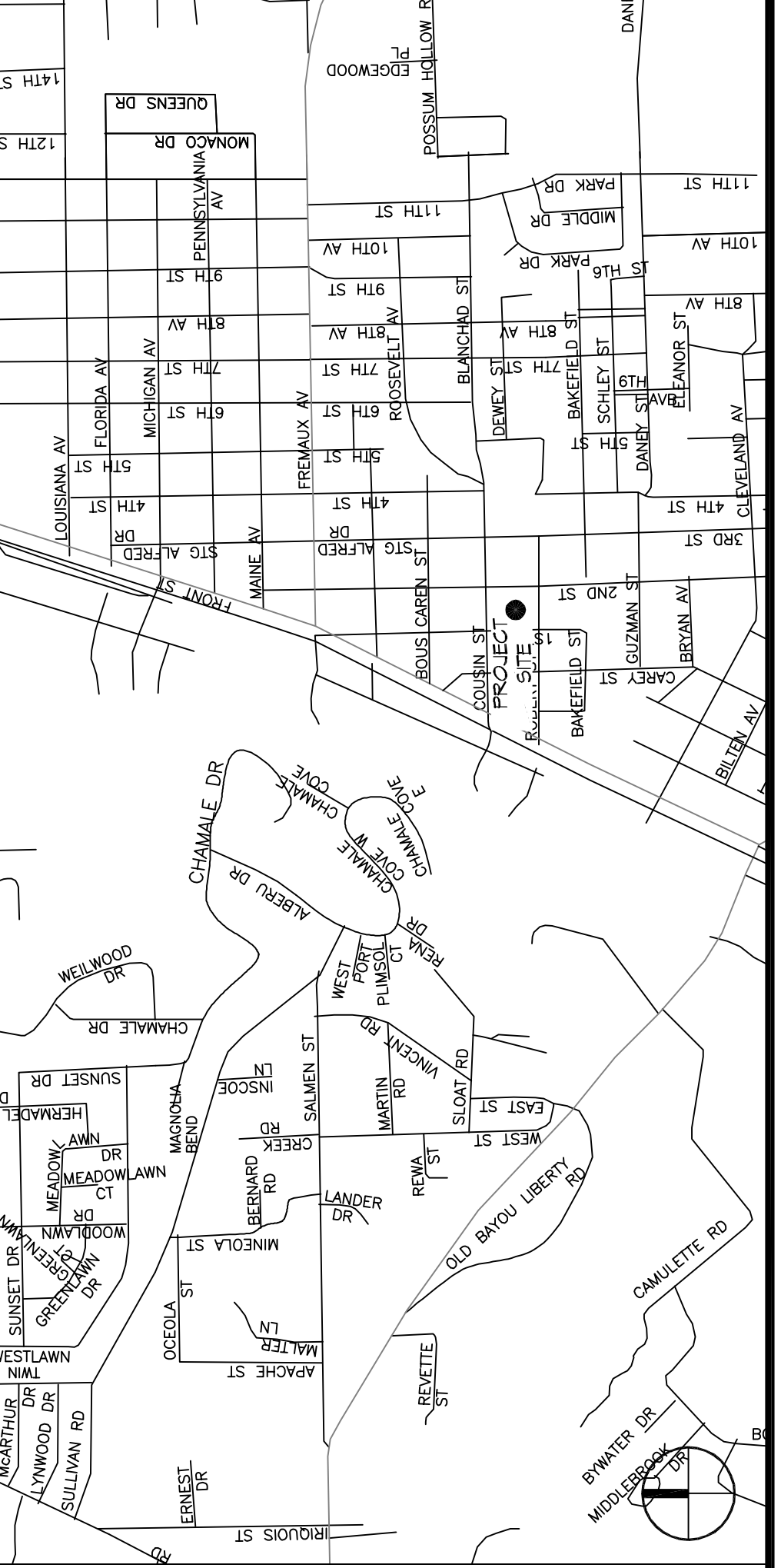

SHEET INDEX

SHEET #	SHEET TITLE
G/01	GENERAL INFORMATION SHEET
A/01	ACCESSIBILITY INFORMATION
G/02	SITE PLAN
A/02	SITE UTILITIES PLAN
F/01	FLOOR PLAN
M/01	PLUMBING PLAN
E/01	MECHANICAL FLOOR PLAN, SCHEDULES & DETAILS
E/02	PANEL AND LIGHTING PLAN

GENERAL NOTES

1. ALL MATERIALS AND WORK, INCIDENTAL TO THE CONSTRUCTION OF THIS PROJECT, SHALL BE IN ACCORDANCE WITH ALL GOVERNING CODES, AND REGULATIONS OF AGENCIES IN AUTHORITY.
2. CONTRACTOR SHALL PROVIDE ALL PUBLIC PROTECTIONS NECESSARY AS REQUIRED BY LAW.
3. THE DRAWINGS AND ANY SUBSEQUENTLY ISSUED APPENDIX, AMENDMENTS OR SUPPLEMENTAL SHEETS SHALL BE PART OF THESE CONTRACT DOCUMENTS. CONTRACTOR SHALL VERIFY ALL DIMENSIONS AND CONDITIONS PRIOR TO COMMENCING WORK AND REPORT ANY AND ALL DISCREPANCIES TO THE ARCHITECT.
4. DO NOT SCALE DRAWINGS. CONSULT WITH THE ENGINEER REGARDING ANY ITEMS IN THE CONTRACT DOCUMENTS THAT REQUIRE CLARIFICATION.
5. TRASH SHALL BE REMOVED FROM THE SITE NOT LESS THAN TWICE MONTHLY.
6. THE GENERAL CONTRACTOR SHALL VERIFY EXISTING CONDITIONS PRIOR TO COMMENCING WORK AND REPORT ANY AND ALL DISCREPANCIES TO THE ARCHITECT.
7. CONTRACTOR VEHICLES AND EQUIPMENT NECESSARY FOR CONSTRUCTION MAY BE PARKED ON THE SITE. OTHER VEHICLES PARKED ON THE SITE ALL MATERIALS/EQUIPMENT SHALL BE INSTALLED PER MANUFACTURER'S RECOMMENDATIONS. WORK NOT CONSISTENT WITH MANUFACTURER'S RECOMMENDATIONS WILL BE REJECTED BY OWNER/ARCHITECT.

SHEET TITLE:
 GENERAL INFORMATION SHEET

DRAWING NUMBER:

G101

SHEET NO. 1 of 5

DAMMON ENGINEERING, INC.
 MISSISSIPPI & LOUISIANA
 Chief Engineer: Brian Mitchell, PE
 554 Old Spanish Trail
 Slidell, LA 70458
 www.dammonengineering.com
 PH: 955.649.5832

#	DESCRIPTION	DATE



11-21-17
 CHECKED BY: CKD
 DATE: 2/24
 BRANN BY: CKD
 227 COUSIN STREET
 SLIDEL, LA 70458