

LIFE-SAFETY INFORMATION

APPLICABLE CODES	NFPA 101 LIFE-SAFETY CODE 2015
OCCUPANCY A-2 ASSEMBLY USES INTENDED FOR FOOD AND DRINK CONSUMPTION (RESTAURANTS) : CONSTRUCTION TYPE II-B	
BUSINESS (CHAPTER 30)	(REFERENCE CHAPTER 6)
OCCUPANT LOAD FACTOR	(REFERENCE TABLE 73.12)
1044 SF NET	10 OCCUPANTS
ASSSEMBLY WITHOUT FIXED SEATING (TABLES AND CHAIRS) - 15 NET/100 SF PER OCCUPANT	
TOTAL OCCUPANTS = 101	

CLASSIFICATION OF HAZARD OF CONTENTS	(REFERENCE OCCUPANCY CHAPTER AND 6.2.2 SPECIFY LOW, ORDINARY, OR HIGH)
CONSTRUCTION TYPE(S)	(REFERENCE CHAPTERS, TABLE A.8.2.1.2 AND COMMENTARY TABLE 8.1 IN HANDBOOK)
MINIMUM EXIT SEPARATION DISTANCE FOR REMOTELY LOCATED EXITS	(REFERENCE SECTION 7.5 SPECIFY 1/2 OR 1/3 DIAGONAL DISTANCE OF AREA SERVED)
1/2 DIAGONAL =	N/A
MAXIMUM DEAD-END CORRIDORS	(REFERENCE OCCUPANCY CHAPTER AND TABLE A.7.6)
MAXIMUM COMMON PATH OF TRAVEL DISTANCE	(REFERENCE OCCUPANCY CHAPTER AND TABLE A.7.6)
MAXIMUM TRAVEL DISTANCE TO EXITS	(REFERENCE OCCUPANCY CHAPTER AND TABLE A.7.6)
MAIN ENTRANCE MUST BE SIGNED TO ACCOMMODATE 1/2 OCCUPANT LOAD OF BUILDING	
EXTINGUISHMENT REQUIREMENTS	SPRINKLER (NOT REQUIRED)
DETECTION, ALARM, AND COMMUNICATION SYSTEMS	NO
ALLOWABLE HEIGHT AND BUILDING AREA PER IBC EQUIVALENT CONSTRUCTION TYPE	

BUILDING CODE INFORMATION

APPLICABLE CODES	
OCCUPANCY A-2 ASSEMBLY USES INTENDED FOR FOOD AND DRINK CONSUMPTION (RESTAURANTS)	(IBC 2015 CHAPTER 10)
OCCUPANT LOAD CALCULATIONS	(TABLE 1004.1.2)
ASSEMBLY WITHOUT FIXED SEATING (TABLES AND CHAIRS)	15 NET
TOTAL OCCUPANTS	101
CONSTRUCTION TYPE(S)	(TABLE 603)
II-B (SECTION 603)	
ALLOWABLE HEIGHT AND BUILDING AREA LIMITED BY TYPE OF CONSTRUCTION	2
MAXIMUM HEIGHT IN STORES (SECTION 603.4.504, TABLE 603)	4500
MAXIMUM AREA IN SQUARE FEET (SECTION 603.506, 606, 607, TABLE 603)	

WIND SPEED DESIGN REQUIREMENTS

THIS BUILDING SHALL BE DESIGNED WITH IBC SEC. 1604 AS A FULLY ENCLOSED BLDG USING THE FOLLOWING INFORMATION:
 WIND DESIGN DATA:
 DETERMINATION OF WIND LOADS SHALL BE IN ACCORDANCE WITH IBC SEC. 1603.9 (A), (B), OR (C) DEPENDING ON THE RISK CATEGORY
 BASIC WIND SPEED (3 SECOND GUST) = 132 MPH (IBC FIG 1603C)
 CATEGORY I BLDGS SURFACE ROUGHNESS = C
 RISK FACTOR = 1 EXPOSURE = C
 DESIGN WIND PRESSURE (ASCE 7-10 TABLE 26.6-1): 34.7 PSF
 INTERNAL PRESSURE COEFFICIENT (ASCE 7-10 TABLE 26.11-1): ± 0.18
 LIVE LOADS (IBC SEC 1607): 125 PSF STORAGE LIGHT (IBC TABLE 1607.1): 20 PSF UNIFORM, 300 LB CONCENTRATED
 ROOF LIVE LOADS (IBC TABLE 1607.1): 20 PSF UNIFORM, 300 LB CONCENTRATED
 SNOW LOADS (IBC TABLE 1608): 5 PSF
 GROUND SNOW LOAD (IBC FIG 1608.2): 5 PSF

FLOOD ZONE INFORMATION

BASED ON THE SURVEY OF THIS PROPERTY BY KADVA LAND SURVEYING LLC, THIS PROPERTY IS IN SPECIAL FLOOD HAZARD AREA. FIRM COMMUNITY MAP NO. 223204.0010 C
 FLOOD ZONE: AE BASE FLOOD ELEVATION: NGVD 4.0'
 ELEVATIONS REFER TO NGVD 1929 DATUM

LIFE-SAFETY LEGEND

SYMBOL	DESCRIPTION
EXIT	EXITS
DOOR FIRE RATING (MINUTES)	DOOR FIRE RATING (MINUTES)
DOOR WIDTH/EGRESS CAPACITY	DOOR WIDTH/EGRESS CAPACITY
EXIT LIGHT	EXIT LIGHT
FIRE EXTINGUISHER W/ WALL MTD BRACKET	FIRE EXTINGUISHER W/ WALL MTD BRACKET
COMMON PATH OF TRAVEL	COMMON PATH OF TRAVEL
TRAVEL DISTANCE	TRAVEL DISTANCE
DECISION POINT	DECISION POINT

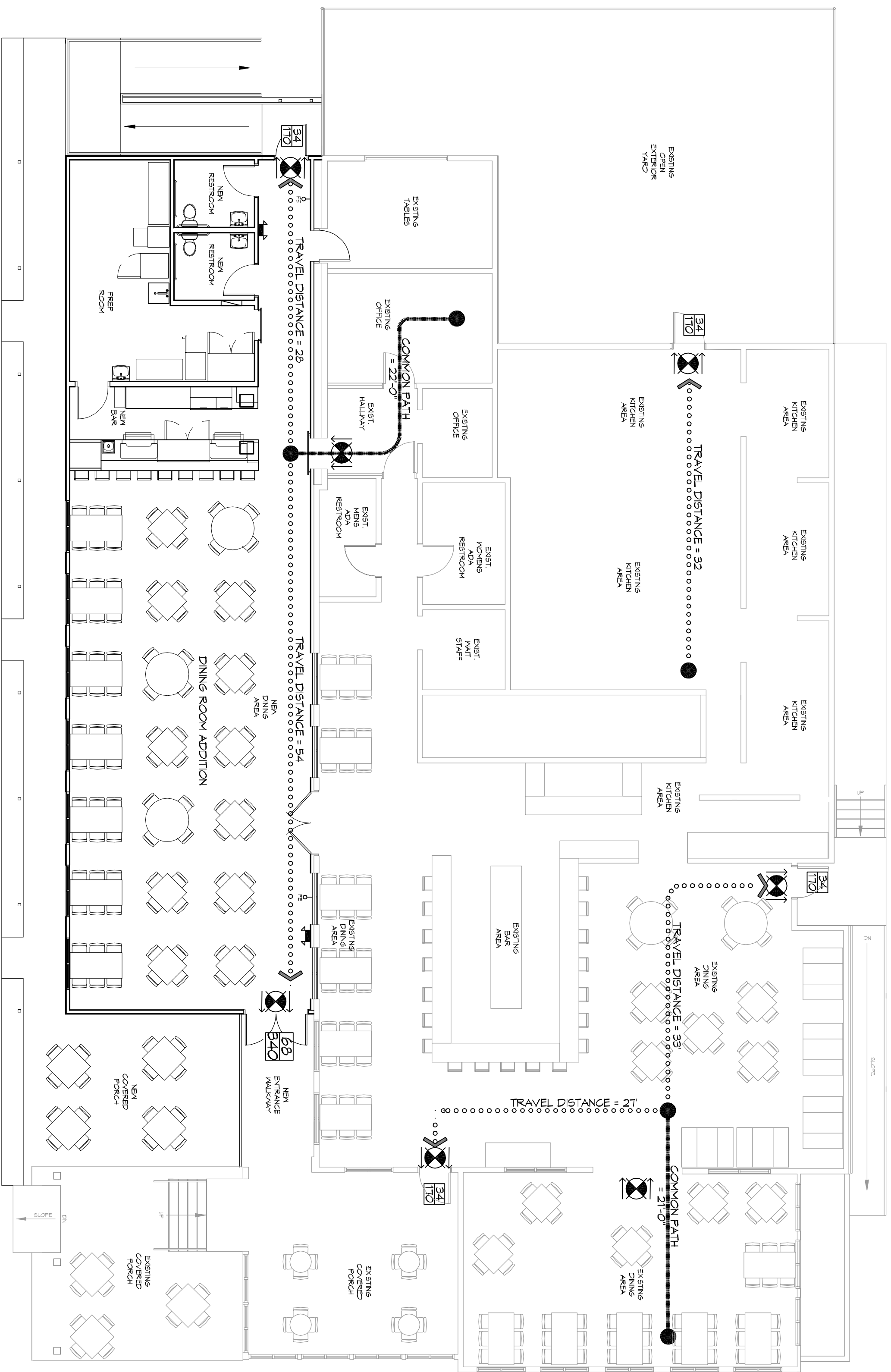

LIFE-SAFETY PLAN
 SCALE: 1/8" = 1'-0"

VICINITY MAP

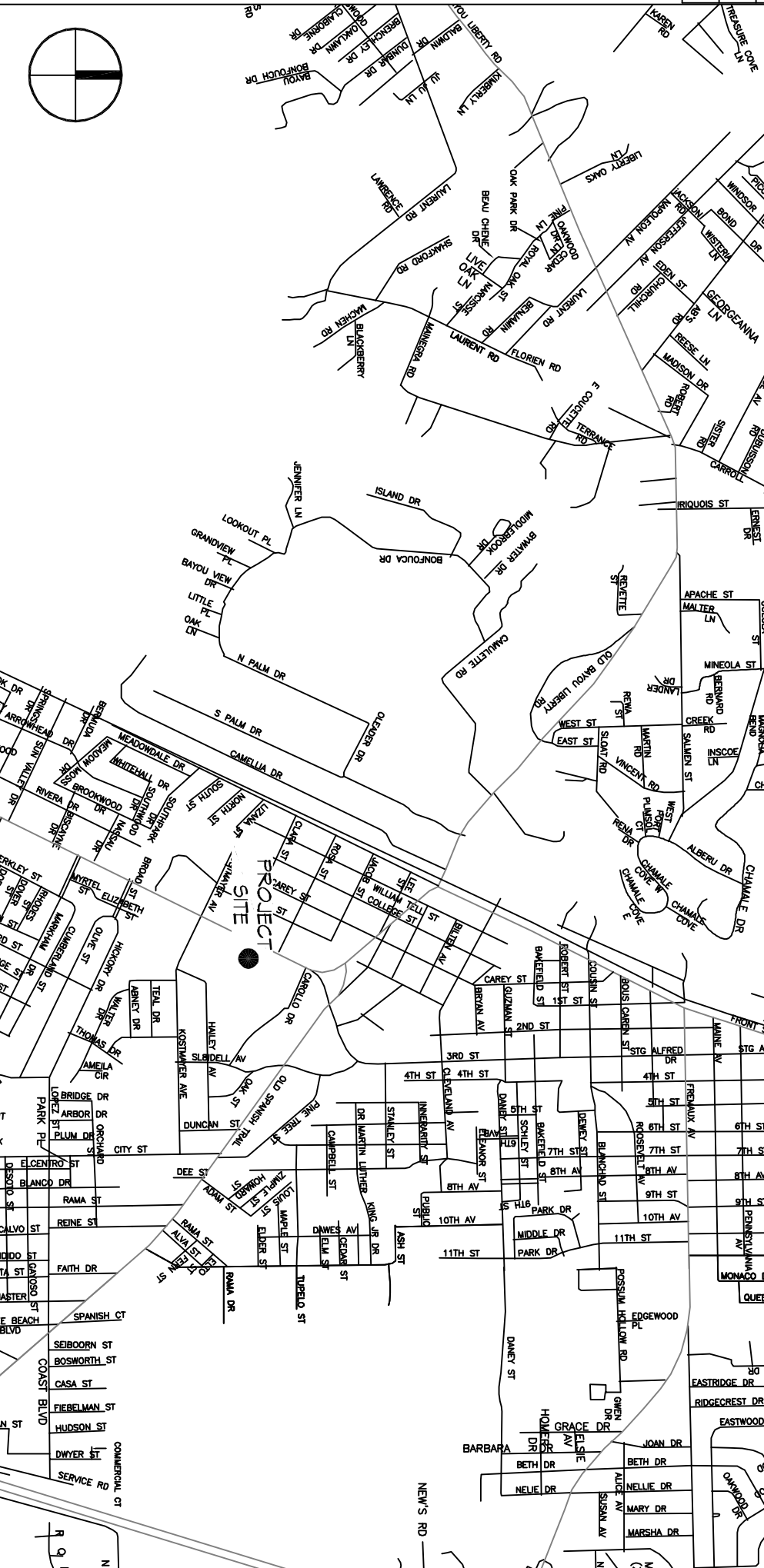

SHEET INDEX

SHEET #	SHEET TITLE
6101	GENERAL INFORMATION SHEET
6102	ACCESSIBILITY INFORMATION
6103	SITE PLAN
6104	FOUNDATION PLAN AND DETAILS
6105	DEMOLITION PLAN
6106	OVERALL FLOOR PLAN
6107	FLOOR PLAN
6108	REFLECTED CEILING PLAN
6109	BAR FLOOR PLAN
6110	EXTERIOR ELEVATIONS
6111	PLUMBING PLAN
6112	MECHANICAL FLOOR PLAN, SCHEDULES & DETAILS
6113	POWER AND LIGHTING PLAN

GENERAL NOTES

1. ALL MATERIALS AND WORK INCIDENTAL TO THE CONSTRUCTION OF THIS PROJECT SHALL CONFORM TO ALL GOVERNING CODES AND REGULATIONS OR ASHES IN ANY MANNER.
2. CONTRACTORS SHALL PROVIDE ALL PUBLIC PROTECTIONS NECESSARY AS REQUIRED BY LAW.
3. THE DRAWINGS AND ANY SUBSEQUENTLY ISSUED AMENDMENTS OR ADDITIONS SHALL BE THE PROPERTY OF THE ARCHITECT. THE CONTRACTOR SHALL BE RESPONSIBLE FOR OBTAINING ALL NECESSARY PERMITS AND APPROVALS FROM THE APPROPRIATE AGENCIES.
4. DO NOT SCALE DRAWINGS. CONSULT WITH THE ENGINEER REGARDING ANY ITEMS IN THE CONTRACT DOCUMENTS THAT REQUIRE CLARIFICATION.
5. TRASH SHALL BE REMOVED FROM THE SITE NOT LESS THAN TWICE MONTHLY.
6. THE GENERAL CONTRACTOR SHALL VERIFY EXISTING CONDITIONS PRIOR TO COMMENCING WORK AND REPORT ANY AND ALL DISCREPANCIES TO THE ARCHITECT.
7. CONTRACTOR VEHICLES AND EQUIPMENT NECESSARY FOR CONSTRUCTION MAY BE PARKED ON THE SITE. OTHER VEHICLES PARKED ON THE SITE REQUIRE THE OWNER'S PERMISSION.
8. ALL MATERIALS/EQUIPMENT SHALL BE INSTALLED PER MANUFACTURER'S RECOMMENDATIONS. WORK NOT CONSISTENT WITH MANUFACTURER'S RECOMMENDATIONS WILL BE REJECTED BY OWNER/ARCHITECT.

DAMMON ENGINEERING, INC.
 LOUISIANA & MISSISSIPPI

Chief Engineer: Brian Mstich, PE
 554 Old Spanish Trail
 Slidell, LA 70458

www.dammonengineering.com
 info@dammonengineering.com
 PH: 985.649.5832

REVISIONS	DATE
# DESCRIPTION	

NEW DINING ADDITION
SOUTHSIDE CAFE

3154 PONTCHARTRAIN DR
 SLIDELL, LA 70458

JOB No: 2354 DATE: 01-07-18
 DRAWN BY: CKD CHECKED BY: JMS

SHEET TITLE:
 GENERAL INFORMATION SHEET

DRAWING NUMBER:
6101

SHEET No: 1 OF 14