

LIFE-SAFETY INFORMATION

APPLICABLE CODES	IFPA 101 LIFE-SAFETY CODE 2015
OCCUPANCY A-2 ASSEMBLY USES INTENDED FOR FOOD AND DRINK CONSUMPTION (RESTAURANTS) : CONSTRUCTION TYPE IIB	
BUSINESS (CHAPTER 30)	(REFERENCE CHAPTER 6)
OCCUPANT LOAD FACTOR	(REFERENCE TABLE 73.12)
ASSSEMBLY WITHOUT FIXED SEATING (TABLES AND CHAIRS) - 15 NET SQ. FT. PER OCCUPANT	10 OCCUPANTS
TOTAL OCCUPANTS = 101	
CLASSIFICATION OF HAZARD OF CONTENTS	(REFERENCE CHAPTERS TABLE A.8.2.12 AND COMMENTARY TABLE 8.1 IN HANDBOOK)
CONSTRUCTION TYPE(B)	(REFERENCE CHAPTERS TABLE A.8.2.12 AND COMMENTARY TABLE 8.1 IN HANDBOOK)
MINIMUM EXIT SEPARATION DISTANCE FOR REMOTELY LOCATED EXITS	(REFERENCE SECTION 75 SPECIFY 1/2 OR 1/3 DIAGONAL DISTANCE OF AREA SERVED)
1/2 DIAGONAL =	N/A
MAXIMUM DEAD-END CORRIDORS	(REFERENCE OCCUPANCY CHAPTER AND TABLE A.7.6)
MAXIMUM COMMON PATH OF TRAVEL DISTANCE	(REFERENCE OCCUPANCY CHAPTER AND TABLE A.7.6)
MAXIMUM TRAVEL DISTANCE TO EXITS	(REFERENCE OCCUPANCY CHAPTER AND TABLE A.7.6)
MAIN ENTRANCE MUST BE SIGNED TO ACCOMMODATE 1/2 OCCUPANT LOAD OF BUILDING	
EXTINGUISHMENT REQUIREMENTS	SPRINKLER (NOT REQUIRED)
DETECTION, ALARM, AND COMMUNICATION SYSTEMS	NO
ALLOWABLE HEIGHT AND BUILDING AREA PER IBC EQUIVALENT CONSTRUCTION TYPE	
APPLICABLE CODES	
OCCUPANCY A-2 ASSEMBLY USES INTENDED FOR FOOD AND DRINK CONSUMPTION (RESTAURANTS)	(IBC 2015 CHAPTER 10)
OCCUPANT LOAD CALCULATIONS	(TABLE 1004.1.2)
ASSEMBLY WITHOUT FIXED SEATING (TABLES AND CHAIRS)	15 NET
TOTAL OCCUPANTS	101
CONSTRUCTION TYPE(S)	(TABLE 603)
I B (SECTION 603)	
ALLOWABLE HEIGHT AND BUILDING AREA LIMITED BY TYPE OF CONSTRUCTION	2
MAXIMUM HEIGHT IN STORES (SECTION 603 & 604, TABLE 603)	
MAXIMUM AREA IN SQUARE FEET (SECTION 603, 606 & 607, TABLE 603)	4,500
WIND SPEED DESIGN REQUIREMENTS	
THIS BUILDING SHALL BE DESIGNED WITH IBC SEC. 1604 AS A FULLY ENCLOSED BLDG USING THE FOLLOWING INFORMATION:	
WIND DESIGN DATA:	
DETERMINATION OF WIND LOADS SHALL BE IN ACCORDANCE WITH IBC SEC. 1603.9 (A), (B), OR (C) DEPENDING ON THE RISK CATEGORY	
BASIC WIND SPEED (3 SECOND GUST) =	132 MPH (IBC FIG 1603C)
RISK FACTOR	CATEGORY I BLDGS
TOPOGRAPHIC FACTOR =	1
DESIGN WIND PRESSURE (ASCE 7-10 TABLE 26.6-1):	34.7 PSF
INTERNAL PRESSURE COEFFICIENT (ASCE 7-10 TABLE 26.11-1):	+ 0.18
LIVE LOADS (IBC SEC 1607)	125 PSF
STORAGE LIGHT (IBC TABLE 1607.1):	20 PSF UNIFORM, 300 LB CONCENTRATED
ROOF LIVE LOADS (IBC TABLE 1607.1):	20 PSF UNIFORM, 300 LB CONCENTRATED
SNOW LOADS (IBC TABLE 1609):	5 PSF
GROUND SNOW LOAD (IBC FIG 1609.2):	
FLOOD ZONE INFORMATION	
BASED ON THE SURVEY OF THIS PROPERTY BY KADVA LAND SURVEYING LLC, THIS PROPERTY IS IN SPECIAL FLOOD HAZARD AREA. FIRM COMMUNITY MAP NO 223204 0010 C	
FLOOD ZONE:	AE
ELEVATIONS REFER TO NAVD 1928 DATUM	BASE FLOOD ELEVATION NAVD 4.0'

BUILDING CODE INFORMATION

WIND SPEED DESIGN REQUIREMENTS

FLOOD ZONE INFORMATION

LIFE-SAFETY LEGEND

SYMBOL	DESCRIPTION
EXIT	EXITS
45	DOOR FIRE RATING (MINUTES)
350	DOOR WIDTH/EGRESS CAPACITY
350	EXIT LIGHT
350	FIRE EXTINGUISHER W/ WALL MTD BRACKET
350	COMMON PATH OF TRAVEL
350	TRAVEL DISTANCE
350	DECISION POINT

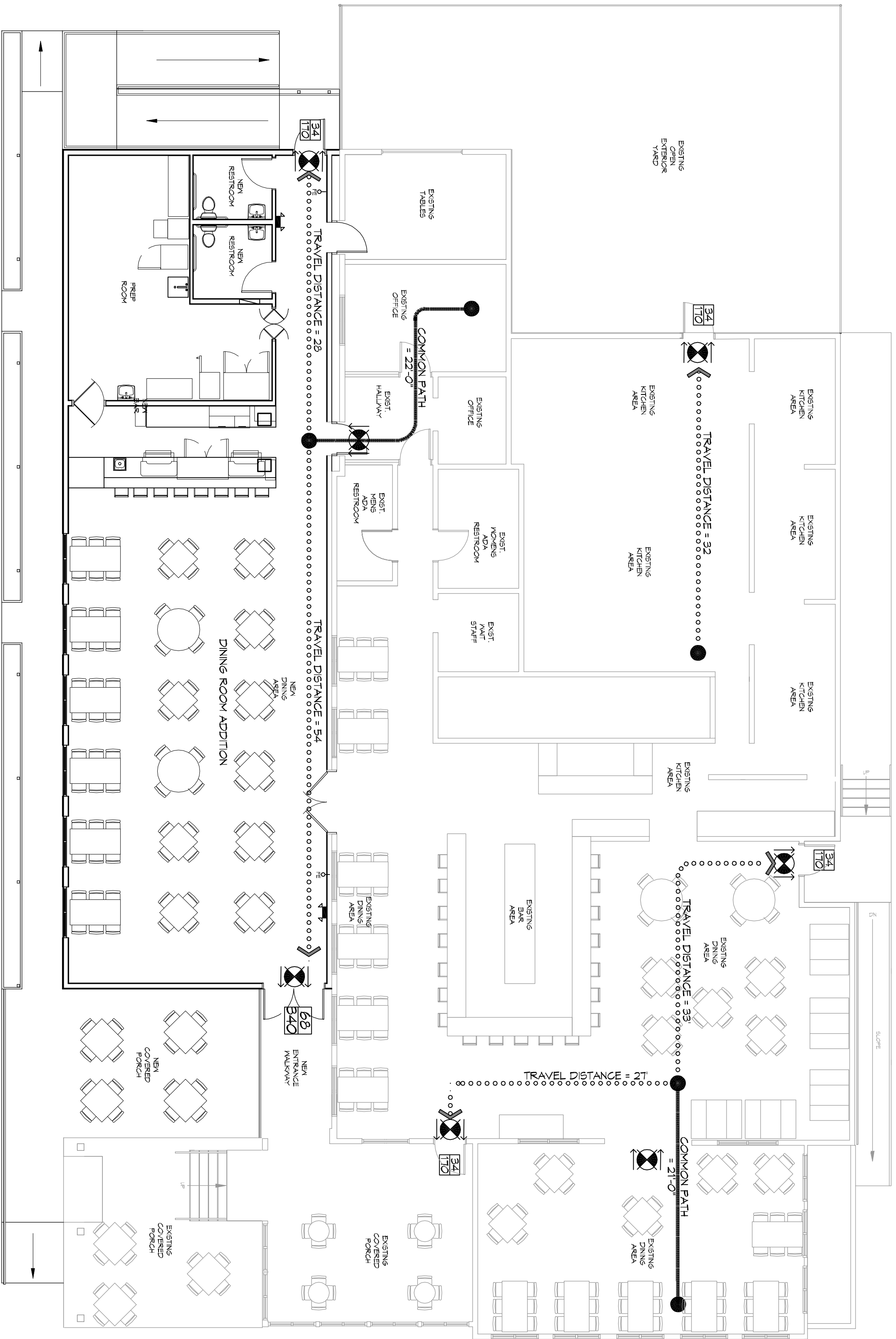

LIFE-SAFETY PLAN
SCALE: 1/8" = 1'-0"

VICINITY MAP

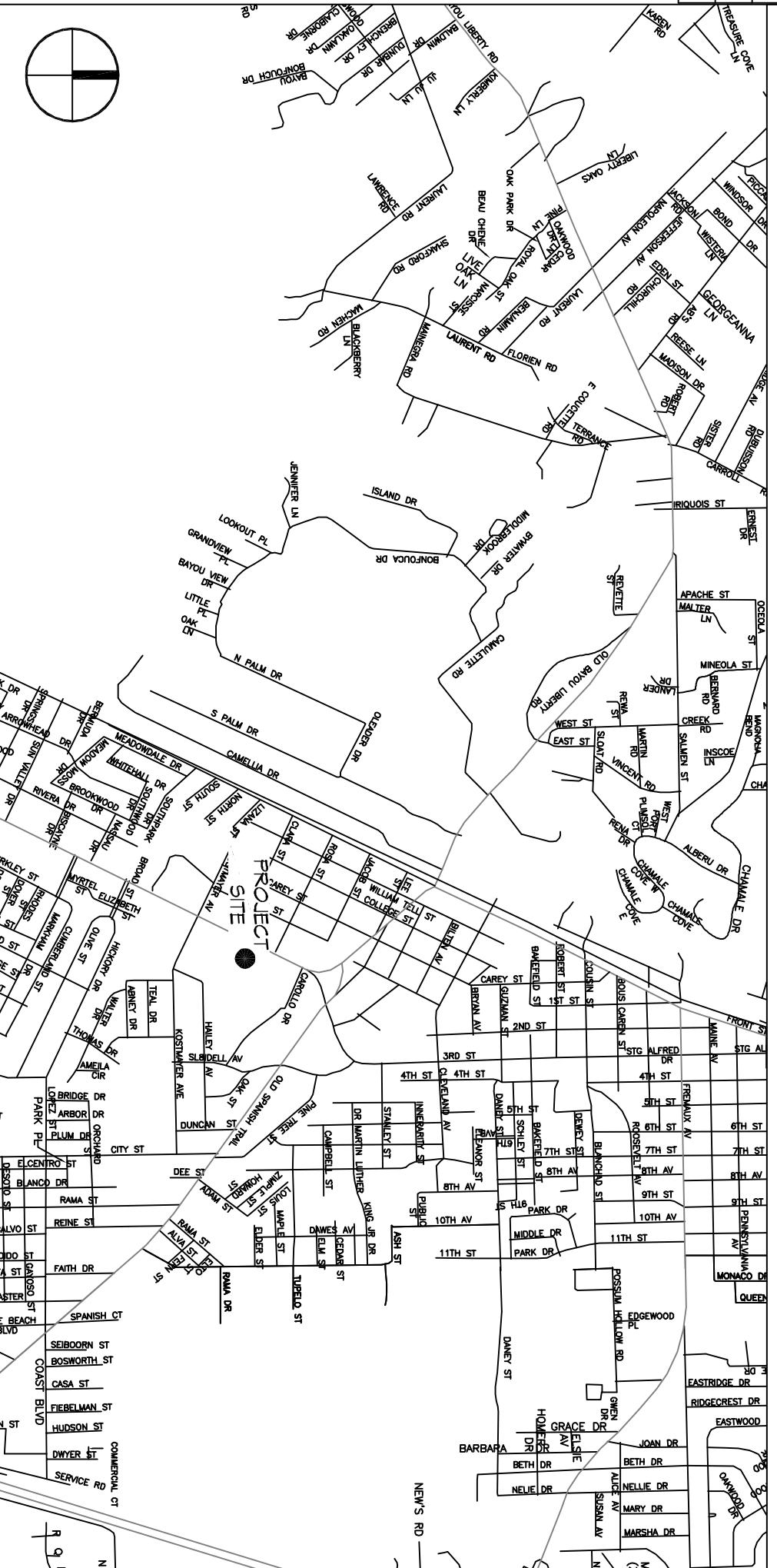

SHEET INDEX

SHEET #	SHEET TITLE
6101	GENERAL INFORMATION SHEET
6102	ACCESSIBILITY INFORMATION
6101	SITE PLAN
6101	FOUNDATION PLAN AND DETAILS
6102	TYPICAL CONNECTION DETAILS, SCHEDULES, AND NOTES
6101	OVERALL FLOOR PLAN
6102	FLOOR PLAN
6103	BAR FLOOR PLAN
6104	REFLECTED CEILING PLAN
6105	ROOF PLAN
6106	EXTERIOR ELEVATIONS
6101	PLUMBING PLAN
6101	MECHANICAL FLOOR PLAN, SCHEDULES & DETAILS
6101	POWER AND LIGHTING PLAN

GENERAL NOTES

1. ALL MATERIALS AND WORK INCIDENT TO THE CONSTRUCTION OF THIS PROJECT SHALL CONFORM TO ALL GOVERNING CODES AND REGULATIONS OR ASHES IN ANY MANNER.
2. CONTRACTOR SHALL PROVIDE ALL PUBLIC PROTECTIONS NECESSARY AS REQUIRED BY LAW.
3. THE DRAWINGS AND ANY SUBSEQUENTLY ISSUED AMENDMENTS SHALL BE CONSIDERED PART OF THE CONTRACT DOCUMENTS. THE CONTRACTOR SHALL BE RESPONSIBLE FOR OBTAINING ALL NECESSARY PERMITS AND APPROVALS FROM THE APPROPRIATE AGENCIES.
4. DO NOT SCALE DRAWINGS. CONSULT WITH THE ENGINEER REGARDING ANY ITEMS IN THE CONTRACT DOCUMENTS THAT REQUIRE CLARIFICATION.
5. TRASH SHALL BE REMOVED FROM THE SITE NOT LESS THAN TWICE MONTHLY.
6. THE GENERAL CONTRACTOR SHALL VERIFY EXISTING CONDITIONS PRIOR TO COMMENCING WORK AND REPORT ANY AND ALL DISCREPANCIES TO THE ARCHITECT.
7. CONTRACTOR VEHICLES AND EQUIPMENT NECESSARY FOR CONSTRUCTION MAY BE PARKED ON THE SITE. OTHER VEHICLES PARKED ON THE SITE REQUIRE THE OWNER'S PERMISSION.
8. ALL MATERIALS/EQUIPMENT SHALL BE INSTALLED PER MANUFACTURER'S RECOMMENDATIONS. WORK NOT CONSISTENT WITH MANUFACTURER'S RECOMMENDATIONS WILL BE REJECTED BY OWNER/ARCHITECT.



Chief Engineer: Brian Mistic, PE
554 Old Spanish Trail
Stidell, LA 70458
www.dammonengineering.com
info@dammonengineering.com
PH: 985.649.5832

REVISIONS	DATE
# DESCRIPTION	



NEW DINING ADDITION

SOUTHSIDE CAFE

3154 PONTCHARTRAIN DR
SLIDELL, LA 70458

JOB No: 2354 DATE: 02-07-2019
DRAWN BY: CKD CHECKED BY: JMS

The above drawings and specifications design and arrangements represent the best and true intent of the project of Dammon Engineering, Inc. and its staff. Dammon Engineering, Inc. and its staff shall not be held responsible for any errors or omissions on the part of the contractor or any other party. The contractor shall be responsible for obtaining all necessary permits and approvals from the appropriate agencies. The contractor shall be responsible for obtaining all necessary permits and approvals from the appropriate agencies. The contractor shall be responsible for obtaining all necessary permits and approvals from the appropriate agencies.

GENERAL INFORMATION SHEET

DRAWING NUMBER:

6101

SHEET NO. 1 OF 15