

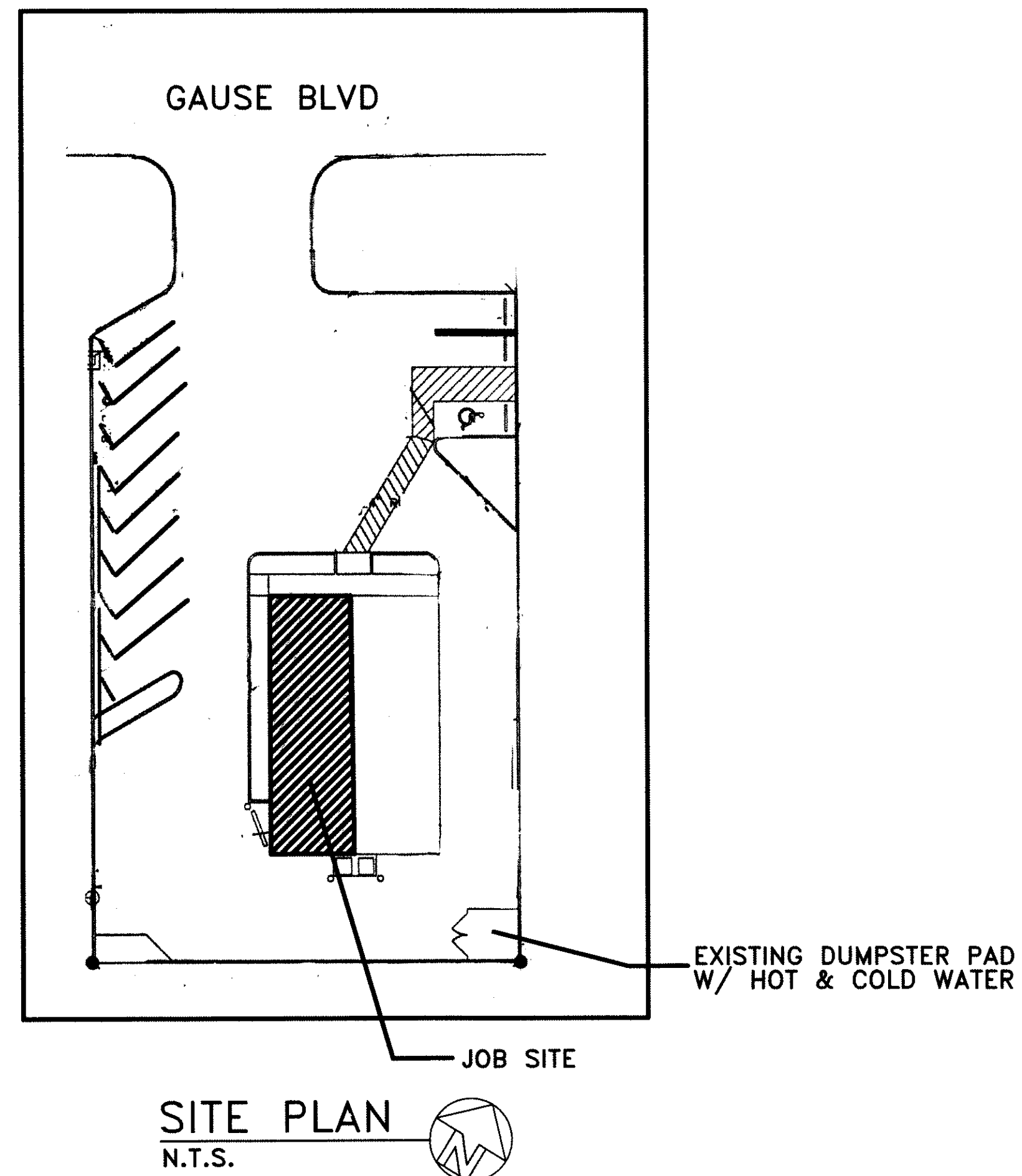

STORE LOCATION
 2349 GAUSE BLVD.
 SUITE 1
 SLIDELL, LA 70461



APPROVED

LA. IBTS
 CERTIFIED 3RD PARTY PROVIDER
 WWW.LAIBTS.ORG

11-18-10

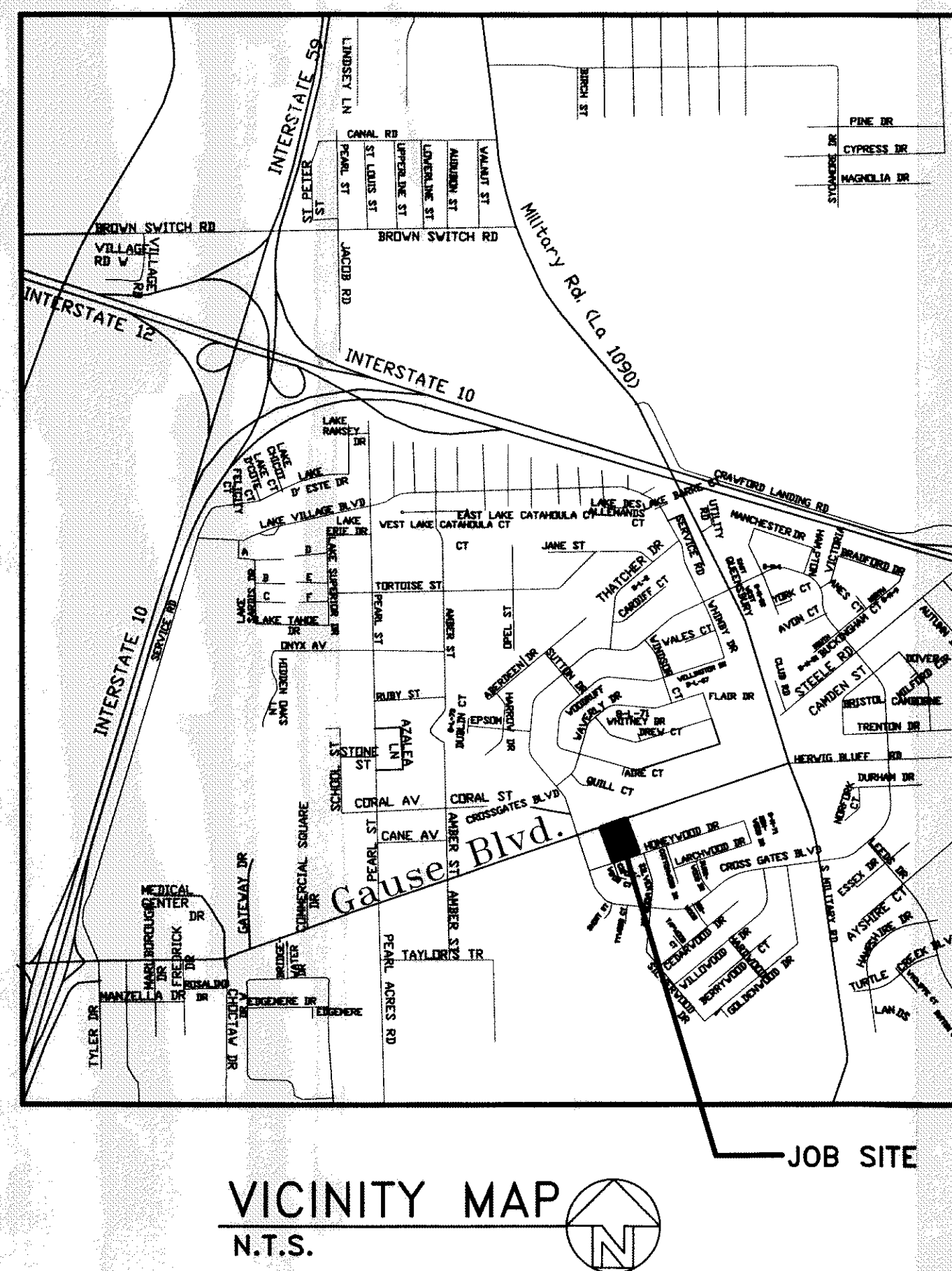

CODE SUMMARY	
TOTAL BUILDING AREA:	2,400 SQ. FT.
LEASE BUILDING AREA:	1,200 SQ. FT.
OCCUPANCY CLASSIFICATION SECTION 304.1	GROUP M (LESS THAN 50 OCCUPANTS)-LIFE SAFETY CODE NFPA 101, 2009 GROUP B (LESS THAN 50 OCCUPANTS A-2) INTERNATIONAL BUILDING CODE, 2006
BUILDING TYPE SECTION 503	TYPE V-B (WOOD FRAME)
OCCUPANT LOAD: IBC TABLE 1004.1.1 LIFE SAFETY CODE TABLE 7.3.1.2	TOTAL SQ. FOOTAGE 1,172 SQ. FT. OCCUPANT LOAD: FRONT COUNTER STANDING NO SEATING 95 SQ. FT. = 19 KITCHEN/SERVICE AREA 904 SQ. FT. = 9 28 OCCUPANTS
MEANS OF EGRESS:	NO. OF EXITS 2 (NFPA 101, 36.2.4.3) (IBC 2006, TBL. 1019.2) EXIT WIDTH PROVIDED 3'-0" (FRONT) (EXIT WIDTH REQUIRED 3'-0") 3'-0" (REAR) MAXIMUM DISTANCE TO EXITS 39'-5" (2 OR MORE EGRESS - 150'-0" ALLOWED) (SINGLE EGRESS - 75'-0" ALLOWED)

SHEET INDEX	
TITLESHEET	
A-1	FLOOR PLAN
A-2	EQUIPMENT PLAN
A-3	FINISHED AND CEILING PLAN
M-1	MECHANICAL PLAN
M-2	MECHANICAL DETAILS
E-1	POWER & LIGHTING PLAN
E-2	ELECTRICAL SCHEDULES
P-1	PLUMBING PLAN
P-2	PLUMBING DETAILS

PROJECT DIRECTORY	
FRANCHISEE: (OWNERS)	SELA PIZZA 1LLC DBA: MARCO'S PIZZA 1001 CHICORY CT. SLIDELL, LA 70460 CONTACT: BOBBY CURTIS (504) 416-6689 whachamean@aol.com
FRANCHISER:	MARCO'S FRANCHISING, LLC 5252 MONROE STREET TOLEDO, OH 43623-3140 (419) 885-7000 (PHONE) (419) 885-5215 (FAX)
LANDLORD:	TRIAD LLC. ATTN: DON NASH 2349 GAUSE BLVD. SUITE 2 SLIDELL, LA 70461 (985) 285-4048
ARCHITECT:	DAMMON ENGINEERING INC. ARCHITECTS AND ENGINEERS ROBERT WILTSE 1095 Florida Avenue Slidell, Louisiana 70458 (985) 649-5832 (985) 641-5950 FAX

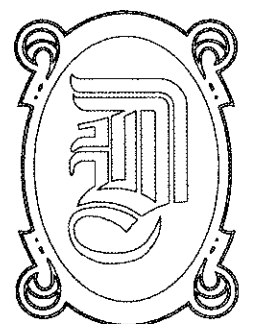
DAMMON
 ENGINEERING, INC.
EMMETT
DAMMON

ARCHITECT
ROBERT
WILTSE

1095 FLORIDA AVENUE
 SLIDELL, LA. 70458
 985-649-5832

WEBSITE:
 WWW.DAMMONENGINEERING.COM

EMAIL:
 DAMMONENG@BELLSOUTH.NET

ARCHITECTURE
 ENGINEERING
 STUDIES
 PLANNING
 INVESTIGATION
 EXPERT WITNESS

MARCO'S
PIZZA
TENANT
BUILDOUT

2349 E. GAUSE BLVD
 SUITE 1
 SLIDELL, LA
 70461

TITLE
SHEET

Robert Wiltse

REV:

SCALE: AS NOTED

JOB #: 2082

DATE: 11-1-10

SHEET 1

TS-1

OF 10