

SETBACKS SHOWN ARE AS PER ST. LOUISIS PLANNING DEPARTMENT CODE, SECTION 7.01.06 AND 7.01.07.

CROSS GATES BLVD. (SIDE)

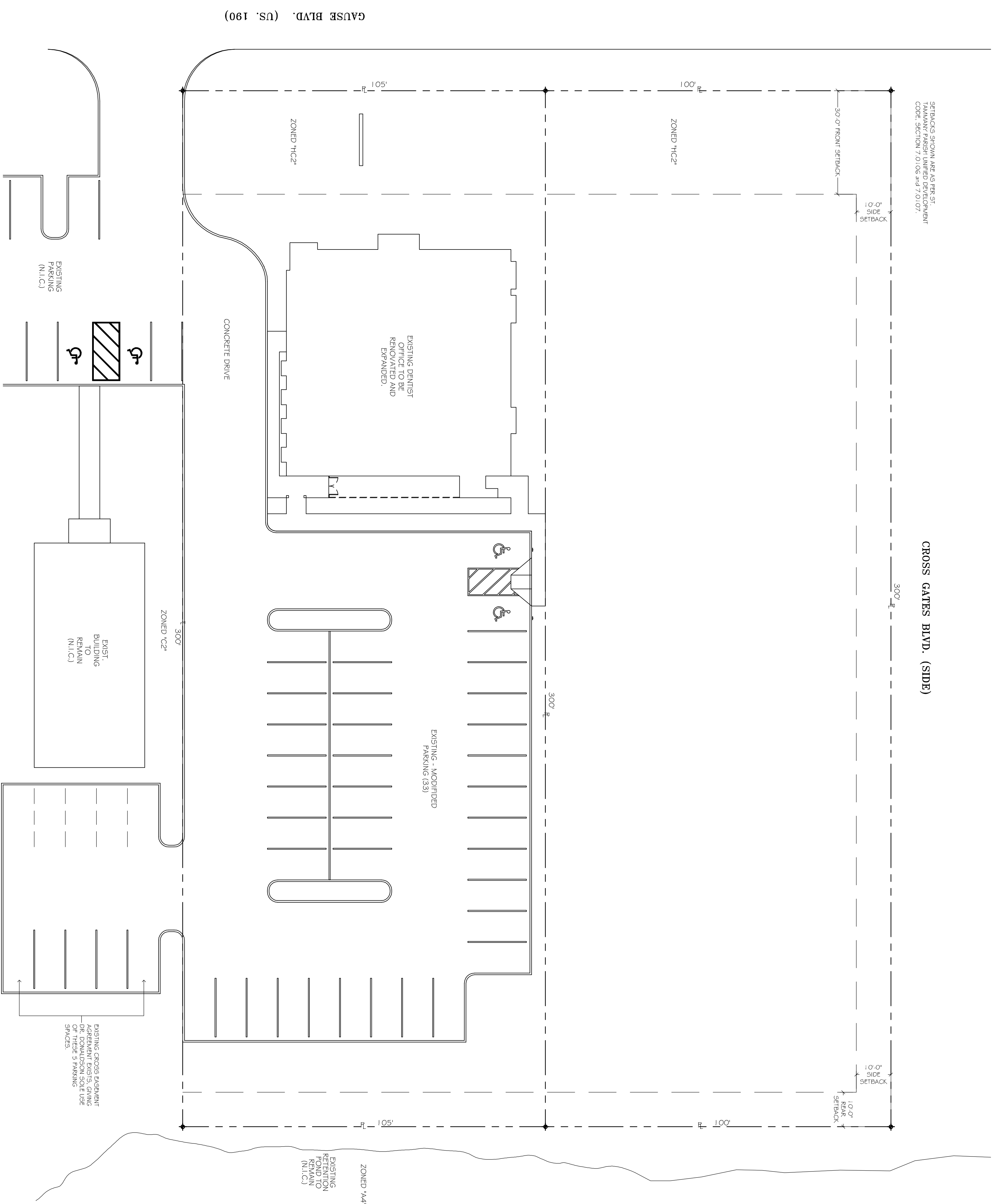

1. EXISTING SITE PLAN

SCALE: 1/16" = 1'-0"
THIS SITE PLAN DRAWING IS BASED ON A SURVEY BY:
J. V. BURKES



Project 3312
date 2/22/13
revisions

Piazza Architecture Planning APAC
Mandeville Louisiana

P.A.P. © 2013

RENOVATIONS and ADDITIONS TO:
~ BIPPO'S PLACE FOR SMILES ~
2960 GAUSE BOULEVARD EAST
SLIDELL • LOUISIANA