

SPACES SHOWN ARE PER SETBACK SECTION 7.01.06 AND 7.01.07.

**CROSS GATES BLVD. (SIDE)**

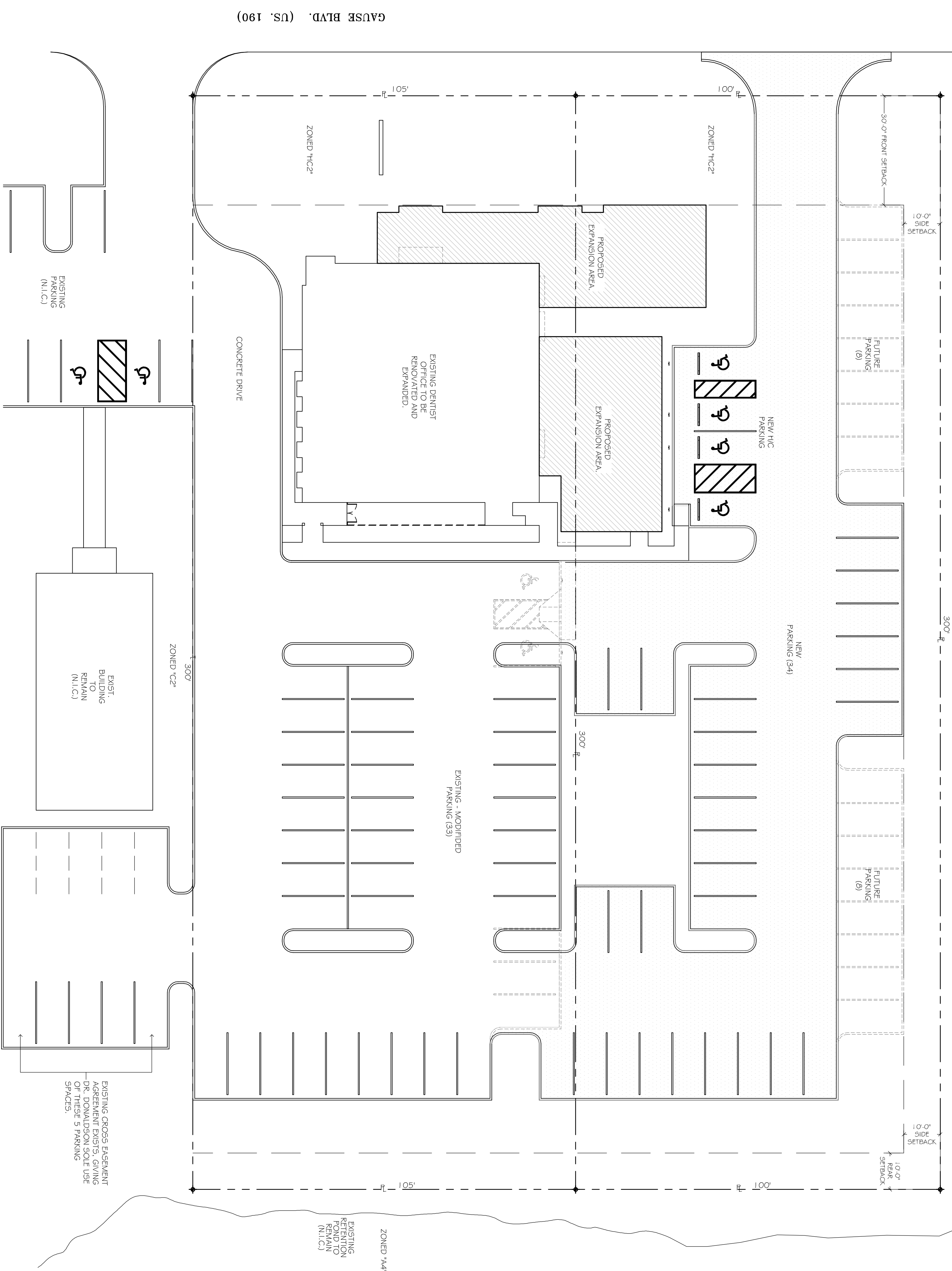

**PROPOSED SITE PLAN**

SCALE: 1/16" = 1'-0"  
THIS SITE PLAN DRAWING IS BASED ON A SURVEY BY:  
J. V. BURKES



**SITE INFORMATION:**  
EXISTING SITE IS AN EXISTING DENTAL OFFICE CLINIC THAT IS TO BE RENOVATED AND EXPANDED.  
EXISTING SITE IS ZONED HC-2 - HIGHWAY COMMERCIAL DISTRICT.  
EXISTING BUILDING IS A TWO STORY BUILDING.  
FIRST FLOOR IS THE DENTAL CLINIC.  
SECOND FLOOR IS THE OFFICES FOR THE DENTISTS, AND THE BREAK ROOM.  
PROPOSED RENOVATION AND EXPANSION IS AT THE FIRST FLOOR ONLY.  
SETBACKS SHOWN ARE THE CURRENT LANDSCAPE/REBUILDING SETBACKS.

**PARKING INFORMATION:**

PER SECTION 7.0704, PARKING SPACES REQUIRED SHALL BE BASED ON:

FLOOR	USE	REQUIREMENT	PROVIDED
FIRST FLOOR (7,352 SQ. FT.)	1 PER RATER	175 SQ. FT.	46 SPACES
	1 PER DOCTOR	3 FLOOR	03 SPACES
	2 FOR EVERY 3 EMPLOYEES	21 EMPLOYEES	14 SPACES
	PROFESSIONAL OFFICES		
SECOND FLOOR (1,191 SQ. FT.)	1 PER EVERY 350 SQ. FT.	1,191 / 350	04 SPACES
<b>PARKING SPACES REQUIRED:</b>			<b>67 SPACES</b>
<b>PARKING SPACES PROVIDED:</b>			<b>72 SPACES</b>

Project 3312  
date 2/22/13  
revisions



P.A.P. © 2013

**RENOVATIONS and ADDITIONS TO:**  
**BIPPO'S PLACE FOR SMILES**  
2960 GAUSE BOULEVARD EAST  
SLIDELL • LOUISIANA