

FIRST FLOOR PLAN  
SCALE: 1/8" = 1'-0"

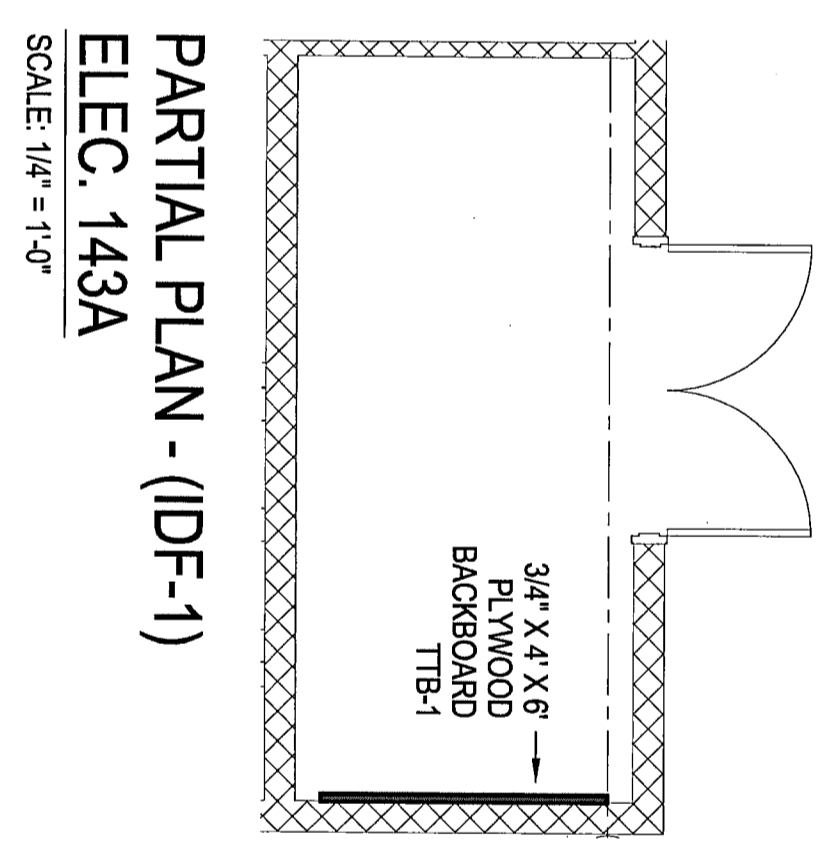

PARTIAL PLAN - (IDF-1)  
ELEC. 143A  
SCALE: 1/4" = 1'-0"

- KEYED PLAN NOTES:**
- 1 FOR SHARBOARD, SEE DETAIL ON DRAWING SHEET E3.1.
  - 2 TERMINATE TELEPHONE DROPS AND INTERCOM AT PUNCH BLOCKS TTB#1, 1ST FLOOR IDF-1 (ELEC. 143A)
  - 3 WIREBOLD ON UNDERBARGE OF COMPUTER DESK WITH ISOLATED GROUND RECEPTILES IN ROUNDCORNER CHANNEL RUN IN COMMUNICATIONS CHANNEL. SEE DETAIL ON DRAWING SHEET E3.1.
  - 4 SPECIAL SYSTEM WIRE BASKET TYPE CABLE TRAY.
  - 5 FIRE RATED PATHWAY SYSTEM, WALL MOUNT ABOVE CEILING. E2-PATH #E2DP4333K.

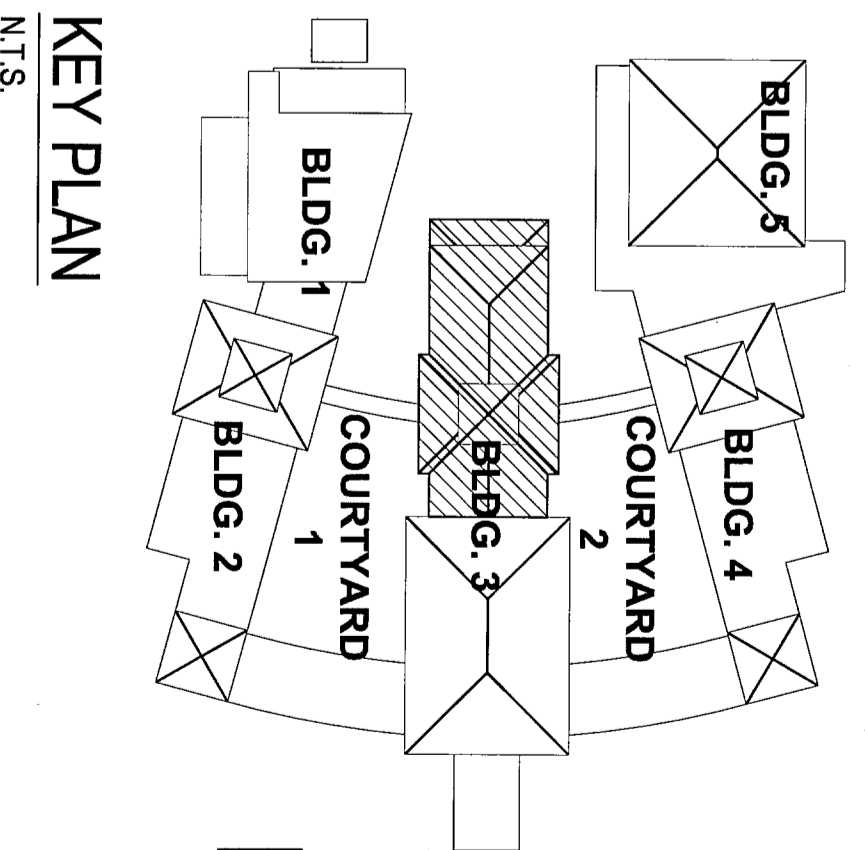

KEY PLAN  
N.T.S.

REVISION		
No.	DATE	DESCRIPTION

**LACHIN ♦ OUBRE & Associates**  
 ARCHITECTS PLANNERS  
 PROJECT MANAGERS  
 A PROFESSIONAL CORPORATION  
 3000 West Esplanade Ave., Suite 302, Metairie, LA 70002  
 Ph: 504-835-8013 Fax: 504-835-8034

**ST. BERNARD PARISH SCHOOL BOARD  
 CHALMETTE ELEMENTARY SCHOOL**  
 75 WEST CHALMETTE CIRCLE  
 CHALMETTE, LOUISIANA

PROJECT: 1ST FLOOR - BLDG. 3  
 SPECIAL SYSTEMS  
 DRAWN BY: [Name]  
 CHECKED BY: [Name]  
 DATE: 04/10/09  
 SHEET NO.: E3.2  
 OF [Total] SHEETS  
 DESIGNED BY: [Name]  
 DATE: 04/10/09  
 SHEET NO.: E3.2  
 OF [Total] SHEETS

**S&E Klingemann**  
 1877 Government Ave.  
 7000 Lakeshore Blvd.  
 Springfield, Louisiana 71154  
 Phone: (504) 979-6109  
 Fax: (504) 979-6109  
 www.sekling.com