

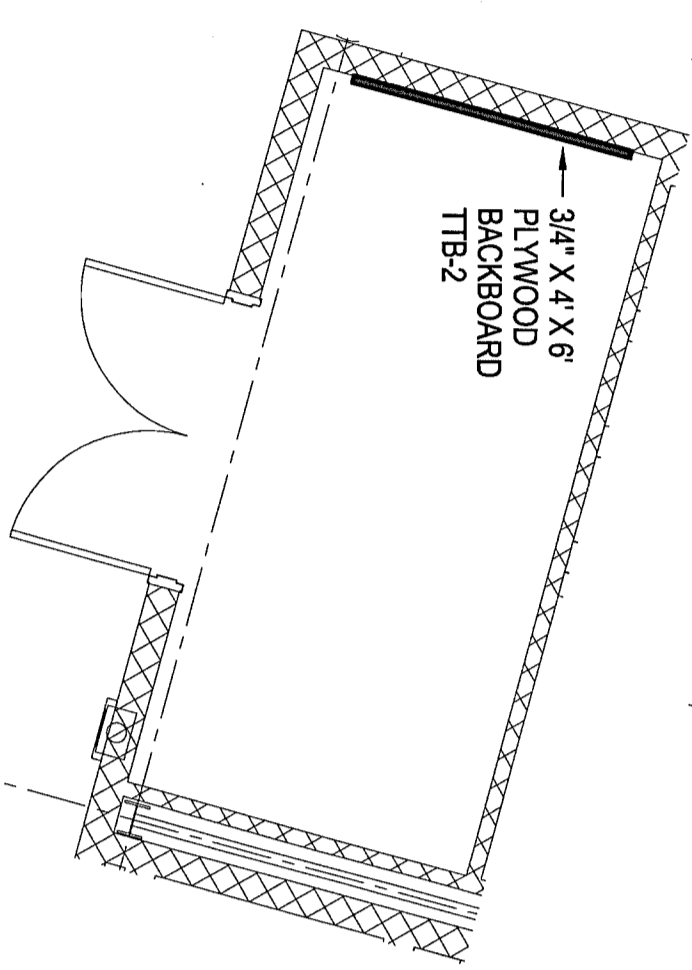

FIRST FLOOR PLAN
SCALE: 1/8" = 1'-0"



PARTIAL PLAN - (IDF-2)
ELEC. 215F
SCALE: 1/4" = 1'-0"



- KEYED PLAN NOTES:**
- 1 FOR SMARTBOARD, SEE DETAIL ON DRAWING SHEET E3.1.
 - 2 TERMINATE TELEPHONE DROPS AND INTERCOM AT PUNCH BLOCKS TTB-42, 1ST FLOOR IDF-2 (ELEC. 215A)
 - 3 WIREBOUND OR UNDERDESK OR COMPUTER DESK WITH ISOLATED GROUND RECEPTACLES IN ROOMS AND COMMUNICATIONS CHANNLES. SEE DETAIL ON DRAWING SHEET E3.1.
 - 4 SPECIAL SYSTEM WIRE BASKET TYPE CABLE TRAY. CABLE OPT. OF 94 SERIES OR EQUAL.
 - 5 FIRE RATED PATHWAY SYSTEM, WALL MOUNT ABOVE CEILING. EZ-PATH #E2PR4336K.

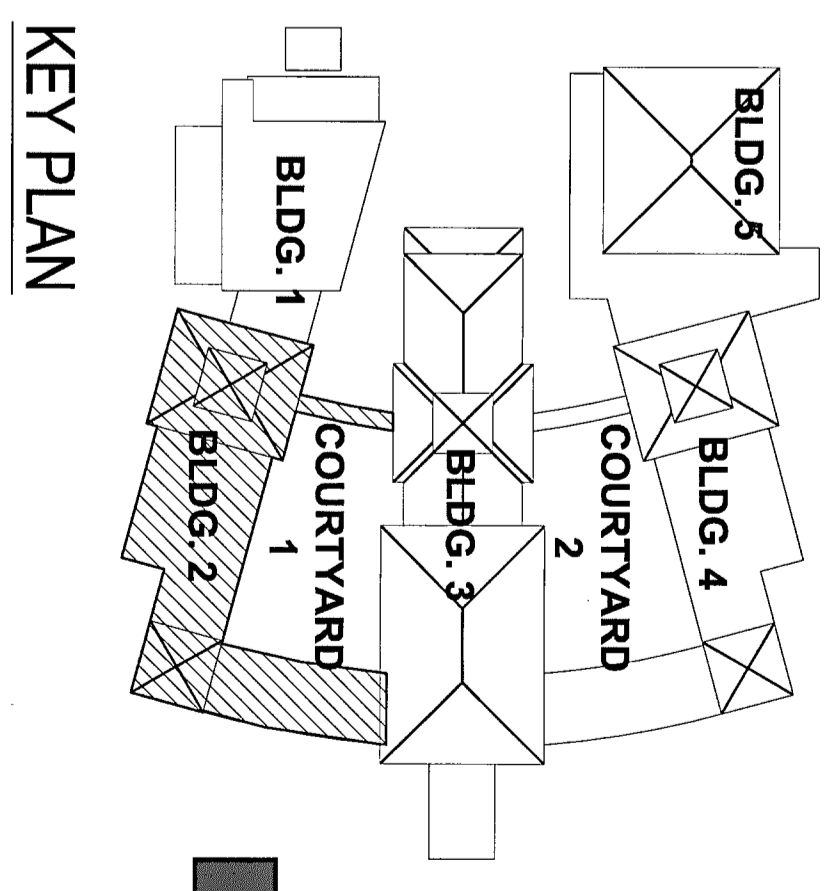

KEY PLAN
N.T.S.

REVISION	
No.	DESCRIPTION
04/10/2009	REV/PERMIT SUBMISSION

LACHIN ♦ OUBRE & Associates
ARCHITECTS PLANNERS
PROJECT MANAGERS
A PROFESSIONAL CORPORATION
3000 West Esplanade Ave., Suite 302, Metairie, LA. 70002
Ph: 504-835-8013 Fax: 504-835-8034

**ST. BERNARD PARISH SCHOOL BOARD
CHALMETTE ELEMENTARY SCHOOL**
75 WEST CHALMETTE CIRCLE
CHALMETTE, LOUISIANA

E3.4
SHEET
1ST FLR - BLDG. 2
SPECIAL SYSTEMS
DATE: 04/10/09
DRAWN BY: [Name]
CHECK BY: [Name]
SHEET NO.: 8 OF 8

SSE KINGENANN
SSE Engineering, Inc.
6005 Broadmoor Road
Springfield, Virginia 22154
Phone: (703) 979-6100
Fax: (703) 979-6101
www.sse.com