

- NOTES
1. ALL WORK SHALL BE IN ACCORDANCE WITH THE CITY OF SLIDELL SPECIFICATIONS AND STANDARDS.
  2. ALL TRENCHES SHALL BE PROTECTED BY STEEL CURBS (NEW OR EXISTING) WITH A MINIMUM OF 11.5" ON WORK.
  3. ALL TRENCHES SHALL BE PROTECTED BY STEEL CURBS (NEW OR EXISTING) WITH A MINIMUM OF 11.5" ON WORK.
  4. ALL TRENCHES SHALL BE PROTECTED BY STEEL CURBS (NEW OR EXISTING) WITH A MINIMUM OF 11.5" ON WORK.
  5. ALL TRENCHES SHALL BE PROTECTED BY STEEL CURBS (NEW OR EXISTING) WITH A MINIMUM OF 11.5" ON WORK.
  6. ALL TRENCHES SHALL BE PROTECTED BY STEEL CURBS (NEW OR EXISTING) WITH A MINIMUM OF 11.5" ON WORK.
  7. ALL TRENCHES SHALL BE PROTECTED BY STEEL CURBS (NEW OR EXISTING) WITH A MINIMUM OF 11.5" ON WORK.
  8. ALL TRENCHES SHALL BE PROTECTED BY STEEL CURBS (NEW OR EXISTING) WITH A MINIMUM OF 11.5" ON WORK.
  9. ALL TRENCHES SHALL BE PROTECTED BY STEEL CURBS (NEW OR EXISTING) WITH A MINIMUM OF 11.5" ON WORK.
  10. ALL TRENCHES SHALL BE PROTECTED BY STEEL CURBS (NEW OR EXISTING) WITH A MINIMUM OF 11.5" ON WORK.
  11. ALL TRENCHES SHALL BE PROTECTED BY STEEL CURBS (NEW OR EXISTING) WITH A MINIMUM OF 11.5" ON WORK.
  12. ALL TRENCHES SHALL BE PROTECTED BY STEEL CURBS (NEW OR EXISTING) WITH A MINIMUM OF 11.5" ON WORK.
  13. ALL TRENCHES SHALL BE PROTECTED BY STEEL CURBS (NEW OR EXISTING) WITH A MINIMUM OF 11.5" ON WORK.
  14. ALL TRENCHES SHALL BE PROTECTED BY STEEL CURBS (NEW OR EXISTING) WITH A MINIMUM OF 11.5" ON WORK.

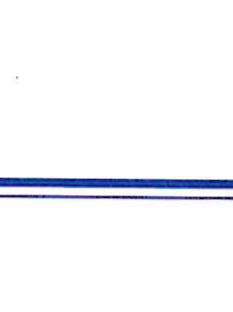
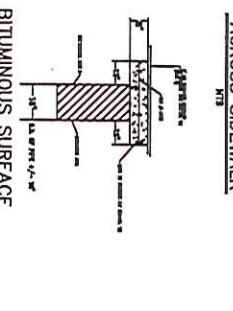
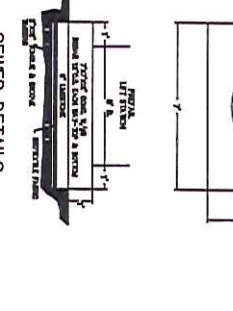
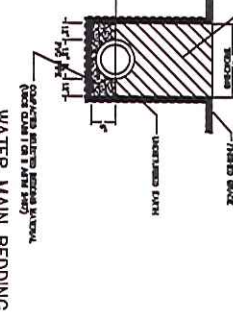
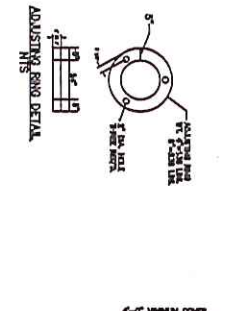
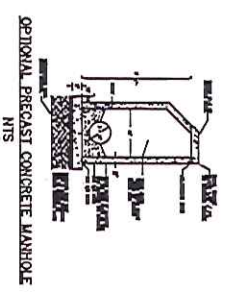
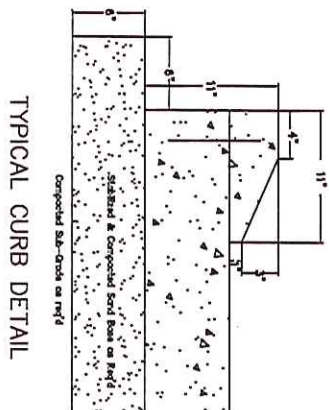
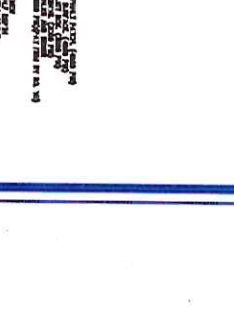
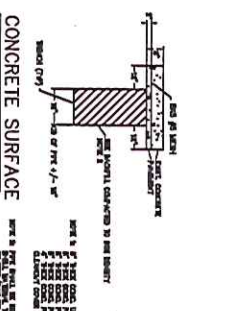
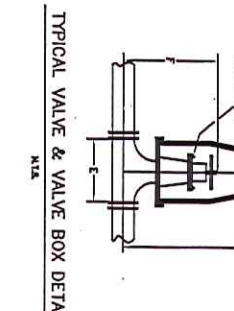
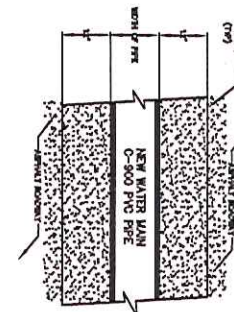
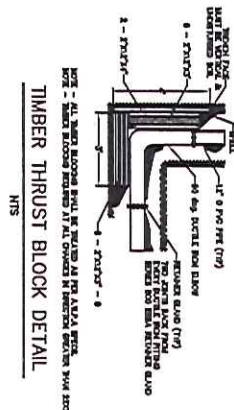
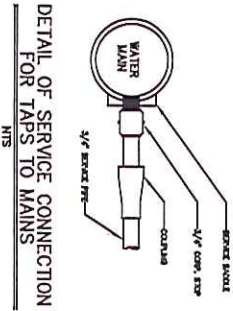

SCALE: 1" = NTS  
 DATE: 12/31/2013  
 DRAWN BY: JVB  
 CHECKED BY: JVB  
 DWG. NO: 20120461  
 SHEET 3 OF 4

I certify that this plat does represent an actual ground survey and that to the best of my knowledge no encroachments exist either across any of the property lines, except as shown. Encroachments shown hereon are not necessarily exclusive. Encroachments of record as shown on title opinion or title policy will be added hereto upon request, as surveyor has not performed any title search or abstract.

I have consulted the Flood Insurance Rate Maps and found this property is not in a Special Flood Hazard Area.

F.I.R.M.: 000000000000000  
 DATE: 00/00/0000  
 ZONE: Zone  
 B.F.E.: = EL

\* Verify prior to construction with local governing body.

SEWER AND WATER DETAILS  
 SLIDELL LITTLE THEATER  
 SECTION 11-9-14  
 LOCATED IN CITY OF SLIDELL  
 ST TAMMANY PARISH, LA

Declaration is made to original purchaser of the survey. It is not transferable to additional institutions or subsequent owners. Survey is void only if print has original seal of surveyor. Property is surveyed in accordance with the Louisiana "Minimum Standards for Property Boundary Surveys" for a Class C survey. Bearings are based on record bearings unless noted otherwise.

SLIDELL LITTLE THEATER

**J.V. Burkes & Associates, Inc.**  
 SURVEYING ENGINEERING • ENVIRONMENTAL

1805 Shortcut Highway  
 Slidell, Louisiana 70458  
 E-mail: jvbossc@jvburkes.com

Phone: 985-649-0075 Fax: 985-649-0154  
 Mississippi Phone: 228-435-5800

STATE OF LOUISIANA  
 J.V. BURKES III  
 REG. NO. 6997  
 PROFESSIONAL ENGINEER  
 CIVIL ENGINEER

J.V. BURKES  
 LA REG. NO. 6997

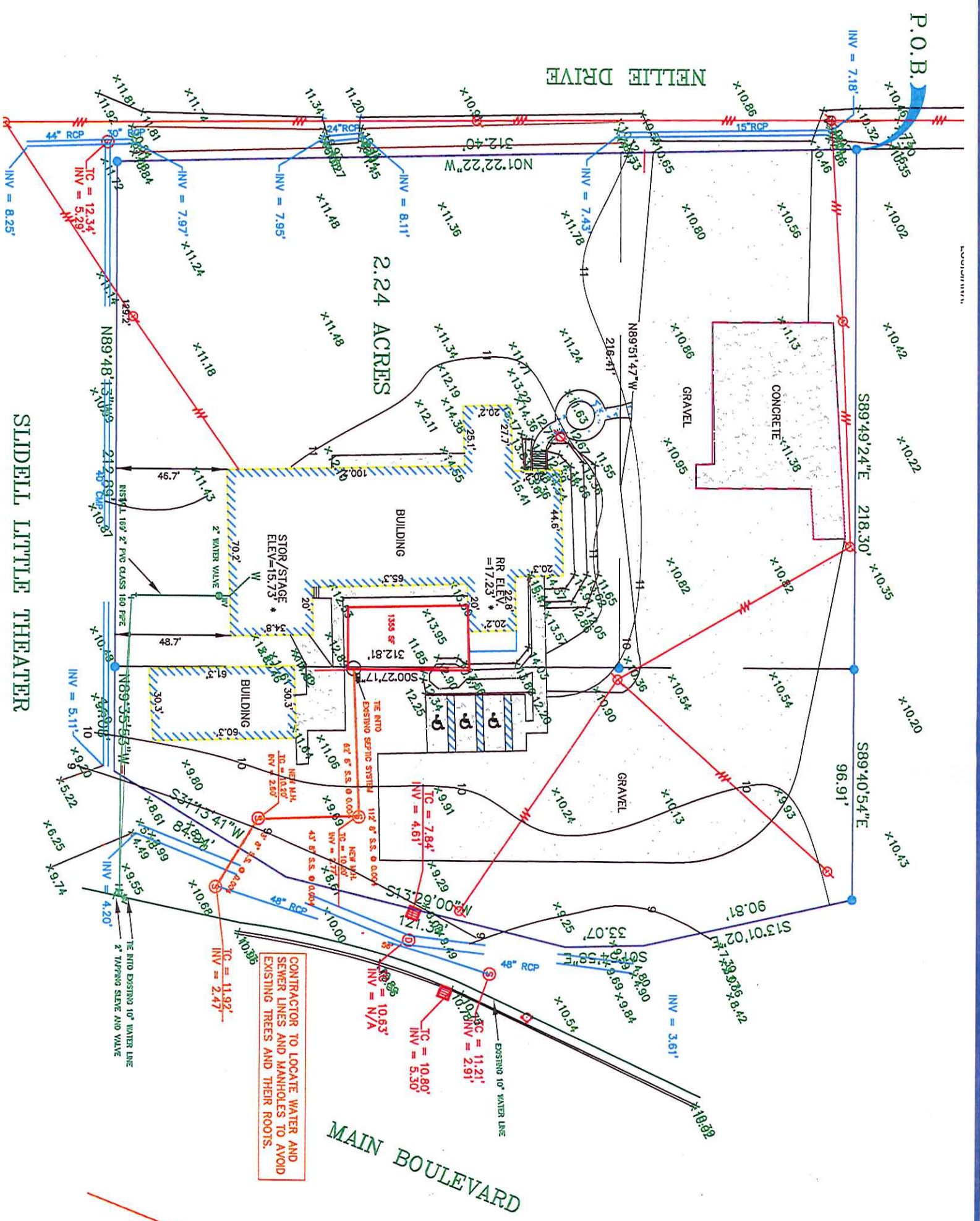

CONTRACTOR TO LOCATE WATER AND SEWER LINES AND MANHOLES TO AVOID EXISTING TREES AND THEIR ROOTS.

**SLIDELL LITTLE THEATER**

**SEWER AND WATER PLAN**  
**SLIDELL LITTLE THEATER**  
 SECTION 11-9-14  
 LOCATED IN CITY OF SLIDELL  
 ST. TAMMANY PARISH, LA.



SCALE: 1"=50'  
 DATE: 12/31/2013  
 DRAWN BY: JVB CHECKED BY: JVB  
 DWG. NO.: 20120461  
 SHEET 4 OF 4

I certify that this plot does represent an actual ground survey and that to the best of my knowledge no encroachments exist either way across any of the property lines, except as shown. Encroachments shown hereon are not necessarily exclusive. Encroachments of record as shown on title opinion or title policy will be added hereon upon request, as surveyor has not performed any title search or abstract.

I have consulted the Flood Insurance Rate Maps and found this property is not in a Special Flood Hazard Area.

F.I.R.M. DATE: ZONE: B.F.E. =

• Verify prior to construction with local governing body.

Declaration is made to original purchaser of the survey. It is not transferable to additional institutions or subsequent owners. Survey is valid only if print has original seal of surveyor. Property is surveyed in accordance with the Louisiana "Minimum Standards for Property Boundary Surveys" for a Class C survey. Bearings are based on record bearings unless noted otherwise.

**J.V. Burkes & Associates, Inc.**  
 SURVEYING ENGINEERING • ENVIRONMENTAL

1805 Shortcut Highway  
 Slidell, Louisiana 70458  
 E-mail: jvb@jvburkes.com

Phone: 985-649-0075 Fax: 985-649-0154  
 Mississippi Phone: 228-435-5800

