

SPRINKLER RISER HOUSING POSITION WILL VARY. LOCATE PER SITE WATER PLAN (C-5)

SPRINKLER RISER HOUSING POSITION WILL VARY. LOCATE PER SITE WATER PLAN (C-5)

51'-0" 1 HR. FIREWALL - APPLIES TO BLDG. #4 ONLY

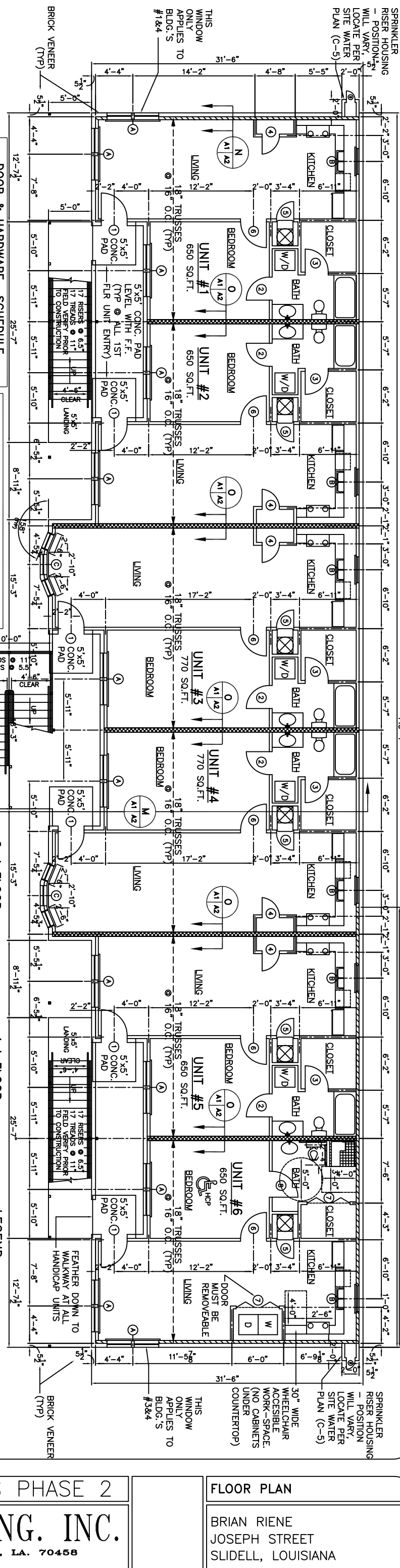

**DOOR & HARDWARE SCHEDULE**

TYPE	FRAME	FINISH	USE	ACCESSORIES	REMARKS
1	HOLLOW WOOD	ALUM/BLADE	STAIR	NO	
2	HOLLOW WOOD	WOOD	INT.	NO	
3	HOLLOW WOOD	WOOD	INT.	NO	
4	HOLLOW WOOD	WOOD	INT.	NO	
5	HOLLOW WOOD	WOOD	INT.	NO	
6	HOLLOW WOOD	WOOD	INT.	NO	
7	HOLLOW WOOD	WOOD	INT.	NO	
8	HOLLOW WOOD	WOOD	INT.	NO	
9	HOLLOW WOOD	WOOD	INT.	NO	
10	HOLLOW WOOD	WOOD	INT.	NO	
11	HOLLOW WOOD	WOOD	INT.	NO	
12	HOLLOW WOOD	WOOD	INT.	NO	
13	HOLLOW WOOD	WOOD	INT.	NO	
14	HOLLOW WOOD	WOOD	INT.	NO	
15	HOLLOW WOOD	WOOD	INT.	NO	
16	HOLLOW WOOD	WOOD	INT.	NO	
17	HOLLOW WOOD	WOOD	INT.	NO	
18	HOLLOW WOOD	WOOD	INT.	NO	
19	HOLLOW WOOD	WOOD	INT.	NO	
20	HOLLOW WOOD	WOOD	INT.	NO	
21	HOLLOW WOOD	WOOD	INT.	NO	
22	HOLLOW WOOD	WOOD	INT.	NO	
23	HOLLOW WOOD	WOOD	INT.	NO	
24	HOLLOW WOOD	WOOD	INT.	NO	
25	HOLLOW WOOD	WOOD	INT.	NO	
26	HOLLOW WOOD	WOOD	INT.	NO	
27	HOLLOW WOOD	WOOD	INT.	NO	
28	HOLLOW WOOD	WOOD	INT.	NO	
29	HOLLOW WOOD	WOOD	INT.	NO	
30	HOLLOW WOOD	WOOD	INT.	NO	
31	HOLLOW WOOD	WOOD	INT.	NO	
32	HOLLOW WOOD	WOOD	INT.	NO	
33	HOLLOW WOOD	WOOD	INT.	NO	
34	HOLLOW WOOD	WOOD	INT.	NO	
35	HOLLOW WOOD	WOOD	INT.	NO	
36	HOLLOW WOOD	WOOD	INT.	NO	
37	HOLLOW WOOD	WOOD	INT.	NO	
38	HOLLOW WOOD	WOOD	INT.	NO	
39	HOLLOW WOOD	WOOD	INT.	NO	
40	HOLLOW WOOD	WOOD	INT.	NO	
41	HOLLOW WOOD	WOOD	INT.	NO	
42	HOLLOW WOOD	WOOD	INT.	NO	
43	HOLLOW WOOD	WOOD	INT.	NO	
44	HOLLOW WOOD	WOOD	INT.	NO	
45	HOLLOW WOOD	WOOD	INT.	NO	
46	HOLLOW WOOD	WOOD	INT.	NO	
47	HOLLOW WOOD	WOOD	INT.	NO	
48	HOLLOW WOOD	WOOD	INT.	NO	
49	HOLLOW WOOD	WOOD	INT.	NO	
50	HOLLOW WOOD	WOOD	INT.	NO	
51	HOLLOW WOOD	WOOD	INT.	NO	
52	HOLLOW WOOD	WOOD	INT.	NO	
53	HOLLOW WOOD	WOOD	INT.	NO	
54	HOLLOW WOOD	WOOD	INT.	NO	
55	HOLLOW WOOD	WOOD	INT.	NO	
56	HOLLOW WOOD	WOOD	INT.	NO	
57	HOLLOW WOOD	WOOD	INT.	NO	
58	HOLLOW WOOD	WOOD	INT.	NO	
59	HOLLOW WOOD	WOOD	INT.	NO	
60	HOLLOW WOOD	WOOD	INT.	NO	
61	HOLLOW WOOD	WOOD	INT.	NO	
62	HOLLOW WOOD	WOOD	INT.	NO	
63	HOLLOW WOOD	WOOD	INT.	NO	
64	HOLLOW WOOD	WOOD	INT.	NO	
65	HOLLOW WOOD	WOOD	INT.	NO	
66	HOLLOW WOOD	WOOD	INT.	NO	
67	HOLLOW WOOD	WOOD	INT.	NO	
68	HOLLOW WOOD	WOOD	INT.	NO	
69	HOLLOW WOOD	WOOD	INT.	NO	
70	HOLLOW WOOD	WOOD	INT.	NO	
71	HOLLOW WOOD	WOOD	INT.	NO	
72	HOLLOW WOOD	WOOD	INT.	NO	
73	HOLLOW WOOD	WOOD	INT.	NO	
74	HOLLOW WOOD	WOOD	INT.	NO	
75	HOLLOW WOOD	WOOD	INT.	NO	
76	HOLLOW WOOD	WOOD	INT.	NO	
77	HOLLOW WOOD	WOOD	INT.	NO	
78	HOLLOW WOOD	WOOD	INT.	NO	
79	HOLLOW WOOD	WOOD	INT.	NO	
80	HOLLOW WOOD	WOOD	INT.	NO	
81	HOLLOW WOOD	WOOD	INT.	NO	
82	HOLLOW WOOD	WOOD	INT.	NO	
83	HOLLOW WOOD	WOOD	INT.	NO	
84	HOLLOW WOOD	WOOD	INT.	NO	
85	HOLLOW WOOD	WOOD	INT.	NO	
86	HOLLOW WOOD	WOOD	INT.	NO	
87	HOLLOW WOOD	WOOD	INT.	NO	
88	HOLLOW WOOD	WOOD	INT.	NO	
89	HOLLOW WOOD	WOOD	INT.	NO	
90	HOLLOW WOOD	WOOD	INT.	NO	
91	HOLLOW WOOD	WOOD	INT.	NO	
92	HOLLOW WOOD	WOOD	INT.	NO	
93	HOLLOW WOOD	WOOD	INT.	NO	
94	HOLLOW WOOD	WOOD	INT.	NO	
95	HOLLOW WOOD	WOOD	INT.	NO	
96	HOLLOW WOOD	WOOD	INT.	NO	
97	HOLLOW WOOD	WOOD	INT.	NO	
98	HOLLOW WOOD	WOOD	INT.	NO	
99	HOLLOW WOOD	WOOD	INT.	NO	
100	HOLLOW WOOD	WOOD	INT.	NO	

**WINDOW SCHEDULE**

TYPE	FRAME	GLASS	FINISH	ACCESSORIES	REMARKS
1	WOOD	DOUBLE GLAZED	WOOD	NO	
2	WOOD	DOUBLE GLAZED	WOOD	NO	
3	WOOD	DOUBLE GLAZED	WOOD	NO	
4	WOOD	DOUBLE GLAZED	WOOD	NO	
5	WOOD	DOUBLE GLAZED	WOOD	NO	
6	WOOD	DOUBLE GLAZED	WOOD	NO	
7	WOOD	DOUBLE GLAZED	WOOD	NO	
8	WOOD	DOUBLE GLAZED	WOOD	NO	
9	WOOD	DOUBLE GLAZED	WOOD	NO	
10	WOOD	DOUBLE GLAZED	WOOD	NO	
11	WOOD	DOUBLE GLAZED	WOOD	NO	
12	WOOD	DOUBLE GLAZED	WOOD	NO	
13	WOOD	DOUBLE GLAZED	WOOD	NO	
14	WOOD	DOUBLE GLAZED	WOOD	NO	
15	WOOD	DOUBLE GLAZED	WOOD	NO	
16	WOOD	DOUBLE GLAZED	WOOD	NO	
17	WOOD	DOUBLE GLAZED	WOOD	NO	
18	WOOD	DOUBLE GLAZED	WOOD	NO	
19	WOOD	DOUBLE GLAZED	WOOD	NO	
20	WOOD	DOUBLE GLAZED	WOOD	NO	
21	WOOD	DOUBLE GLAZED	WOOD	NO	
22	WOOD	DOUBLE GLAZED	WOOD	NO	
23	WOOD	DOUBLE GLAZED	WOOD	NO	
24	WOOD	DOUBLE GLAZED	WOOD	NO	
25	WOOD	DOUBLE GLAZED	WOOD	NO	
26	WOOD	DOUBLE GLAZED	WOOD	NO	
27	WOOD	DOUBLE GLAZED	WOOD	NO	
28	WOOD	DOUBLE GLAZED	WOOD	NO	
29	WOOD	DOUBLE GLAZED	WOOD	NO	
30	WOOD	DOUBLE GLAZED	WOOD	NO	
31	WOOD	DOUBLE GLAZED	WOOD	NO	
32	WOOD	DOUBLE GLAZED	WOOD	NO	
33	WOOD	DOUBLE GLAZED	WOOD	NO	
34	WOOD	DOUBLE GLAZED	WOOD	NO	
35	WOOD	DOUBLE GLAZED	WOOD	NO	
36	WOOD	DOUBLE GLAZED	WOOD	NO	
37	WOOD	DOUBLE GLAZED	WOOD	NO	
38	WOOD	DOUBLE GLAZED	WOOD	NO	
39	WOOD	DOUBLE GLAZED	WOOD	NO	
40	WOOD	DOUBLE GLAZED	WOOD	NO	
41	WOOD	DOUBLE GLAZED	WOOD	NO	
42	WOOD	DOUBLE GLAZED	WOOD	NO	
43	WOOD	DOUBLE GLAZED	WOOD	NO	
44	WOOD	DOUBLE GLAZED	WOOD	NO	
45	WOOD	DOUBLE GLAZED	WOOD	NO	
46	WOOD	DOUBLE GLAZED	WOOD	NO	
47	WOOD	DOUBLE GLAZED	WOOD	NO	
48	WOOD	DOUBLE GLAZED	WOOD	NO	
49	WOOD	DOUBLE GLAZED	WOOD	NO	
50	WOOD	DOUBLE GLAZED	WOOD	NO	
51	WOOD	DOUBLE GLAZED	WOOD	NO	
52	WOOD	DOUBLE GLAZED	WOOD	NO	
53	WOOD	DOUBLE GLAZED	WOOD	NO	
54	WOOD	DOUBLE GLAZED	WOOD	NO	
55	WOOD	DOUBLE GLAZED	WOOD	NO	
56	WOOD	DOUBLE GLAZED	WOOD	NO	
57	WOOD	DOUBLE GLAZED	WOOD	NO	
58	WOOD	DOUBLE GLAZED	WOOD	NO	
59	WOOD	DOUBLE GLAZED	WOOD	NO	
60	WOOD	DOUBLE GLAZED	WOOD	NO	
61	WOOD	DOUBLE GLAZED	WOOD	NO	
62	WOOD	DOUBLE GLAZED	WOOD	NO	
63	WOOD	DOUBLE GLAZED	WOOD	NO	
64	WOOD	DOUBLE GLAZED	WOOD	NO	
65	WOOD	DOUBLE GLAZED	WOOD	NO	
66	WOOD	DOUBLE GLAZED	WOOD	NO	
67	WOOD	DOUBLE GLAZED	WOOD	NO	
68	WOOD	DOUBLE GLAZED	WOOD	NO	
69	WOOD	DOUBLE GLAZED	WOOD	NO	
70	WOOD	DOUBLE GLAZED	WOOD	NO	
71	WOOD	DOUBLE GLAZED	WOOD	NO	
72	WOOD	DOUBLE GLAZED	WOOD	NO	
73	WOOD	DOUBLE GLAZED	WOOD	NO	
74	WOOD	DOUBLE GLAZED	WOOD	NO	
75	WOOD	DOUBLE GLAZED	WOOD	NO	
76	WOOD	DOUBLE GLAZED	WOOD	NO	
77	WOOD	DOUBLE GLAZED	WOOD	NO	
78	WOOD	DOUBLE GLAZED	WOOD	NO	
79	WOOD	DOUBLE GLAZED	WOOD	NO	
80	WOOD	DOUBLE GLAZED	WOOD	NO	
81	WOOD	DOUBLE GLAZED	WOOD	NO	
82	WOOD	DOUBLE GLAZED	WOOD	NO	
83	WOOD	DOUBLE GLAZED	WOOD	NO	
84	WOOD	DOUBLE GLAZED	WOOD	NO	
85	WOOD	DOUBLE GLAZED	WOOD	NO	
86	WOOD	DOUBLE GLAZED	WOOD	NO	
87	WOOD	DOUBLE GLAZED	WOOD	NO	
88	WOOD	DOUBLE GLAZED	WOOD	NO	
89	WOOD	DOUBLE GLAZED	WOOD	NO	
90	WOOD	DOUBLE GLAZED	WOOD	NO	
91	WOOD	DOUBLE GLAZED	WOOD	NO	
92	WOOD	DOUBLE GLAZED	WOOD	NO	
93	WOOD	DOUBLE GLAZED	WOOD	NO	
94	WOOD	DOUBLE GLAZED	WOOD	NO	
95	WOOD	DOUBLE GLAZED	WOOD	NO	
96	WOOD	DOUBLE GLAZED	WOOD	NO	
97	WOOD	DOUBLE GLAZED	WOOD	NO	
98	WOOD	DOUBLE GLAZED	WOOD	NO	
99	WOOD	DOUBLE GLAZED	WOOD	NO	
100	WOOD	DOUBLE GLAZED	WOOD	NO	

**2nd FLOOR**

UNIT #7	650 SQ. FT.
UNIT #8	650 SQ. FT.
UNIT #9	770 SQ. FT.
UNIT #10	770 SQ. FT.
UNIT #11	650 SQ. FT.
UNIT #12	650 SQ. FT.
<b>TOTAL SECOND FLOOR</b>	<b>4,140 SQ. FT.</b>
<b>TOTAL FIRST FLOOR</b>	<b>4,140 SQ. FT.</b>
<b>TOTAL (INHABITABLE SPACE)</b>	<b>8,280 SQ. FT.</b>

**1st FLOOR**

UNIT #1	650 SQ. FT.
UNIT #2	650 SQ. FT.
UNIT #3	770 SQ. FT.
UNIT #4	770 SQ. FT.
UNIT #5	650 SQ. FT.
UNIT #6	650 SQ. FT.
<b>TOTAL FIRST FLOOR</b>	<b>4,140 SQ. FT.</b>

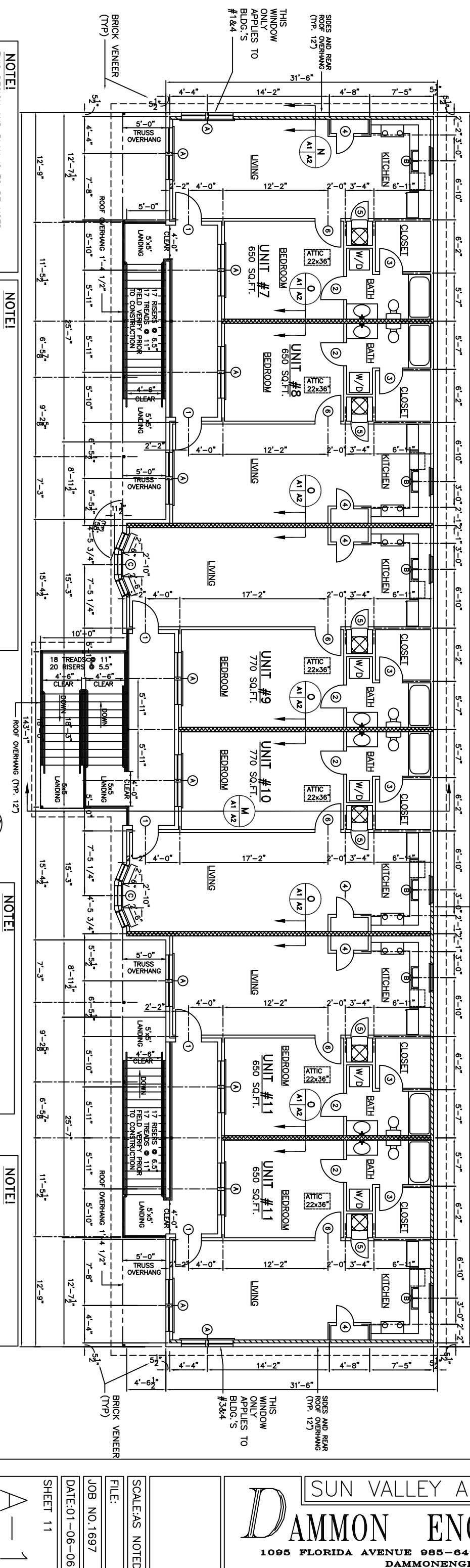

**NOTE!**  
THIS DESIGN AND PLAN IS TO BE USED (TYPICALLY) FOR BUILDINGS 1-4 AS INDICATED ON THE SITE PLAN. (SHEET C-1)

**NOTE!**  
1 HR FIRE RATED ENDWALL IS NOT REQUIRED AT THE WEST WALL OF BLDG. #1, THE EAST WALL OF BLDG. #3, AND EAST AND WEST WALLS OF BLDG. #4 (SEE SHEET C-1 FOR BLDG. LOCATIONS)

**NOTE!**  
ALL BUILDINGS SHALL BE PROVIDED WITH AN AUTOMATIC SPRINKLER SYSTEM INSTALLED IN ACCORDANCE WITH IBC 903.3

**NOTE!**  
ALL INTERIOR PARTITION WALLS SHALL EXTEND TIGHT TO ROOF AND TIGHT TO ROOF EAVE WITHIN ATTIC SPACE.

REVISIONS: 15-10-06

**SUN VALLEY APARTMENTS PHASE 2**

**DAMMON ENGINEERING, INC.**

1095 FLORIDA AVENUE 985-649-5832 SLIDELL, LA. 70458  
DAMMONENGINEERING.COM

**FLOOR PLAN**  
BRIAN RIENE  
JOSEPH STREET  
SLIDELL, LOUISIANA

FILE: SCALE: AS NOTED  
JOB NO. 1697  
DATE: 01-06-06  
SHEET 11 OF 28