

**REFLECTED CEILING PLAN**  
SCALE: 3/16"=1'-0"

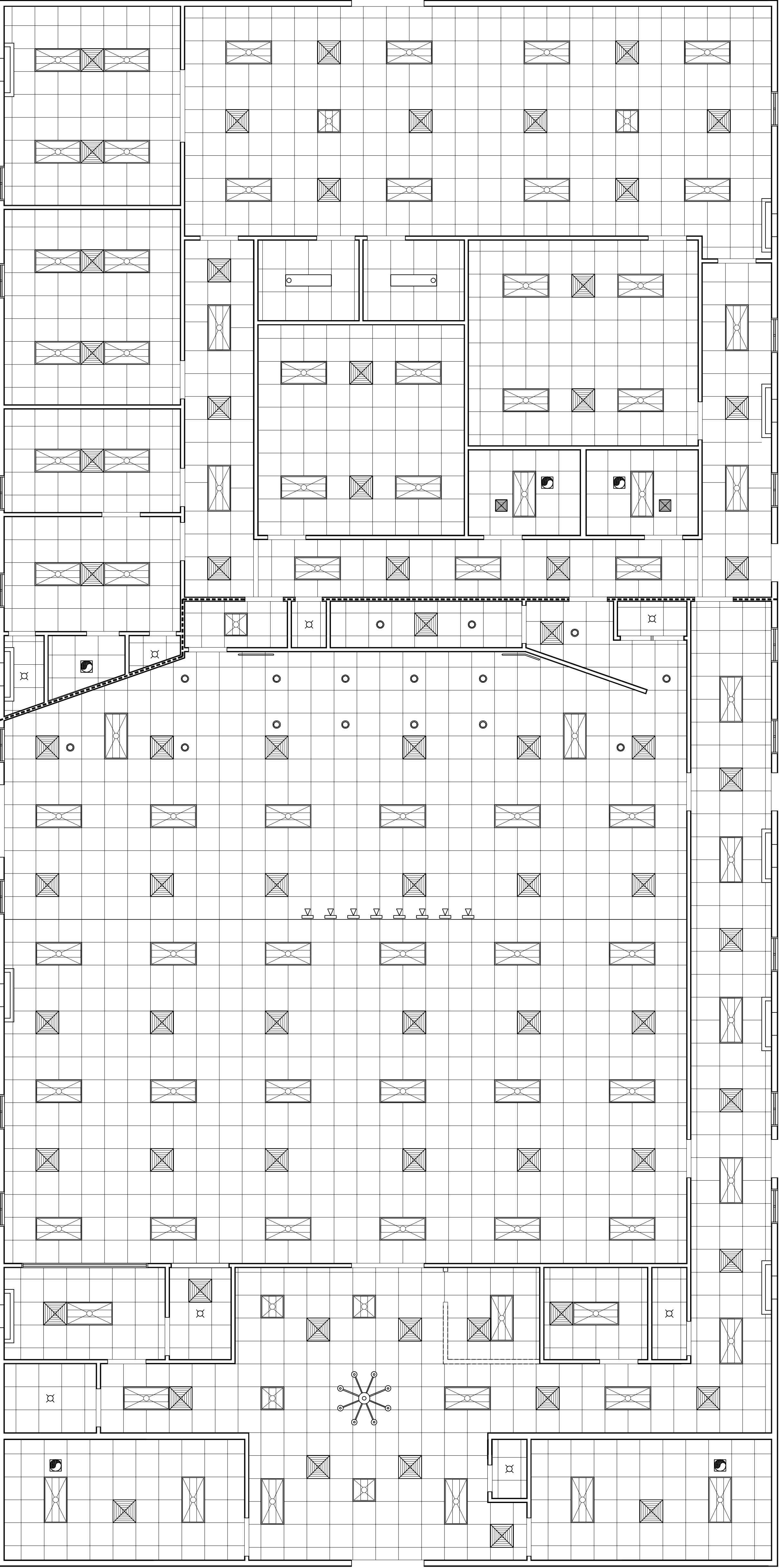

**GENERAL NOTES**

ALL CEILING HEIGHTS INDICATED ARE APPROXIMATE. ACTUAL CEILING HEIGHTS MAY VARY DUE TO CONSTRUCTION VARIATIONS AND CEILING ASSEMBLY. THE NUMBER OF SUSPENDED STRIP LIGHTS SHALL NOT EXCEED A CEILING HEIGHT LESS THAN 7'-6" (PER IBC 1209.2).

**RCP LEGEND**

SYMBOL/SYMBOL	DESCRIPTION
	2x4 SUSPENDED FLUORESCENT LIGHT FIXTURE
	2x2 SUSPENDED FLUORESCENT LIGHT FIXTURE
	DIRECTIONAL FLOOD LIGHT FIXTURE
	SURFACE MOUNTED FLUORESCENT STRIP LIGHT FIXTURE
	PENDANT LIGHT FIXTURE
	RECESSED CAN LIGHT FIXTURE
	SURFACE MOUNTED LIGHT FIXTURE
	EXHAUST FAN
	HVAC SUPPLY AIR DIFFUSER
	CHANDELIER

**DAMMON ENGINEERING, INC.**  
LOUISIANA & MISSISSIPPI

Chief Engineer: Brian Mistich, PE  
554 Old Spanish Trail  
Slidell, LA 70458

www.dammonengineering.com  
info@dammonengineering.com  
PH: 985.649.5832 F: 985.641.5950

REVISIONS	
#	DESCRIPTION



**CHRISTIAN LOVE CHURCH**

3770 LEGGETT ROAD  
SLIDELL, LA 70460

JOB No: 2295 DATE: 9/15/2017

DRAWN BY: KHM CHECKED BY: JMS

The above drawings are graphical design, copyright and engineering documents. They may not be used, copied, reproduced, or otherwise disseminated without the written consent of Dammon Engineering, Inc. Any unauthorized use of these drawings shall constitute a violation of applicable laws and regulations.

SHEET TITLE:  
**REFLECTED CEILING PLAN**

DRAWING NUMBER:  
**A104**

SHEET No. 10 of 15