

1 SITE PLAN  
SCALE: 1" = 30'

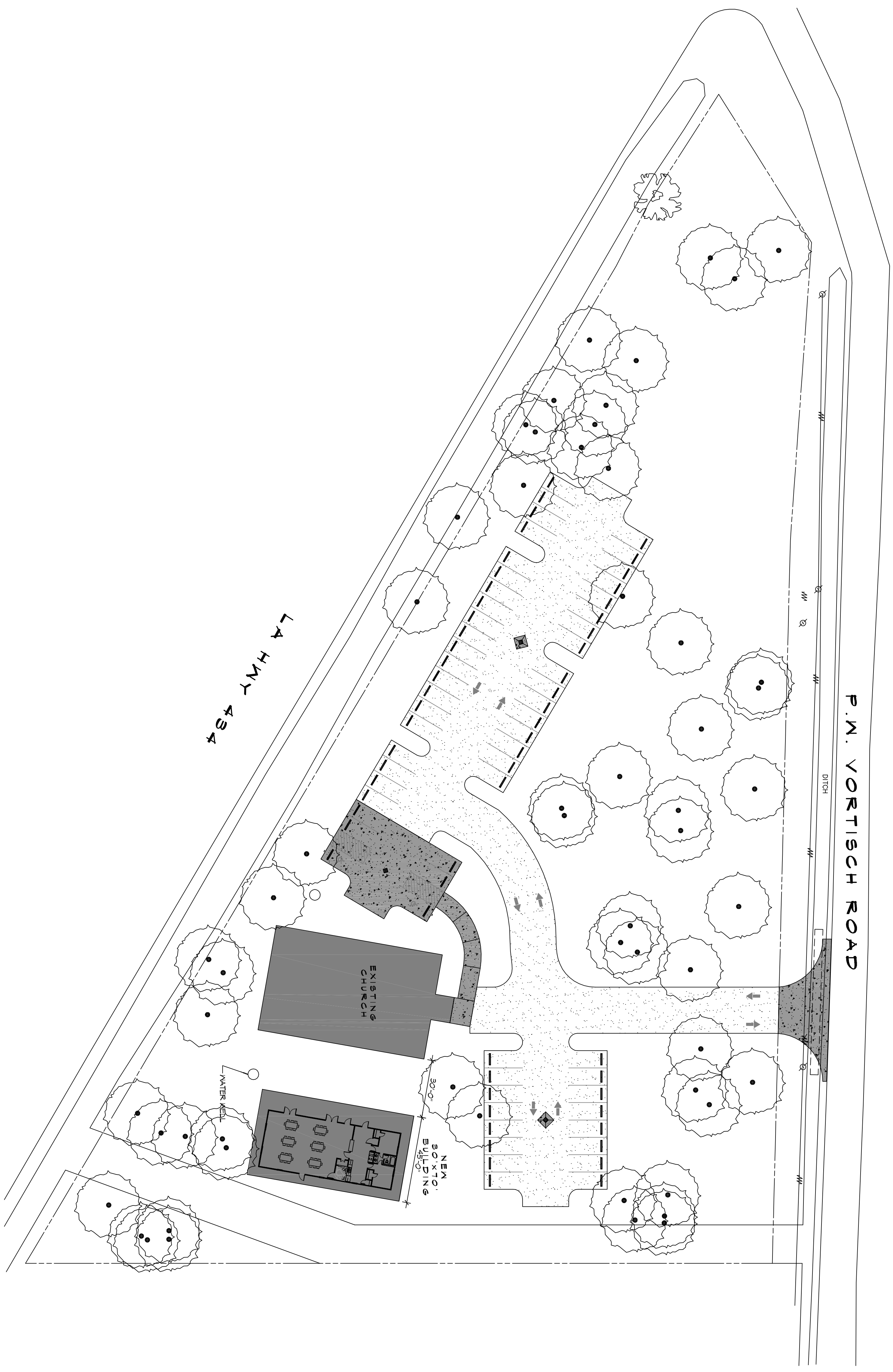

SHEET NO. 1 OF 3  
**C101**  
DRAWING NUMBER:

SHEET TITLE:  
SITE PLAN

**PRO MULTIS  
LACOMBE CHAPEL**  
P.M. VORTISCH ROAD AND LA HWY 434  
LACOMBE, LOUISIANA 70445  
JOB No: 2354 DATE: 12-19-18  
DRAWN BY: CKD CHECKED BY: CKD

The above drawings, specifications, designs and all engineering representations hereby are made and issued for the project of Dammon Engineering, Inc. and shall remain the property of Dammon Engineering, Inc. and shall not be used for any other project or purpose without the written consent of Dammon Engineering, Inc. If you are not the intended recipient of this drawing, you should not disseminate, distribute or copy this drawing. If you have received this drawing by mistake, please notify the sender immediately by e-mail at [info@dammonengineering.com](mailto:info@dammonengineering.com). Your cooperation in maintaining the integrity of this information is appreciated.

#	DESCRIPTION	REVISIONS	
		DATE	

**DAMMON**  
ENGINEERING, INC.  
LOUISIANA & MISSISSIPPI

Chief Engineer: Brian Mstich, PE  
554 Old Spanish Trail  
Slidell, LA 70458

[www.dammonengineering.com](http://www.dammonengineering.com)  
[info@dammonengineering.com](mailto:info@dammonengineering.com)  
PH: 985.649.5832