

DAMMON ENGINEERING, INC.

CHIEF ENGINEER
EMMETT DAMMON, P.E.
CHIEF ARCHITECT
ROBERT WILTSE

1095 FLORIDA AVENUE
SLIDELL, LA, 70456
OFFICE: 985-649-5332
FAX: 985-641-5950

WEBSITE:
WWW.DAMMONENGINEERING.COM
EMAIL:
DAMMONENG@BELLSOUTH.NET

ARCHITECTURE
ENGINEERING
STUDIES
PLANNING
INVESTIGATION
EXPERT WITNESS

NEW
PARKING
LOT

HONAKER
FUNERAL HOME
1751 GAUSE BLVD W,
SLIDELL, LA

PARTIAL
PAVING
PLAN

REV:	
SCALE:	AS NOTED
JOB#:	1999
DATE:	10-24-08
SHEET:	

C-4

OF

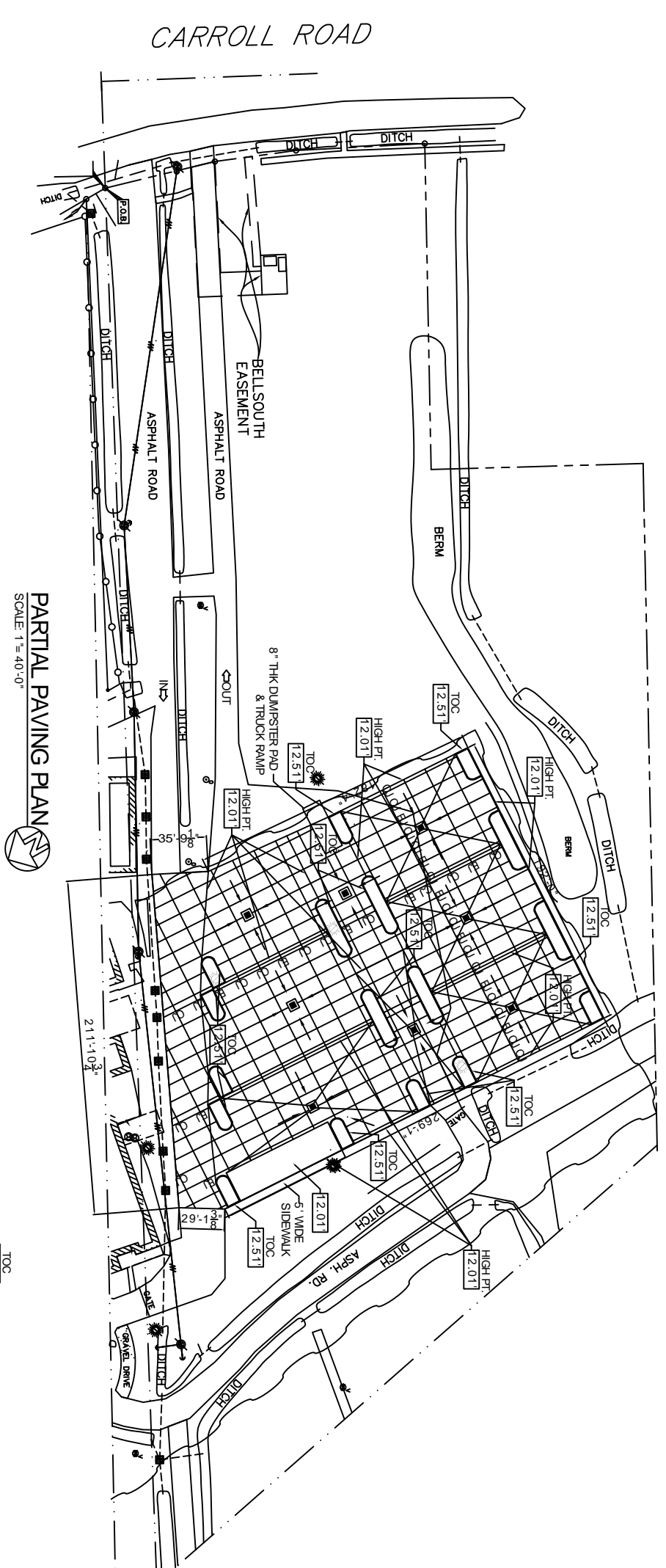

PARTIAL PAVING PLAN
SCALE: 1" = 40'-0"

- NOTES:**
- 1) FIELD VERIFY ALL ELEVATIONS PRIOR TO CONSTRUCTION.
 - 2) MUCK OUT 12" DEEP FOR NEW PARKING LOT. CAPABLE OF 1500 PSF BEARING.
 - 3) TEMPORARY PARKING LOT SHALL BE CONSTRUCTED OF LIMESTONE.
 - 4) SEE SHEET C-5 FOR PAVING DIMENSIONAL PLAN.

