

**DAMMON**  
ENGINEERING, INC.

CHIEF ENGINEER  
EMMETT  
DAMMON, P.E.

CHIEF ARCHITECT  
ROBERT  
WILTSE

1095 FLORIDA AVENUE  
SLIDELL, LA. 70458  
OFFICE: 985-649-5832  
FAX: 985-641-5950

WEBSITE:  
WWW.DAMMONENGINEERING.COM

EMAIL:  
DAMMONENG@BELLSOUTH.NET

- ARCHITECTURE
- ENGINEERING
- STUDIES
- PLANNING
- INVESTIGATION
- EXPERT WITNESS

GREEN-STATEFARM  
RETAIL COMPLEX  
GAUSE  
BLVD., WEST  
SLIDELL, LA

FLOOR  
PLAN

REV:

SCALE: AS NOTED

JOB#: 2057

DATE: 04-19-10

SHEET

**A-1**

OF

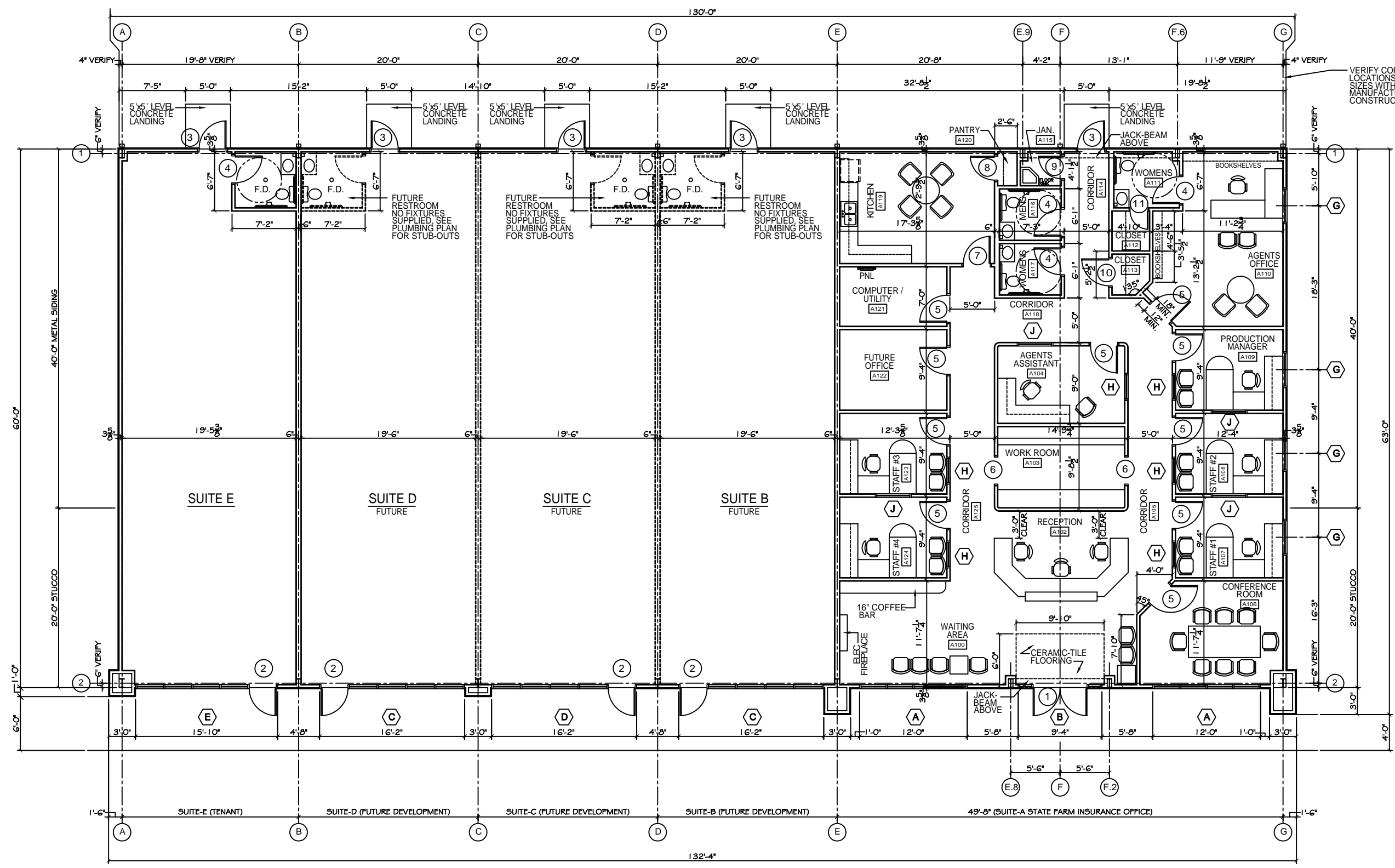

FLOOR PLAN  
SCALE: 3/16"=1'

PRELIMINARY (NOT FOR CONSTRUCTION)